

| Repair Parts Sheet | Revision | Revision Date | Product Code Beginning |
|--------------------|----------|---------------|------------------------|
| L3032 | Rev. G | 10/22 | E |

Fig. 1, Cylinder Assembly

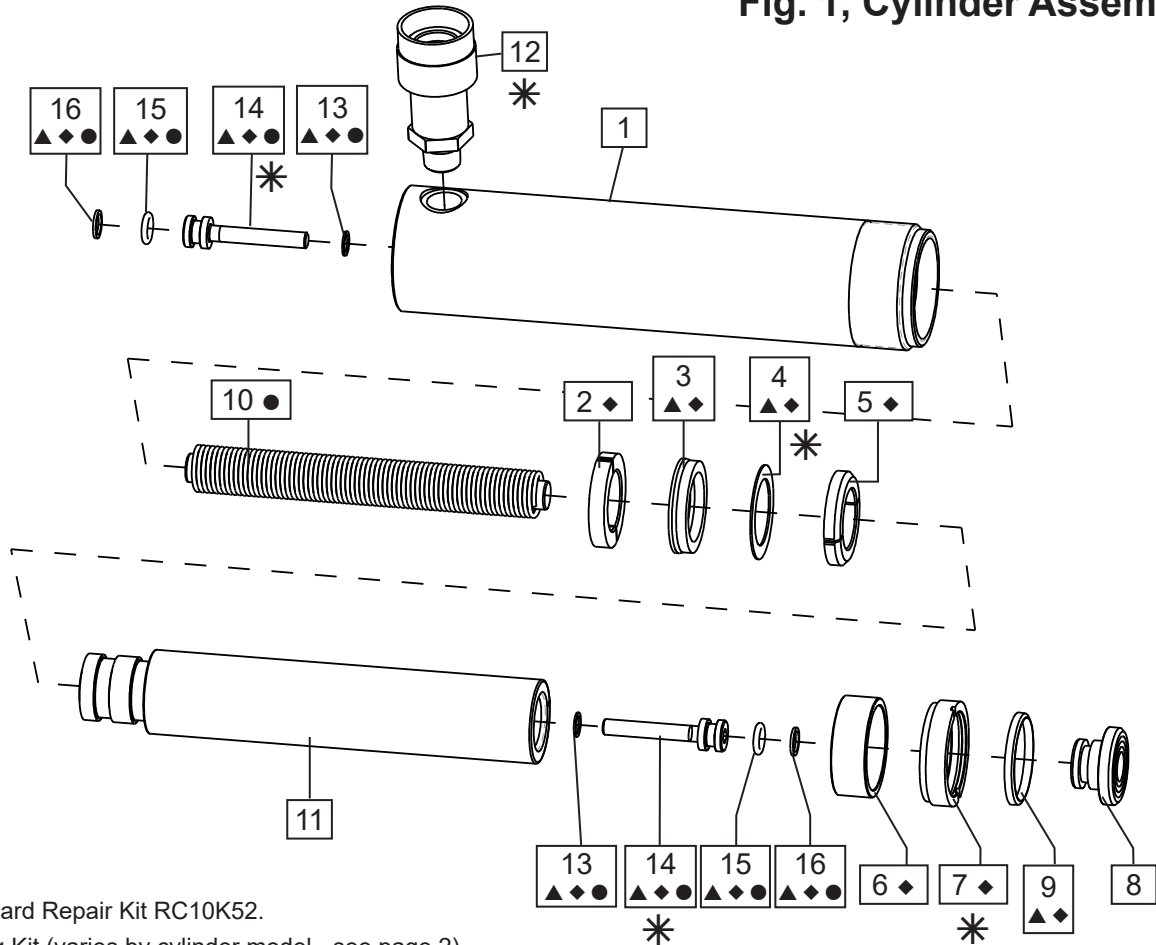

- ▲ = Standard Repair Kit RC10K52.
- = Spring Kit (varies by cylinder model - see page 2).
- ◆ = Premium Repair Kit RC10K72.
- * = See *Notes* section for additional information.



**Note: See Page 2
for parts list.**

| (*) Notes | |
|-----------|--|
| Item | Torque / notes |
| 4 | Washer to be placed with the sharp edge towards U-Cup. |
| 7 | 7.9 - 10.2 Nm, 70 - 90 In - Lbs |
| 7 | Secure with Loctite 222. |
| 12 | 54 - 81 Nm, 40 - 60 Ft - Lbs |
| 12 | Use Loctite 545 or Teflon tape. |
| 14 | 10.2 - 12.4 Nm, 90 - 110 In - Lbs. |

Repair Parts List, Figure 1

L3032

| Item | Description | Qty. | Part Number | | | | |
|------|----------------------|------|-----------------|-----------------|-----------------|-----------------|-----------------|
| | | | RC-106 | RC-108 | RC-1010 | RC-1012 | RC-1014 |
| 1 | Base | 1 | (Not Available) | (Not Available) | (Not Available) | (Not Available) | (Not Available) |
| 2 | Bearing, Bottom ◆ | 1 | DD2260107 | DD2260107 | DD2260107 | DD2260107 | DD2260107 |
| 3 | U-Cup ▲◆ | 1 | CB663041 | CB663041 | CB663041 | CB663041 | CB663041 |
| 4 | Washer ▲◆ | 1 | G384108 | G384108 | G384108 | G384108 | G384108 |
| 5 | Bearing, Top ◆ | 1 | G382107 | G382107 | G382107 | G382107 | G382107 |
| 6 | Bearing, Stop Ring ◆ | 1 | G831446 | G831446 | G831446 | G831446 | G831446 |
| 7 | Stop Ring ◆ | 1 | G385044 | G385044 | G385044 | G385044 | G385044 |
| 8 | Saddle, Grooved | 1 | A102G | A102G | A102G | A102G | A102G |
| 9 | Wiper Ring ▲◆ | 1 | G416044 | G416044 | G416044 | G416044 | G416044 |
| 10 | Spring ● | 1 | DD2267110 | DD2270110 | DD2252110 | DD2257110 | DD2261110 |
| 11 | Plunger | 1 | (Not Available) | (Not Available) | (Not Available) | (Not Available) | (Not Available) |
| 12 | Coupler | 1 | CR-400 | CR-400 | CR-400 | CR-400 | CR-400 |
| 13 | Gasket ▲◆● | 2 | C846037 | C846037 | C846037 | C846037 | C846037 |
| 14 | Spring Retainer ▲◆● | 2 | DD1543160 | DD1543160 | DD1543160 | DD1543160 | DD1543160 |
| 15 | O-Ring ▲◆● | 2 | B1110903 | B1110903 | B1110903 | B1110903 | B1110903 |
| 16 | Back-up ▲◆● | 2 | B1110564 | B1110564 | B1110564 | B1110564 | B1110564 |
| N/S | Dust Cap ▲◆ | 1 | DD1782020 | DD1782020 | DD1782020 | DD1782020 | DD1782020 |
| N/S | Thread Protector ▲◆ | 1 | DD1774271 | DD1774271 | DD1774271 | DD1774271 | DD1774271 |
| N/S | O-Ring Coupler ▲◆ | 1 | B1116803 | B1116803 | B1116803 | B1116803 | B1116803 |
| N/S | Enerpac Decal ▲◆ | 1 | DD2217026 | DD2216026 | DD2216026 | DD2217026 | DD2217026 |
| N/S | Warning Decal ▲◆ | 1 | DA5625026 | DA5625026 | DA5625026 | DA5625026 | DA5625026 |
| N/S | O-Ring Saddle ▲◆ | 1 | B1208503 | B1208503 | B1208503 | B1208503 | B1208503 |
| ▲ | Repair Kit, Standard | - | RC10K52 | RC10K52 | RC10K52 | RC10K52 | RC10K52 |
| ◆ | Repair Kit, Premium | - | RC10K72 | RC10K72 | RC10K72 | RC10K72 | RC10K72 |
| ● | Spring Kit | - | RC10K33 | RC10K34 | RC10K35 | RC10K36 | RC10K37 |

Notes:

Premium repair kit includes all standard (▲) repair kit items plus additional premium (◆) items.

N/S = Item not shown.

IMPORTANT: Shaded items are available only in kits (not sold separately).

Cylinders with Viton components only: Order Repair Kit RC102KV in addition to Repair Kit RC10K52 or RC10K72.
 Repair Kit RC102KV includes Viton components for items 3 and 9. Standard components are used in other locations.



To maintain your warranty:

- Use only Enerpac Oil
- Have your products inspected and repaired by an Enerpac Authorized Service Center



Visit www.enerpac.com for the location of the Enerpac Authorized Service Center nearest you.