



The Timken Company

4500 Mt Pleasant St. NW

N. Canton, OH 44720

Phone: (234) 262-3000

E-Mail: CustomerCAD@timken.com • **Web site:** www.timken.com

Part Number QACW13A207S, Single Concentric Piloted Flange Cartridge



[Specifications](#) | [Dimensions](#) | [Radial and Thrust Factors](#) | [Engineering Seal Speed](#) | [Engineering Bearing Attributes](#) | [Engineering Internal Radial Clearance](#)

Specifications

Engineering Group Mounted Bearing

Bearing Number 22213

Shaft Size 2 7/16 in

Shaft Size Type Imperial

Full Timken Part Number

QACW13A207SB
 QACW13A207SC
 QACW13A207SEB
 QACW13A207SEC
 QACW13A207SEM
 QACW13A207SEN
 QACW13A207SEO
 QACW13A207SET
 QACW13A207SETHT
 QACW13A207SLRC
 QACW13A207SM
 QACW13A207SMNPNG
 QACW13A207SMSLA



QACW13A207SMT
 QACW13A207SN
 QACW13A207SO
 QACW13A207ST
 QACW13A207STHT

Locking Style Single Concentric

Housing Construction Piloted Flange Cartridge

UPC Code

0883450036801
 0883450036818
 0883450036832
 0883450036849
 0883450036856
 0883450036863
 0883450036870
 0883450036887
 0883450193863
 0883450194020
 0883450271035
 0883450271196
 0883450432443
 0883450432450
 0883450454476
 0883450496346
 0883450497053
 0883450502306

Dimensions

Dimension BC

6-1/2 in
 165.1 mm

Dimension B Exp

1.95 in
 49.5 mm

Dimension B Fix

1.86 in
 47.2 mm

Dimension C

3.8 in
 96.5 mm

Dimension D	5.5 in 139.7 mm
Dimension E	4.6 in 116.8 mm
Dimension F	7.63 in 193.8 mm
Dimension G	5.5 in 139.7 mm
Dimension H	0.5 in 12.7 mm
Dimension J (Bolt Size)	0.5 in 12 mm
Dimension KA	1.24 in 31.5 mm
Dimension L Exp	3.63 in 92.2 mm
Dimension L Fix	3.55 in 90.2 mm
Dimension M	2.15 in 54.6 mm
Dimension N	1.69 in 42.9 mm
Dimension RA	0.17 in 4.3 mm
Dimension SA	3.39 in 86.1 mm

Radial and Thrust Factors

C0 - Static Load	48600 lbf 216000 N
-------------------------	-----------------------

C - Dynamic Load (Basic)	46400 lbf 206000 N
---------------------------------	-----------------------

e - Geometry Factor	0.24
----------------------------	------

Y1 - Geometry Factor	2.79
-----------------------------	------

Y2 - Geometry Factor	4.15
-----------------------------	------

Engineering Seal Speed

Oil Lubrication - M/N Seal	1800 rpm
-----------------------------------	----------

Oil Lubrication - T Seal	3200 rpm
---------------------------------	----------

Oil Lubrication - B/C/O Seal	1500 rpm
-------------------------------------	----------

Grease Lubrication - M/N Seal	1800 rpm
--------------------------------------	----------

Grease Lubrication - T Seal	2800 rpm
------------------------------------	----------

Grease Lubrication - B/C/O Seal	1500 rpm
--	----------

Engineering Bearing Attributes

Float	0.083 in 2.108 mm
--------------	----------------------

Shaft Tolerance	0.0015 in 0.038 mm
------------------------	-----------------------

Engineering Internal Radial Clearance

Eng Internal Radial Clearance - Min	0.0016
--	--------

Eng Internal Radial Clearance - Max	0.0026
--	--------

Pre Install Clearance Min	0.0016 in 0.040 mm
----------------------------------	-----------------------

Pre Install Clearance Max

0.0026 in
0.065 mm

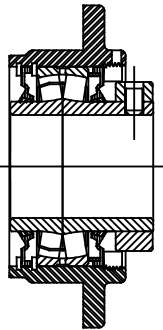
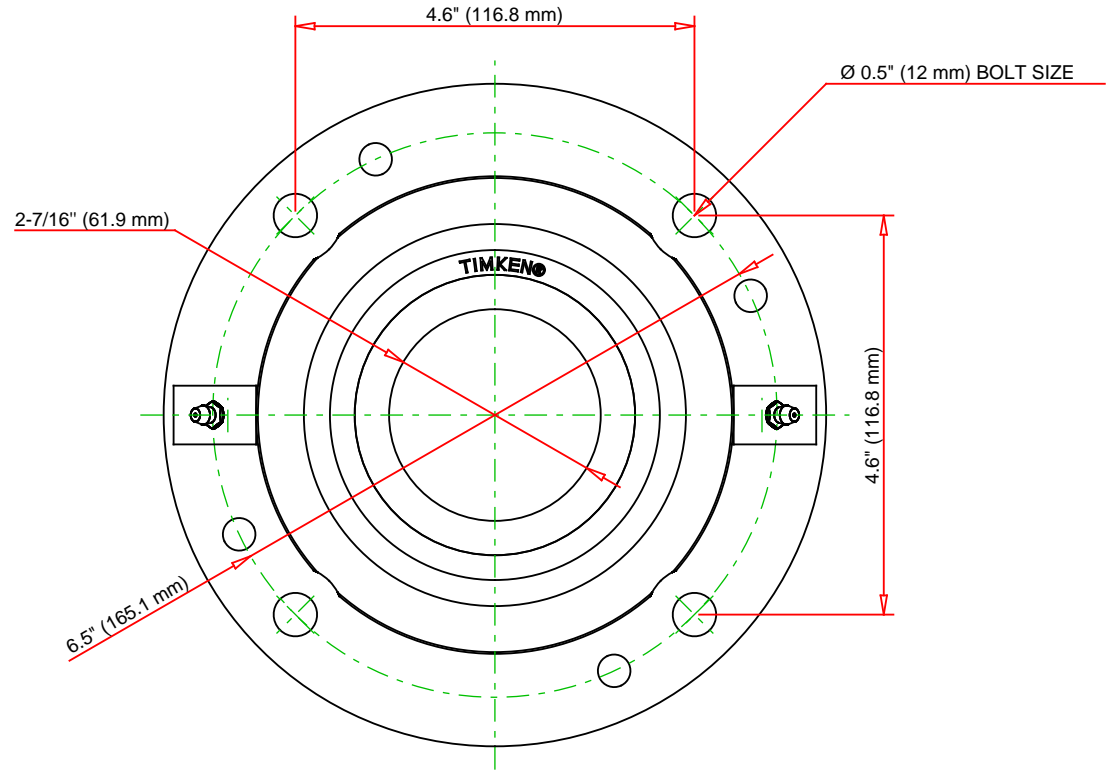
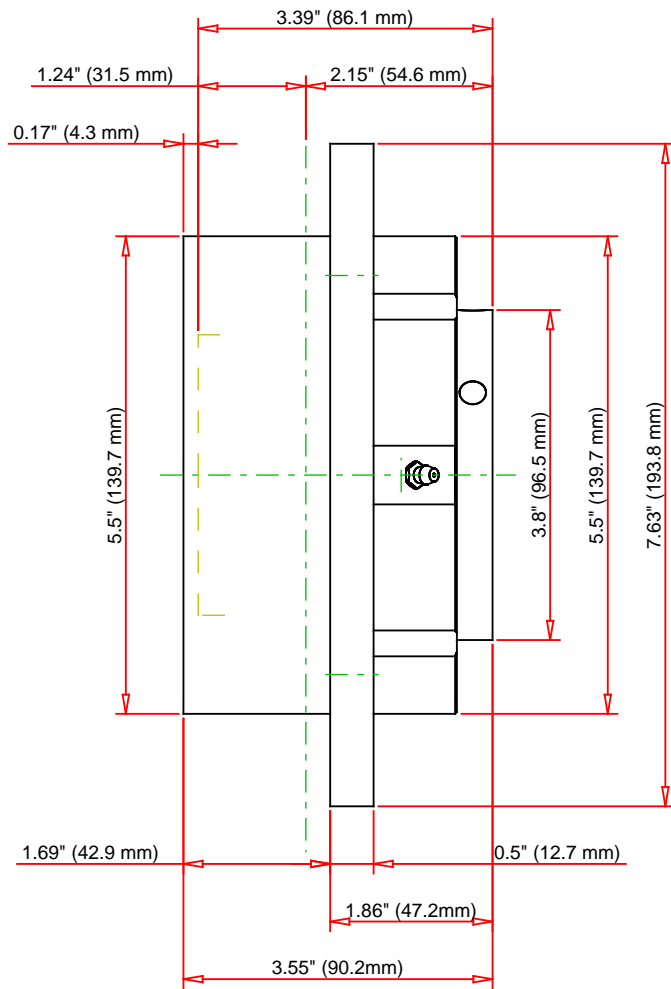

Note: Section View not to Scale

C - Dynamic Load	46400	lbf	206000	N
C0 - Static Load	48600	lbf	216000	N
Weight	16	lb	7.3	kg
Max. Speed T-Seals & Grease	2800	rpm		
Rad. Clearance - Max.	0.0026			

TIMKEN

THE TIMKEN COMPANY
NORTH CANTON, OHIO USA

QACW13A207S

Single Concentric Piloted Flange
Cartridge

Every reasonable effort has been made to ensure the accuracy of the information contained in this writing, but no liability is accepted for errors, omissions or for any other reason.

FOR DISCUSSION ONLY