

TOP VIEW

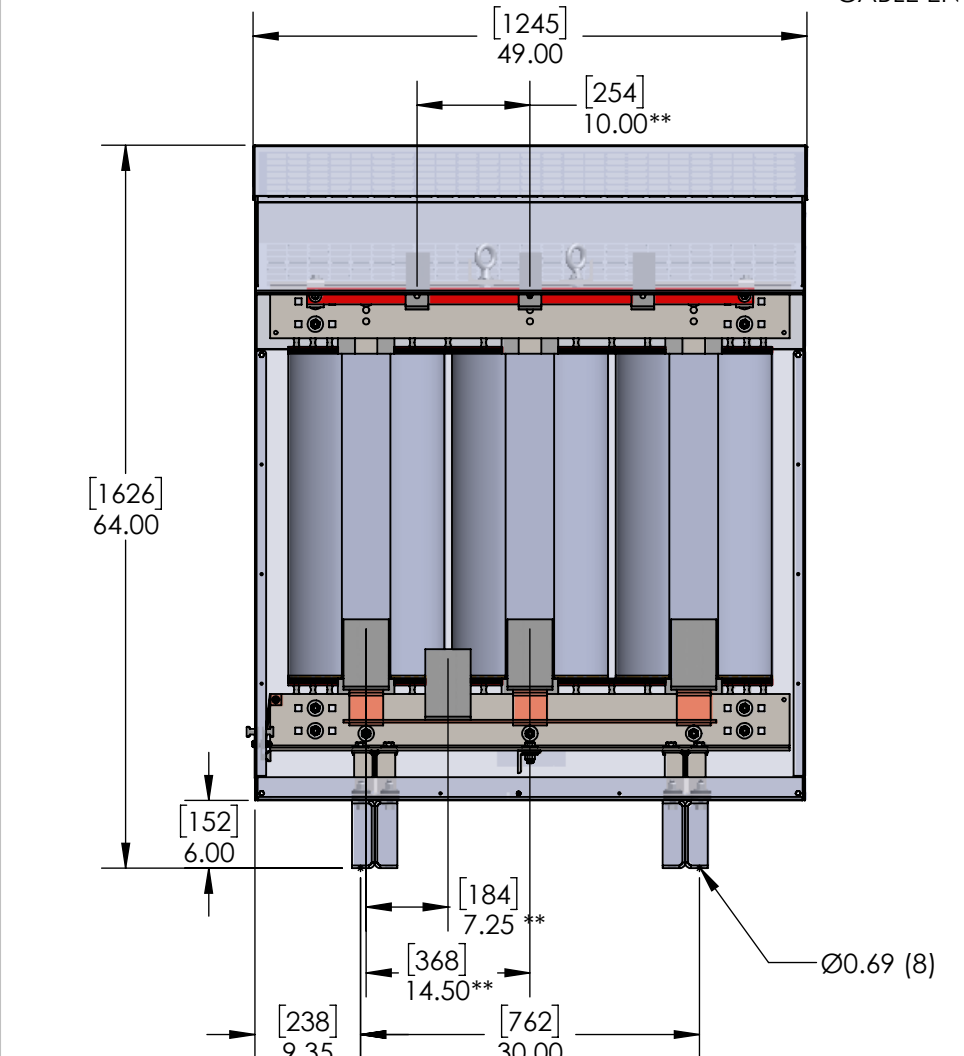

FRONT VIEW

ALUMINUM

KVA	TEMP RISE-150C	TEMP RISE-115C	TEMP RISE-80C
300	SEE DH5	SEE DH5	✓
500	✓	✓	SEE DH7

COPPER

KVA	TEMP RISE-150C	TEMP RISE-115C	TEMP RISE-80C
500	✓	✓	✓
750	✓	✓	✓

- NOTES:
- CATALOGUE INFO TAKES PRECEDENCE OVER THIS DRAWING
 - NOT APPLICABLE TO Y(430, 416, 400, 380) VOLTAGE CODE
 - DRAWING SHOWS DELTA-WYE CONNECTION
 - DATA SUBJECT TO CHANGE WITHOUT NOTICE
 - THIS DRAWING IS FOR REFERENCE ONLY. THE ACTUAL UNIT WILL BE SIMILAR, INTERNAL DIMENSIONS OF CORE & COIL COULD VARY
 - ONLY LIFT BY PROVIDED PROVISIONS (SEE INSTALLATION MANUAL)
 - TERMINALS SHOWN ARE FOR REPRESENTATION ONLY
 - PRIMARY TERMINATED AT TOP FRONT
 - SECONDARY TERMINATED AT BOTTOM FRONT
 - RECOMMENDED BOTTOM AND SIDE CABLE ENTRY (CUTOUTS & GLAND PLATES NOT PROVIDED)
 - TAPS (IF ANY) LOCATED ON COIL FACE AT FRONT
 - GROUND: MECH TYPE LUGS INCLUDED, SUITABLE FOR 250MCM - 6 AWG CU/AL CONDUCTORS (QTY 3)
 - SEE CATALOGUE TO DETERMINE EXACT PAD/LUG PROVIDED
 - ** DIMENSIONS THAT CHANGE BASED ON TRANSFORMER SPECIFICATIONS

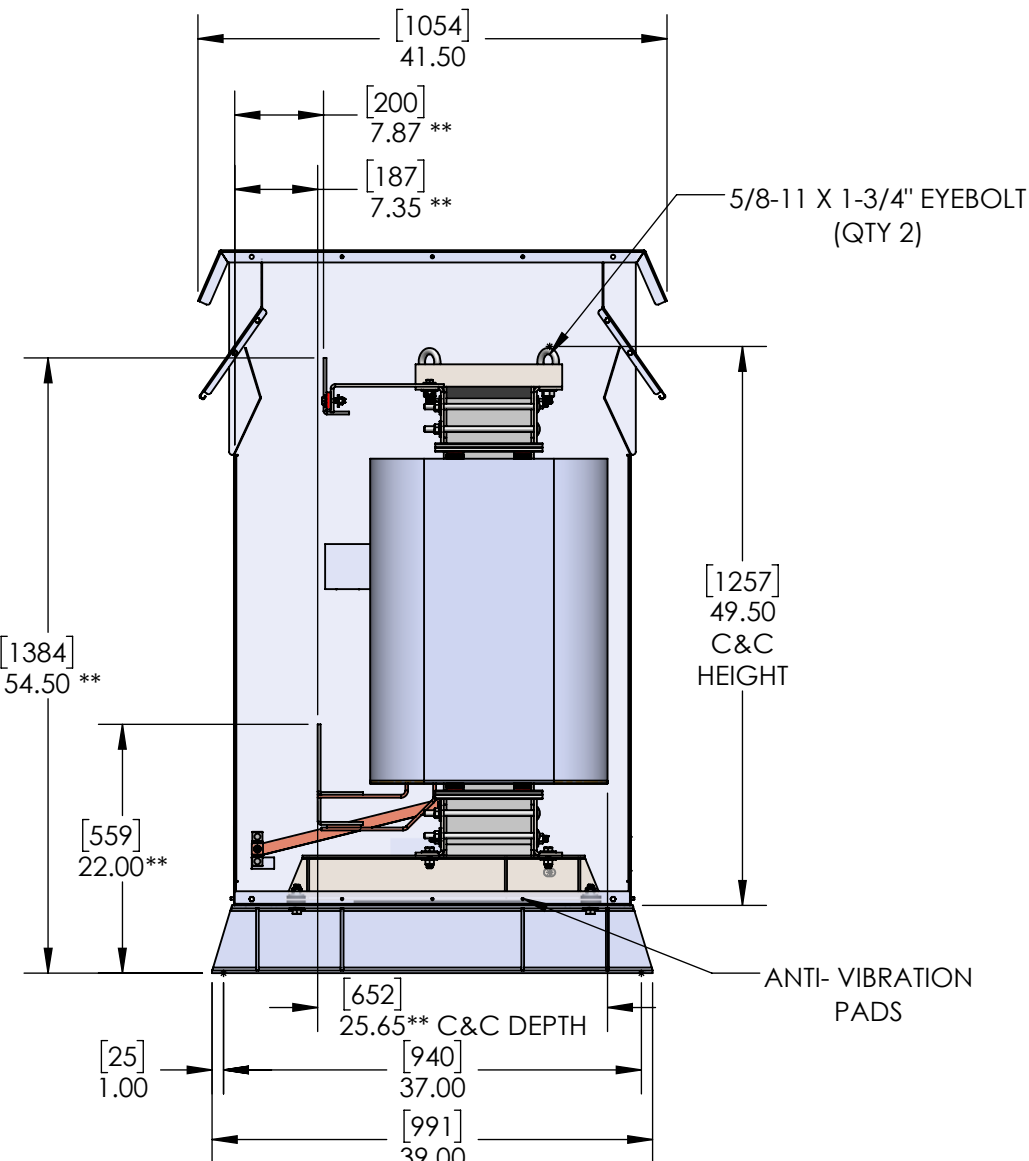

RIGHT SIDE VIEW

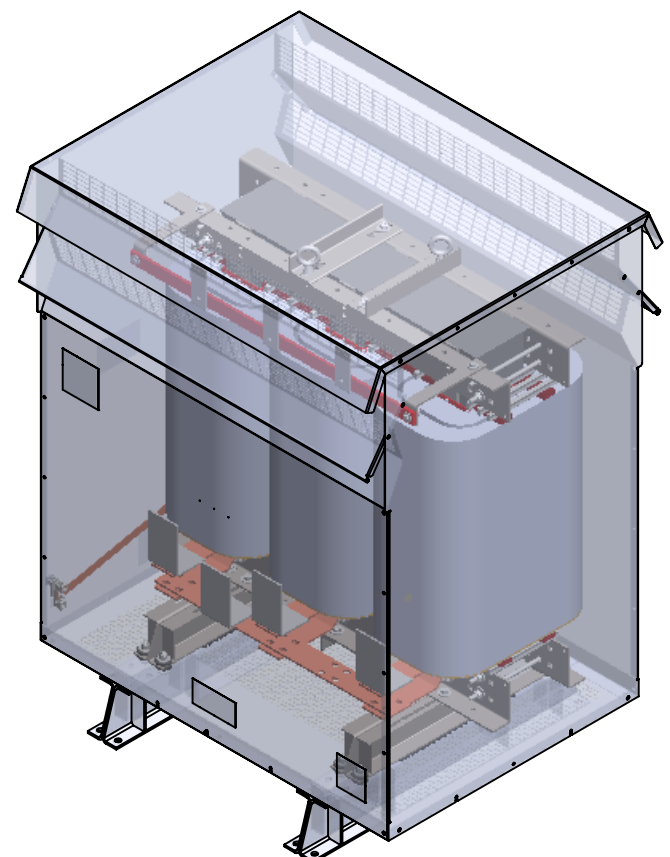

ISOMETRIC VIEW

TOLERANCES
(UNLESS OTHERWISE SPECIFIED)

STANDARD	CUSTOMER
.X ± 0.5 [13]	TERMINAL DETAILS
.XX ± 0.25 [6]	.XX ± 0.06 [1.6]
.XXX ± 0.125 [3]	

ALL DIMENSIONS IN INCHES
MM IN BRACKETS

CAD GENERATED DRAWING DO NOT MANUALLY UPDATE

REV.NO.	REVISION	DATE

Hammond Power Solutions Inc.

DES'D BY:	AA
DATE:	2020-04-03
CHK'D BY:	--
DATE:	--
APP'D BY:	AA
DATE:	2020-04-03

TITLE:

**SENTINEL-G 3PH TRANSFORMER
DH6-N3R REFERENCE DRAWING**

DWG.NO.

B DH6-N3R

SHEET 1 OF 1 REV 0

B DH6-N3R

THIS DRAWING CONTAINS PROPRIETARY INFORMATION BELONGING TO HAMMOND POWER SOLUTIONS INC., AND IS NOT FOR GENERAL DISTRIBUTION

CONFIDENTIAL