



The Timken Company

4500 Mt Pleasant St. NW

N. Canton, OH 44720

Phone: (234) 262-3000

E-Mail: CustomerCAD@timken.com • **Web site:** www.timken.com

Part Number QMPL08J108S, Eccentric Two-Bolt Pillow Block

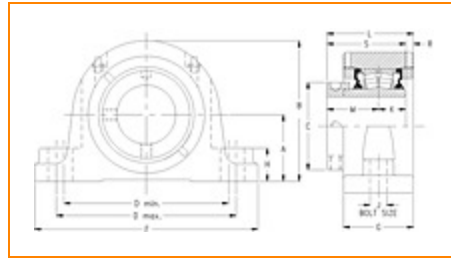

[Specifications](#) | [Dimensions](#) | [Radial and Thrust Factors](#) | [Engineering Seal Speed](#) | [Engineering Bearing Attributes](#) | [Engineering Internal Radial Clearance](#)

Specifications

Engineering Group Mounted Bearing

Bearing Number 22208

Shaft Size 1 1/2 in

Shaft Size Type Imperial

Full Timken Part Number

- QMPL08J108SB
- QMPL08J108SC
- QMPL08J108SEB
- QMPL08J108SEC
- QMPL08J108SEM
- QMPL08J108SEN
- QMPL08J108SEO
- QMPL08J108SET
- QMPL08J108SETNP
- QMPL08J108SM
- QMPL08J108SMNP
- QMPL08J108SN



QMPL08J108SO
 QMPL08J108ST
 QMPL08J108STNP

Locking Style

Eccentric

Housing Construction

Two-Bolt Pillow Block

UPC Code

0883450086622
 0883450086639
 0883450086653
 0883450086660
 0883450086677
 0883450086684
 0883450086691
 0883450086707
 0883450154994
 0883450155335
 0883450249928
 0883450250269
 0883450459419
 0883450459426
 0883450500531

Dimensions**Dimension A**

1.88 in
 47.8 mm

Dimension B

3.73 in
 94.7 mm

Dimension C

2.38 in
 60.5 mm

Dimension D Min

4.69 in
 119.1 mm

Dimension D Max

6 in
 152.4 mm

Dimension F

6.88 in
 174.8 mm

Dimension G	2.25 in 57.2 mm
--------------------	--------------------

Dimension H	1 in 25.4 mm
--------------------	-----------------

Dimension J (Bolt Size)	0.5 in 12 mm
--------------------------------	-----------------

Dimension K	1 in 25.4 mm
--------------------	-----------------

Dimension L	2.88 in 73.2 mm
--------------------	--------------------

Dimension M	1.75 in 44.5 mm
--------------------	--------------------

Dimension R	0.13 in 3.3 mm
--------------------	-------------------

Dimension S	2.75 in 69.9 mm
--------------------	--------------------

Radial and Thrust Factors

C0 - Static Load	22400 lbf 99700 N
-------------------------	----------------------

C - Dynamic Load (Basic)	23400 lbf 104000 N
---------------------------------	-----------------------

e - Geometry Factor	0.27
----------------------------	------

Y1 - Geometry Factor	2.47
-----------------------------	------

Y2 - Geometry Factor	3.67
-----------------------------	------

Engineering Seal Speed

Oil Lubrication - M/N Seal	2700 rpm
-----------------------------------	----------

Oil Lubrication - T Seal	4500 rpm
---------------------------------	----------

Oil Lubrication - B/C/O Seal	1950 rpm
-------------------------------------	----------

Grease Lubrication - M/N Seal	2700 rpm
--------------------------------------	----------

Grease Lubrication - T Seal	4000 rpm
------------------------------------	----------

Grease Lubrication - B/C/O Seal	1950 rpm
--	----------

Engineering Bearing Attributes

Float	0.050 in 1.270 mm
--------------	----------------------

Shaft Tolerance	0.0010 in 0.025 mm
------------------------	-----------------------

Engineering Internal Radial Clearance

Eng Internal Radial Clearance - Min	0.0012
--	--------

Eng Internal Radial Clearance - Max	0.0018
--	--------

Pre Install Clearance Min	0.0012 in 0.030 mm
----------------------------------	-----------------------

Pre Install Clearance Max	0.0018 in 0.045 mm
----------------------------------	-----------------------

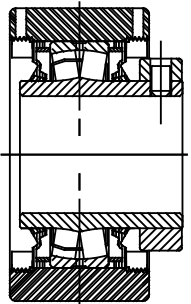
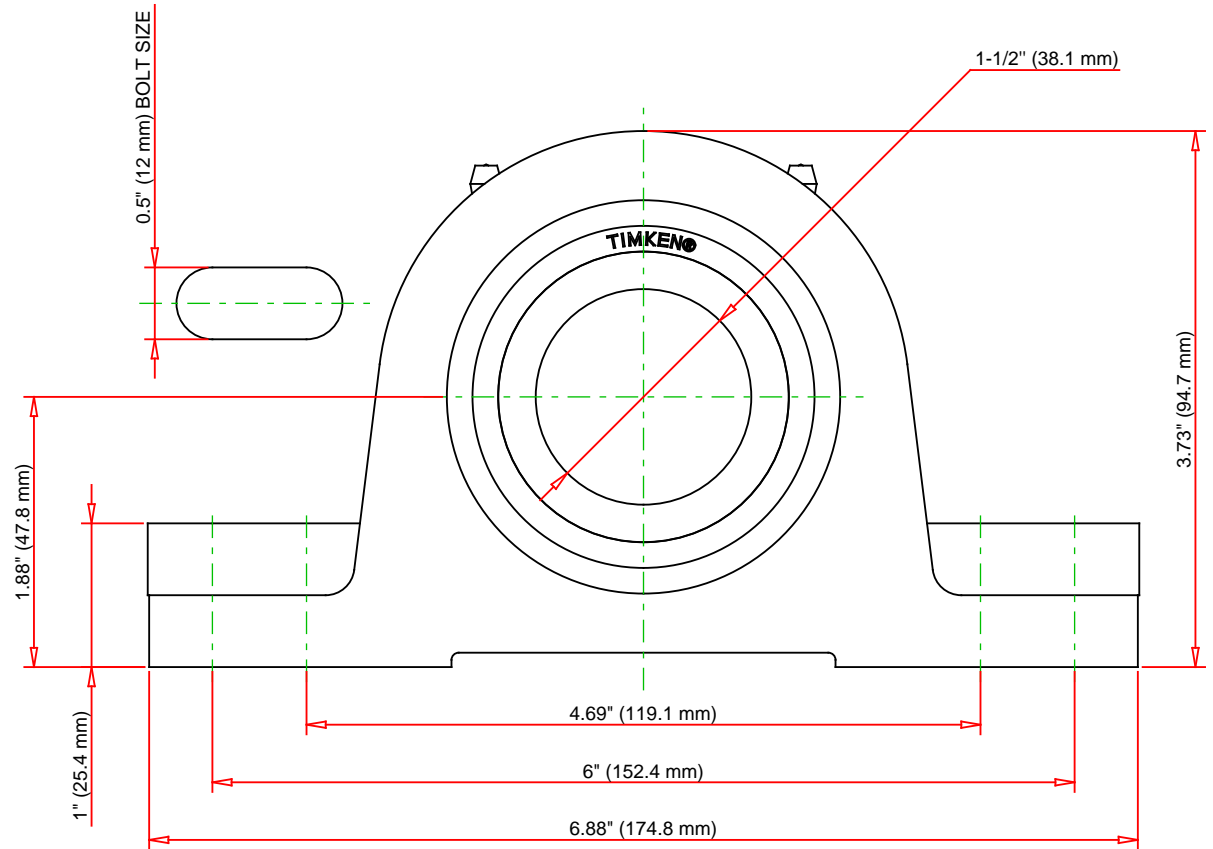
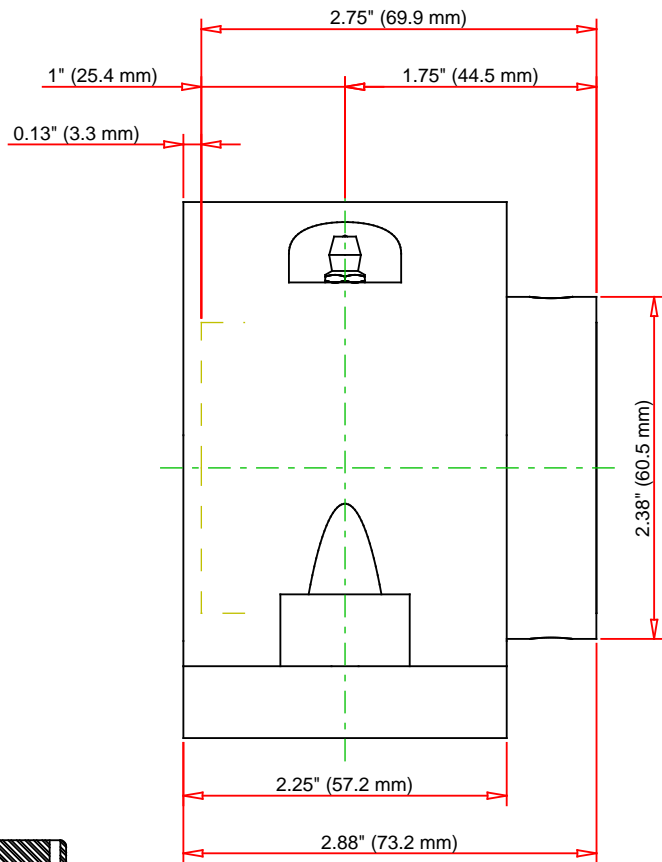

Note: Section View not to Scale

C - Dynamic Load	23400	lbf	104000	N
C0 - Static Load	22400	lbf	99700	N
Weight	9	lb	4.1	kg
Max. Speed T-Seals & Grease	4000	rpm		
Rad. Clearance - Max.	0.0018			

TIMKEN

THE TIMKEN COMPANY
NORTH CANTON, OHIO USA

QMPL08J108S
Eccentric Two-Bolt Pillow Block

Every reasonable effort has been made to ensure the accuracy of the information contained in this writing, but no liability is accepted for errors, omissions or for any other reason.

FOR DISCUSSION ONLY