



**The Timken Company**

4500 Mt Pleasant St. NW

N. Canton, OH 44720

**Phone:** (234) 262-3000

**E-Mail:** [CustomerCAD@timken.com](mailto:CustomerCAD@timken.com) • **Web site:** [www.timken.com](http://www.timken.com)

## Part Number QMCW08J107S, Eccentric Piloted Flange Cartridge

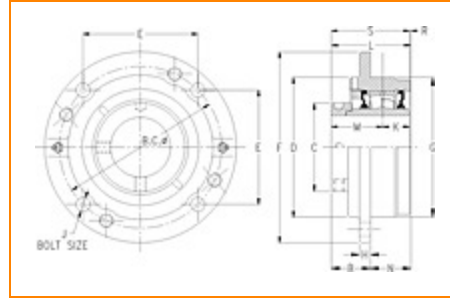

[Specifications](#) | [Dimensions](#) | [Radial and Thrust Factors](#) | [Engineering Seal Speed](#) | [Engineering Bearing Attributes](#) | [Engineering Internal Radial Clearance](#)

### Specifications

**Engineering Group** Mounted Bearing

**Bearing Number** 22208

**Shaft Size** 1 7/16 in

**Shaft Size Type** Imperial

**Full Timken Part Number**

- QMCW08J107SB
- QMCW08J107SC
- QMCW08J107SEB
- QMCW08J107SEC
- QMCW08J107SEM
- QMCW08J107SEN
- QMCW08J107SEO
- QMCW08J107SET
- QMCW08J107SM
- QMCW08J107SN
- QMCW08J107SO
- QMCW08J107ST



<b>Locking Style</b>	Eccentric
<b>Housing Construction</b>	Piloted Flange Cartridge
<b>UPC Code</b>	0883450061421 0883450061438 0883450061452 0883450061469 0883450061476 0883450061483 0883450061490 0883450061506 0883450166386 0883450167109 0883450258524 0883450259064

## Dimensions

<b>Dimension BC</b>	4.38 in 111.3 mm
<b>Dimension B Exp</b>	1.61 in 40.9 mm
<b>Dimension B Fix</b>	1.53 in 38.9 mm
<b>Dimension C</b>	2.36 in 59.9 mm
<b>Dimension D</b>	3.63 in 92.2 mm
<b>Dimension E</b>	3.09 in 78.5 mm
<b>Dimension F</b>	5 1/4 in 133.4 mm
<b>Dimension G</b>	3.625 in 92.1 mm

<b>Dimension H</b>	0.5 in 12.7 mm
<b>Dimension J (Bolt Size)</b>	0.438 in 10 mm
<b>Dimension K</b>	1 in 25.4 mm
<b>Dimension L Exp</b>	2.98 in 75.7 mm
<b>Dimension L Fix</b>	2.9 in 73.7 mm
<b>Dimension M</b>	1.75 in 44.5 mm
<b>Dimension N</b>	1.38 in 35.1 mm
<b>Dimension R</b>	0.15 in 3.8 mm
<b>Dimension S</b>	2.75 in 69.9 mm

## Radial and Thrust Factors

<b>C0 - Static Load</b>	22400 lbf 99700 N
<b>C - Dynamic Load (Basic)</b>	23400 lbf 104000 N
<b>e - Geometry Factor</b>	0.27
<b>Y1 - Geometry Factor</b>	2.47
<b>Y2 - Geometry Factor</b>	3.67

## Engineering Seal Speed

<b>Oil Lubrication - M/N Seal</b>	2700 rpm
-----------------------------------	----------

<b>Oil Lubrication - T Seal</b>	4500 rpm
---------------------------------	----------

<b>Oil Lubrication - B/C/O Seal</b>	1950 rpm
-------------------------------------	----------

<b>Grease Lubrication - M/N Seal</b>	2700 rpm
--------------------------------------	----------

<b>Grease Lubrication - T Seal</b>	4000 rpm
------------------------------------	----------

<b>Grease Lubrication - B/C/O Seal</b>	1950 rpm
--	----------

## Engineering Bearing Attributes

<b>Float</b>	0.050 in 1.270 mm
--------------	----------------------

<b>Shaft Tolerance</b>	0.0010 in 0.025 mm
------------------------	-----------------------

## Engineering Internal Radial Clearance

<b>Eng Internal Radial Clearance - Min</b>	0.0012
--	--------

<b>Eng Internal Radial Clearance - Max</b>	0.0018
--	--------

<b>Pre Install Clearance Min</b>	0.0012 in 0.030 mm
----------------------------------	-----------------------

<b>Pre Install Clearance Max</b>	0.0018 in 0.045 mm
----------------------------------	-----------------------

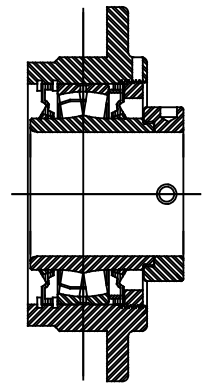
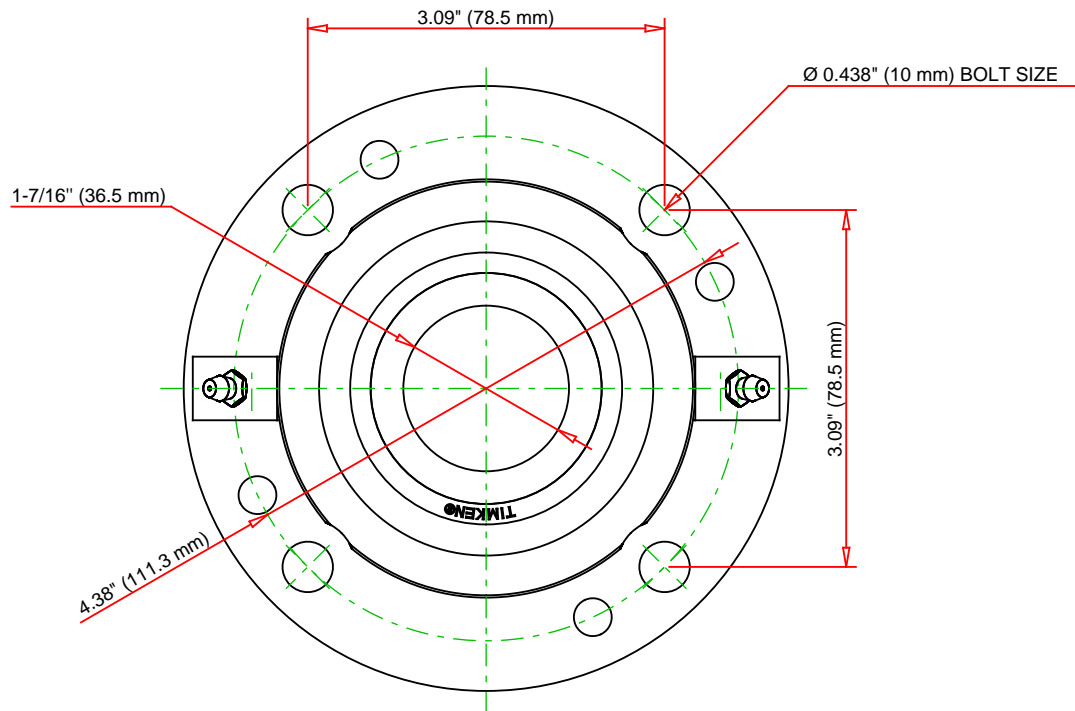
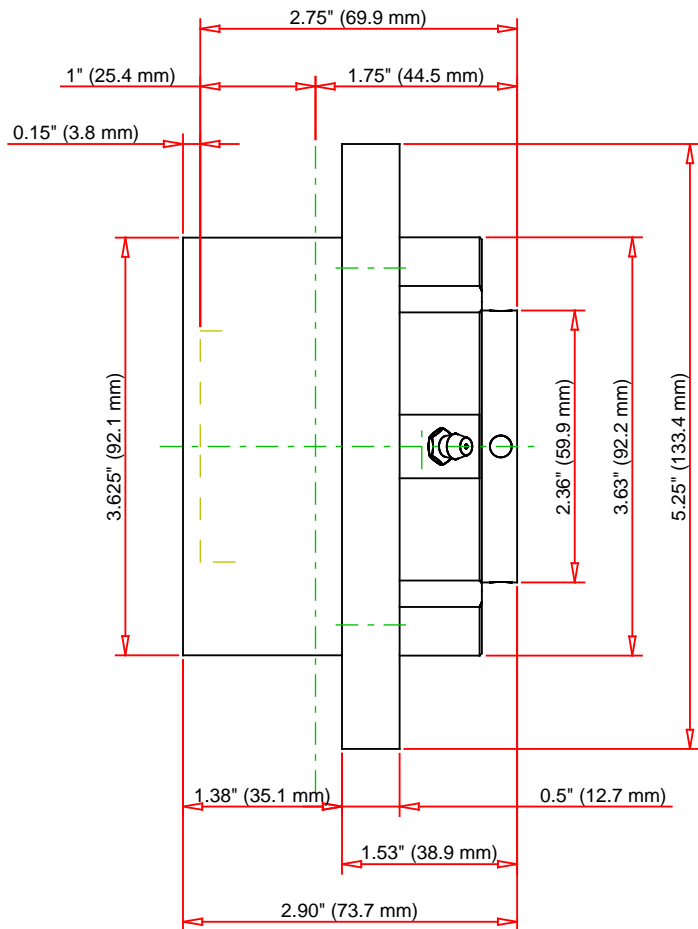

Note: Section View not to Scale

C - Dynamic Load	23400	lbf	104000	N
C0 - Static Load	22400	lbf	99700	N
Weight	8	lb	3.6	kg
Max. Speed T-Seals & Grease	4000	rpm		
Rad. Clearance - Max.	0.0018			

**TIMKEN**

THE TIMKEN COMPANY  
NORTH CANTON, OHIO USA

**QMCW08J107S**  
Eccentric Piloted Flange Cartridge

Every reasonable effort has been made to ensure the accuracy of the information contained in this writing, but no liability is accepted for errors, omissions or for any other reason.

**FOR DISCUSSION ONLY**