

ALUMINUM CYLINDERS

RAC Series — Single Acting Center Hole

SIMPLEX



RAC303 Shown

Capacity Range▶ 30 - 60 tons

Stroke Range▶ 3 - 6 in.

Maximum Pressure▶ 10,000 psi

- ▶ Half the weight of steel cylinders.
- ▶ Heavy duty spring for fast & full retraction.
- ▶ Technical coating reduces wear & corrosion.
- ▶ Stop rings for piston blow-out protection.
- ▶ Rod wiper protects inner cylinder from dirt.



POWER PUMPS - pages 43 - 65

Simplex offers a wide variety of lightweight power pumps to fit any application.



CENTER HOLE

Chrome plated center hole for extra protection.

The Simplex RAC306A 30 ton single acting aluminum center hole cylinder is used to pull pins from off road equipment. ▼

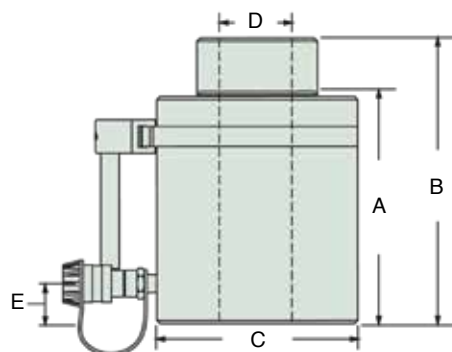

Model	Capacity (tons)	Stroke (in)	Oil Capacity Required (cu.in.)	Effect Area (sq.in.)	Pressure @ Capacity (psi)	A	B	C	D	E	Wgt. (lbs)
						Minimum Height (in)	Extended Height (in)	Body O.D. (in)	Center Hole (in)	Base to Port C/L (in)	
RAC303	30	3	22	7.21	8321	8.75	11.75	5.5	1.19	1	22
RAC306A	30	6	44	7.21	8321	11.75	17.75	5.5	1.19	1	30
RAC603	60	3	37	12.3	9756	10.13	13.13	7.5	2.13	1	42
RAC606	60	6	74	12.3	9756	13.25	19.25	7.5	2.13	1	55