

Hub City™ HERA® High-Efficiency Right Angle Gear Drives

Torque Arm Kits

SERIES	TORQUE ARM KIT NO.	A	D	D2	Shipping WT. LBS.
HERA35	0259-00125	2.50	2.062	3.688	8.5
HERA45	0259-00078	3.25	2.500	4.438	9.0
HERA55	0259-00107	5.00	3.500	5.875	11.0
HERA75	0259-00144	5.00	4.438	6.937	13.0

Contact factory at 605-225-0360 or hubsales@regalbelloit.com for custom torque arm designs.

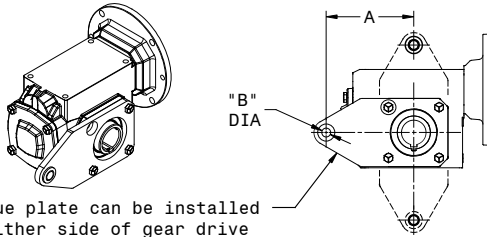

Torque plate can be installed on either side of gear drive in (3) possible orientations.

Side Mounted Torque Plate Kits

SERIES	TORQUE PLATE KIT NO.	A	B	Shipping WT. LBS.
HERA35	0259-00286	5.12	0.53	3.0
HERA45	0259-00287	5.12	0.53	3.5
HERA55	0259-00309	8.50	0.53	8.0
HERA75	0259-00310	10.00	0.53	10.0

Torque Plate Kit does not include tie rod assembly.

Model	OVERHUNG LOAD (LBS)*	THRUST LOAD (LBS)
HERA35	1500	1150
HERA45	1800	2100
HERA55	2200	2575
HERA75	3000	3400

Model	NORMAL BACKLASH			
	INCHES AT .75" RADIUS OF OUTPUT		ARC-MINUTES	
	MIN	MAX	MIN	MAX
All Models	0.002	0.006	9.2	27.5

*OHL Assumptions:

- 1) Load located at 1.5" from end of output sleeve (all models).
- 2) These values only account for bearing ratings and do not include stresses on plug-in or customer shafts used with the gear drive unit.

Consult factory at 605-225-0360 or hubsales@regalbelloit.com if OHL is expected to exceed above ratings.

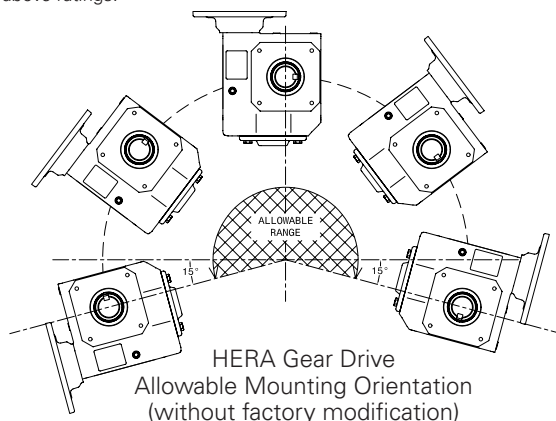

HERA Gear Drive
Allowable Mounting Orientation
(without factory modification)

EMAIL: hubsales@regalbelloit.com • www.regalbelloit.com

HERA® Gear Drive ACCESSORIES

Torque Arms & Plates

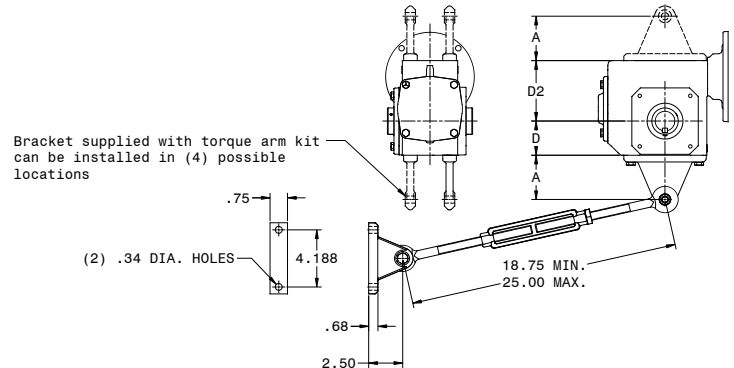

Technical Info

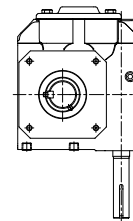

B6

- INPUT VERTICAL/DOWN -

OUTPUT HORIZONTAL

NOT RECOMMENDED POSITION
(FACTORY MODIFICATIONS REQUIRED)

HERA® Gear Drive
Special Mounting
Orientations Requiring
Factory Modification

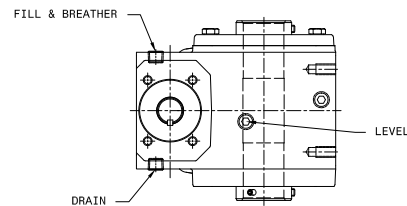

V5

- OUTPUT VERTICAL, COVER SIDE UP -

INPUT HORIZONTAL

(FACTORY MODIFICATIONS REQUIRED)

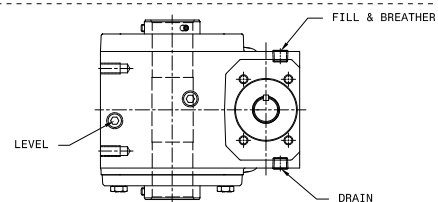

V6

- OUTPUT VERTICAL, COVER SIDE DOWN -

INPUT HORIZONTAL

(FACTORY MODIFICATIONS REQUIRED)