

The Timken Company

4500 Mt Pleasant St. NW

N. Canton, OH 44720

Phone: (234) 262-3000

E-Mail: CustomerCAD@timken.com • **Web site:** www.timken.com

Part Number QMP10J200S, Eccentric Two-Bolt Pillow Block

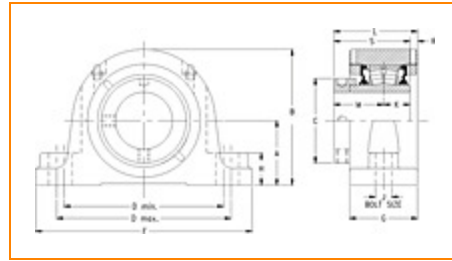

[Specifications](#) | [Dimensions](#) | [Radial and Thrust Factors](#) | [Engineering Seal Speed](#) | [Engineering Bearing Attributes](#) | [Engineering Internal Radial Clearance](#)

Specifications

Engineering Group Mounted Bearing

Bearing Number 22210

Shaft Size 2 in

Shaft Size Type Imperial

Full Timken Part Number
 QMP10J200SB
 QMP10J200SC
 QMP10J200SEB
 QMP10J200SEC
 QMP10J200SEM
 QMP10J200SEN
 QMP10J200SEO
 QMP10J200SET
 QMP10J200SETNP
 QMP10J200SETNPFG
 QMP10J200SM
 QMP10J200SMSLA



QMP10J200SMSLD
 QMP10J200SN
 QMP10J200SO
 QMP10J200ST
 QMP10J200STNP
 QMP10J200STNPFPG

Locking Style

Eccentric

Housing Construction

Two-Bolt Pillow Block

UPC Code

0883450080927
 0883450080934
 0883450080958
 0883450080965
 0883450080972
 0883450080989
 0883450080996
 0883450081009
 0883450154352
 0883450154697
 0883450249300
 0883450249645
 0883450433396
 0883450472739
 0883450492812
 0883450492836
 0883450499828
 0883450499835

Dimensions**Dimension A**

2.25 in
 57.2 mm

Dimension B

4.81 in
 122.2 mm

Dimension C

2.81 in
 71.4 mm

Dimension D Min

6 in
 152.4 mm

Dimension D Max	7.13 in 181.1 mm
Dimension F	8.88 in 225.6 mm
Dimension G	2.44 in 62 mm
Dimension H	1-1/4 in 31.8 mm
Dimension J (Bolt Size)	0.625 in 16 mm
Dimension K	1 in 25.4 mm
Dimension L	3.11 in 79 mm
Dimension M	1.89 in 48 mm
Dimension R	0.24 in 6.1 mm
Dimension S	2.87 in 72.9 mm

Radial and Thrust Factors

C0 - Static Load	26600 lbf 118000 N
C - Dynamic Load (Basic)	26300 lbf 117000 N
e - Geometry Factor	0.24
Y1 - Geometry Factor	2.84
Y2 - Geometry Factor	4.23

Engineering Seal Speed

Oil Lubrication - M/N Seal	2400 rpm
Oil Lubrication - T Seal	4200 rpm
Oil Lubrication - B/C/O Seal	1800 rpm
Grease Lubrication - M/N Seal	2400 rpm
Grease Lubrication - T Seal	3550 rpm
Grease Lubrication - B/C/O Seal	1800 rpm

Engineering Bearing Attributes

Float	0.050 in 1.270 mm
Shaft Tolerance	0.0015 in 0.038 mm

Engineering Internal Radial Clearance

Eng Internal Radial Clearance - Min	0.0016
Eng Internal Radial Clearance - Max	0.0026
Pre Install Clearance Min	0.0016 in 0.040 mm
Pre Install Clearance Max	0.0026 in 0.065 mm

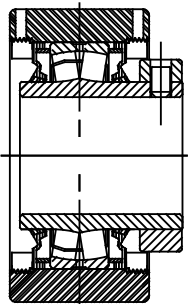
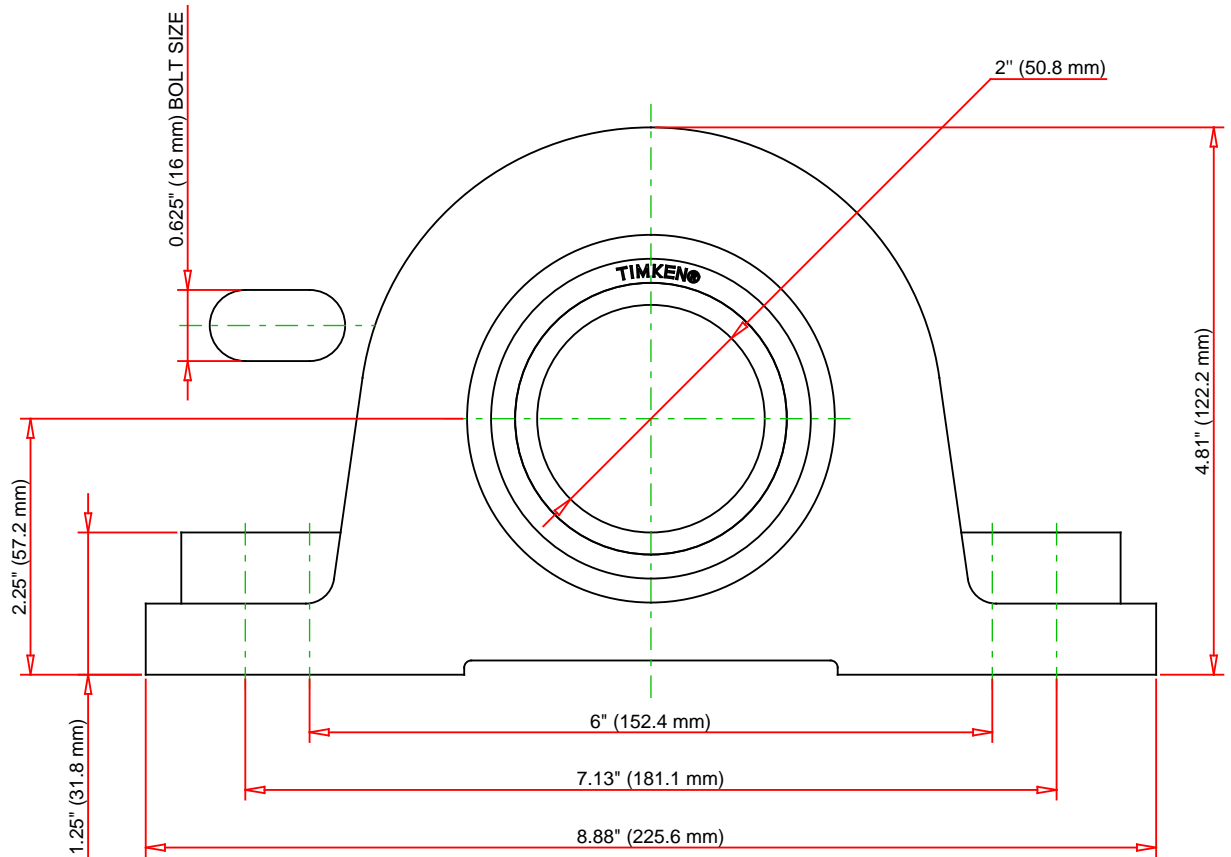
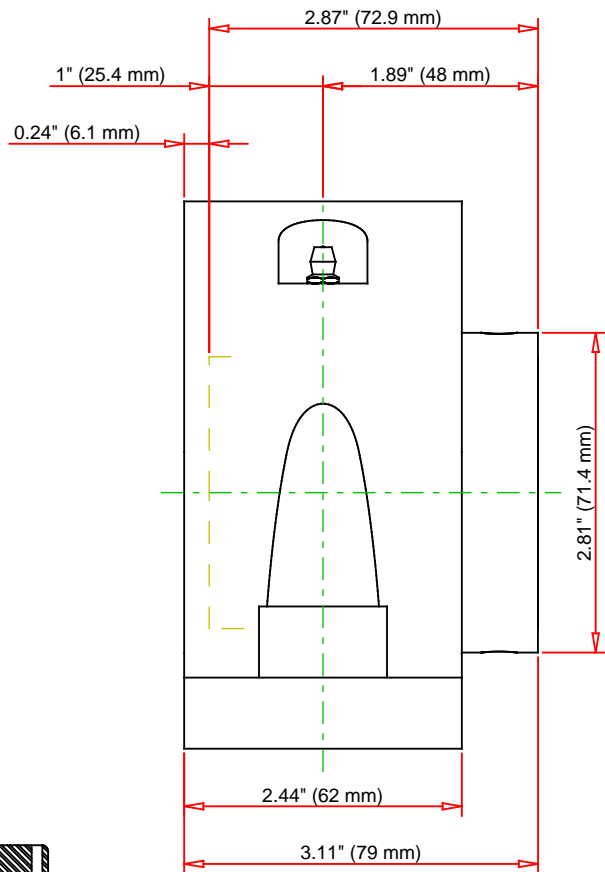

Note: Section View not to Scale

C - Dynamic Load	26300	lbf	117000	N
C0 - Static Load	26600	lbf	118000	N
Weight	13	lb	5.9	kg
Max. Speed T-Seals & Grease	3550	rpm		
Rad. Clearance - Max.	0.0026			

TIMKEN

THE TIMKEN COMPANY
NORTH CANTON, OHIO USA

QMP10J200S
Eccentric Two-Bolt Pillow Block

Every reasonable effort has been made to ensure the accuracy of the information contained in this writing, but no liability is accepted for errors, omissions or for any other reason.

FOR DISCUSSION ONLY