



The Timken Company

4500 Mt Pleasant St. NW

N. Canton, OH 44720

Phone: (234) 262-3000

E-Mail: CustomerCAD@timken.com • **Web site:** www.timken.com

Part Number QAFL18A307S, Single Concentric Four Bolt Square Flange Block

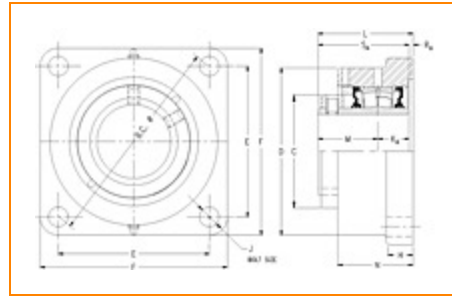

[Specifications](#) | [Dimensions](#) | [Radial and Thrust Factors](#) | [Engineering Seal Speed](#) | [Engineering Bearing Attributes](#) | [Engineering Internal Radial Clearance](#)

Specifications

Engineering Group Mounted Bearing

Bearing Number 22213

Shaft Size 3 7/16 in

Shaft Size Type Imperial

Full Timken Part Number

QAFL18A307SB
 QAFL18A307SBT
 QAFL18A307SC
 QAFL18A307SEB
 QAFL18A307SEC
 QAFL18A307SEM
 QAFL18A307SEMNP
 QAFL18A307SEN
 QAFL18A307SEO
 QAFL18A307SET
 QAFL18A307SM



QAFL18A307SMNP
 QAFL18A307SN
 QAFL18A307SO
 QAFL18A307ST
 QAFL18A307STNG

Locking Style Single Concentric

Housing Construction Four-Bolt Square Flange

UPC Code

0883450040600
 0883450040617
 0883450040631
 0883450040648
 0883450040655
 0883450040662
 0883450040679
 0883450040686
 0883450191395
 0883450191555
 0883450268752
 0883450268912
 0883450459198
 0883450492584
 0883450492607
 0883450959308

Dimensions

Dimension BC

9.5 in
 241.3 mm

Dimension C

5.13 in
 130.3 mm

Dimension D

7.63 in
 193.8 mm

Dimension E

6.72 in
 170.7 mm

Dimension F

8.38 in
 212.9 mm

Dimension H	1.28 in 32.5 mm
Dimension J (Bolt Size)	0.75 in 20 mm
Dimension KA	1.44 in 36.6 mm
Dimension L Exp	4.27 in 108.5 mm
Dimension L Fix	4.19 in 106.4 mm
Dimension M	2.59 in 65.8 mm
Dimension N	3.4 in 86.4 mm
Dimension RA	0.16 in 4.1 mm
Dimension SA	4.03 in 102.4 mm

Radial and Thrust Factors

C0 - Static Load	48600 lbf 216000 N
C - Dynamic Load (Basic)	46400 lbf 206000 N
e - Geometry Factor	0.25
Y1 - Geometry Factor	2.69
Y2 - Geometry Factor	4.00

Engineering Seal Speed

Oil Lubrication - M/N Seal	1800 rpm
Oil Lubrication - T Seal	3200 rpm
Oil Lubrication - B/C/O Seal	1500 rpm
Grease Lubrication - M/N Seal	1800 rpm
Grease Lubrication - T Seal	2800 rpm
Grease Lubrication - B/C/O Seal	1500 rpm

Engineering Bearing Attributes

Float	0.083 in 2.108 mm
Shaft Tolerance	0.0015 in 0.038 mm

Engineering Internal Radial Clearance

Eng Internal Radial Clearance - Min	0.0016
Eng Internal Radial Clearance - Max	0.0026
Pre Install Clearance Min	0.0024 in 0.060 mm
Pre Install Clearance Max	0.0039 in 0.100 mm

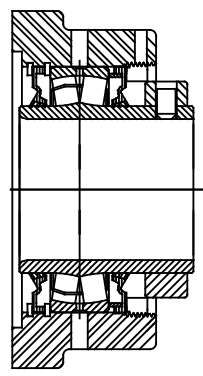
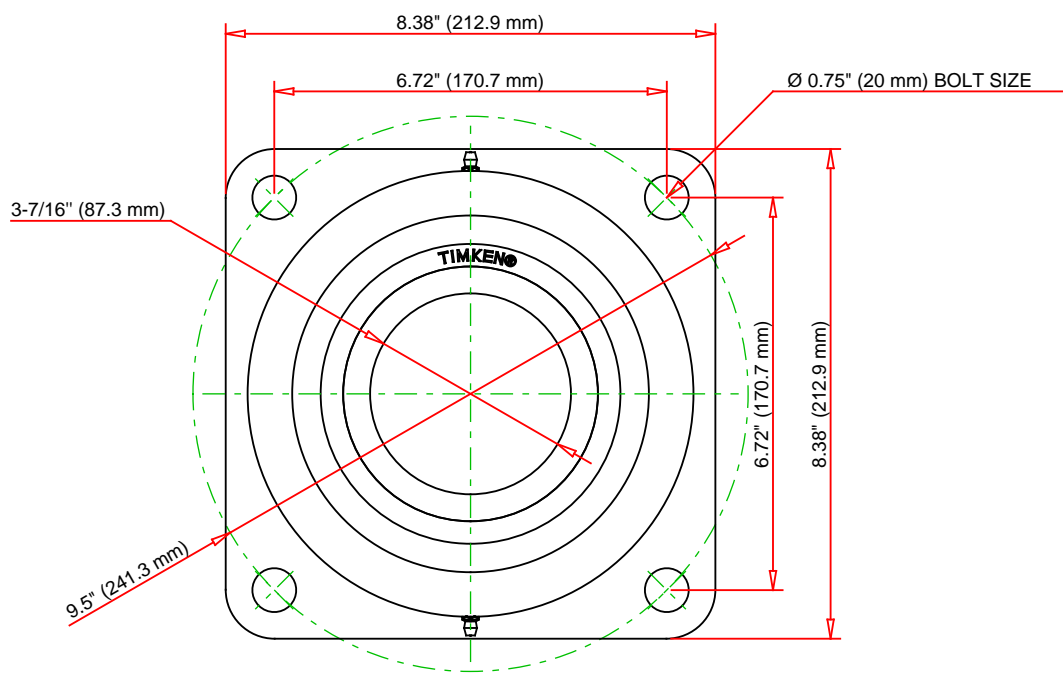
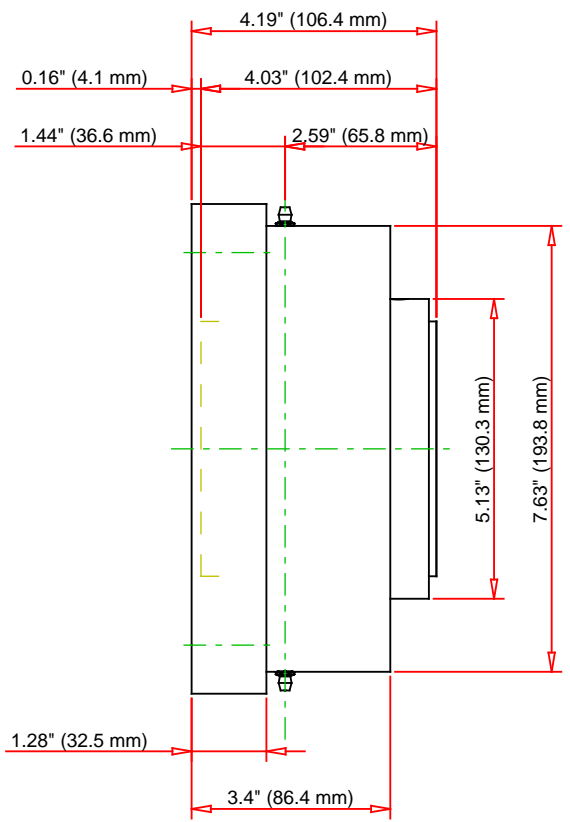

Note: Section View not to Scale

C - Dynamic Load	46400	lbf	206000	N
C0 - Static Load	48600	lbf	216000	N
Weight	35	lb	15.9	kg
Max. Speed T-Seals & Grease	2800	rpm		
Rad. Clearance - Max.	0.0026			

TIMKEN
 THE TIMKEN COMPANY
 NORTH CANTON, OHIO USA

QAFL18A307S
 Single Concentric Four Bolt Square
 Flange Block

Every reasonable effort has been made to ensure the accuracy of the information contained in this writing, but no liability is accepted for errors, omissions or for any other reason.

FOR DISCUSSION ONLY