

The Timken Company

4500 Mt Pleasant St. NW

N. Canton, OH 44720

Phone: (234) 262-3000

E-Mail: CustomerCAD@timken.com • **Web site:** www.timken.com

Part Number QACW09A111S, Single Concentric Piloted Flange Cartridge



[Specifications](#) | [Dimensions](#) | [Radial and Thrust Factors](#) | [Engineering Seal Speed](#) | [Engineering Bearing Attributes](#) | [Engineering Internal Radial Clearance](#)

Specifications

Engineering Group Mounted Bearing

Bearing Number 22209

Shaft Size 1 11/16 in

Shaft Size Type Imperial

Full Timken Part Number

- QACW09A111SB
- QACW09A111SC
- QACW09A111SEB
- QACW09A111SEC
- QACW09A111SEM
- QACW09A111SEN
- QACW09A111SEO
- QACW09A111SET
- QACW09A111SM
- QACW09A111SN
- QACW09A111SO
- QACW09A111ST



Locking Style	Single Concentric
----------------------	-------------------

Housing Construction	Piloted Flange Cartridge
-----------------------------	--------------------------

UPC Code	883450965453
	883450965460
	883450965477
	883450965484
	883450965491
	883450965507
	883450970839
	883450970846
	883450970853
	883450970860
883450970877	
883450970884	

Dimensions

Dimension BC	5.13 in 130.3 mm
---------------------	---------------------

Dimension B Exp	1.58 in 40.1 mm
------------------------	--------------------

Dimension B Fix	1.53 in 38.9 mm
------------------------	--------------------

Dimension C	2.63 in 66.8 mm
--------------------	--------------------

Dimension D	4.38 in 111.3 mm
--------------------	---------------------

Dimension E	3.62 in 91.9 mm
--------------------	--------------------

Dimension F	6.13 in 155.7 mm
--------------------	---------------------

Dimension G	4.25 in 108 mm
--------------------	-------------------

Dimension H	0.4 in 10.2 mm
Dimension J (Bolt Size)	0.438 in 10 mm
Dimension KA	1 in 25.4 mm
Dimension L Exp	3.08 in 78.2 mm
Dimension L Fix	3.03 in 77 mm
Dimension M	1.88 in 47.8 mm
Dimension N	1.5 in 38.1 mm
Dimension RA	0.15 in 3.8 mm
Dimension SA	2.88 in 73.2 mm

Radial and Thrust Factors

C0 - Static Load	24200 lbf 108000 N
C - Dynamic Load (Basic)	24500 lbf 109000 N
e - Geometry Factor	0.26
Y1 - Geometry Factor	2.64
Y2 - Geometry Factor	3.93

Engineering Seal Speed

Oil Lubrication - M/N Seal	2700 rpm
-----------------------------------	----------

Oil Lubrication - T Seal	4500 rpm
---------------------------------	----------

Oil Lubrication - B/C/O Seal	1950 rpm
-------------------------------------	----------

Grease Lubrication - M/N Seal	2700 rpm
--------------------------------------	----------

Grease Lubrication - T Seal	4000 rpm
------------------------------------	----------

Grease Lubrication - B/C/O Seal	1950 rpm
--	----------

Engineering Bearing Attributes

Float	0.050 in 1.270 mm
--------------	----------------------

Shaft Tolerance	0.0015 in 0.038 mm
------------------------	-----------------------

Engineering Internal Radial Clearance

Eng Internal Radial Clearance - Min	0.0014
--	--------

Eng Internal Radial Clearance - Max	0.0022
--	--------

Pre Install Clearance Min	0.0014 in 0.035 mm
----------------------------------	-----------------------

Pre Install Clearance Max	0.0022 in 0.055 mm
----------------------------------	-----------------------

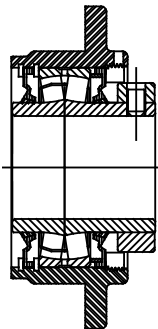
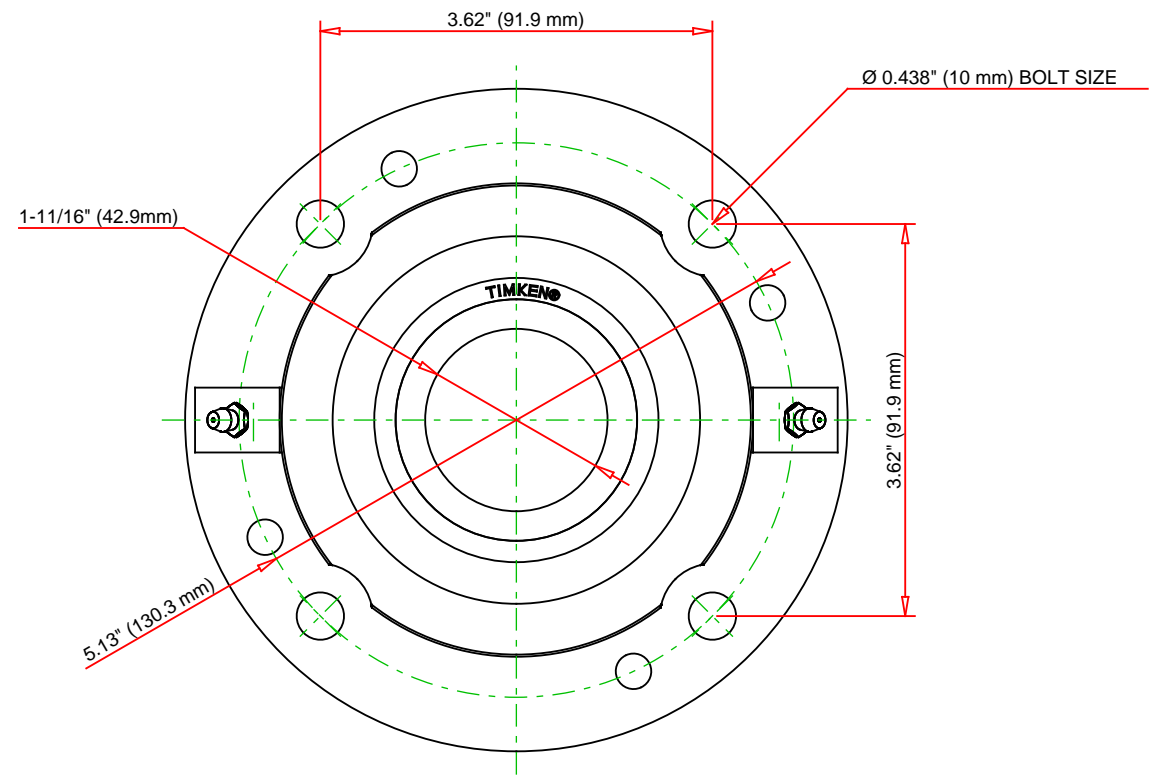
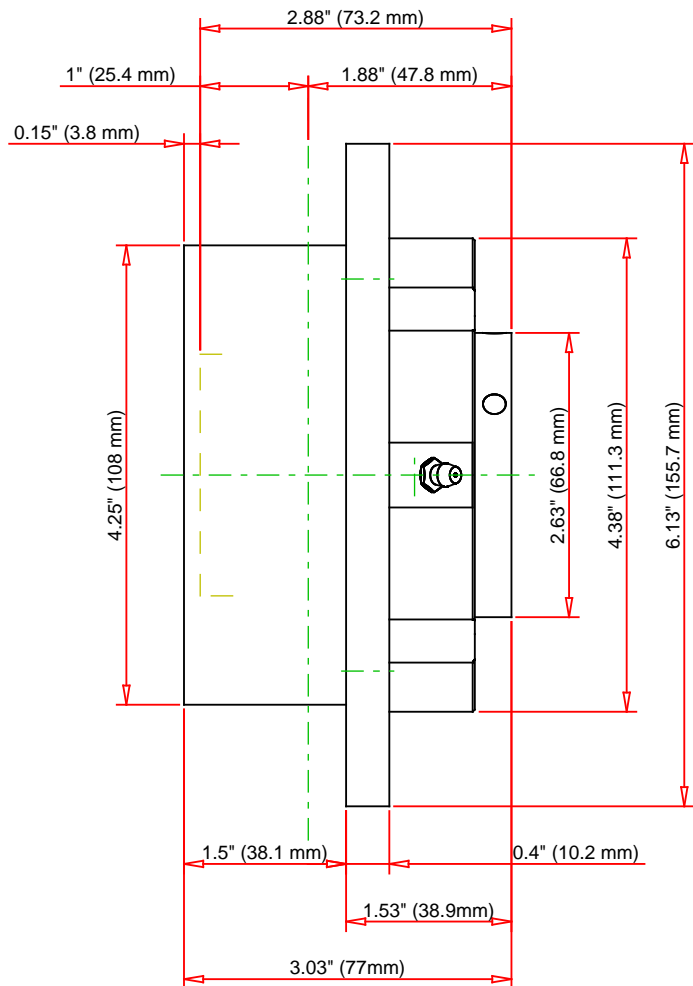

Note: Section View not to Scale

C - Dynamic Load	24500	lbf	109000	N
C0 - Static Load	24200	lbf	108000	N
Weight	9	lb	4.1	kg
Max. Speed T-Seals & Grease	4000	rpm		
Rad. Clearance - Max.	0.0022			

TIMKEN
THE TIMKEN COMPANY
NORTH CANTON, OHIO USA

QACW09A111S
Single Concentric Piloted Flange
Cartridge

Every reasonable effort has been made to ensure the accuracy of the information contained in this writing, but no liability is accepted for errors, omissions or for any other reason.

FOR DISCUSSION ONLY