

**The Timken Company**

4500 Mt Pleasant St. NW

N. Canton, OH 44720

**Phone:** (234) 262-3000

**E-Mail:** [CustomerCAD@timken.com](mailto:CustomerCAD@timken.com) • **Web site:** [www.timken.com](http://www.timken.com)

## Part Number QACW09A112S, Single Concentric Piloted Flange Cartridge



[Specifications](#) | [Dimensions](#) | [Radial and Thrust Factors](#) | [Engineering Seal Speed](#) | [Engineering Bearing Attributes](#) | [Engineering Internal Radial Clearance](#)

## Specifications

<b>Engineering Group</b>	Mounted Bearing
<b>Bearing Number</b>	22209
<b>Shaft Size</b>	1 3/4 in
<b>Shaft Size Type</b>	Imperial
<b>Full Timken Part Number</b>	QACW09A112SB QACW09A112SC QACW09A112SEB QACW09A112SEC QACW09A112SEM QACW09A112SEN QACW09A112SEO QACW09A112SET QACW09A112SM QACW09A112SN QACW09A112SO QACW09A112ST



<b>Locking Style</b>	Single Concentric
----------------------	-------------------

<b>Housing Construction</b>	Piloted Flange Cartridge
-----------------------------	--------------------------

<b>UPC Code</b>	883450965514
	883450965521
	883450965538
	883450965545
	883450965552
	883450965569
	883450965576
	883450965583
	883450965590
	883450965606
883450965613	
883450965620	

## Dimensions

<b>Dimension BC</b>	5.13 in 130.3 mm
---------------------	---------------------

<b>Dimension B Exp</b>	1.58 in 40.1 mm
------------------------	--------------------

<b>Dimension B Fix</b>	1.53 in 38.9 mm
------------------------	--------------------

<b>Dimension C</b>	2.63 in 66.8 mm
--------------------	--------------------

<b>Dimension D</b>	4.38 in 111.3 mm
--------------------	---------------------

<b>Dimension E</b>	3.62 in 91.9 mm
--------------------	--------------------

<b>Dimension F</b>	6.13 in 155.7 mm
--------------------	---------------------

<b>Dimension G</b>	4.25 in 108 mm
--------------------	-------------------

<b>Dimension H</b>	0.4 in 10.2 mm
<b>Dimension J (Bolt Size)</b>	0.438 in 10 mm
<b>Dimension KA</b>	1 in 25.4 mm
<b>Dimension L Exp</b>	3.08 in 78.2 mm
<b>Dimension L Fix</b>	3.03 in 77 mm
<b>Dimension M</b>	1.88 in 47.8 mm
<b>Dimension N</b>	1.5 in 38.1 mm
<b>Dimension RA</b>	0.15 in 3.8 mm
<b>Dimension SA</b>	2.88 in 73.2 mm

## Radial and Thrust Factors

<b>C0 - Static Load</b>	24200 lbf 108000 N
<b>C - Dynamic Load (Basic)</b>	24500 lbf 109000 N
<b>e - Geometry Factor</b>	0.26
<b>Y1 - Geometry Factor</b>	2.64
<b>Y2 - Geometry Factor</b>	3.93

## Engineering Seal Speed

<b>Oil Lubrication - M/N Seal</b>	2700 rpm
-----------------------------------	----------

<b>Oil Lubrication - T Seal</b>	4500 rpm
---------------------------------	----------

<b>Oil Lubrication - B/C/O Seal</b>	1950 rpm
-------------------------------------	----------

<b>Grease Lubrication - M/N Seal</b>	2700 rpm
--------------------------------------	----------

<b>Grease Lubrication - T Seal</b>	4000 rpm
------------------------------------	----------

<b>Grease Lubrication - B/C/O Seal</b>	1950 rpm
--	----------

### Engineering Bearing Attributes

<b>Float</b>	0.050 in 1.270 mm
--------------	----------------------

<b>Shaft Tolerance</b>	0.0015 in 0.038 mm
------------------------	-----------------------

### Engineering Internal Radial Clearance

<b>Eng Internal Radial Clearance - Min</b>	0.0014
--	--------

<b>Eng Internal Radial Clearance - Max</b>	0.0022
--	--------

<b>Pre Install Clearance Min</b>	0.0014 in 0.035 mm
----------------------------------	-----------------------

<b>Pre Install Clearance Max</b>	0.0022 in 0.055 mm
----------------------------------	-----------------------

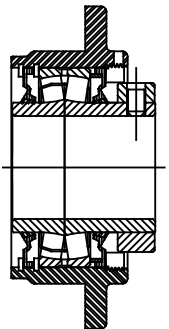
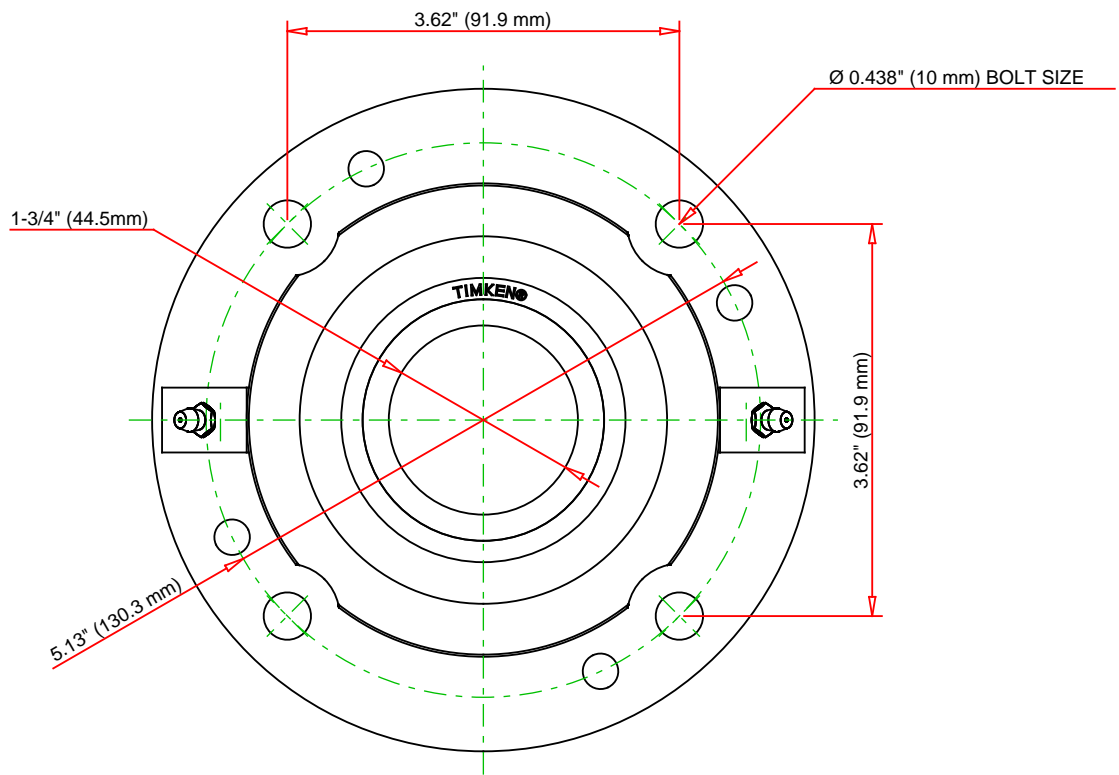
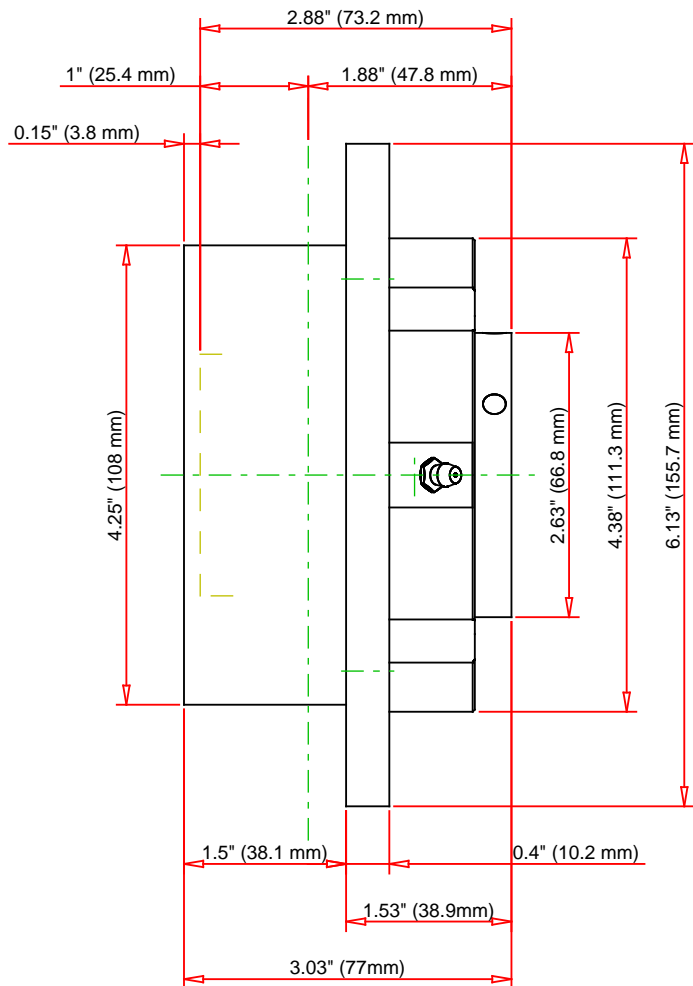

Note: Section View not to Scale

C - Dynamic Load	24500	lbf	109000	N
C0 - Static Load	24200	lbf	108000	N
Weight	9	lb	4.1	kg
Max. Speed T-Seals & Grease	4000	rpm		
Rad. Clearance - Max.	0.0022			

**TIMKEN**  
 THE TIMKEN COMPANY  
 NORTH CANTON, OHIO USA

**QACW09A112S**  
 Single Concentric Piloted Flange  
 Cartridge

Every reasonable effort has been made to ensure the accuracy of the information contained in this writing, but no liability is accepted for errors, omissions or for any other reason.

**FOR DISCUSSION ONLY**