

**The Timken Company**

4500 Mt Pleasant St. NW

N. Canton, OH 44720

**Phone:** (234) 262-3000

**E-Mail:** [CustomerCAD@timken.com](mailto:CustomerCAD@timken.com) • **Web site:** [www.timken.com](http://www.timken.com)

## Part Number QACW09A045S, Single Concentric Piloted Flange Cartridge



[Specifications](#) | [Dimensions](#) | [Radial and Thrust Factors](#) | [Engineering Seal Speed](#) | [Engineering Bearing Attributes](#) | [Engineering Internal Radial Clearance](#)

## Specifications

<b>Engineering Group</b>	Mounted Bearing
<b>Bearing Number</b>	22209
<b>Shaft Size</b>	45 mm
<b>Shaft Size Type</b>	Metric
<b>Full Timken Part Number</b>	QACW09A045SB QACW09A045SC QACW09A045SEB QACW09A045SEC QACW09A045SEM QACW09A045SEN QACW09A045SEO QACW09A045SET QACW09A045SM QACW09A045SN QACW09A045SO QACW09A045ST



<b>Locking Style</b>	Single Concentric
----------------------	-------------------

<b>Housing Construction</b>	Piloted Flange Cartridge
-----------------------------	--------------------------

<b>UPC Code</b>	883450970716
	883450970723
	883450970730
	883450970747
	883450970754
	883450970761
	883450970778
	883450970785
	883450970792
	883450970808
883450970815	
883450970822	

## Dimensions

<b>Dimension BC</b>	5.13 in 130.3 mm
---------------------	---------------------

<b>Dimension B Exp</b>	1.58 in 40.1 mm
------------------------	--------------------

<b>Dimension B Fix</b>	1.53 in 38.9 mm
------------------------	--------------------

<b>Dimension C</b>	2.63 in 66.8 mm
--------------------	--------------------

<b>Dimension D</b>	4.38 in 111.3 mm
--------------------	---------------------

<b>Dimension E</b>	3.62 in 91.9 mm
--------------------	--------------------

<b>Dimension F</b>	6.13 in 155.7 mm
--------------------	---------------------

<b>Dimension G</b>	4.25 in 108 mm
--------------------	-------------------

<b>Dimension H</b>	0.4 in 10.2 mm
<b>Dimension J (Bolt Size)</b>	0.438 in 10 mm
<b>Dimension KA</b>	1 in 25.4 mm
<b>Dimension L Exp</b>	3.08 in 78.2 mm
<b>Dimension L Fix</b>	3.03 in 77 mm
<b>Dimension M</b>	1.88 in 47.8 mm
<b>Dimension N</b>	1.5 in 38.1 mm
<b>Dimension RA</b>	0.15 in 3.8 mm
<b>Dimension SA</b>	2.88 in 73.2 mm

## Radial and Thrust Factors

<b>C0 - Static Load</b>	24200 lbf 108000 N
<b>C - Dynamic Load (Basic)</b>	24500 lbf 109000 N
<b>e - Geometry Factor</b>	0.26
<b>Y1 - Geometry Factor</b>	2.64
<b>Y2 - Geometry Factor</b>	3.93

## Engineering Seal Speed

<b>Oil Lubrication - M/N Seal</b>	2700 rpm
-----------------------------------	----------

<b>Oil Lubrication - T Seal</b>	4500 rpm
---------------------------------	----------

<b>Oil Lubrication - B/C/O Seal</b>	1950 rpm
-------------------------------------	----------

<b>Grease Lubrication - M/N Seal</b>	2700 rpm
--------------------------------------	----------

<b>Grease Lubrication - T Seal</b>	4000 rpm
------------------------------------	----------

<b>Grease Lubrication - B/C/O Seal</b>	1950 rpm
--	----------

### Engineering Bearing Attributes

<b>Float</b>	0.050 in 1.270 mm
--------------	----------------------

<b>Shaft Tolerance</b>	0.0015 in 0.038 mm
------------------------	-----------------------

### Engineering Internal Radial Clearance

<b>Eng Internal Radial Clearance - Min</b>	0.0014
--	--------

<b>Eng Internal Radial Clearance - Max</b>	0.0022
--	--------

<b>Pre Install Clearance Min</b>	0.0014 in 0.035 mm
----------------------------------	-----------------------

<b>Pre Install Clearance Max</b>	0.0022 in 0.055 mm
----------------------------------	-----------------------

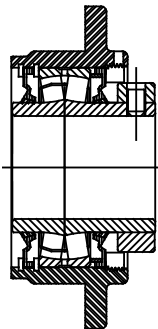
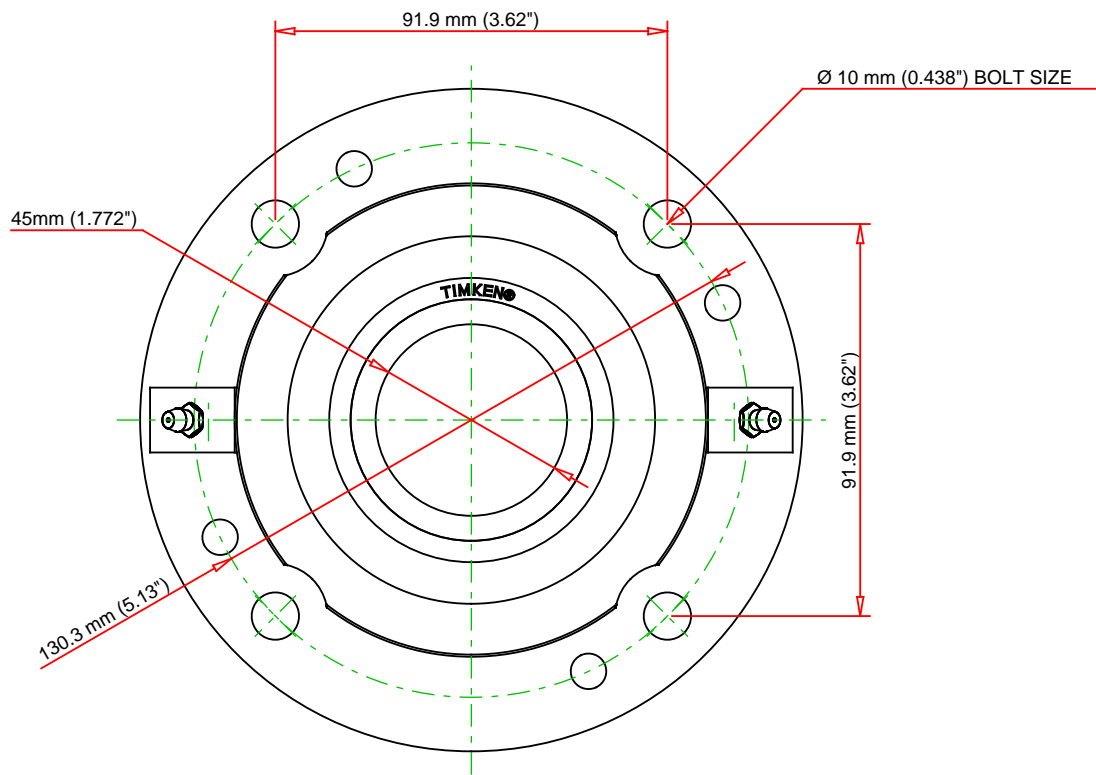
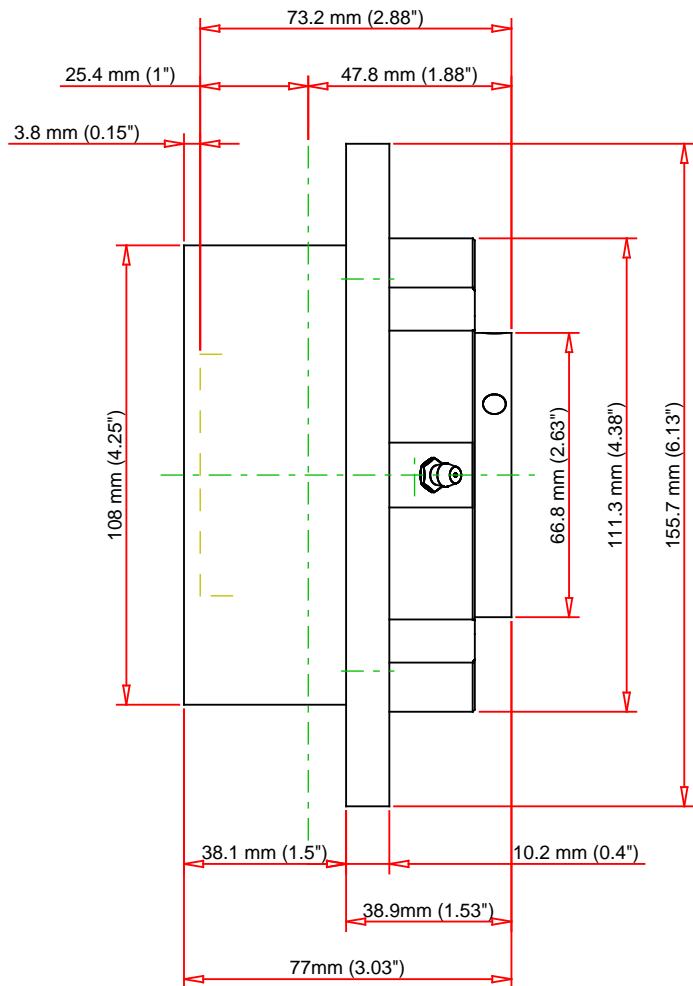

Note: Section View not to Scale

C - Dynamic Load	24500	lbf	109000	N
C0 - Static Load	24200	lbf	108000	N
Weight	9	lb	4.1	kg
Max. Speed T-Seals & Grease	4000	rpm		
Rad. Clearance - Max.	0.0022			

**TIMKEN**

THE TIMKEN COMPANY  
NORTH CANTON, OHIO USA

**QACW09A045S**  
Single Concentric Piloted Flange  
Cartridge

Every reasonable effort has been made to ensure the accuracy of the information contained in this writing, but no liability is accepted for errors, omissions or for any other reason.

**FOR DISCUSSION ONLY**