

The Timken Company

4500 Mt Pleasant St. NW

N. Canton, OH 44720

Phone: (234) 262-3000

E-Mail: CustomerCAD@timken.com • **Web site:** www.timken.com

Part Number QAF08A108S, Single Concentric Four Bolt Square Flange Block



[Specifications](#) | [Dimensions](#) | [Radial and Thrust Factors](#) | [Engineering Seal Speed](#) | [Engineering Bearing Attributes](#) | [Engineering Internal Radial Clearance](#)

Specifications

Engineering Group	Mounted Bearing
Bearing Number	22210
Shaft Size	1 1/2 in
Shaft Size Type	Imperial
Full Timken Part Number	QAF08A108SB QAF08A108SC QAF08A108SEB QAF08A108SEC QAF08A108SEM QAF08A108SEN QAF08A108SEO QAF08A108SET QAF08A108SM QAF08A108SN QAF08A108SO



QAF08A108ST

Locking Style Single Concentric

Housing Construction Four-Bolt Square Flange

UPC Code

0883450037808
0883450037815
0883450037839
0883450037846
0883450037853
0883450037860
0883450037877
0883450037884
0883450190640
0883450190800
0883450268004
0883450268165

Dimensions

Dimension BC 5.84 in
148.3 mm

Dimension C 2.38 in
60.5 mm

Dimension D 4.25 in
108 mm

Dimension E 4.13 in
104.9 mm

Dimension F 5.38 in
136.7 mm

Dimension H 0.88 in
22.4 mm

Dimension J (Bolt Size) 0.5 in
12 mm

Dimension KA 1 in
25.4 mm

Dimension L Exp	2.98 in 75.7 mm
------------------------	--------------------

Dimension L Fix	2.9 in 73.7 mm
------------------------	-------------------

Dimension M	1.75 in 44.5 mm
--------------------	--------------------

Dimension N	2.34 in 59.4 mm
--------------------	--------------------

Dimension RA	0.15 in 3.8 mm
---------------------	-------------------

Dimension SA	2.75 in 69.9 mm
---------------------	--------------------

Radial and Thrust Factors

C0 - Static Load	26600 lbf 118000 N
-------------------------	-----------------------

C - Dynamic Load (Basic)	26300 lbf 117000 N
---------------------------------	-----------------------

e - Geometry Factor	0.25
----------------------------	------

Y1 - Geometry Factor	2.71
-----------------------------	------

Y2 - Geometry Factor	4.04
-----------------------------	------

Engineering Seal Speed

Oil Lubrication - M/N Seal	2400 rpm
-----------------------------------	----------

Oil Lubrication - T Seal	4200 rpm
---------------------------------	----------

Oil Lubrication - B/C/O Seal	1800 rpm
-------------------------------------	----------

Grease Lubrication - M/N Seal	2400 rpm
--------------------------------------	----------

Grease Lubrication - T Seal	3550 rpm
------------------------------------	----------

Grease Lubrication - B/C/O Seal	1800 rpm
--	----------

Engineering Bearing Attributes

Float	0.050 in 1.270 mm
--------------	----------------------

Shaft Tolerance	0.0015 in 0.038 mm
------------------------	-----------------------

Engineering Internal Radial Clearance

Eng Internal Radial Clearance - Min	0.0016
--	--------

Eng Internal Radial Clearance - Max	0.0026
--	--------

Pre Install Clearance Min	0.0016 in 0.040 mm
----------------------------------	-----------------------

Pre Install Clearance Max	0.0026 in 0.065 mm
----------------------------------	-----------------------

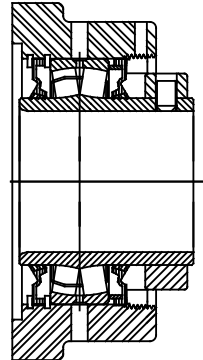
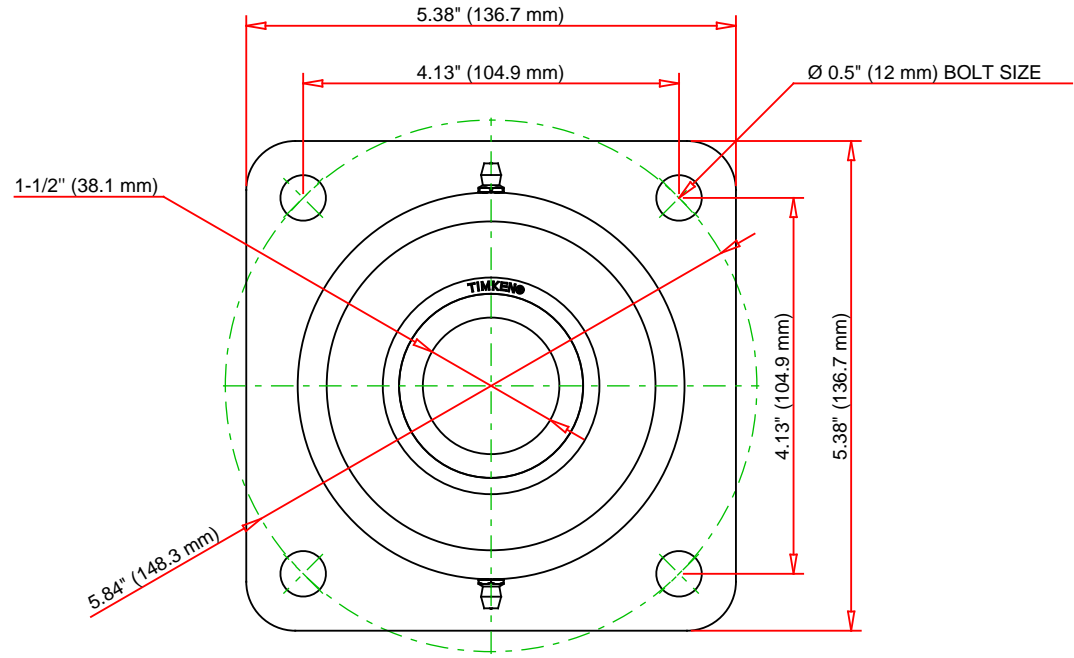
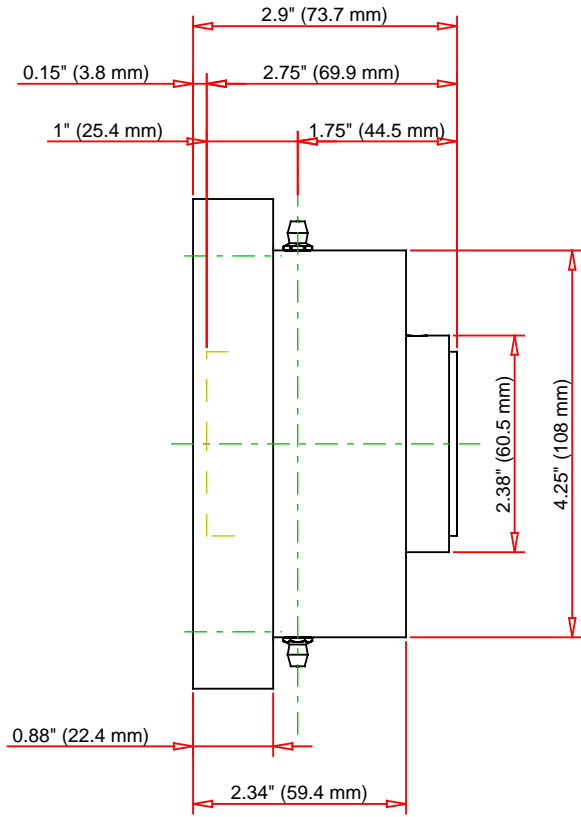

Note: Section View not to Scale

C - Dynamic Load	26300	lbf	117000	N
C0 - Static Load	26600	lbf	118000	N
Weight	10	lb	4.5	kg
Max. Speed T-Seals & Grease	3550	rpm		
Rad. Clearance - Max.	0.0026			

TIMKEN

THE TIMKEN COMPANY
NORTH CANTON, OHIO USA

QAF08A108S

Single Concentric Four Bolt Square
Flange Block

Every reasonable effort has been made to ensure the accuracy of the information contained in this writing, but no liability is accepted for errors, omissions or for any other reason.

FOR DISCUSSION ONLY