

The Timken Company

4500 Mt Pleasant St. NW

N. Canton, OH 44720

Phone: (234) 262-3000

E-Mail: CustomerCAD@timken.com • **Web site:** www.timken.com

Part Number QMTP10J200S, Eccentric Top Pull Take-Up Block



[Specifications](#) | [Dimensions](#) | [Radial and Thrust Factors](#) | [Engineering Seal Speed](#) | [Engineering Bearing Attributes](#) | [Engineering Internal Radial Clearance](#)

Specifications

Engineering Group Mounted Bearing

Bearing Number 22210

Shaft Size 2 in

Shaft Size Type Imperial

Full Timken Part Number

QMTP10J200SB
 QMTP10J200SC
 QMTP10J200SEB
 QMTP10J200SEC
 QMTP10J200SEM
 QMTP10J200SEN
 QMTP10J200SEO
 QMTP10J200SET
 QMTP10J200SM
 QMTP10J200SN
 QMTP10J200SO



QMTP10J200ST
QMTP10J200STNP

Locking Style

Eccentric

Housing Construction

Top Pull Take-Up

Dimensions**Dimension A1**

2.81 in
71.4 mm

Dimension B

2.38 in
60.5 mm

Dimension C

2.81 in
71.4 mm

Dimension D

6.44 in
163.6 mm

Dimension E

5.19 in
131.8 mm

Dimension F

1.66 in
42.2 mm

Dimension G

2.47 in
62.7 mm

Dimension H

3.06 in
77.8 mm

Dimension J

1.65 in
41.9 mm

Dimension K

0.98 in
24.9 mm

Dimension L

6-1/2 in
165.1 mm

Dimension M

1.89 in
48 mm

Dimension N	3.12 in 79.3 mm
Dimension P	6 in 152.4 mm
Dimension Q	0.81 in 20.6 mm
Dimension R	0.25 in 6.4 mm
Dimension S	0.88 in 22.4 mm
Dimension T	2.87 in 72.9 mm
Dimension U	0.81 in 20.6 mm

Radial and Thrust Factors

C0 - Static Load	26600 lbf 118000 N
C - Dynamic Load (Basic)	26300 lbf 117000 N
e - Geometry Factor	0.24
Y1 - Geometry Factor	2.84
Y2 - Geometry Factor	4.23

Engineering Seal Speed

Oil Lubrication - M/N Seal	2400 rpm
Oil Lubrication - T Seal	4200 rpm
Oil Lubrication - B/C/O Seal	1800 rpm

Grease Lubrication - M/N Seal	2400 rpm
--------------------------------------	----------

Grease Lubrication - T Seal	3550 rpm
------------------------------------	----------

Grease Lubrication - B/C/O Seal	1800 rpm
--	----------

Engineering Bearing Attributes

Float	0.050 in 1.270 mm
--------------	----------------------

Shaft Tolerance	0.0015 in 0.038 mm
------------------------	-----------------------

Engineering Internal Radial Clearance

Eng Internal Radial Clearance - Min	0.0016
--	--------

Eng Internal Radial Clearance - Max	0.0026
--	--------

Pre Install Clearance Min	0.0016 in 0.040 mm
----------------------------------	-----------------------

Pre Install Clearance Max	0.0026 in 0.065 mm
----------------------------------	-----------------------

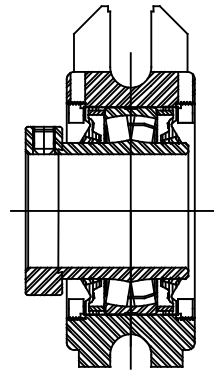
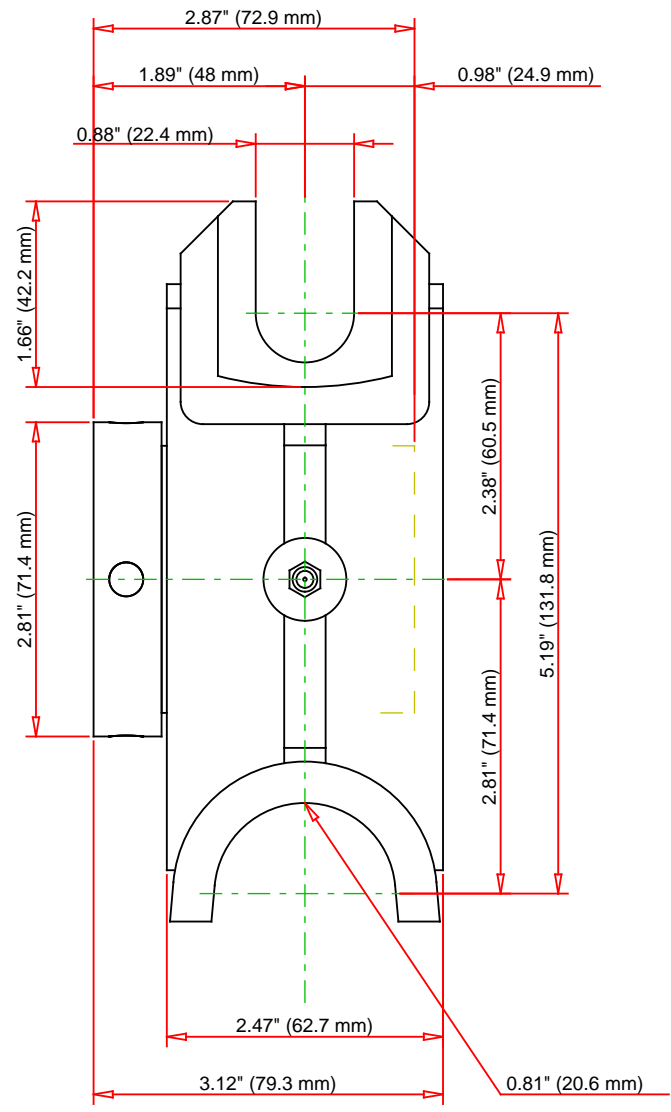
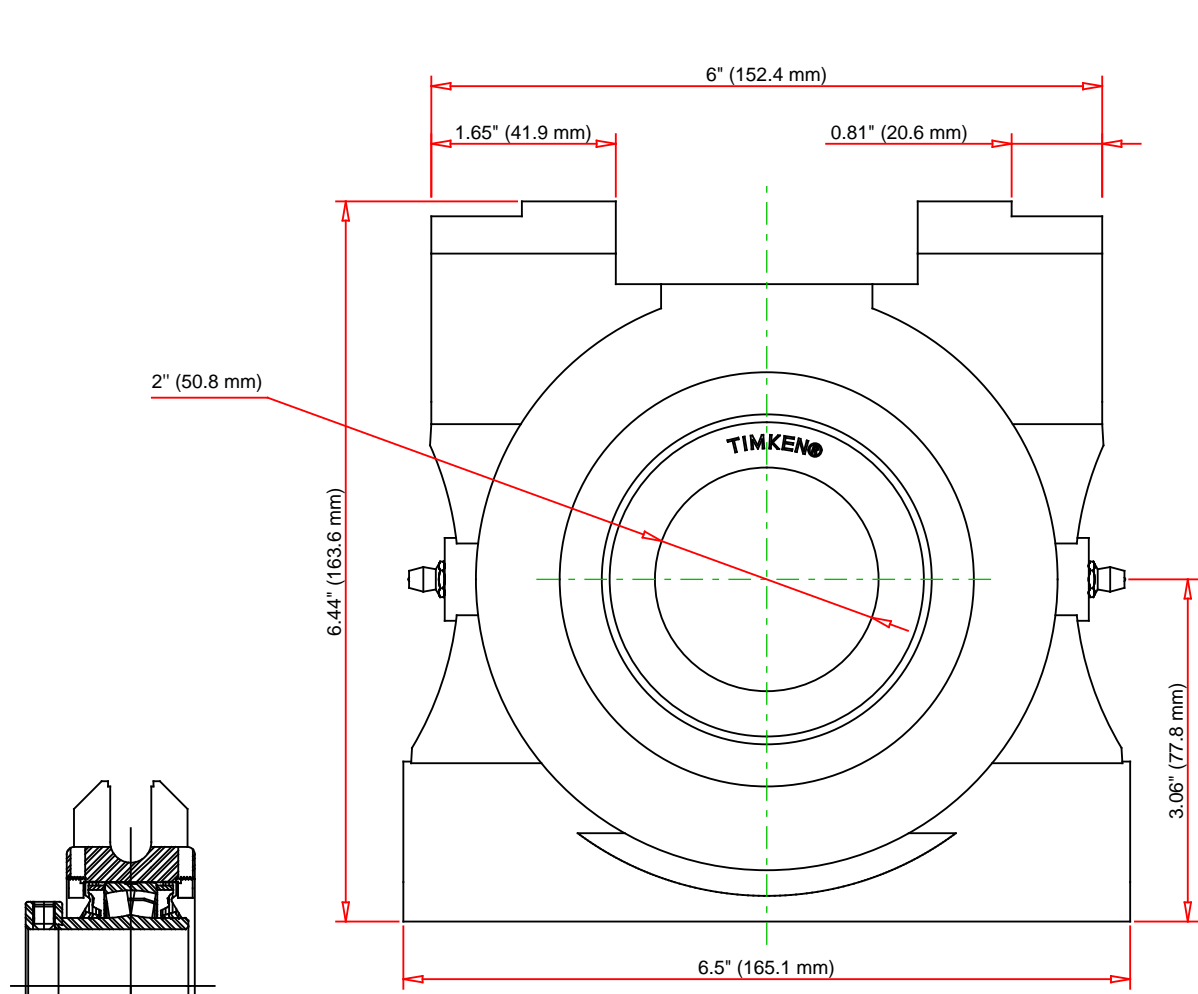

Note: Section View not to Scale

C - Dynamic Load	26300	lbf	117000	N
C0 - Static Load	26600	lbf	118000	N
Weight		lb		kg
Max. Speed T-Seals & Grease	3550	rpm		
Rad. Clearance - Max.	0.0026			

TIMKEN
THE TIMKEN COMPANY
NORTH CANTON, OHIO USA

QMP10J200S
Eccentric Top Pull Take-Up Block

Every reasonable effort has been made to ensure the accuracy of the information contained in this writing, but no liability is accepted for errors, omissions or for any other reason.

FOR DISCUSSION ONLY