



The Timken Company

4500 Mt Pleasant St. NW

N. Canton, OH 44720

Phone: (234) 262-3000

E-Mail: CustomerCAD@timken.com • **Web site:** www.timken.com

Part Number QATP20A315S, Single Concentric Top Pull Take-Up Block

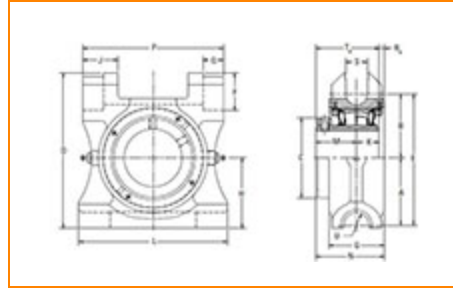

[Specifications](#) | [Dimensions](#) | [Radial and Thrust Factors](#) | [Engineering Seal Speed](#) | [Engineering Bearing Attributes](#) | [Engineering Internal Radial Clearance](#)

Specifications -

Engineering Group	Mounted Bearing
Bearing Number	22220
Shaft Size	3 15/16 in
Shaft Size Type	Imperial
Full Timken Part Number	QATP20A315SB QATP20A315SC QATP20A315SEB QATP20A315SEC QATP20A315SEM QATP20A315SEN QATP20A315SEO QATP20A315SET QATP20A315SM QATP20A315SN QATP20A315SO



QATP20A315ST

Locking Style Single Concentric**Housing Construction** Top Pull Take-Up**Dimensions****Dimension A1**4.76 in
121 mm**Dimension B**4.63 in
117.6 mm**Dimension C**6 in
152.4 mm**Dimension D**11.38 in
289.1 mm**Dimension E**9.25 in
234.9 mm**Dimension F**2.5 in
63.5 mm**Dimension G**3.13 in
79.5 mm**Dimension H**5.5 in
139.7 mm**Dimension J**2.31 in
58.7 mm**Dimension K**1.63 in
41.3 mm**Dimension L**11 in
279.4 mm**Dimension M**2.97 in
75.4 mm

Dimension N	4.97 in 126.1 mm
Dimension P	10.5 in 266.7 mm
Dimension Q	1.31 in 33.3 mm
Dimension RA	0.37 in 9.4 mm
Dimension S	1.38 in 35.1 mm
Dimension TA	4.59 in 116.7 mm
Dimension U	0.81 in 20.6 mm

Radial and Thrust Factors

C0 - Static Load	113000 lbf 502000 N
C - Dynamic Load (Basic)	97700 lbf 435000 N
e - Geometry Factor	0.24
Y1 - Geometry Factor	2.85
Y2 - Geometry Factor	4.24

Engineering Seal Speed

Oil Lubrication - M/N Seal	1200 rpm
Oil Lubrication - T Seal	2000 rpm
Oil Lubrication - B/C/O Seal	900 rpm

Grease Lubrication - M/N Seal	1200 rpm
--------------------------------------	----------

Grease Lubrication - T Seal	1600 rpm
------------------------------------	----------

Grease Lubrication - B/C/O Seal	900 rpm
--	---------

Engineering Bearing Attributes

Float	0.08 in 2.03 mm
--------------	--------------------

Shaft Tolerance	0.0030 in 0.076 mm
------------------------	-----------------------

Engineering Internal Radial Clearance

Eng Internal Radial Clearance - Min	0.0030
--	--------

Eng Internal Radial Clearance - Max	0.0047
--	--------

Pre Install Clearance Min	0.0030 in 0.075 mm
----------------------------------	-----------------------

Pre Install Clearance Max	0.0047 in 0.120 mm
----------------------------------	-----------------------

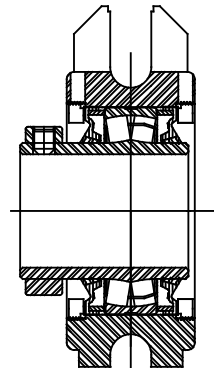
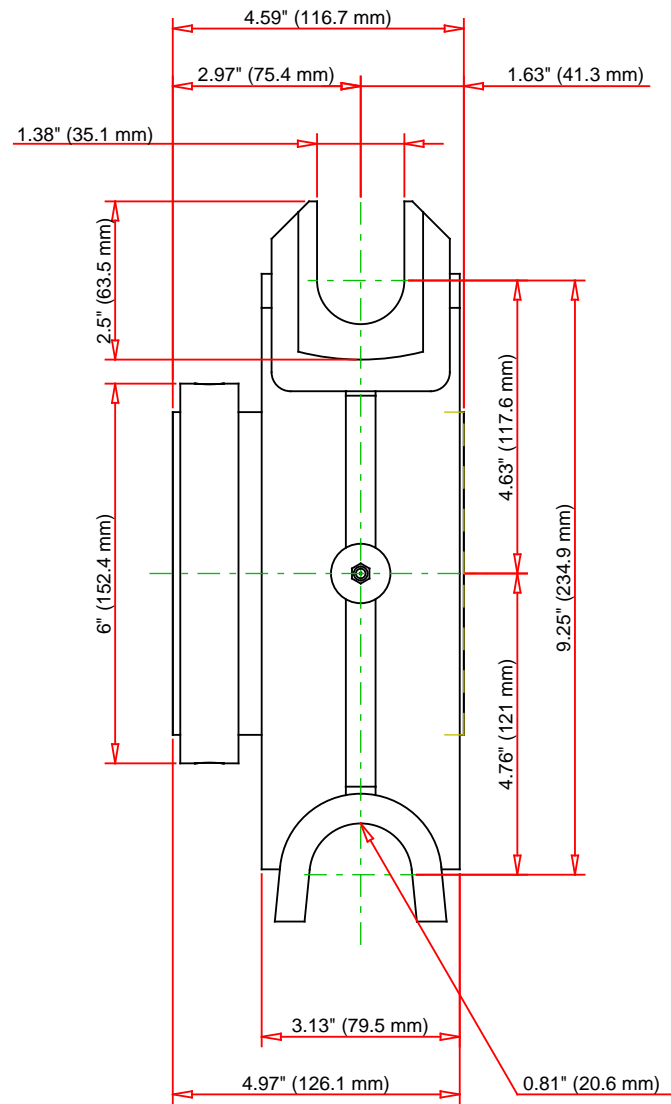
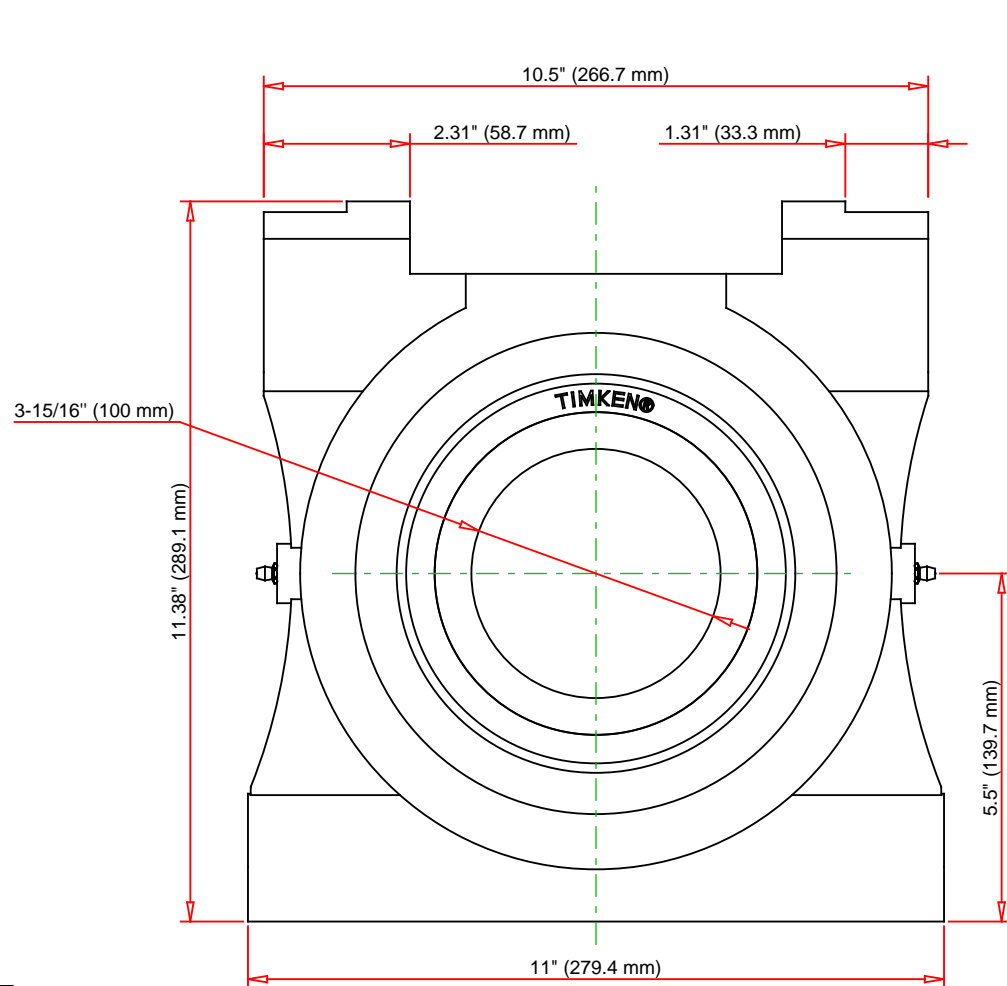

Note: Section View not to Scale

C - Dynamic Load	97700	lbf	435000	N
C0 - Static Load	113000	lbf	502000	N
Weight		lb		kg
Max. Speed T-Seals & Grease	1600	rpm		
Rad. Clearance - Max.	0.0047			

TIMKEN

THE TIMKEN COMPANY
NORTH CANTON, OHIO USA

QATP20A315S
Single Concentric Top Pull Take-Up
Block

Every reasonable effort has been made to ensure the accuracy of the information contained in this writing, but no liability is accepted for errors, omissions or for any other reason.

FOR DISCUSSION ONLY