



The Timken Company

4500 Mt Pleasant St. NW

N. Canton, OH 44720

Phone: (234) 262-3000

E-Mail: CustomerCAD@timken.com • **Web site:** www.timken.com

Part Number QAAPF18A307S, Double Concentric Four-Bolt Pillow Block

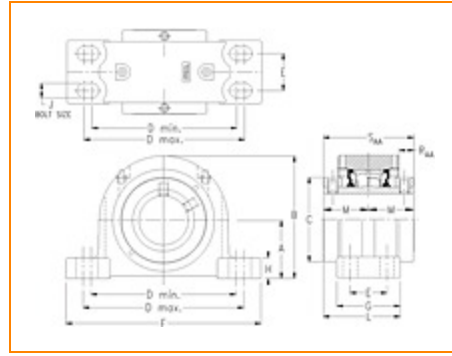
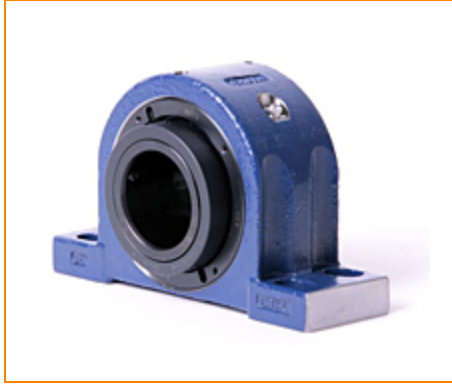

[Specifications](#) | [Dimensions](#) | [Radial and Thrust Factors](#) | [Engineering Seal Speed](#) | [Engineering Bearing Attributes](#) | [Engineering Internal Radial Clearance](#)

Specifications

Engineering Group Mounted Bearing

Bearing Number 22218

Shaft Size 3 7/16 in

Shaft Size Type Imperial

Full Timken Part Number

- QAAPF18A307SB
- QAAPF18A307SC
- QAAPF18A307SEB
- QAAPF18A307SEC
- QAAPF18A307SEM
- QAAPF18A307SEN
- QAAPF18A307SEO
- QAAPF18A307SET
- QAAPF18A307SEHT
- QAAPF18A307SM



QAAPF18A307SN
 QAAPF18A307SNHT
 QAAPF18A307SO
 QAAPF18A307ST
 QAAPF18A307STHT

Locking Style Double Concentric

Housing Construction Four-Bolt Pillow Block

UPC Code

0883450027502
 0883450027519
 0883450027533
 0883450027540
 0883450027557
 0883450027564
 0883450027571
 0883450027588
 0883450189545
 0883450189675
 0883450266888
 0883450267021
 0883450432948
 0883450494243
 0883450494366

Dimensions

Dimension A

3-3/4 in
 95.3 mm

Dimension B

7.69 in
 195.3 mm

Dimension C

5.13 in
 130.3 mm

Dimension D Min

8.88 in
 225.6 mm

Dimension D Max

10.88 in
 276.4 mm

Dimension E	2 in 50.8 mm
Dimension F	12.3 in 312.4 mm
Dimension G	3.75 in 95.3 mm
Dimension H	1.56 in 39.6 mm
Dimension J (Bolt Size)	0.755 in 20 mm
Dimension L	4.47 in 113.5 mm
Dimension M	2.59 in 65.8 mm
Dimension RAA	0.84 in 21.3 mm
Dimension SAA	5.18 in 131.6 mm

Radial and Thrust Factors

C0 - Static Load	87200 lbf 388000 N
C - Dynamic Load (Basic)	79700 lbf 355000 N
e - Geometry Factor	0.23
Y1 - Geometry Factor	2.90
Y2 - Geometry Factor	4.31

Engineering Seal Speed

Oil Lubrication - M/N Seal	1400 rpm
Oil Lubrication - T Seal	2400 rpm
Oil Lubrication - B/C/O Seal	1000 rpm
Grease Lubrication - M/N Seal	1400 rpm
Grease Lubrication - T Seal	2000 rpm
Grease Lubrication - B/C/O Seal	1000 rpm

Engineering Bearing Attributes

Float	0.083 in 2.108 mm
Shaft Tolerance	0.0030 in 0.076 mm

Engineering Internal Radial Clearance

Eng Internal Radial Clearance - Min	0.0024
Eng Internal Radial Clearance - Max	0.0039
Pre Install Clearance Min	0.0024 in 0.060 mm
Pre Install Clearance Max	0.0039 in 0.100 mm

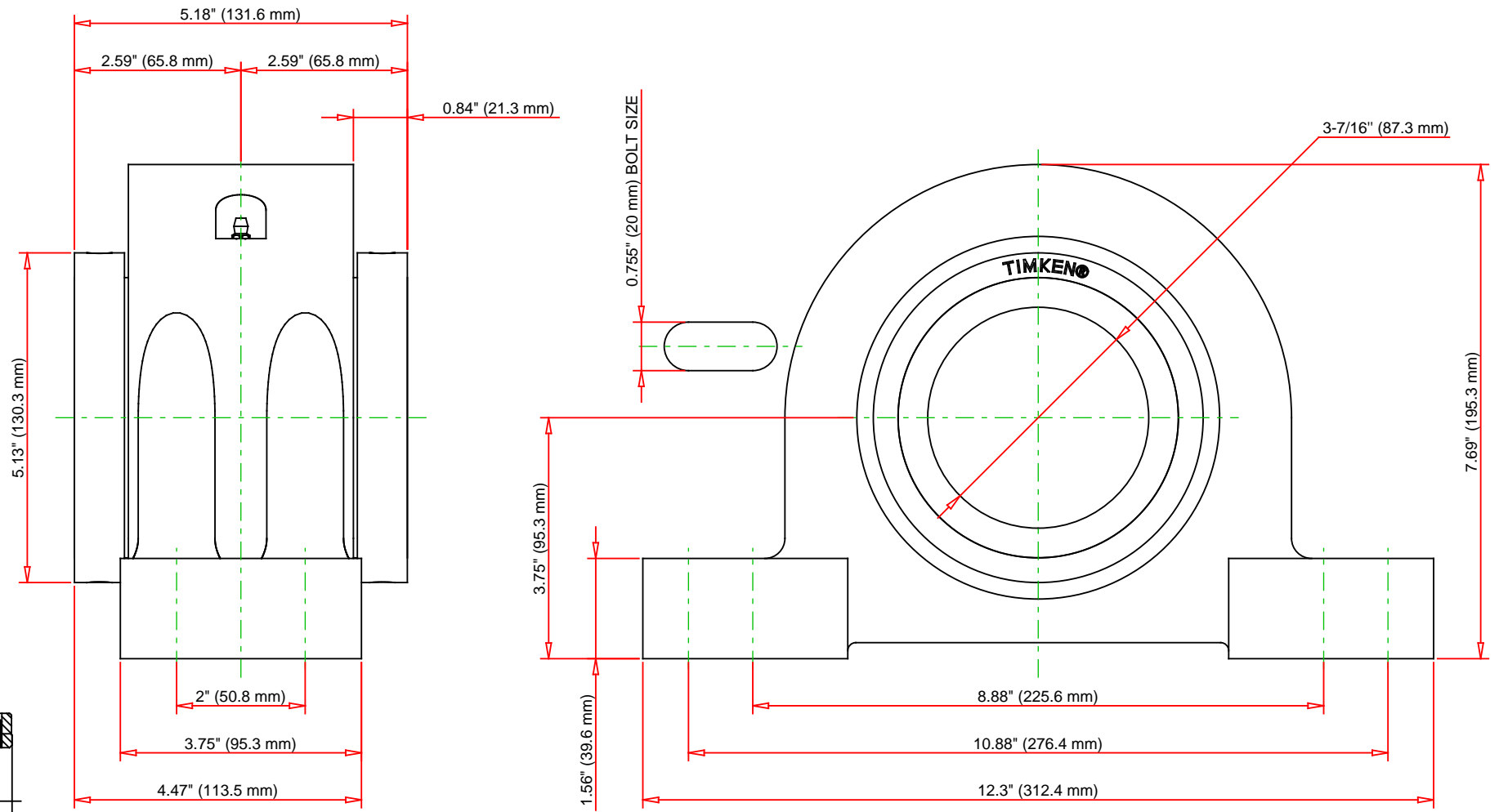

Note: Section View not to Scale

C - Dynamic Load	79700	lbf	355000	N
C0 - Static Load	87200	lbf	388000	N
Weight	49	lb	22.2	kg
Max. Speed T-Seals & Grease	2000	rpm		
Rad. Clearance - Max.	0.0039			

TIMKEN

THE TIMKEN COMPANY
NORTH CANTON, OHIO USA

QAAPF18A307S

Double Concentric Four-Bolt Pillow
Block

Every reasonable effort has been made to ensure the accuracy of the information contained in this writing, but no liability is accepted for errors, omissions or for any other reason.

FOR DISCUSSION ONLY