

The Timken Company

4500 Mt Pleasant St. NW

N. Canton, OH 44720

Phone: (234) 262-3000

E-Mail: CustomerCAD@timken.com • **Web site:** www.timken.com

Part Number QAACW26A500S, Double Concentric Piloted Flange Cartridge



[Specifications](#) | [Dimensions](#) | [Radial and Thrust Factors](#) | [Engineering Seal Speed](#) | [Engineering Bearing Attributes](#) | [Engineering Internal Radial Clearance](#)

Specifications

Engineering Group Mounted Bearing

Bearing Number 22226

Shaft Size 5 in

Shaft Size Type Imperial

Full Timken Part Number
 QAACW26A500SB
 QAACW26A500SC
 QAACW26A500SEB
 QAACW26A500SEC
 QAACW26A500SEM
 QAACW26A500SEN
 QAACW26A500SEO
 QAACW26A500SET
 QAACW26A500SM
 QAACW26A500SN
 QAACW26A500SO



QAACW26A500ST

Locking Style Double Concentric

Housing Construction Piloted Flange Cartridge

UPC Code

0883450306102
0883450306119
0883450306126
0883450306133
0883450306140
0883450306157
0883450306164
0883450306171
0883450306188
0883450306195
0883450306201
0883450306218

Dimensions

Dimension BC 12-3/4 in
323.9 mm

Dimension C 6.875 in
174.6 mm

Dimension D 10.5 in
266.7 mm

Dimension E 6.38 in
162.1 mm

Dimension B Exp 2.98 in
75.7 mm

Dimension B Fix 2.9 in
73.7 mm

Dimension F 14-3/4 in
374.7 mm

Dimension H 1.03 in
26.2 mm

Dimension J (Bolt Size)	0.875 in 24 mm
Dimension M	3.72 in 94.5 mm
Dimension L Exp	6.04 in 153.4 mm
Dimension L Fix	5.96 in 151.4 mm
Dimension RAA	1.48 in 37.6 mm
Dimension SAA	7.44 in 189 mm
Dimension G	11 in 279.4 mm
Dimension N	3.07 in 78 mm

Radial and Thrust Factors

C0 - Static Load	212000 lbf 945000 N
C - Dynamic Load (Basic)	170000 lbf 757000 N
e - Geometry Factor	0.26
Y1 - Geometry Factor	2.62
Y2 - Geometry Factor	3.9

Engineering Seal Speed

Oil Lubrication - M/N Seal	700 rpm
-----------------------------------	---------

Oil Lubrication - T Seal	1500 rpm
---------------------------------	----------

Oil Lubrication - B/C/O Seal	400 rpm
-------------------------------------	---------

Grease Lubrication - M/N Seal	700 rpm
--------------------------------------	---------

Grease Lubrication - T Seal	1000 rpm
------------------------------------	----------

Grease Lubrication - B/C/O Seal	400 rpm
--	---------

Engineering Bearing Attributes

Float	0.083 in 2.108 mm
--------------	----------------------

Shaft Tolerance	0.0050 in 0.127 mm
------------------------	-----------------------

Engineering Internal Radial Clearance

Eng Internal Radial Clearance - Min	0.0037
--	--------

Eng Internal Radial Clearance - Max	0.0057
--	--------

Pre Install Clearance Min	0.095 in 0.0037 mm
----------------------------------	-----------------------

Pre Install Clearance Max	0.145 in 0.0057 mm
----------------------------------	-----------------------

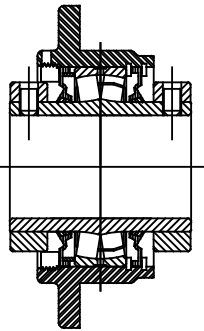
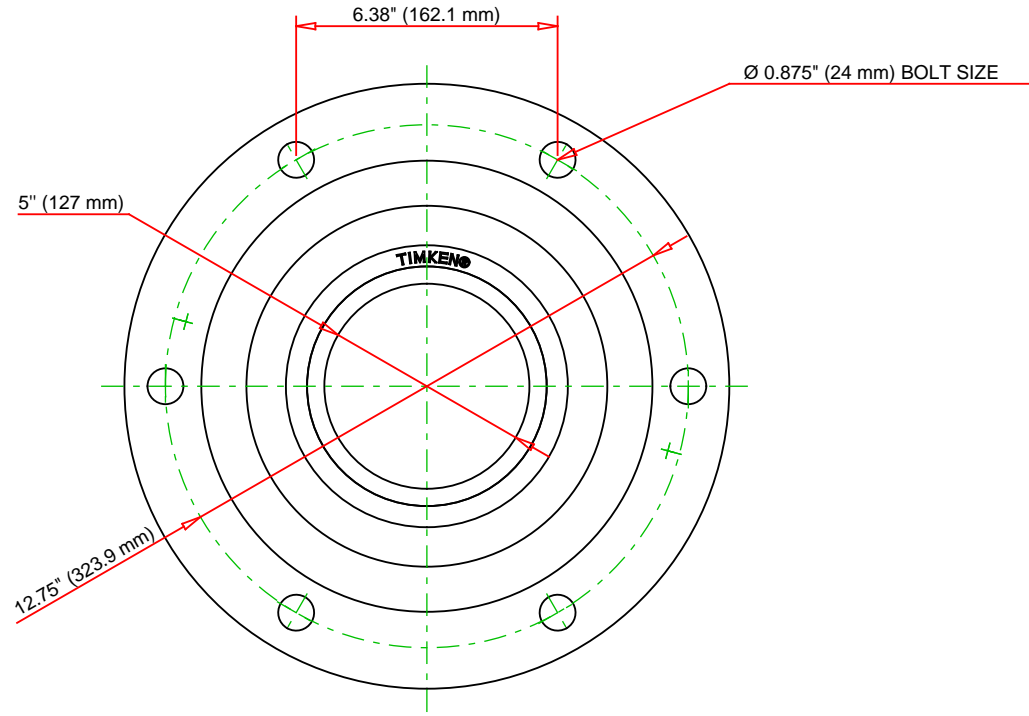
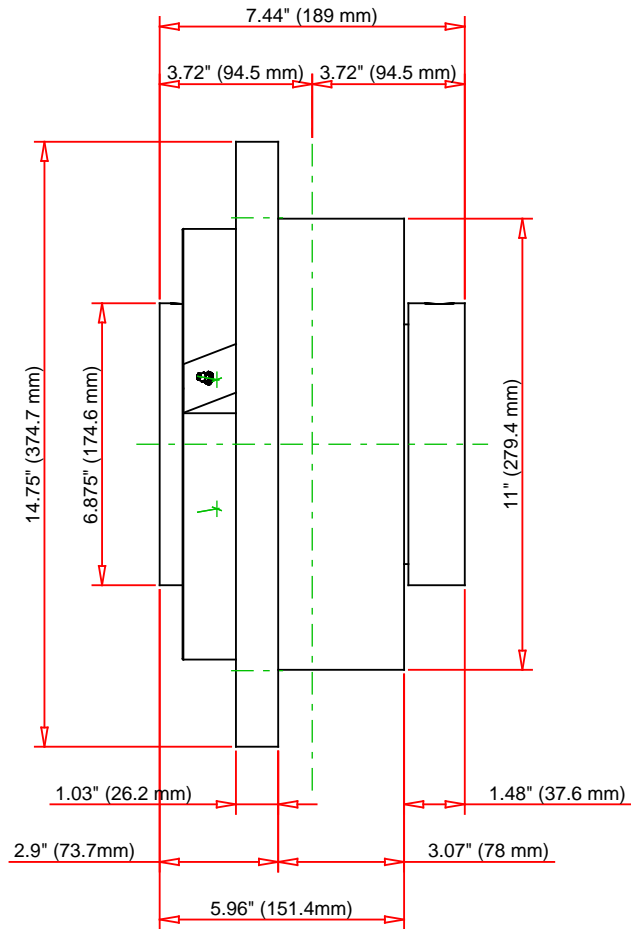

Note: Section View not to Scale

C - Dynamic Load	170000	lbf	757000	N
C0 - Static Load	212000	lbf	945000	N
Weight	102	lb	46.3	kg
Max. Speed T-Seals & Grease	1000	rpm		
Rad. Clearance - Max.	0.0057			

TIMKEN

THE TIMKEN COMPANY
NORTH CANTON, OHIO USA

QAACW26A500S

Double Concentric Piloted Flange
Cartridge

Every reasonable effort has been made to ensure the accuracy of the information contained in this writing, but no liability is accepted for errors, omissions or for any other reason.

FOR DISCUSSION ONLY