



The Timken Company

4500 Mt Pleasant St. NW

N. Canton, OH 44720

Phone: (234) 262-3000

E-Mail: CustomerCAD@timken.com • **Web site:** www.timken.com

Part Number QAAPX20A315S, Double Concentric Four-Bolt Pillow Block

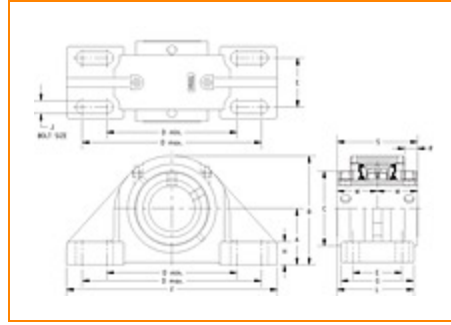
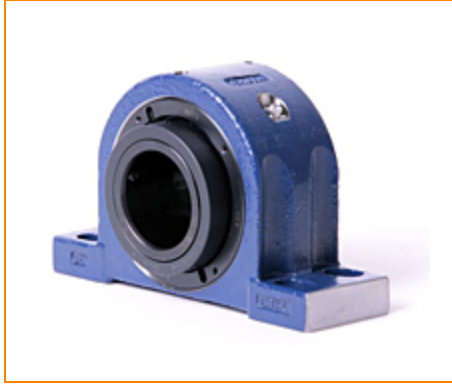

[Specifications](#) | [Dimensions](#) | [Radial and Thrust Factors](#) | [Engineering Seal Speed](#) | [Engineering Bearing Attributes](#) | [Engineering Internal Radial Clearance](#)

Specifications

Engineering Group Mounted Bearing

Bearing Number 22220

Shaft Size 3 15/16 in

Shaft Size Type Imperial

Full Timken Part Number

- QAAPX20A315SB
- QAAPX20A315SC
- QAAPX20A315SEB
- QAAPX20A315SEC
- QAAPX20A315SEM
- QAAPX20A315SEN
- QAAPX20A315SEO
- QAAPX20A315SET
- QAAPX20A315SM
- QAAPX20A315SN
- QAAPX20A315SO
- QAAPX20A315ST



Locking Style	Double Concentric
Housing Construction	Four-Bolt Pillow Block

UPC Code	0883450013710
	0883450013734
	0883450013789
	0883450013796
	0883450013802
	0883450013819
	0883450013826
	0883450013840
	0883450013895
	0883450013901
0883450267717	
0883450267939	

Dimensions

Dimension A	5 in 127 mm
Dimension B	9.44 in 239.8 mm
Dimension C	6 in 152.4 mm
Dimension D Min	12.5 in 317.5 mm
Dimension D Max	14 in 355.6 mm
Dimension E	3.5 in 88.9 mm
Dimension F	16.75 in 425.5 mm
Dimension G	5.5 in 139.7 mm

Dimension H	1.63 in 41.4 mm
--------------------	--------------------

Dimension J (Bolt Size)	0.875 in 24 mm
--------------------------------	-------------------

Dimension L	5.71 in 145 mm
--------------------	-------------------

Dimension M	2.96 in 75.2 mm
--------------------	--------------------

Dimension RAA	1 in 25.4 mm
----------------------	-----------------

Dimension SAA	5.92 in 150.4 mm
----------------------	---------------------

Radial and Thrust Factors

C0 - Static Load	113000 lbf 502000 N
-------------------------	------------------------

C - Dynamic Load (Basic)	97700 lbf 435000 N
---------------------------------	-----------------------

e - Geometry Factor	0.24
----------------------------	------

Y1 - Geometry Factor	2.85
-----------------------------	------

Y2 - Geometry Factor	4.24
-----------------------------	------

Engineering Seal Speed

Oil Lubrication - M/N Seal	1200 rpm
-----------------------------------	----------

Oil Lubrication - T Seal	2000 rpm
---------------------------------	----------

Oil Lubrication - B/C/O Seal	900 rpm
-------------------------------------	---------

Grease Lubrication - M/N Seal	1200 rpm
--------------------------------------	----------

Grease Lubrication - T Seal	1600 rpm
------------------------------------	----------

Grease Lubrication - B/C/O Seal	900 rpm
--	---------

Engineering Bearing Attributes

Float	0.083 in 2.108 mm
--------------	----------------------

Shaft Tolerance	0.0030 in 0.076 mm
------------------------	-----------------------

Engineering Internal Radial Clearance

Eng Internal Radial Clearance - Min	0.0030
--	--------

Eng Internal Radial Clearance - Max	0.0047
--	--------

Pre Install Clearance Min	0.0030 in 0.075 mm
----------------------------------	-----------------------

Pre Install Clearance Max	0.0047 in 0.120 mm
----------------------------------	-----------------------

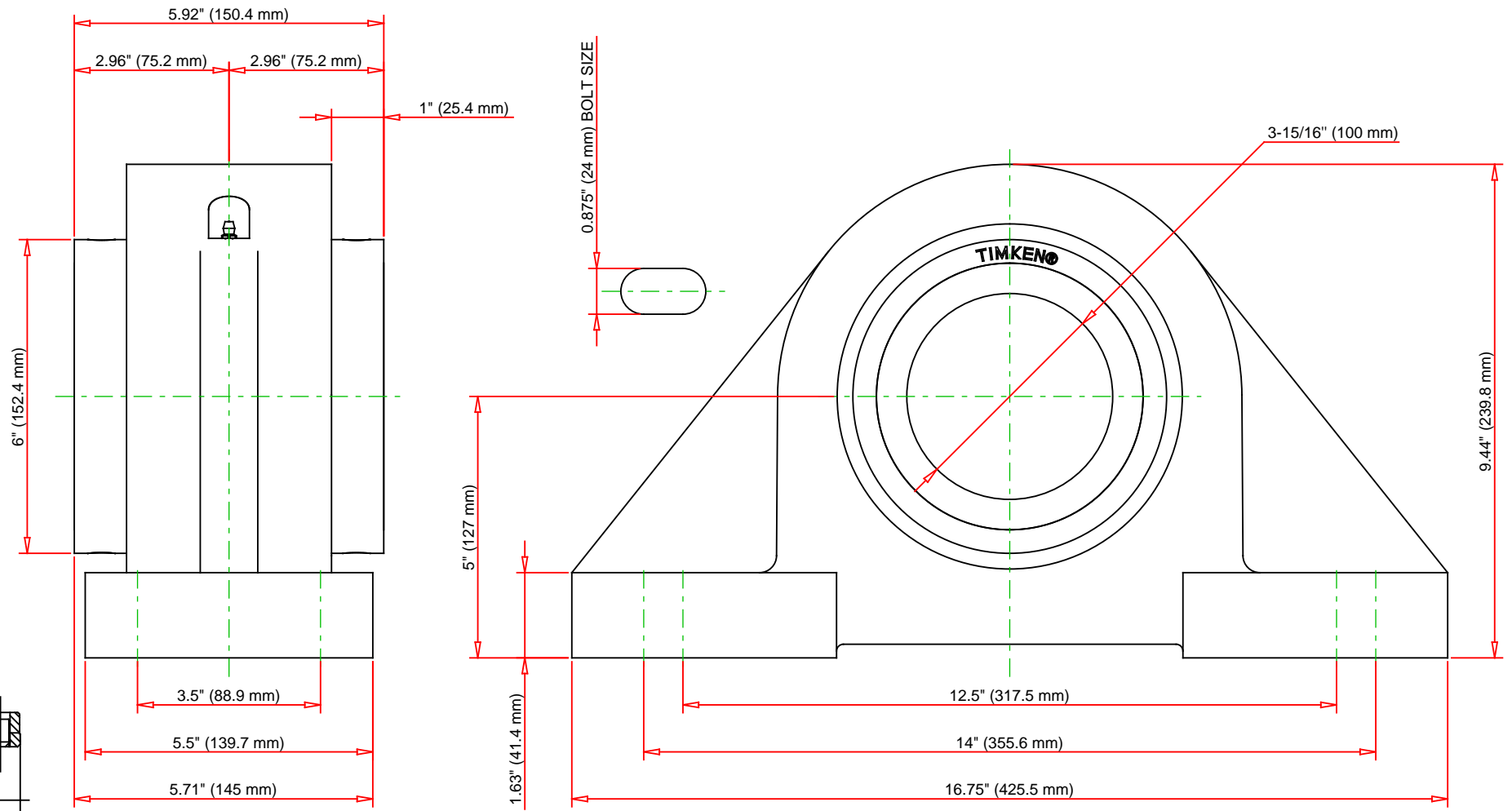

Note: Section View not to Scale

C - Dynamic Load	97700	lbf	435000	N
C0 - Static Load	113000	lbf	502000	N
Weight	99	lb	44.9	kg
Max. Speed T-Seals & Grease	1600	rpm		
Rad. Clearance - Max.	0.0047			

TIMKEN

THE TIMKEN COMPANY
NORTH CANTON, OHIO USA

QAAPX20A315S
Double Concentric Four-Bolt Pillow
Block

Every reasonable effort has been made to ensure the accuracy of the information contained in this writing, but no liability is accepted for errors, omissions or for any other reason.

FOR DISCUSSION ONLY