



The Timken Company

4500 Mt Pleasant St. NW

N. Canton, OH 44720

Phone: (234) 262-3000

E-Mail: CustomerCAD@timken.com • **Web site:** www.timken.com

Part Number QAF11A204S, Single Concentric Four Bolt Square Flange Block

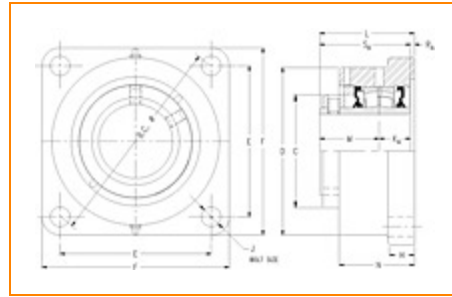

[Specifications](#) | [Dimensions](#) | [Radial and Thrust Factors](#) | [Engineering Seal Speed](#) | [Engineering Bearing Attributes](#) | [Engineering Internal Radial Clearance](#)

Specifications

Engineering Group Mounted Bearing

Bearing Number 22211

Shaft Size 2 1/4 in

Shaft Size Type Imperial

Full Timken Part Number

- QAF11A204SB
- QAF11A204SC
- QAF11A204SEB
- QAF11A204SEC
- QAF11A204SEM
- QAF11A204SEN
- QAF11A204SEO
- QAF11A204SET
- QAF11A204SM
- QAF11A204SN
- QAF11A204SO



QAF11A204ST

Locking Style	Single Concentric
Housing Construction	Four-Bolt Square Flange
UPC Code	0883450038201 0883450038218 0883450038232 0883450038249 0883450038256 0883450038263 0883450038270 0883450038287 0883450190664 0883450190824 0883450268028 0883450268189

Dimensions

Dimension BC	6.89 in 175 mm
Dimension C	3.25 in 82.6 mm
Dimension D	5.13 in 130.3 mm
Dimension E	4.88 in 124 mm
Dimension F	6.19 in 157.2 mm
Dimension H	1 in 25.4 mm
Dimension J (Bolt Size)	0.625 in 16 mm
Dimension KA	1.13 in 28.7 mm

Dimension L Exp	3.35 in 85.1 mm
------------------------	--------------------

Dimension L Fix	3.27 in 83.1 mm
------------------------	--------------------

Dimension M	2 in 50.8 mm
--------------------	-----------------

Dimension N	2.63 in 66.8 mm
--------------------	--------------------

Dimension RA	0.15 in 3.8 mm
---------------------	-------------------

Dimension SA	3.13 in 79.5 mm
---------------------	--------------------

Radial and Thrust Factors

C0 - Static Load	31900 lbf 142000 N
-------------------------	-----------------------

C - Dynamic Load (Basic)	31400 lbf 140000 N
---------------------------------	-----------------------

e - Geometry Factor	0.25
----------------------------	------

Y1 - Geometry Factor	2.74
-----------------------------	------

Y2 - Geometry Factor	4.08
-----------------------------	------

Engineering Seal Speed

Oil Lubrication - M/N Seal	2200 rpm
-----------------------------------	----------

Oil Lubrication - T Seal	3800 rpm
---------------------------------	----------

Oil Lubrication - B/C/O Seal	1600 rpm
-------------------------------------	----------

Grease Lubrication - M/N Seal	2200 rpm
--------------------------------------	----------

Grease Lubrication - T Seal	3200 rpm
------------------------------------	----------

Grease Lubrication - B/C/O Seal	1600 rpm
--	----------

Engineering Bearing Attributes

Float	0.050 in 1.270 mm
--------------	----------------------

Shaft Tolerance	0.0015 in 0.038 mm
------------------------	-----------------------

Engineering Internal Radial Clearance

Eng Internal Radial Clearance - Min	0.0016
--	--------

Eng Internal Radial Clearance - Max	0.0026
--	--------

Pre Install Clearance Min	0.0016 in 0.040 mm
----------------------------------	-----------------------

Pre Install Clearance Max	0.0026 in 0.065 mm
----------------------------------	-----------------------

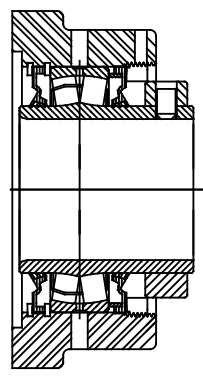
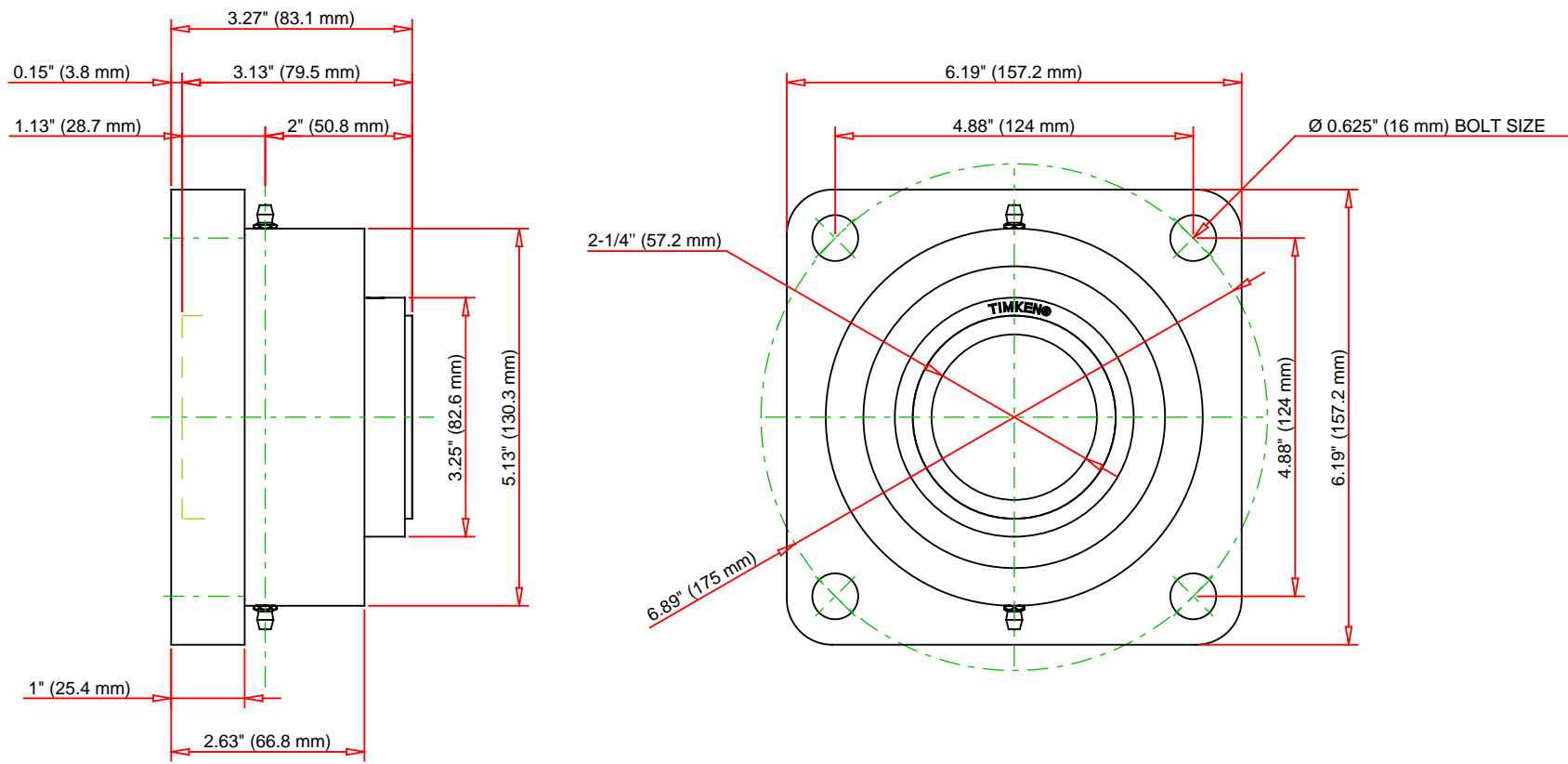

Note: Section View not to Scale

C - Dynamic Load	31400	lbf	140000	N
C0 - Static Load	31900	lbf	142000	N
Weight	14	lb	6.4	kg
Max. Speed T-Seals & Grease	3200	rpm		
Rad. Clearance - Max.	0.0026			

TIMKEN
 THE TIMKEN COMPANY
 NORTH CANTON, OHIO USA

QAF11A204S
 Single Concentric Four Bolt Square
 Flange Block

Every reasonable effort has been made to ensure the accuracy of the information contained in this writing, but no liability is accepted for errors, omissions or for any other reason.

FOR DISCUSSION ONLY