



The Timken Company

4500 Mt Pleasant St. NW

N. Canton, OH 44720

Phone: (234) 262-3000

E-Mail: CustomerCAD@timken.com • **Web site:** www.timken.com

Part Number DVC15K208S, Tapered Adapter Piloted Flange Cartridge

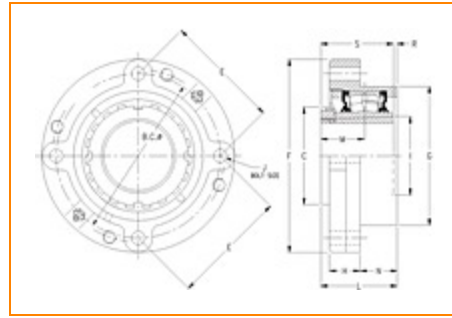

[Specifications](#) | [Dimensions](#) | [Radial and Thrust Factors](#) | [Engineering Seal Speed](#) | [Engineering Bearing Attributes](#) | [Engineering Internal Radial Clearance](#)

Specifications

Engineering Group Mounted Bearing

Bearing Number 22215

Shaft Size 2 1/2 in

Shaft Size Type Imperial

Full Timken Part Number

- DVC15K208SB
- DVC15K208SC
- DVC15K208SEB
- DVC15K208SEC
- DVC15K208SEM
- DVC15K208SEN
- DVC15K208SEO
- DVC15K208SET
- DVC15K208SM
- DVC15K208SN
- DVC15K208SO
- DVC15K208ST



Locking Style	Tapered Adapter
Housing Construction	Piloted Flange Cartridge
UPC Code	0883450004329 0883450004336 0883450004350 0883450004367 0883450004374 0883450004381 0883450004398 0883450004404 0883450196901 0883450197106 0883450274418 0883450274616

Dimensions

Dimension BC	6-1/2 in 165.1 mm
Dimension C	3.86 in 98 mm
Dimension E	4.6 in 116.8 mm
Dimension F	7.63 in 193.8 mm
Dimension G	5.5 in 139.7 mm
Dimension H	1.27 in 32.3 mm
Dimension I	3.11 in 79 mm
Dimension J (Bolt Size)	0.5 in 12 mm

Dimension L	2.75 in 69.9 mm
--------------------	--------------------

Dimension M	1.73 in 43.9 mm
--------------------	--------------------

Dimension N	1.25 in 31.8 mm
--------------------	--------------------

Dimension R	0.14 in 3.6 mm
--------------------	-------------------

Dimension S	2.87 in 72.9 mm
--------------------	--------------------

Radial and Thrust Factors

C0 - Static Load	54100 lbf 240000 N
-------------------------	-----------------------

C - Dynamic Load (Basic)	49900 lbf 222000 N
---------------------------------	-----------------------

e - Geometry Factor	0.22
----------------------------	------

Y1 - Geometry Factor	3.14
-----------------------------	------

Y2 - Geometry Factor	4.67
-----------------------------	------

Engineering Seal Speed

Oil Lubrication - M/N Seal	1600 rpm
-----------------------------------	----------

Oil Lubrication - T Seal	2900 rpm
---------------------------------	----------

Oil Lubrication - B/C/O Seal	1300 rpm
-------------------------------------	----------

Grease Lubrication - M/N Seal	1600 rpm
--------------------------------------	----------

Grease Lubrication - T Seal	2400 rpm
------------------------------------	----------

Grease Lubrication - B/C/O Seal	1300 rpm
--	----------

Engineering Bearing Attributes

Float	0.083 in 2.108 mm
Shaft Tolerance	0.0035 in 0.089 mm

Engineering Internal Radial Clearance

Pre Install Clearance Min	0.0037 in 0.095 mm
Pre Install Clearance Max	0.0047 in 0.120 mm

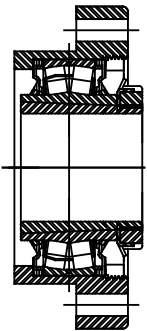
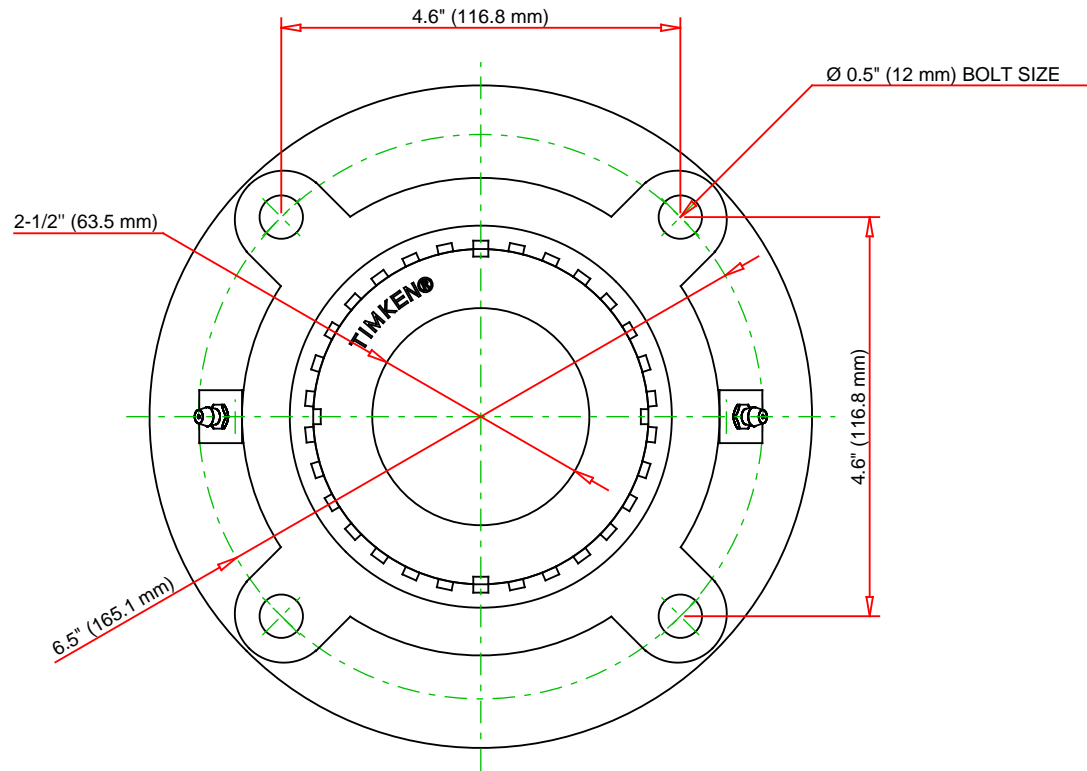
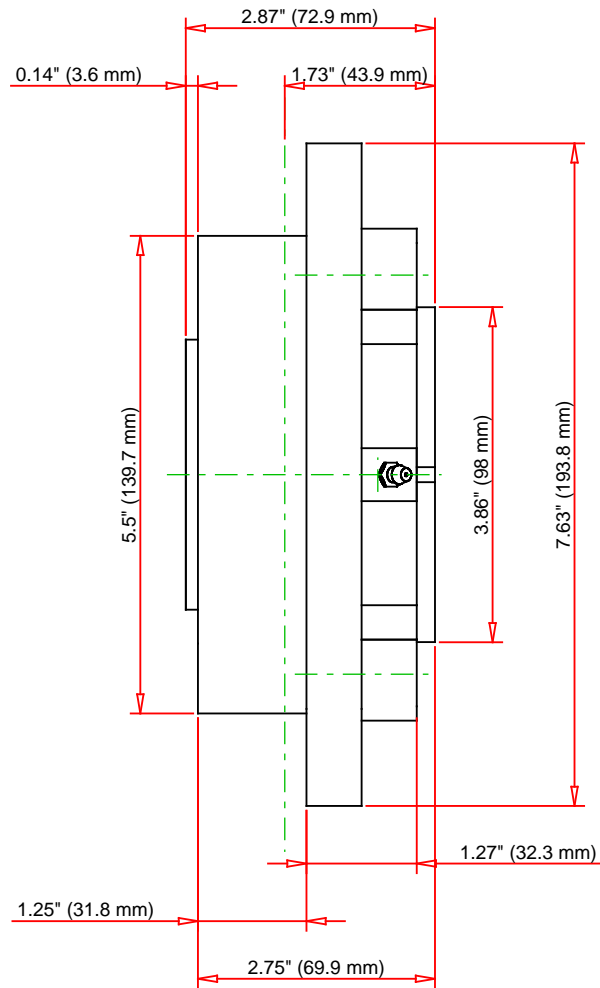

Note: Section View not to Scale

C - Dynamic Load	49900	lbf	222000	N
C0 - Static Load	54100	lbf	240000	N
Weight	18	lb	8.2	kg
Max. Speed T-Seals & Grease	2400	rpm		
Rad. Clearance - Max.				

TIMKEN

THE TIMKEN COMPANY
NORTH CANTON, OHIO USA

DVC15K208S

Tapered Adapter Piloted Flange
Cartridge

Every reasonable effort has been made to ensure the accuracy of the information contained in this writing, but no liability is accepted for errors, omissions or for any other reason.

FOR DISCUSSION ONLY