

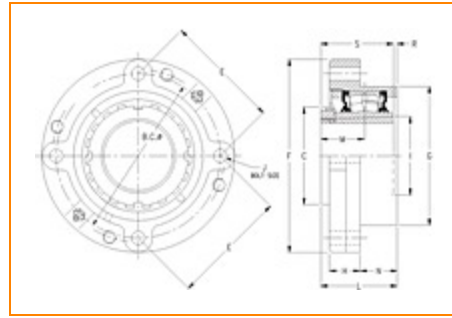

**The Timken Company**

4500 Mt Pleasant St. NW

N. Canton, OH 44720

**Phone:** (234) 262-3000

**E-Mail:** [CustomerCAD@timken.com](mailto:CustomerCAD@timken.com) • **Web site:** [www.timken.com](http://www.timken.com)
**Part Number DVC17K215S, Tapered Adapter Piloted Flange Cartridge**

[Specifications](#) | [Dimensions](#) | [Radial and Thrust Factors](#) | [Engineering Seal Speed](#) | [Engineering Bearing Attributes](#) | [Engineering Internal Radial Clearance](#)

**Specifications**

**Engineering Group** Mounted Bearing

**Bearing Number** 22217

**Shaft Size** 2 15/16 in

**Shaft Size Type** Imperial

**Full Timken Part Number**  
 DVC17K215SB  
 DVC17K215SC  
 DVC17K215SEB  
 DVC17K215SEC  
 DVC17K215SEM  
 DVC17K215SEN  
 DVC17K215SEO  
 DVC17K215SET  
 DVC17K215SLRC  
 DVC17K215SM



DVC17K215SN  
 DVC17K215SNNG  
 DVC17K215SO  
 DVC17K215ST  
 DVC17K215STNG  
 DVC17K215STREV

<b>Locking Style</b>	Tapered Adapter
<b>Housing Construction</b>	Piloted Flange Cartridge
<b>UPC Code</b>	0883450004527 0883450004534 0883450004558 0883450004565 0883450004572 0883450004589 0883450004596 0883450004602 0883450196925 0883450197120 0883450274432 0883450274630 0883450434256 0883450454711 0883450462389 0883450496322

## Dimensions

<b>Dimension BC</b>	7-1/2 in 190.5 mm
<b>Dimension C</b>	4.33 in 110 mm
<b>Dimension E</b>	5.3 in 134.6 mm
<b>Dimension F</b>	8-3/4 in 222.3 mm
<b>Dimension G</b>	6.375 in 161.9 mm

<b>Dimension H</b>	1.28 in 32.5 mm
<b>Dimension I</b>	3.55 in 90.2 mm
<b>Dimension J (Bolt Size)</b>	0.625 in 16 mm
<b>Dimension L</b>	3.14 in 79.8 mm
<b>Dimension M</b>	1.96 in 49.8 mm
<b>Dimension N</b>	1.38 in 35.1 mm
<b>Dimension R</b>	0.09 in 2.3 mm
<b>Dimension S</b>	3.23 in 82 mm

## Radial and Thrust Factors

<b>C0 - Static Load</b>	71900 lbf 320000 N
<b>C - Dynamic Load (Basic)</b>	66900 lbf 297000 N
<b>e - Geometry Factor</b>	0.22
<b>Y1 - Geometry Factor</b>	3.07
<b>Y2 - Geometry Factor</b>	4.57

## Engineering Seal Speed

<b>Oil Lubrication - M/N Seal</b>	1400 rpm
-----------------------------------	----------

<b>Oil Lubrication - T Seal</b>	2400 rpm
---------------------------------	----------

<b>Oil Lubrication - B/C/O Seal</b>	1100 rpm
-------------------------------------	----------

<b>Grease Lubrication - M/N Seal</b>	1400 rpm
--------------------------------------	----------

<b>Grease Lubrication - T Seal</b>	2000 rpm
------------------------------------	----------

<b>Grease Lubrication - B/C/O Seal</b>	1100 rpm
--	----------

## Engineering Bearing Attributes —

<b>Float</b>	0.083 in 2.108 mm
--------------	----------------------

<b>Shaft Tolerance</b>	0.0040 in 0.102 mm
------------------------	-----------------------

## Engineering Internal Radial Clearance —

<b>Pre Install Clearance Min</b>	0.0043 in 0.109 mm
----------------------------------	-----------------------

<b>Pre Install Clearance Max</b>	0.0055 in 0.140 mm
----------------------------------	-----------------------

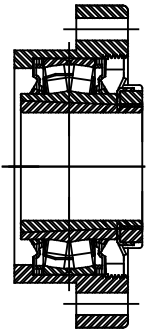
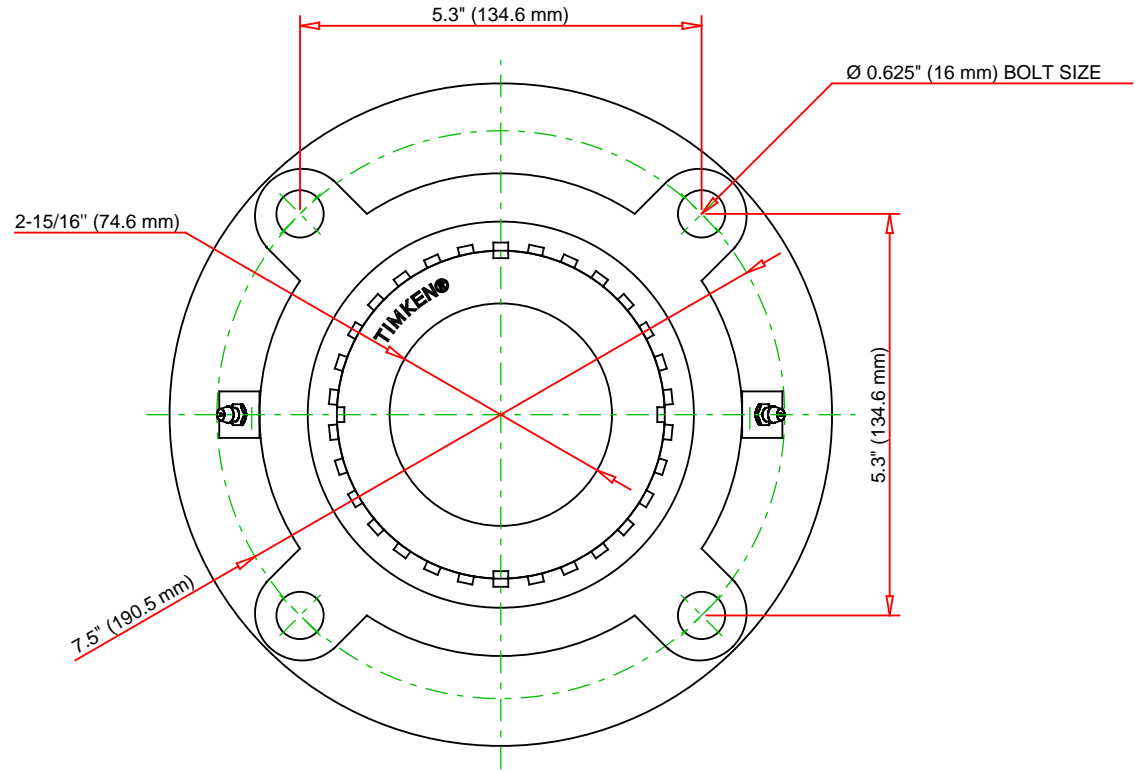
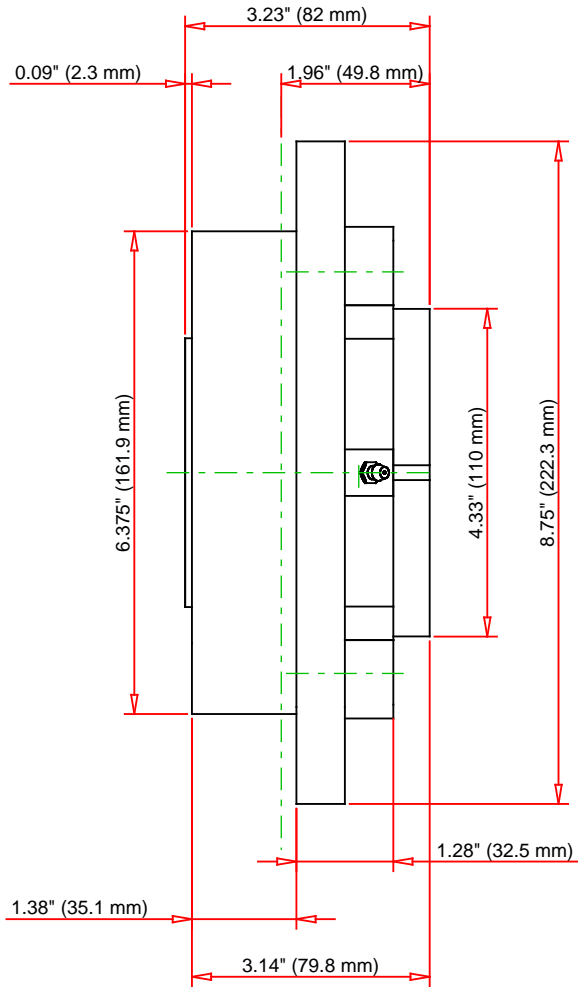

Note: Section View not to Scale

C - Dynamic Load	66900	lbf	297000	N
C0 - Static Load	71900	lbf	320000	N
Weight	25	lb	11.3	kg
Max. Speed T-Seals & Grease	2000	rpm		
Rad. Clearance - Max.				

**TIMKEN**

THE TIMKEN COMPANY  
NORTH CANTON, OHIO USA

**DVC17K215S**

Tapered Adapter Piloted Flange  
Cartridge

Every reasonable effort has been made to ensure the accuracy of the information contained in this writing, but no liability is accepted for errors, omissions or for any other reason.

**FOR DISCUSSION ONLY**