

The Timken Company

4500 Mt Pleasant St. NW

N. Canton, OH 44720

Phone: (234) 262-3000

E-Mail: CustomerCAD@timken.com • **Web site:** www.timken.com

Part Number QMP13J207S, Eccentric Two-Bolt Pillow Block

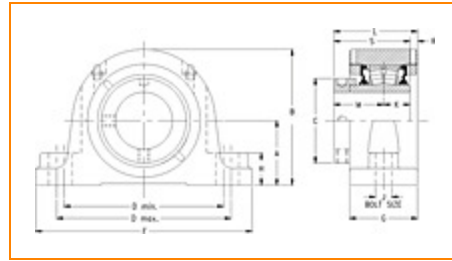

[Specifications](#) | [Dimensions](#) | [Radial and Thrust Factors](#) | [Engineering Seal Speed](#) | [Engineering Bearing Attributes](#) | [Engineering Internal Radial Clearance](#)

Specifications

Engineering Group Mounted Bearing

Bearing Number 22213

Shaft Size 2 7/16 in

Shaft Size Type Imperial

Full Timken Part Number
 QMP13J207SB
 QMP13J207SC
 QMP13J207SEB
 QMP13J207SEC
 QMP13J207SEM
 QMP13J207SEN
 QMP13J207SEO
 QMP13J207SET
 QMP13J207SETHT
 QMP13J207SM
 QMP13J207SMNG
 QMP13J207SN



QMP13J207SO
 QMP13J207ST
 QMP13J207STHT

Locking Style

Eccentric

Housing Construction

Two-Bolt Pillow Block

UPC Code

0883450081320
 0883450081337
 0883450081351
 0883450081368
 0883450081375
 0883450081382
 0883450081399
 0883450081405
 0883450154390
 0883450154734
 0883450249362
 0883450249706
 0883450493314
 0883450493321
 0883450960908

Dimensions**Dimension A**

2.75 in
 69.9 mm

Dimension B

5.8 in
 147.3 mm

Dimension C

3.62 in
 91.9 mm

Dimension D Min

6.88 in
 174.8 mm

Dimension D Max

8.63 in
 219.2 mm

Dimension F

10 1/4 in
 260.4 mm

Dimension G	2.9 in 73.7 mm
--------------------	-------------------

Dimension H	1.38 in 35.1 mm
--------------------	--------------------

Dimension J (Bolt Size)	0.625 in 16 mm
--------------------------------	-------------------

Dimension K	1.24 in 31.5 mm
--------------------	--------------------

Dimension L	3.59 in 91.2 mm
--------------------	--------------------

Dimension M	2.13 in 54.1 mm
--------------------	--------------------

Dimension R	0.21 in 5.3 mm
--------------------	-------------------

Dimension S	3.37 in 85.6 mm
--------------------	--------------------

Radial and Thrust Factors

C0 - Static Load	48600 lbf 216000 N
-------------------------	-----------------------

C - Dynamic Load (Basic)	46400 lbf 206000 N
---------------------------------	-----------------------

e - Geometry Factor	0.24
----------------------------	------

Y1 - Geometry Factor	2.79
-----------------------------	------

Y2 - Geometry Factor	4.15
-----------------------------	------

Engineering Seal Speed

Oil Lubrication - M/N Seal	1800 rpm
-----------------------------------	----------

Oil Lubrication - T Seal	3200 rpm
---------------------------------	----------

Oil Lubrication - B/C/O Seal	1500 rpm
-------------------------------------	----------

Grease Lubrication - M/N Seal	1800 rpm
--------------------------------------	----------

Grease Lubrication - T Seal	2800 rpm
------------------------------------	----------

Grease Lubrication - B/C/O Seal	1500 rpm
--	----------

Engineering Bearing Attributes

Float	0.083 in 2.108 mm
--------------	----------------------

Shaft Tolerance	0.0015 in 0.038 mm
------------------------	-----------------------

Engineering Internal Radial Clearance

Eng Internal Radial Clearance - Min	0.0016
--	--------

Eng Internal Radial Clearance - Max	0.0026
--	--------

Pre Install Clearance Min	0.0016 in 0.040 mm
----------------------------------	-----------------------

Pre Install Clearance Max	0.0026 in 0.065 mm
----------------------------------	-----------------------

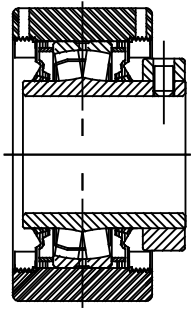
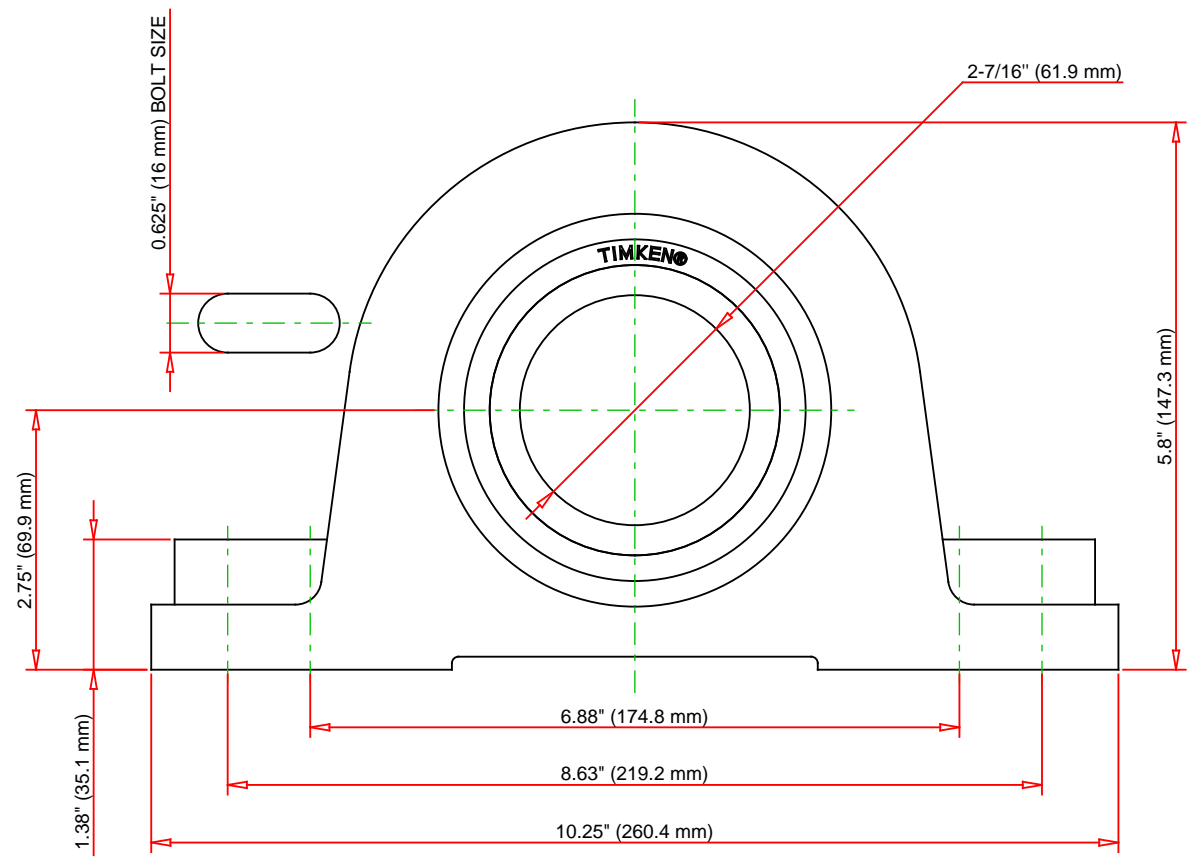
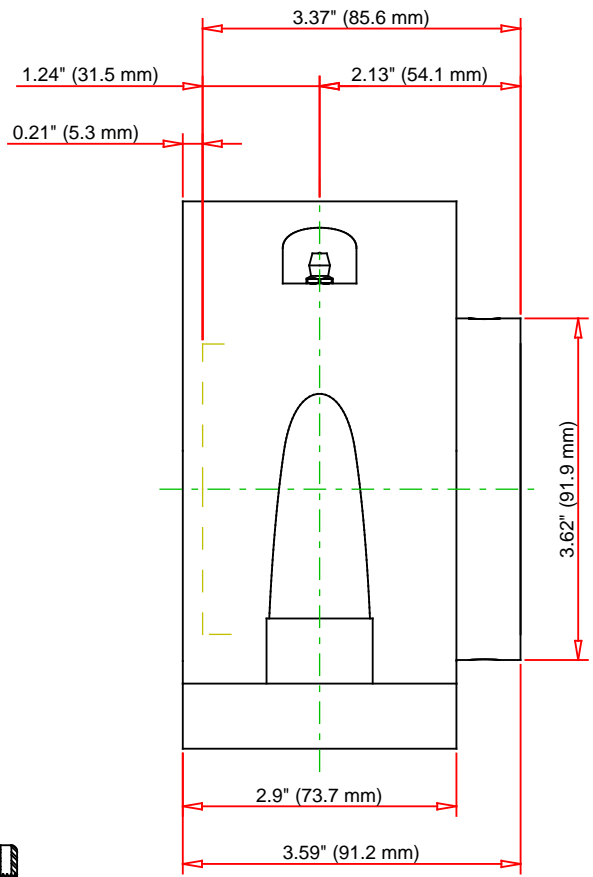

Note: Section View not to Scale

C - Dynamic Load	46400	lbf	206000	N
C0 - Static Load	48600	lbf	216000	N
Weight	22	lb	10	kg
Max. Speed T-Seals & Grease	2800	rpm		
Rad. Clearance - Max.	0.0026			

TIMKEN
THE TIMKEN COMPANY
NORTH CANTON, OHIO USA

QMP13J207S
Eccentric Two-Bolt Pillow Block

Every reasonable effort has been made to ensure the accuracy of the information contained in this writing, but no liability is accepted for errors, omissions or for any other reason.

FOR DISCUSSION ONLY