



The Timken Company

4500 Mt Pleasant St. NW

N. Canton, OH 44720

Phone: (234) 262-3000

E-Mail: CustomerCAD@timken.com • **Web site:** www.timken.com

Part Number QMF10J115S, Eccentric Four Bolt Square Flange Block

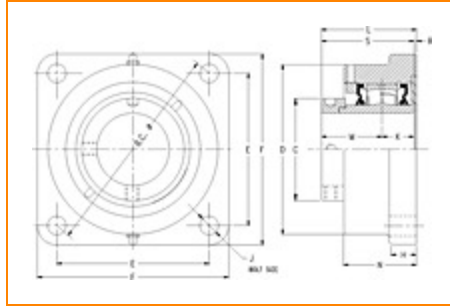

[Specifications](#) | [Dimensions](#) | [Radial and Thrust Factors](#) | [Engineering Seal Speed](#) | [Engineering Bearing Attributes](#) | [Engineering Internal Radial Clearance](#)

Specifications

Engineering Group	Mounted Bearing
Bearing Number	22210
Shaft Size	1 15/16 in
Shaft Size Type	Imperial
Full Timken Part Number	QMF10J115SB QMF10J115SC QMF10J115SEB QMF10J115SEC QMF10J115SEM QMF10J115SEN QMF10J115SEO QMF10J115SET QMF10J115SM QMF10J115SN QMF10J115SO



QMF10J115ST

Locking Style

Eccentric

Housing Construction

Four-Bolt Square Flange

UPC Code

0883450066129
 0883450066136
 0883450066150
 0883450066167
 0883450066174
 0883450066181
 0883450066198
 0883450066204
 0883450161558
 0883450162234
 0883450254298
 0883450254779

Dimensions**Dimension BC**

6.19 in
 157.2 mm

Dimension C

2.76 in
 70.1 mm

Dimension D

4.75 in
 120.7 mm

Dimension E

4.38 in
 111.3 mm

Dimension F

5.5000 in
 139.700 mm

Dimension H

0.88 in
 22.4 mm

Dimension J (Bolt Size)

0.5 in
 12 mm

Dimension K

0.98 in
 24.9 mm

Dimension L Exp	3.26 in 82.8 mm
------------------------	--------------------

Dimension L Fix	3.18 in 80.8 mm
------------------------	--------------------

Dimension M	1.89 in 48 mm
--------------------	------------------

Dimension N	2.56 in 65 mm
--------------------	------------------

Dimension R	0.31 in 7.9 mm
--------------------	-------------------

Dimension S	2.87 in 72.9 mm
--------------------	--------------------

Radial and Thrust Factors

C0 - Static Load	26600 lbf 118000 N
-------------------------	-----------------------

C - Dynamic Load (Basic)	26300 lbf 117000 N
---------------------------------	-----------------------

e - Geometry Factor	0.25
----------------------------	------

Y1 - Geometry Factor	2.71
-----------------------------	------

Y2 - Geometry Factor	4.04
-----------------------------	------

Engineering Seal Speed

Oil Lubrication - M/N Seal	2400 rpm
-----------------------------------	----------

Oil Lubrication - T Seal	4200 rpm
---------------------------------	----------

Oil Lubrication - B/C/O Seal	1800 rpm
-------------------------------------	----------

Grease Lubrication - M/N Seal	2400 rpm
--------------------------------------	----------

Grease Lubrication - T Seal	3550 rpm
------------------------------------	----------

Grease Lubrication - B/C/O Seal	1800 rpm
--	----------

Engineering Bearing Attributes

Float	0.050 in 1.270 mm
--------------	----------------------

Shaft Tolerance	0.0015 in 0.038 mm
------------------------	-----------------------

Engineering Internal Radial Clearance

Eng Internal Radial Clearance - Min	0.0016
--	--------

Eng Internal Radial Clearance - Max	0.0026
--	--------

Pre Install Clearance Min	0.0016 in 0.040 mm
----------------------------------	-----------------------

Pre Install Clearance Max	0.0026 in 0.065 mm
----------------------------------	-----------------------

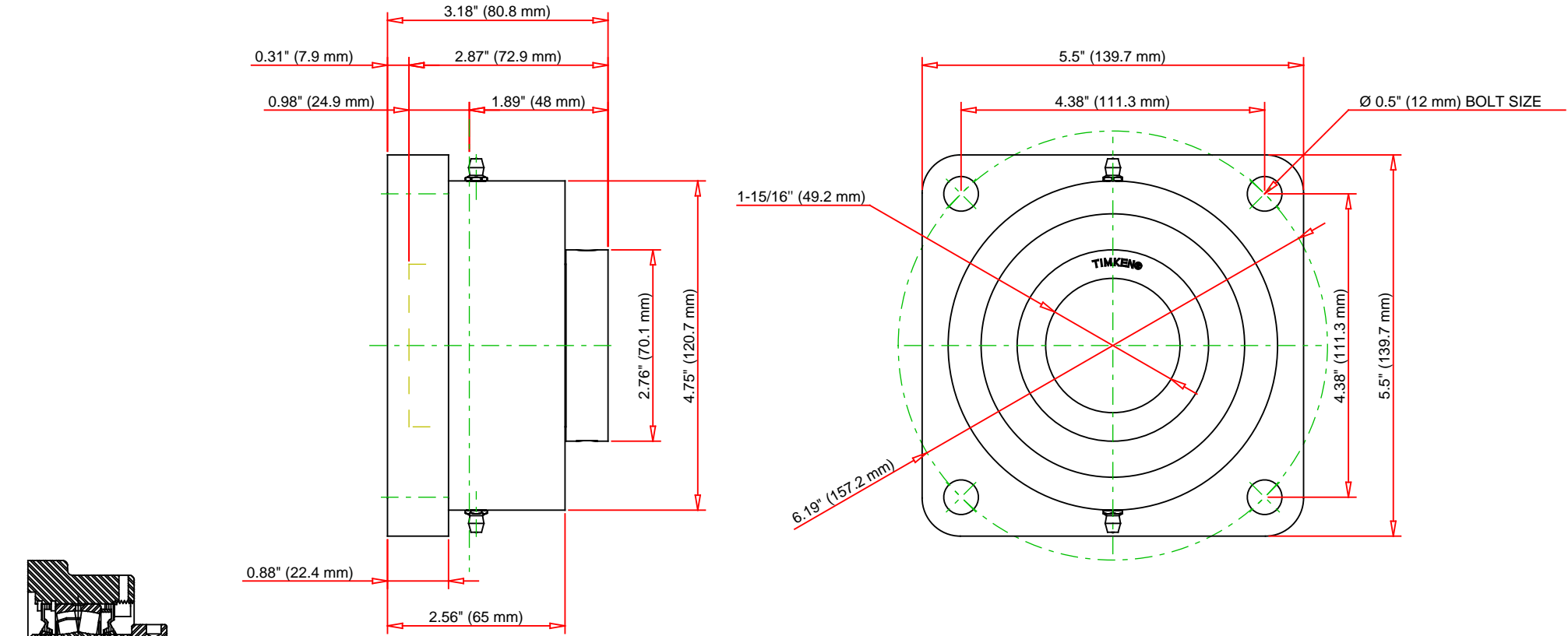

Note: Section View not to Scale

C - Dynamic Load	26300	lbf	117000	N
C0 - Static Load	26600	lbf	118000	N
Weight	11	lb	5	kg
Max. Speed T-Seals & Grease	3550	rpm		
Rad. Clearance - Max.	0.0026			

TIMKEN

THE TIMKEN COMPANY
NORTH CANTON, OHIO USA

QMF10J115S
Eccentric Four Bolt Square Flange Block

Every reasonable effort has been made to ensure the accuracy of the information contained in this writing, but no liability is accepted for errors, omissions or for any other reason.

FOR DISCUSSION ONLY