



**The Timken Company**

4500 Mt Pleasant St. NW

N. Canton, OH 44720

**Phone:** (234) 262-3000

**E-Mail:** [CustomerCAD@timken.com](mailto:CustomerCAD@timken.com) • **Web site:** [www.timken.com](http://www.timken.com)

## Part Number QMC13J207S, Eccentric Piloted Flange Cartridge

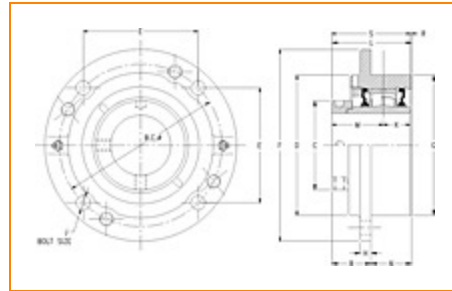

[Specifications](#) | [Dimensions](#) | [Radial and Thrust Factors](#) | [Engineering Seal Speed](#) | [Engineering Bearing Attributes](#) | [Engineering Internal Radial Clearance](#)

### Specifications

**Engineering Group** Mounted Bearing

**Bearing Number** 22213

**Shaft Size** 2 7/16 in

**Shaft Size Type** Imperial

**Full Timken Part Number**

- QMC13J207SB
- QMC13J207SC
- QMC13J207SEB
- QMC13J207SEC
- QMC13J207SEM
- QMC13J207SEN
- QMC13J207SEO
- QMC13J207SET
- QMC13J207SM
- QMC13J207SMB
- QMC13J207SN
- QMC13J207SO
- QMC13J207ST



<b>Locking Style</b>	Eccentric
<b>Housing Construction</b>	Piloted Flange Cartridge
<b>UPC Code</b>	0883450059220 0883450059237 0883450059251 0883450059268 0883450059275 0883450059282 0883450059299 0883450059305 0883450165631 0883450166058 0883450257893 0883450258272 0883450500388

## Dimensions

<b>Dimension BC</b>	6-1/2 in 165.1 mm
<b>Dimension B Exp</b>	2.42 in 61.5 mm
<b>Dimension B Fix</b>	2.34 in 59.4 mm
<b>Dimension C</b>	3.62 in 91.9 mm
<b>Dimension D</b>	5.5 in 139.7 mm
<b>Dimension E</b>	4.6 in 116.8 mm
<b>Dimension F</b>	7.63 in 193.8 mm
<b>Dimension G</b>	5.5 in 139.7 mm

<b>Dimension H</b>	0.69 in 17.5 mm
<b>Dimension J (Bolt Size)</b>	0.5 in 12 mm
<b>Dimension K</b>	1.24 in 31.5 mm
<b>Dimension L Exp</b>	3.59 in 91.2 mm
<b>Dimension L Fix</b>	3.46 in 87.9 mm
<b>Dimension M</b>	2.13 in 54.1 mm
<b>Dimension N</b>	1.13 in 28.7 mm
<b>Dimension R</b>	0.09 in 2.3 mm
<b>Dimension S</b>	3.37 in 85.6 mm

## Radial and Thrust Factors

<b>C0 - Static Load</b>	48600 lbf 216000 N
<b>C - Dynamic Load (Basic)</b>	46400 lbf 206000 N
<b>e - Geometry Factor</b>	0.24
<b>Y1 - Geometry Factor</b>	2.79
<b>Y2 - Geometry Factor</b>	4.15

## Engineering Seal Speed

<b>Oil Lubrication - M/N Seal</b>	1800 rpm
-----------------------------------	----------

<b>Oil Lubrication - T Seal</b>	3200 rpm
---------------------------------	----------

<b>Oil Lubrication - B/C/O Seal</b>	1500 rpm
-------------------------------------	----------

<b>Grease Lubrication - M/N Seal</b>	1800 rpm
--------------------------------------	----------

<b>Grease Lubrication - T Seal</b>	2800 rpm
------------------------------------	----------

<b>Grease Lubrication - B/C/O Seal</b>	1500 rpm
--	----------

## Engineering Bearing Attributes

<b>Float</b>	0.083 in 2.108 mm
--------------	----------------------

<b>Shaft Tolerance</b>	0.0015 in 0.038 mm
------------------------	-----------------------

## Engineering Internal Radial Clearance

<b>Eng Internal Radial Clearance - Min</b>	0.0016
--	--------

<b>Eng Internal Radial Clearance - Max</b>	0.0026
--	--------

<b>Pre Install Clearance Min</b>	0.0016 in 0.040 mm
----------------------------------	-----------------------

<b>Pre Install Clearance Max</b>	0.0026 in 0.065 mm
----------------------------------	-----------------------

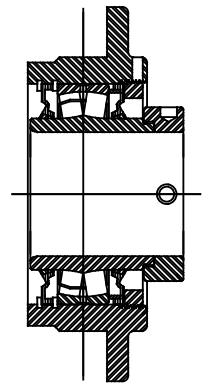
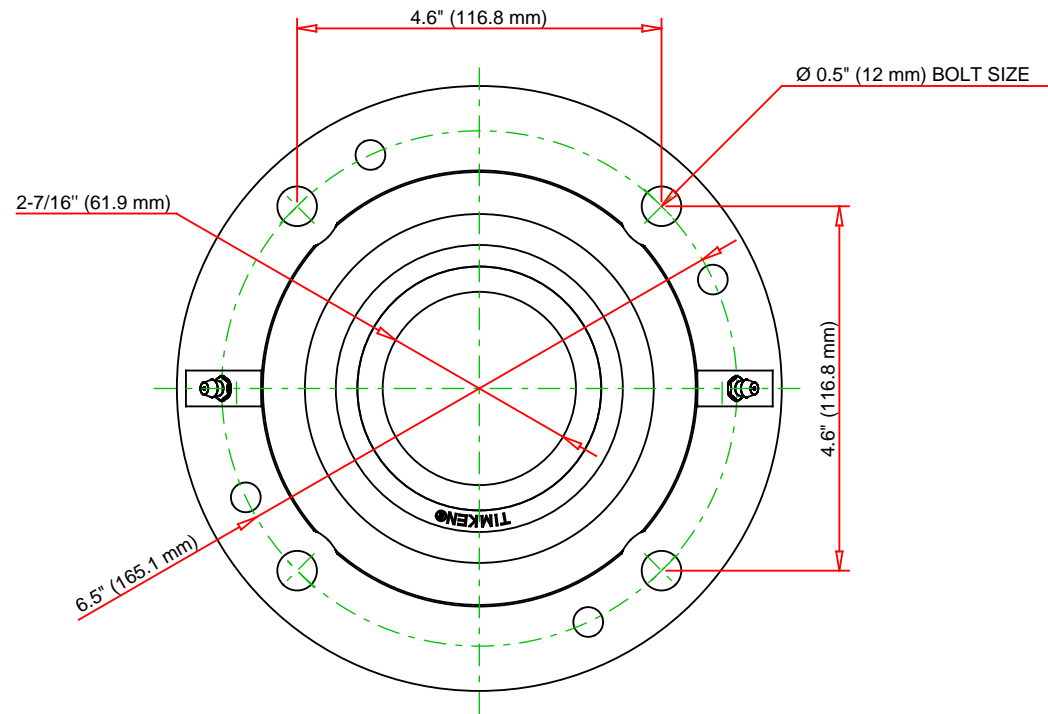
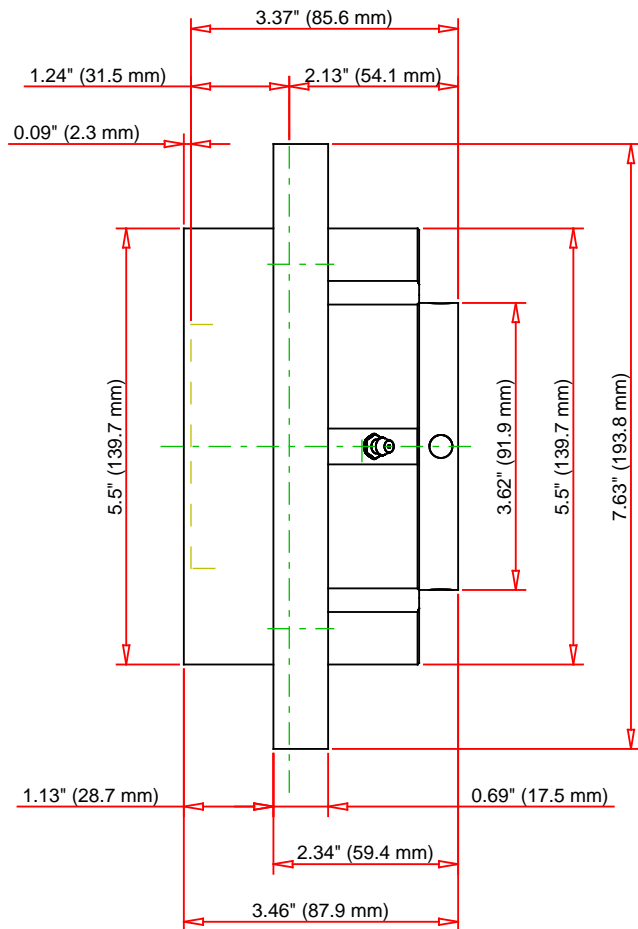

Note: Section View not to Scale

C - Dynamic Load	46400	lbf	206000	N
C0 - Static Load	48600	lbf	216000	N
Weight	16	lb	7.3	kg
Max. Speed T-Seals & Grease	2800	rpm		
Rad. Clearance - Max.	0.0026			

**TIMKEN**

THE TIMKEN COMPANY  
NORTH CANTON, OHIO USA

**QMC13J207S**  
Eccentric Piloted Flange Cartridge

Every reasonable effort has been made to ensure the accuracy of the information contained in this writing, but no liability is accepted for errors, omissions or for any other reason.

**FOR DISCUSSION ONLY**