



The Timken Company

4500 Mt Pleasant St. NW

N. Canton, OH 44720

Phone: (234) 262-3000

E-Mail: CustomerCAD@timken.com • **Web site:** www.timken.com

Part Number QMCW10J200S, Eccentric Piloted Flange Cartridge

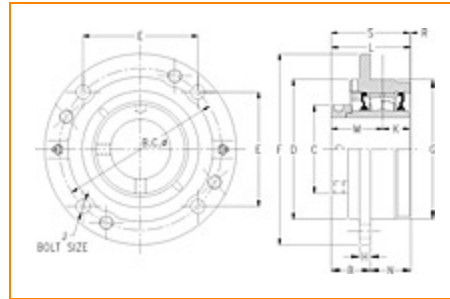

[Specifications](#) | [Dimensions](#) | [Radial and Thrust Factors](#) | [Engineering Seal Speed](#) | [Engineering Bearing Attributes](#) | [Engineering Internal Radial Clearance](#)

Specifications

Engineering Group Mounted Bearing

Bearing Number 22210

Shaft Size 2 in

Shaft Size Type Imperial

Full Timken Part Number

- QMCW10J200SB
- QMCW10J200SC
- QMCW10J200SEB
- QMCW10J200SEC
- QMCW10J200SEM
- QMCW10J200SEN
- QMCW10J200SEO
- QMCW10J200SET
- QMCW10J200SM
- QMCW10J200SMT
- QMCW10J200SN
- QMCW10J200SO
- QMCW10J200ST



| | |
|-----------------------------|---|
| Locking Style | Eccentric |
| Housing Construction | Piloted Flange Cartridge |
| UPC Code | 0883450062022 0883450062039 0883450062053 0883450062060 0883450062077 0883450062084 0883450062091 0883450062107 0883450166430 0883450167154 0883450258593 0883450259132 0883450961424 |

Dimensions

| | |
|------------------------|---------------------|
| Dimension BC | 5.38 in 136.7 mm |
| Dimension B Exp | 1.62 in 41.1 mm |
| Dimension B Fix | 1.54 in 39.1 mm |
| Dimension C | 2.76 in 70.1 mm |
| Dimension D | 4.47 in 113.5 mm |
| Dimension E | 3.8 in 96.5 mm |
| Dimension F | 6.38 in 162.1 mm |
| Dimension G | 4.5 in 114.3 mm |

| | |
|--------------------------------|--------------------|
| Dimension H | 0.38 in 9.7 mm |
| Dimension J (Bolt Size) | 0.438 in 10 mm |
| Dimension K | 0.98 in 24.9 mm |
| Dimension L Exp | 3.12 in 79.2 mm |
| Dimension L Fix | 3.04 in 77.2 mm |
| Dimension M | 1.89 in 48 mm |
| Dimension N | 1.5 in 38.1 mm |
| Dimension R | 0.17 in 4.3 mm |
| Dimension S | 2.87 in 72.9 mm |

Radial and Thrust Factors

| | |
|---------------------------------|-----------------------|
| C0 - Static Load | 26600 lbf 118000 N |
| C - Dynamic Load (Basic) | 26300 lbf 117000 N |
| e - Geometry Factor | 0.24 |
| Y1 - Geometry Factor | 2.84 |
| Y2 - Geometry Factor | 4.23 |

Engineering Seal Speed

| | |
|-----------------------------------|----------|
| Oil Lubrication - M/N Seal | 2400 rpm |
|-----------------------------------|----------|

| | |
|---------------------------------|----------|
| Oil Lubrication - T Seal | 4200 rpm |
|---------------------------------|----------|

| | |
|-------------------------------------|----------|
| Oil Lubrication - B/C/O Seal | 1800 rpm |
|-------------------------------------|----------|

| | |
|--------------------------------------|----------|
| Grease Lubrication - M/N Seal | 2400 rpm |
|--------------------------------------|----------|

| | |
|------------------------------------|----------|
| Grease Lubrication - T Seal | 3550 rpm |
|------------------------------------|----------|

| | |
|--|----------|
| Grease Lubrication - B/C/O Seal | 1800 rpm |
|--|----------|

Engineering Bearing Attributes

| | |
|--------------|----------------------|
| Float | 0.050 in 1.270 mm |
|--------------|----------------------|

| | |
|------------------------|-----------------------|
| Shaft Tolerance | 0.0015 in 0.038 mm |
|------------------------|-----------------------|

Engineering Internal Radial Clearance

| | |
|--|--------|
| Eng Internal Radial Clearance - Min | 0.0016 |
|--|--------|

| | |
|--|--------|
| Eng Internal Radial Clearance - Max | 0.0026 |
|--|--------|

| | |
|----------------------------------|-----------------------|
| Pre Install Clearance Min | 0.0016 in 0.040 mm |
|----------------------------------|-----------------------|

| | |
|----------------------------------|-----------------------|
| Pre Install Clearance Max | 0.0026 in 0.065 mm |
|----------------------------------|-----------------------|

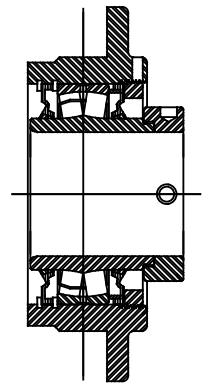
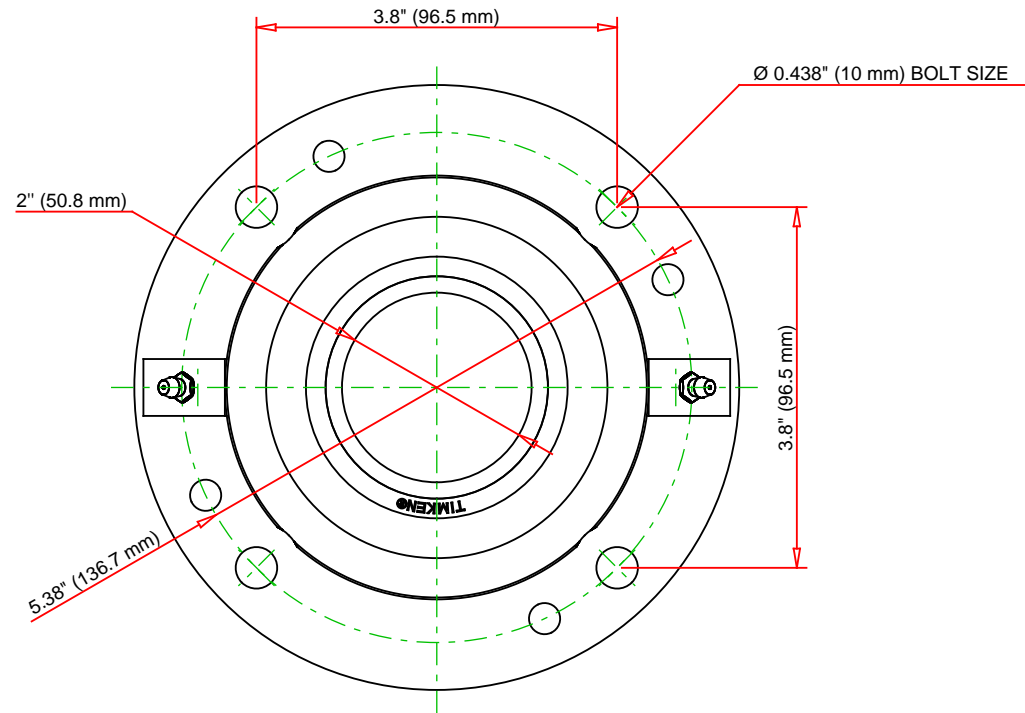
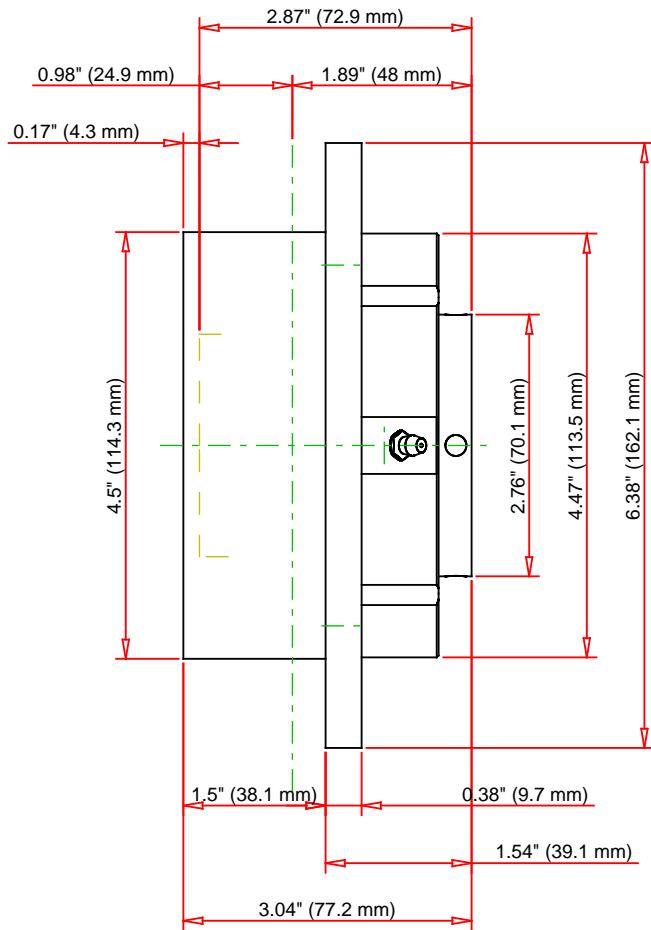

Note: Section View not to Scale

| | | | | |
|-----------------------------|--------|-----|--------|----|
| C - Dynamic Load | 26300 | lbf | 117000 | N |
| C0 - Static Load | 26600 | lbf | 118000 | N |
| Weight | 10 | lb | 4.5 | kg |
| Max. Speed T-Seals & Grease | 3550 | rpm | | |
| Rad. Clearance - Max. | 0.0026 | | | |

TIMKEN

THE TIMKEN COMPANY
NORTH CANTON, OHIO USA

QMCW10J200S
Eccentric Piloted Flange Cartridge

Every reasonable effort has been made to ensure the accuracy of the information contained in this writing, but no liability is accepted for errors, omissions or for any other reason.

FOR DISCUSSION ONLY