



The Timken Company

4500 Mt Pleasant St. NW

N. Canton, OH 44720

Phone: (234) 262-3000

E-Mail: CustomerCAD@timken.com • **Web site:** www.timken.com

Part Number QMC15J215S, Eccentric Piloted Flange Cartridge

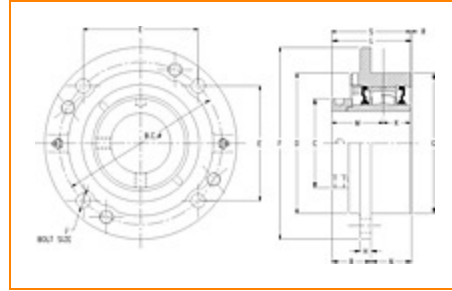

[Specifications](#) | [Dimensions](#) | [Radial and Thrust Factors](#) | [Engineering Seal Speed](#) | [Engineering Bearing Attributes](#) | [Engineering Internal Radial Clearance](#)

Specifications

Engineering Group Mounted Bearing

Bearing Number 22215

Shaft Size 2 15/16 in

Shaft Size Type Imperial

Full Timken Part Number

- QMC15J215SB
- QMC15J215SC
- QMC15J215SEB
- QMC15J215SEC
- QMC15J215SEM
- QMC15J215SEN
- QMC15J215SEO
- QMC15J215SET
- QMC15J215SM
- QMC15J215SMNP
- QMC15J215SN
- QMC15J215SO
- QMC15J215ST



Locking Style	Eccentric
Housing Construction	Piloted Flange Cartridge
UPC Code	0883450059824 0883450059831 0883450059855 0883450059862 0883450059879 0883450059886 0883450059893 0883450059909 0883450165693 0883450166119 0883450257954 0883450258333 0883450958684

Dimensions

Dimension BC	7-1/2 in 190.5 mm
Dimension B Exp	2.54 in 64.5 mm
Dimension B Fix	2.46 in 62.5 mm
Dimension C	4.01 in 101.9 mm
Dimension D	6.38 in 162.1 mm
Dimension E	5.3 in 134.6 mm
Dimension F	8-3/4 in 222.3 mm
Dimension G	6.375 in 161.9 mm

Dimension H	0.81 in 20.6 mm
Dimension J (Bolt Size)	0.625 in 16 mm
Dimension K	1.25 in 31.8 mm
Dimension L Exp	3.8 in 96.5 mm
Dimension L Fix	3.72 in 94.5 mm
Dimension M	2.37 in 60.2 mm
Dimension N	1.25 in 31.8 mm
Dimension R	0.09 in 2.3 mm
Dimension S	3.62 in 91.9 mm

Radial and Thrust Factors

C0 - Static Load	54100 lbf 240000 N
C - Dynamic Load (Basic)	49900 lbf 222000 N
e - Geometry Factor	0.22
Y1 - Geometry Factor	3.14
Y2 - Geometry Factor	4.67

Engineering Seal Speed

Oil Lubrication - M/N Seal	1600 rpm
-----------------------------------	----------

Oil Lubrication - T Seal	2900 rpm
---------------------------------	----------

Oil Lubrication - B/C/O Seal	1300 rpm
-------------------------------------	----------

Grease Lubrication - M/N Seal	1600 rpm
--------------------------------------	----------

Grease Lubrication - T Seal	2400 rpm
------------------------------------	----------

Grease Lubrication - B/C/O Seal	1300 rpm
--	----------

Engineering Bearing Attributes

Float	0.083 in 2.108 mm
--------------	----------------------

Shaft Tolerance	0.0020 in 0.051 mm
------------------------	-----------------------

Engineering Internal Radial Clearance

Eng Internal Radial Clearance - Min	0.0020
--	--------

Eng Internal Radial Clearance - Max	0.0031
--	--------

Pre Install Clearance Min	0.0020 in 0.050 mm
----------------------------------	-----------------------

Pre Install Clearance Max	0.0031 in 0.080 mm
----------------------------------	-----------------------

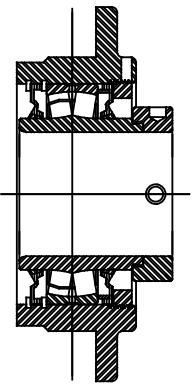
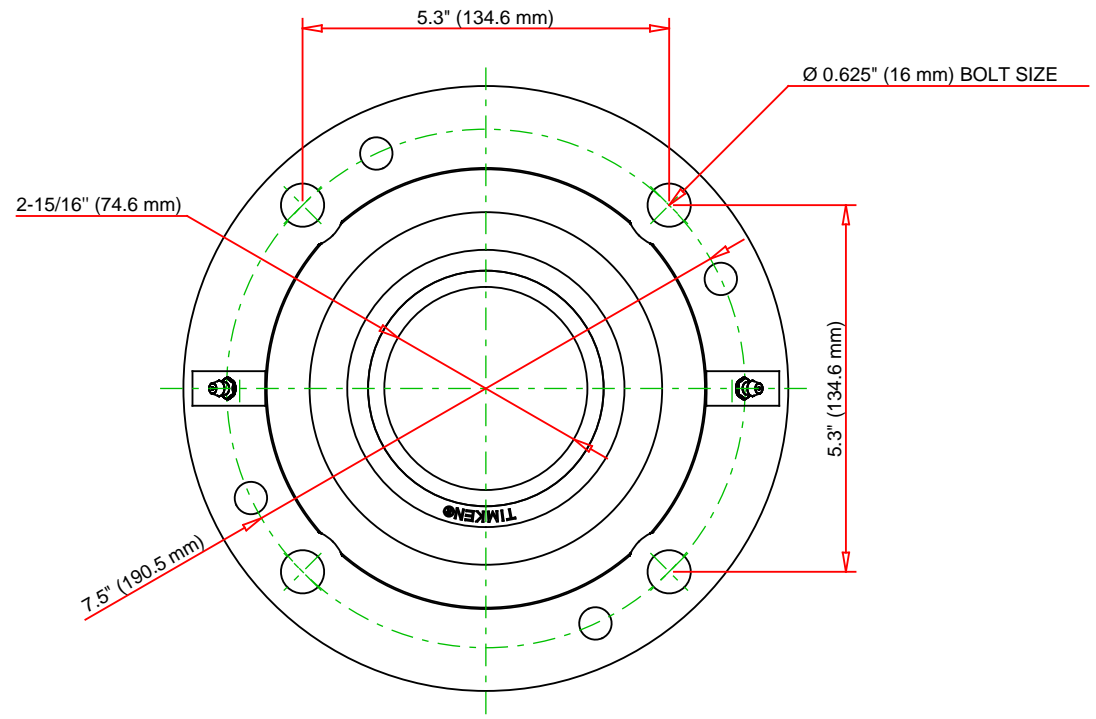
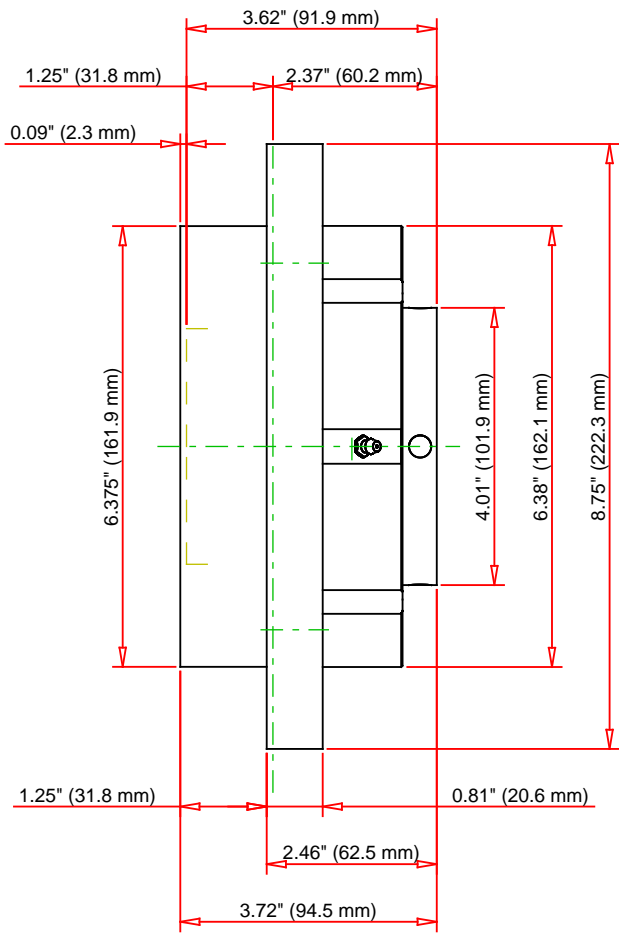

Note: Section View not to Scale

C - Dynamic Load	49900	lbf	222000	N
C0 - Static Load	54100	lbf	240000	N
Weight	22	lb	10	kg
Max. Speed T-Seals & Grease	2400	rpm		
Rad. Clearance - Max.	0.0031			

TIMKEN
THE TIMKEN COMPANY
NORTH CANTON, OHIO USA

QMC15J215S
Eccentric Piloted Flange Cartridge

Every reasonable effort has been made to ensure the accuracy of the information contained in this writing, but no liability is accepted for errors, omissions or for any other reason.

FOR DISCUSSION ONLY