



**The Timken Company**

4500 Mt Pleasant St. NW

N. Canton, OH 44720

**Phone:** (234) 262-3000

**E-Mail:** [CustomerCAD@timken.com](mailto:CustomerCAD@timken.com) • **Web site:** [www.timken.com](http://www.timken.com)

## Part Number QMCW18J303S, Eccentric Piloted Flange Cartridge

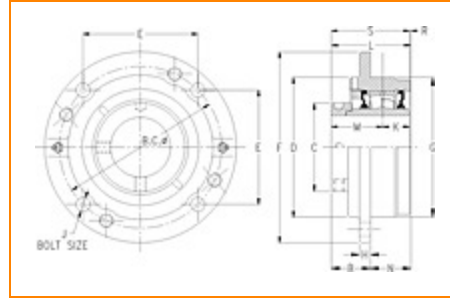

[Specifications](#) | [Dimensions](#) | [Radial and Thrust Factors](#) | [Engineering Seal Speed](#) | [Engineering Bearing Attributes](#) | [Engineering Internal Radial Clearance](#)

### Specifications

**Engineering Group** Mounted Bearing

**Bearing Number** 22218

**Shaft Size** 3 3/16 in

**Shaft Size Type** Imperial

**Full Timken Part Number**

- QMCW18J303SB
- QMCW18J303SC
- QMCW18J303SEB
- QMCW18J303SEC
- QMCW18J303SEM
- QMCW18J303SEN
- QMCW18J303SEO
- QMCW18J303SET
- QMCW18J303SM
- QMCW18J303SN
- QMCW18J303SO
- QMCW18J303ST



<b>Locking Style</b>	Eccentric
<b>Housing Construction</b>	Piloted Flange Cartridge

<b>UPC Code</b>	0883450063425
	0883450063432
	0883450063456
	0883450063463
	0883450063470
	0883450063487
	0883450063494
	0883450063500
	0883450166560
	0883450167284
0883450258746	
0883450259286	

## Dimensions

<b>Dimension BC</b>	8.63 in 219.2 mm
---------------------	---------------------

<b>Dimension B Exp</b>	2.54 in 64.5 mm
------------------------	--------------------

<b>Dimension B Fix</b>	2.46 in 62.5 mm
------------------------	--------------------

<b>Dimension C</b>	4.76 in 120.9 mm
--------------------	---------------------

<b>Dimension D</b>	7.38 in 187.5 mm
--------------------	---------------------

<b>Dimension E</b>	6.1 in 154.9 mm
--------------------	--------------------

<b>Dimension F</b>	10-1/4 in 260.4 mm
--------------------	-----------------------

<b>Dimension G</b>	7.375 in 187.3 mm
--------------------	----------------------

<b>Dimension H</b>	0.88 in 22.4 mm
<b>Dimension J (Bolt Size)</b>	0.75 in 20 mm
<b>Dimension K</b>	1.44 in 36.6 mm
<b>Dimension L Exp</b>	4.42 in 112.3 mm
<b>Dimension L Fix</b>	4.34 in 110.2 mm
<b>Dimension M</b>	2.59 in 65.8 mm
<b>Dimension N</b>	1.88 in 47.8 mm
<b>Dimension R</b>	0.31 in 7.9 mm
<b>Dimension S</b>	4.03 in 102.4 mm

## Radial and Thrust Factors

<b>C0 - Static Load</b>	87200 lbf 388000 N
<b>C - Dynamic Load (Basic)</b>	79700 lbf 355000 N
<b>e - Geometry Factor</b>	0.23
<b>Y1 - Geometry Factor</b>	2.90
<b>Y2 - Geometry Factor</b>	4.31

## Engineering Seal Speed

<b>Oil Lubrication - M/N Seal</b>	1400 rpm
-----------------------------------	----------

<b>Oil Lubrication - T Seal</b>	2400 rpm
---------------------------------	----------

<b>Oil Lubrication - B/C/O Seal</b>	1000 rpm
-------------------------------------	----------

<b>Grease Lubrication - M/N Seal</b>	1400 rpm
--------------------------------------	----------

<b>Grease Lubrication - T Seal</b>	2000 rpm
------------------------------------	----------

<b>Grease Lubrication - B/C/O Seal</b>	1000 rpm
--	----------

## Engineering Bearing Attributes

<b>Float</b>	0.083 in 2.108 mm
--------------	----------------------

<b>Shaft Tolerance</b>	0.0030 in 0.076 mm
------------------------	-----------------------

## Engineering Internal Radial Clearance

<b>Eng Internal Radial Clearance - Min</b>	0.0024
--	--------

<b>Eng Internal Radial Clearance - Max</b>	0.0039
--	--------

<b>Pre Install Clearance Min</b>	0.0024 in 0.060 mm
----------------------------------	-----------------------

<b>Pre Install Clearance Max</b>	0.0039 in 0.100 mm
----------------------------------	-----------------------

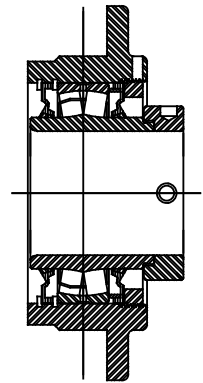
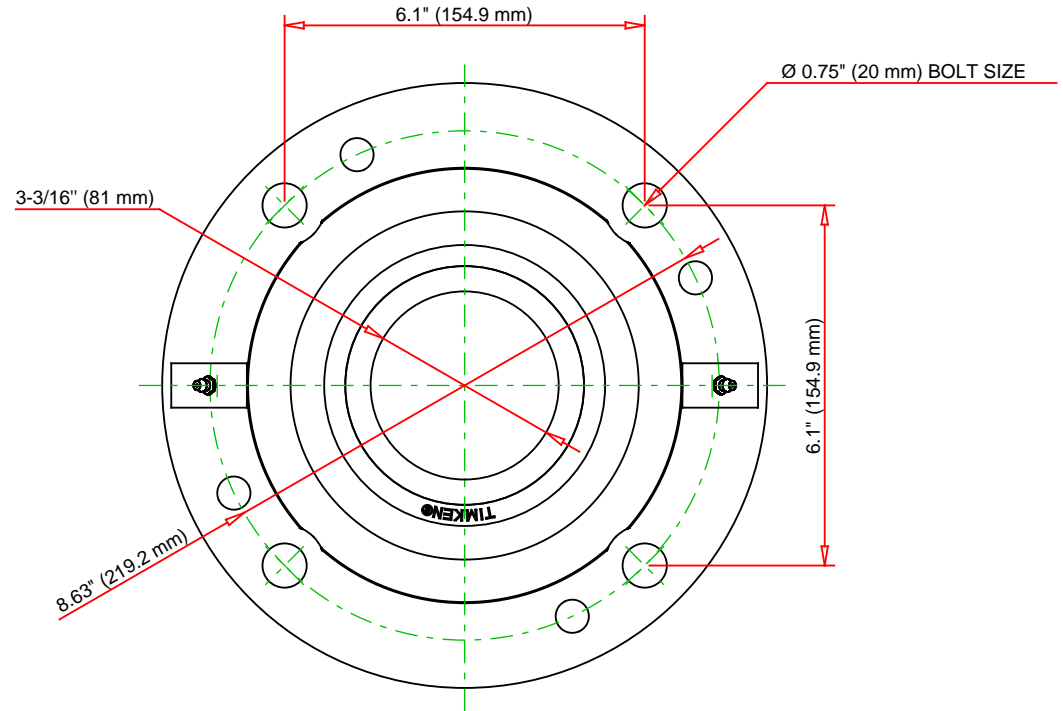
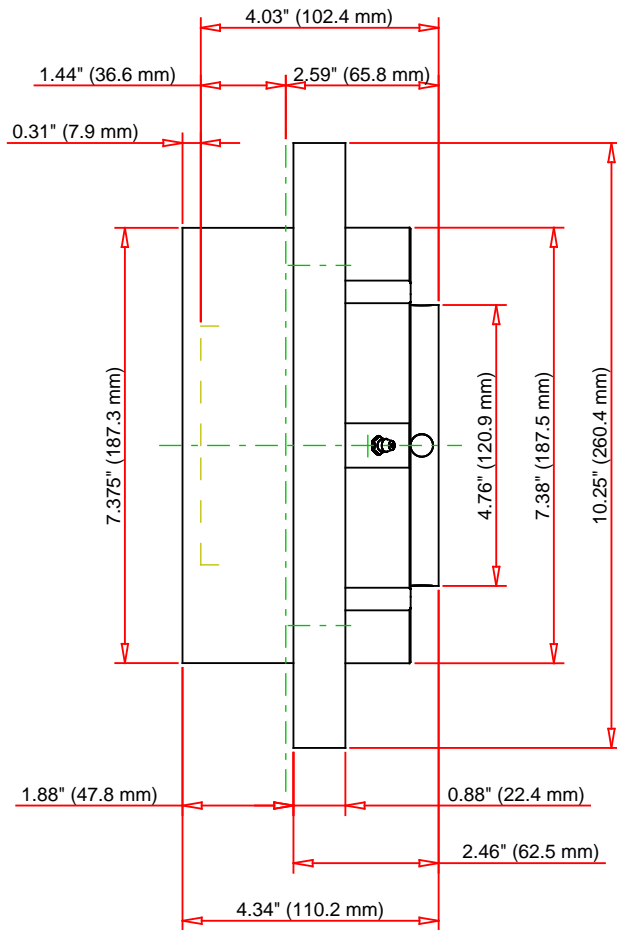

Note: Section View not to Scale

C - Dynamic Load	79700	lbf	355000	N
C0 - Static Load	87200	lbf	388000	N
Weight	32	lb	14.5	kg
Max. Speed T-Seals & Grease	2000	rpm		
Rad. Clearance - Max.	0.0039			

**TIMKEN**

THE TIMKEN COMPANY  
NORTH CANTON, OHIO USA

**QMCW18J303S**  
Eccentric Piloted Flange Cartridge

Every reasonable effort has been made to ensure the accuracy of the information contained in this writing, but no liability is accepted for errors, omissions or for any other reason.

**FOR DISCUSSION ONLY**