



The Timken Company

4500 Mt Pleasant St. NW

N. Canton, OH 44720

Phone: (234) 262-3000

E-Mail: CustomerCAD@timken.com • **Web site:** www.timken.com

Part Number QMCW20J315S, Eccentric Piloted Flange Cartridge

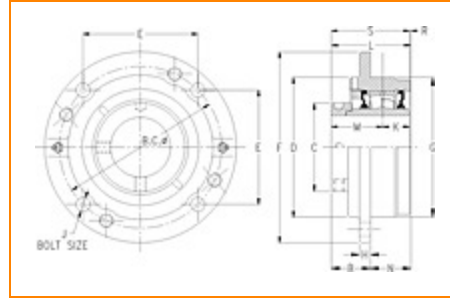

[Specifications](#) | [Dimensions](#) | [Radial and Thrust Factors](#) | [Engineering Seal Speed](#) | [Engineering Bearing Attributes](#) | [Engineering Internal Radial Clearance](#)

Specifications

Engineering Group Mounted Bearing

Bearing Number 22220

Shaft Size 3 15/16 in

Shaft Size Type Imperial

Full Timken Part Number

- QMCW20J315SB
- QMCW20J315SC
- QMCW20J315SEB
- QMCW20J315SEC
- QMCW20J315SEM
- QMCW20J315SEN
- QMCW20J315SEO
- QMCW20J315SET
- QMCW20J315SM
- QMCW20J315SMT
- QMCW20J315SN
- QMCW20J315SO
- QMCW20J315ST



Locking Style	Eccentric
Housing Construction	Piloted Flange Cartridge
UPC Code	0883450064125 0883450064132 0883450064156 0883450064163 0883450064170 0883450064187 0883450064194 0883450064200 0883450166652 0883450167376 0883450258838 0883450259378 0883450959483

Dimensions

Dimension BC	9.38 in 238.3 mm
Dimension B Exp	2.58 in 65.5 mm
Dimension B Fix	2.5 in 63.5 mm
Dimension C	6 in 152.4 mm
Dimension D	8.13 in 206.5 mm
Dimension E	6.63 in 168.4 mm
Dimension F	10.88 in 276.4 mm
Dimension G	8.125 in 206.4 mm

Dimension H	1 in 25.4 mm
Dimension J (Bolt Size)	0.75 in 20 mm
Dimension K	1.63 in 41.4 mm
Dimension L Exp	4.83 in 122.7 mm
Dimension L Fix	4.75 in 120.7 mm
Dimension M	2.96 in 75.2 mm
Dimension N	2.25 in 57.2 mm
Dimension R	0.16 in 4.1 mm
Dimension S	4.59 in 116.6 mm

Radial and Thrust Factors

C0 - Static Load	113000 lbf 502000 N
C - Dynamic Load (Basic)	97700 lbf 435000 N
e - Geometry Factor	0.24
Y1 - Geometry Factor	2.85
Y2 - Geometry Factor	4.24

Engineering Seal Speed

Oil Lubrication - M/N Seal	1200 rpm
-----------------------------------	----------

Oil Lubrication - T Seal	2000 rpm
---------------------------------	----------

Oil Lubrication - B/C/O Seal	900 rpm
-------------------------------------	---------

Grease Lubrication - M/N Seal	1200 rpm
--------------------------------------	----------

Grease Lubrication - T Seal	1600 rpm
------------------------------------	----------

Grease Lubrication - B/C/O Seal	900 rpm
--	---------

Engineering Bearing Attributes

Float	0.083 in 2.108 mm
--------------	----------------------

Shaft Tolerance	0.0030 in 0.076 mm
------------------------	-----------------------

Engineering Internal Radial Clearance

Eng Internal Radial Clearance - Min	0.0030
--	--------

Eng Internal Radial Clearance - Max	0.0047
--	--------

Pre Install Clearance Min	0.0030 in 0.075 mm
----------------------------------	-----------------------

Pre Install Clearance Max	0.0047 in 0.120 mm
----------------------------------	-----------------------

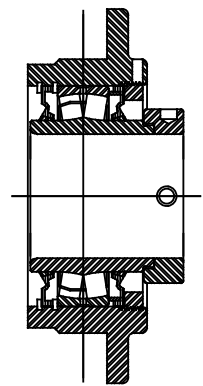
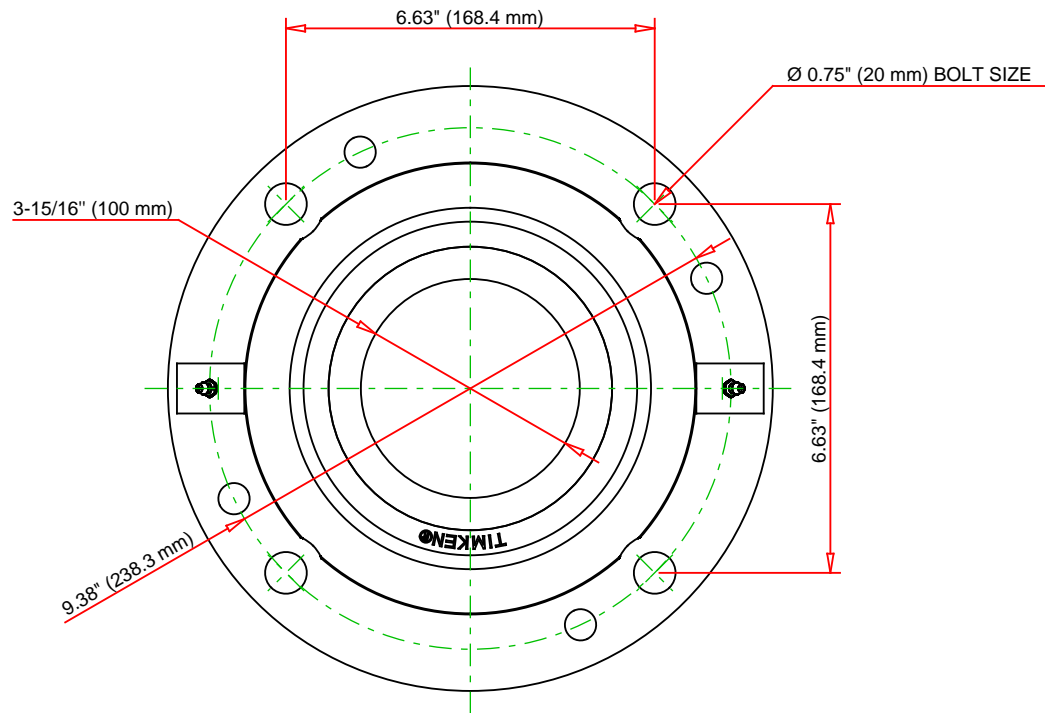
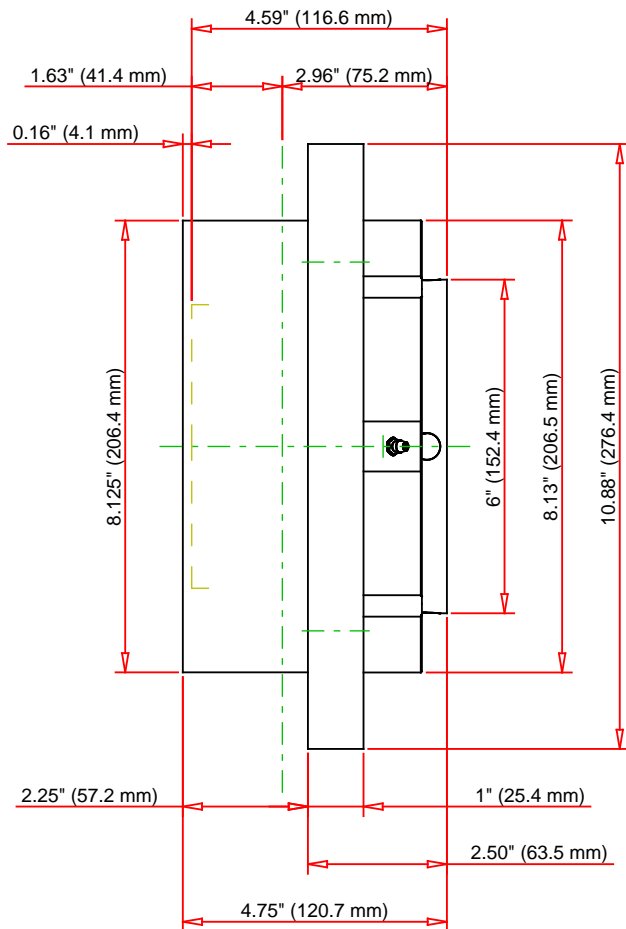

Note: Section View not to Scale

C - Dynamic Load	97700	lbf	435000	N
C0 - Static Load	113000	lbf	502000	N
Weight	43	lb	19.5	kg
Max. Speed T-Seals & Grease	1600	rpm		
Rad. Clearance - Max.	0.0047			

TIMKEN

THE TIMKEN COMPANY
NORTH CANTON, OHIO USA

QMCW20J315S
Eccentric Piloted Flange Cartridge

Every reasonable effort has been made to ensure the accuracy of the information contained in this writing, but no liability is accepted for errors, omissions or for any other reason.

FOR DISCUSSION ONLY