



The Timken Company

4500 Mt Pleasant St. NW

N. Canton, OH 44720

Phone: (234) 262-3000

E-Mail: CustomerCAD@timken.com • **Web site:** www.timken.com

Part Number QMF13J207S, Eccentric Four Bolt Square Flange Block

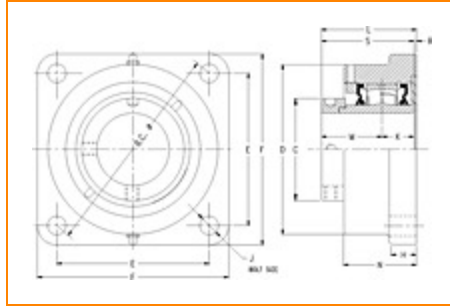

[Specifications](#) | [Dimensions](#) | [Radial and Thrust Factors](#) | [Engineering Seal Speed](#) | [Engineering Bearing Attributes](#) | [Engineering Internal Radial Clearance](#)

Specifications

Engineering Group	Mounted Bearing
Bearing Number	22213
Shaft Size	2 7/16 in
Shaft Size Type	Imperial
Full Timken Part Number	QMF13J207SB QMF13J207SC QMF13J207SEB QMF13J207SEC QMF13J207SEM QMF13J207SEN QMF13J207SEO QMF13J207SET QMF13J207SM QMF13J207SMNP QMF13J207SN



QMF13J207SNT
 QMF13J207SO
 QMF13J207ST

Locking Style

Eccentric

Housing Construction

Four-Bolt Square Flange

UPC Code

0883450066624
 0883450066631
 0883450066655
 0883450066662
 0883450066679
 0883450066686
 0883450066693
 0883450066709
 0883450161602
 0883450162289
 0883450254366
 0883450254847
 0883450454506
 0883450955355

Dimensions**Dimension BC**

7.6 in
 193 mm

Dimension C

3.62 in
 91.9 mm

Dimension D

5.75 in
 146.1 mm

Dimension E

5.38 in
 136.7 mm

Dimension F

6.63 in
 168.4 mm

Dimension H

1 in
 25.4 mm

Dimension J (Bolt Size)	0.625 in 16 mm
Dimension K	1.24 in 31.5 mm
Dimension L Exp	3.57 in 90.7 mm
Dimension L Fix	3.42 in 86.9 mm
Dimension M	2.13 in 54.1 mm
Dimension N	2.85 in 72.4 mm
Dimension R	0.12 in 3 mm
Dimension S	3.37 in 85.6 mm

Radial and Thrust Factors

C0 - Static Load	48600 lbf 216000 N
C - Dynamic Load (Basic)	46400 lbf 206000 N
e - Geometry Factor	0.25
Y1 - Geometry Factor	2.69
Y2 - Geometry Factor	4.00

Engineering Seal Speed

Oil Lubrication - M/N Seal	1800 rpm
-----------------------------------	----------

Oil Lubrication - T Seal	3200 rpm
---------------------------------	----------

Oil Lubrication - B/C/O Seal	1500 rpm
-------------------------------------	----------

Grease Lubrication - M/N Seal	1800 rpm
--------------------------------------	----------

Grease Lubrication - T Seal	2800 rpm
------------------------------------	----------

Grease Lubrication - B/C/O Seal	1500 rpm
--	----------

Engineering Bearing Attributes

Float	0.083 in 2.108 mm
--------------	----------------------

Shaft Tolerance	0.0015 in 0.038 mm
------------------------	-----------------------

Engineering Internal Radial Clearance

Eng Internal Radial Clearance - Min	0.0016
--	--------

Eng Internal Radial Clearance - Max	0.0026
--	--------

Pre Install Clearance Min	0.0016 in 0.040 mm
----------------------------------	-----------------------

Pre Install Clearance Max	0.0026 in 0.065 mm
----------------------------------	-----------------------

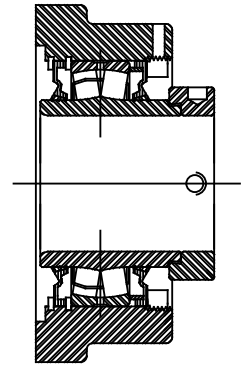
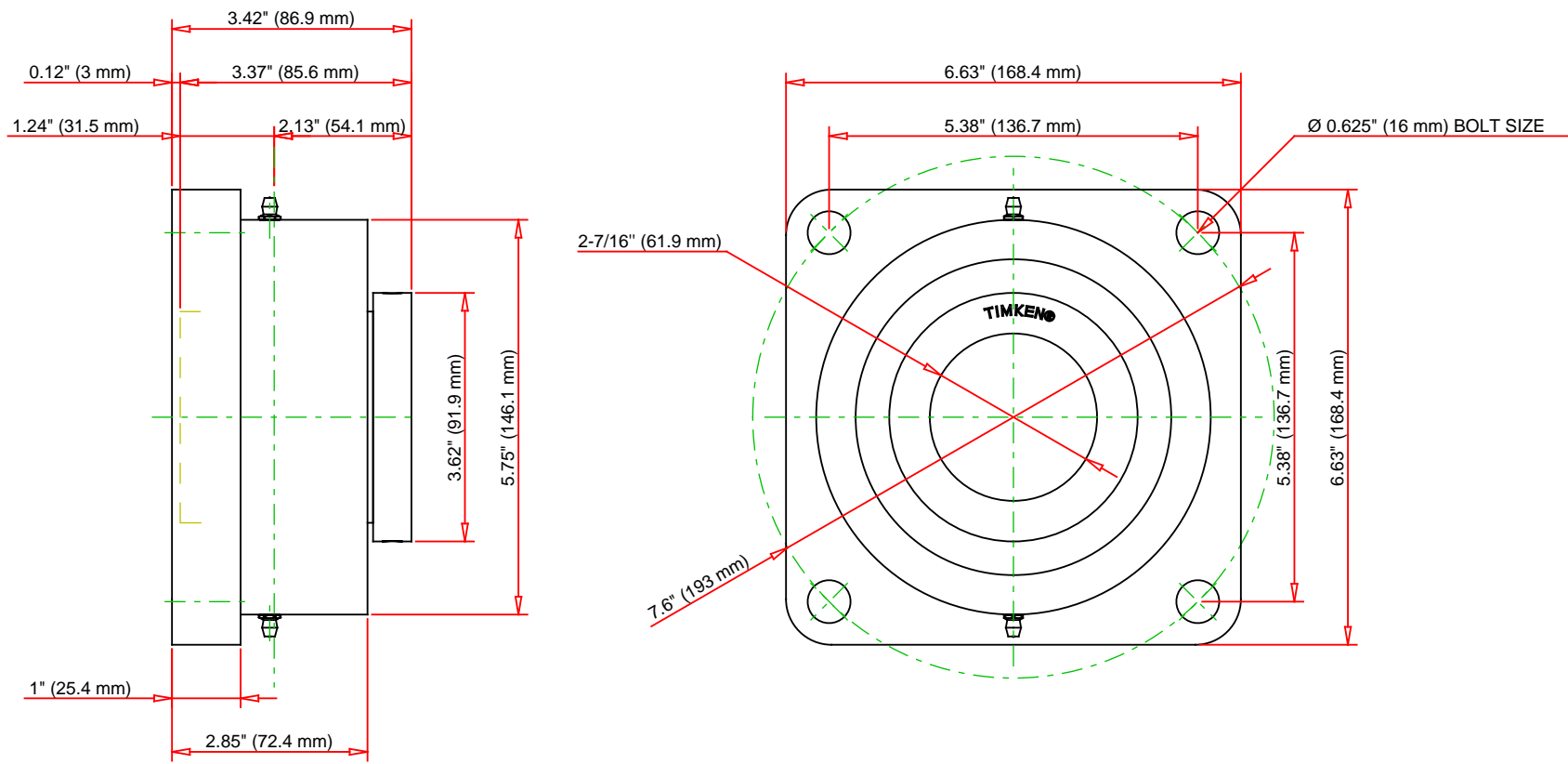

Note: Section View not to Scale

C - Dynamic Load	46400	lbf	206000	N
C0 - Static Load	48600	lbf	216000	N
Weight	17	lb	7.7	kg
Max. Speed T-Seals & Grease	2800	rpm		
Rad. Clearance - Max.	0.0026			

TIMKEN
 THE TIMKEN COMPANY
 NORTH CANTON, OHIO USA

QMF13J207S
 Eccentric Four Bolt Square Flange
 Block

Every reasonable effort has been made to ensure the accuracy of the information contained in this writing, but no liability is accepted for errors, omissions or for any other reason.

FOR DISCUSSION ONLY