



The Timken Company

4500 Mt Pleasant St. NW

N. Canton, OH 44720

Phone: (234) 262-3000

E-Mail: CustomerCAD@timken.com • **Web site:** www.timken.com

Part Number QMFL10J200S, Eccentric Four Bolt Square Flange Block

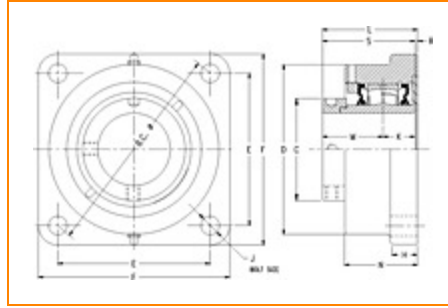

[Specifications](#) | [Dimensions](#) | [Radial and Thrust Factors](#) | [Engineering Seal Speed](#) | [Engineering Bearing Attributes](#) | [Engineering Internal Radial Clearance](#)

Specifications

Engineering Group Mounted Bearing

Bearing Number 22210

Shaft Size 2 in

Shaft Size Type Imperial

Full Timken Part Number

- QMFL10J200SB
- QMFL10J200SC
- QMFL10J200SEB
- QMFL10J200SEC
- QMFL10J200SEM
- QMFL10J200SEN
- QMFL10J200SEO
- QMFL10J200SET
- QMFL10J200SM
- QMFL10J200SN
- QMFL10J200SO



QMFL10J200ST

Locking Style

Eccentric

Housing Construction

Four-Bolt Square Flange

UPC Code

0883450070027
0883450070034
0883450070058
0883450070065
0883450070072
0883450070089
0883450070096
0883450070102
0883450162920
0883450163262
0883450255264
0883450255608

Dimensions**Dimension BC**

5.75 in
146.1 mm

Dimension C

2.76 in
70.1 mm

Dimension D

4.54 in
115.3 mm

Dimension E

4.07 in
103.4 mm

Dimension F

5.19 in
131.8 mm

Dimension H

0.91 in
23.1 mm

Dimension J (Bolt Size)

0.5 in
12 mm

Dimension K

0.98 in
24.9 mm

Dimension L Exp	3.26 in 82.8 mm
------------------------	--------------------

Dimension L Fix	3.18 in 80.8 mm
------------------------	--------------------

Dimension M	1.89 in 48 mm
--------------------	------------------

Dimension N	2.46 in 62.5 mm
--------------------	--------------------

Dimension R	0.31 in 7.9 mm
--------------------	-------------------

Dimension S	2.87 in 72.9 mm
--------------------	--------------------

Radial and Thrust Factors

C0 - Static Load	26600 lbf 118000 N
-------------------------	-----------------------

C - Dynamic Load (Basic)	26300 lbf 117000 N
---------------------------------	-----------------------

e - Geometry Factor	0.25
----------------------------	------

Y1 - Geometry Factor	2.71
-----------------------------	------

Y2 - Geometry Factor	4.04
-----------------------------	------

Engineering Seal Speed

Oil Lubrication - M/N Seal	2400 rpm
-----------------------------------	----------

Oil Lubrication - T Seal	4200 rpm
---------------------------------	----------

Oil Lubrication - B/C/O Seal	1800 rpm
-------------------------------------	----------

Grease Lubrication - M/N Seal	2400 rpm
--------------------------------------	----------

Grease Lubrication - T Seal	3550 rpm
------------------------------------	----------

Grease Lubrication - B/C/O Seal	1800 rpm
--	----------

Engineering Bearing Attributes

Float	0.050 in 1.270 mm
--------------	----------------------

Shaft Tolerance	0.0015 in 0.038 mm
------------------------	-----------------------

Engineering Internal Radial Clearance

Eng Internal Radial Clearance - Min	0.0016
--	--------

Eng Internal Radial Clearance - Max	0.0026
--	--------

Pre Install Clearance Min	0.0016 in 0.040 mm
----------------------------------	-----------------------

Pre Install Clearance Max	0.0026 in 0.065 mm
----------------------------------	-----------------------

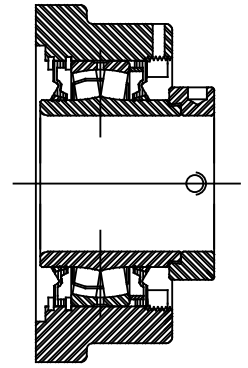
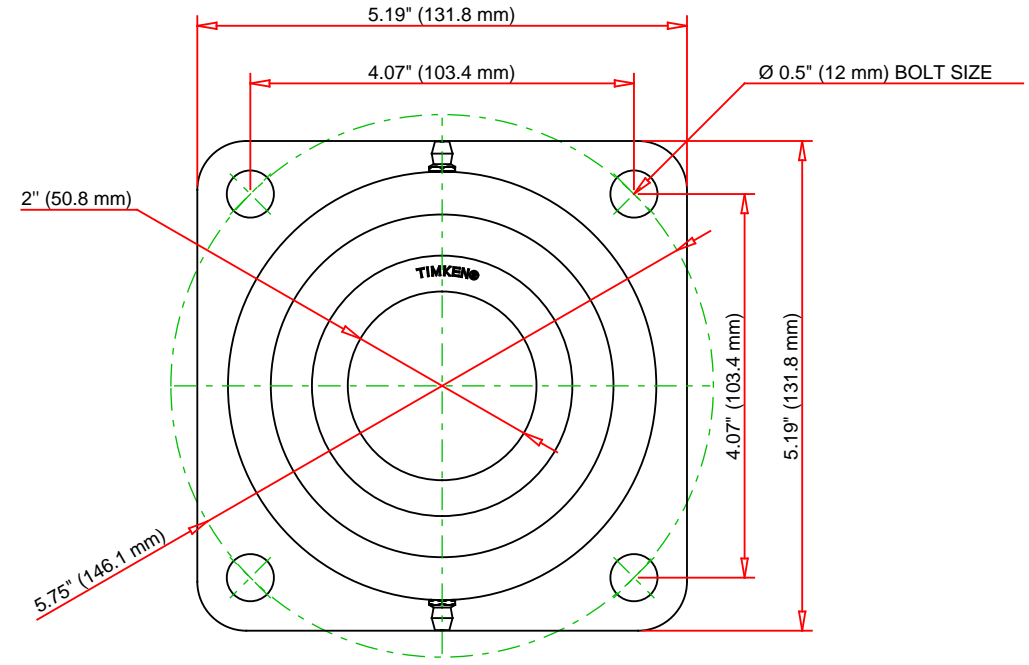
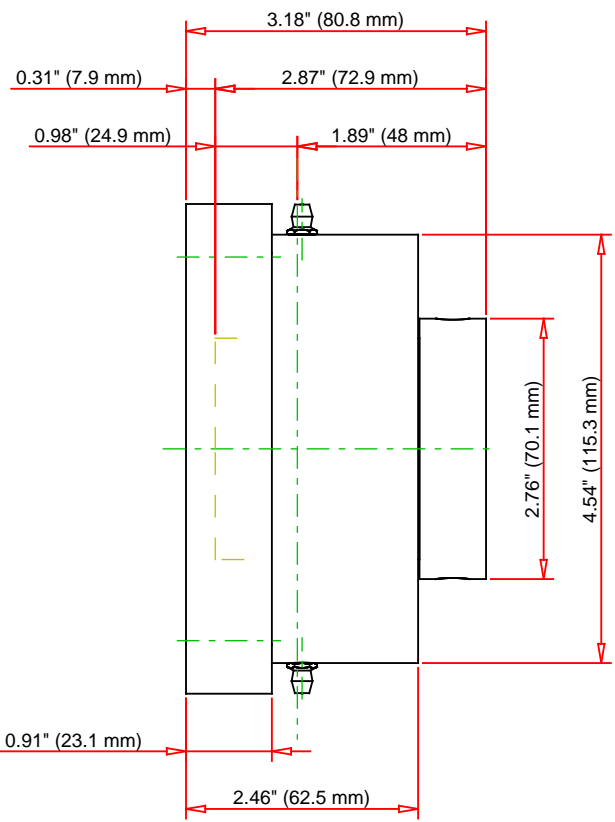

Note: Section View not to Scale

C - Dynamic Load	26300	lbf	117000	N
C0 - Static Load	26600	lbf	118000	N
Weight	11	lb	5	kg
Max. Speed T-Seals & Grease	3550	rpm		
Rad. Clearance - Max.	0.0026			

TIMKEN
 THE TIMKEN COMPANY
 NORTH CANTON, OHIO USA

QMFL10J200S
 Eccentric Four Bolt Square Flange
 Block

Every reasonable effort has been made to ensure the accuracy of the information contained in this writing, but no liability is accepted for errors, omissions or for any other reason.

FOR DISCUSSION ONLY