



The Timken Company

4500 Mt Pleasant St. NW

N. Canton, OH 44720

Phone: (234) 262-3000

E-Mail: CustomerCAD@timken.com • **Web site:** www.timken.com

Part Number QAMC18A307S, Single Concentric Cartridge Block

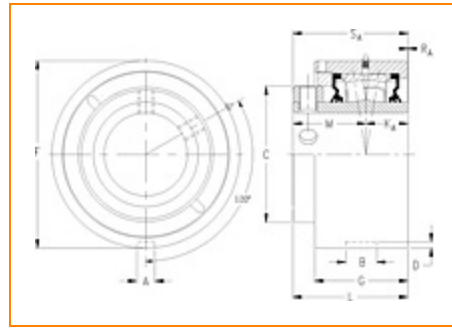

[Specifications](#) | [Dimensions](#) | [Radial and Thrust Factors](#) | [Engineering Seal Speed](#) | [Engineering Bearing Attributes](#) | [Engineering Internal Radial Clearance](#)

Specifications

Engineering Group Mounted Bearing

Bearing Number 22218

Shaft Size 3 7/16 in

Shaft Size Type Imperial

Full Timken Part Number

- QAMC18A307SB
- QAMC18A307SC
- QAMC18A307SEB
- QAMC18A307SEC
- QAMC18A307SEM
- QAMC18A307SEN
- QAMC18A307SEO
- QAMC18A307SET
- QAMC18A307SM
- QAMC18A307SN
- QAMC18A307SO
- QAMC18A307ST



QAMC18A307STSLC

Locking Style	Single Concentric
Housing Construction	Cartridge
UPC Code	0883450043809 0883450043816 0883450043830 0883450043847 0883450043854 0883450043861 0883450043878 0883450043885 0883450194600 0883450194761 0883450271776 0883450271936 0883450458399

Dimensions

Dimension A	0.59 in 15 mm
Dimension B	1.06 in 26.9 mm
Dimension C	5.13 in 130.3 mm
Dimension D	0.23 in 5.8 mm
Dimension F	6.7500 in 171.5 mm
Dimension G	3.45 in 87.6 mm
Dimension KA	1.44 in 36.6 mm

Dimension L Exp	4.42 in 112.3 mm
Dimension L Fix	4.34 in 110.2 mm
Dimension M	2.59 in 65.8 mm
Dimension RA	0.29 in 7.4 mm
Dimension SA	4.03 in 102.4 mm

Radial and Thrust Factors

C0 - Static Load	87200 lbf 388000 N
C - Dynamic Load (Basic)	79700 lbf 355000 N
e - Geometry Factor	0.23
Y1 - Geometry Factor	2.90
Y2 - Geometry Factor	4.31

Engineering Seal Speed

Oil Lubrication - M/N Seal	1400 rpm
Oil Lubrication - T Seal	2400 rpm
Oil Lubrication - B/C/O Seal	1000 rpm
Grease Lubrication - M/N Seal	1400 rpm
Grease Lubrication - T Seal	2000 rpm
Grease Lubrication - B/C/O Seal	1000 rpm

Engineering Bearing Attributes

Float	0.083 in 2.108 mm
Shaft Tolerance	0.0030 in 0.076 mm

Engineering Internal Radial Clearance

Eng Internal Radial Clearance - Min	0.0024
Eng Internal Radial Clearance - Max	0.0039
Pre Install Clearance Min	0.0024 in 0.060 mm
Pre Install Clearance Max	0.0039 in 0.100 mm

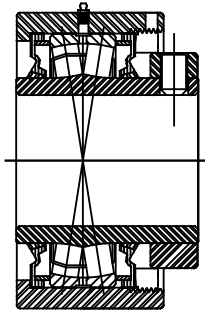
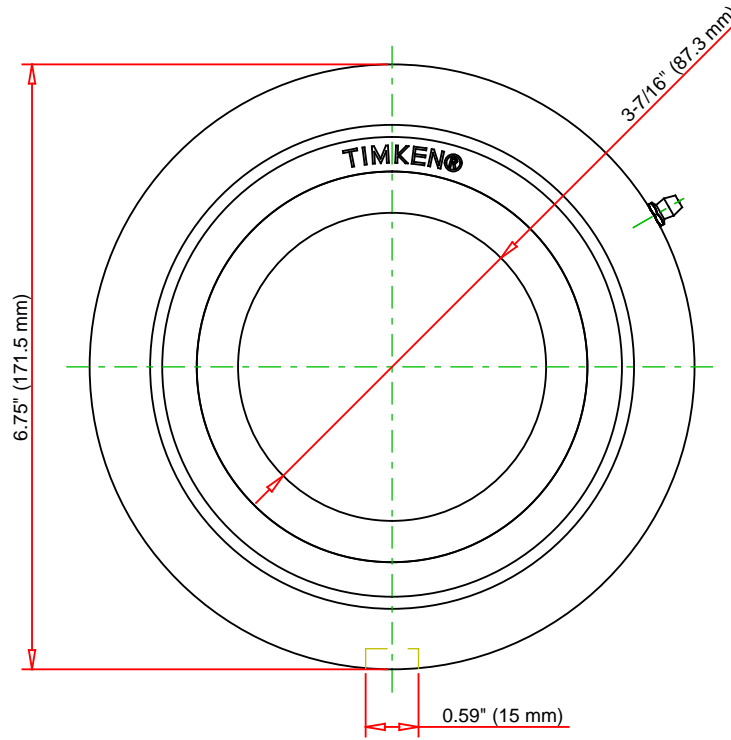
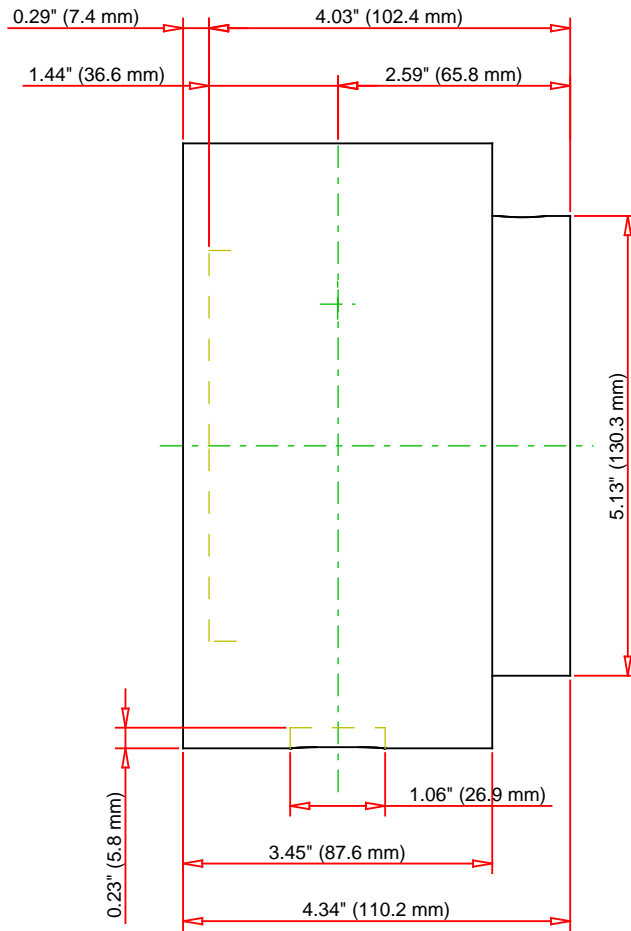

Note: Section View not to Scale

C - Dynamic Load	79700	lbf	355000	N
C0 - Static Load	87200	lbf	388000	N
Weight	26	lb	11.8	kg
Max. Speed T-Seals & Grease	2000	rpm		
Rad. Clearance - Max.	0.0039			

TIMKEN

THE TIMKEN COMPANY
NORTH CANTON, OHIO USA

QAMC18A307S
Single Concentric Cartridge Block

Every reasonable effort has been made to ensure the accuracy of the information contained in this writing, but no liability is accepted for errors, omissions or for any other reason.

FOR DISCUSSION ONLY