



**The Timken Company**

4500 Mt Pleasant St. NW

N. Canton, OH 44720

**Phone:** (234) 262-3000

**E-Mail:** [CustomerCAD@timken.com](mailto:CustomerCAD@timken.com) • **Web site:** [www.timken.com](http://www.timken.com)

Part Number QVVF11V200S, Double V-Lock Four Bolt Square Flange Block

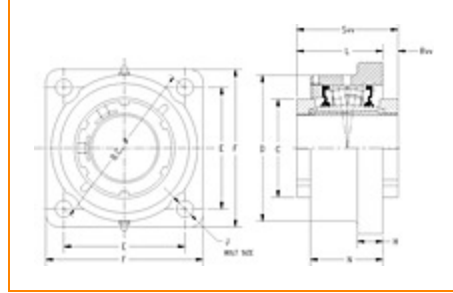

[Specifications](#) | [Dimensions](#) | [Radial and Thrust Factors](#) | [Engineering Seal Speed](#) | [Engineering Bearing Attributes](#) | [Engineering Internal Radial Clearance](#)

Specifications -

<b>Engineering Group</b>	Mounted Bearing
<b>Bearing Number</b>	22211
<b>Shaft Size</b>	2 in
<b>Shaft Size Type</b>	Imperial
<b>Full Timken Part Number</b>	QVVF11V200SB QVVF11V200SC QVVF11V200SEB QVVF11V200SEC QVVF11V200SEM QVVF11V200SEN QVVF11V200SEO QVVF11V200SET QVVF11V200SM QVVF11V200SN QVVF11V200SO



QVVF11V200ST

**Locking Style**

Double V-Lock

**Housing Construction**

Four-Bolt Square Flange

**UPC Code**

0883450091855  
0883450091985  
0883450104869  
0883450105064  
0883450110709  
0883450111089  
0883450120760  
0883450120890  
0883450135016  
0883450135610  
0883450141758  
0883450142045

**Dimensions****Dimension BC**

6.18 in  
157 mm

**Dimension C**

2.99 in  
75.9 mm

**Dimension D**

4.75 in  
120.7 mm

**Dimension L**

3.31 in  
84.1 mm

**Dimension E**

4.38 in  
111.3 mm

**Dimension F**

5.5000 in  
139.700 mm

**Dimension H**

0.88 in  
22.4 mm

**Dimension J (Bolt Size)**

0.5 in  
12 mm

<b>Dimension L Exp</b>	3.39 in 86.1 mm
<b>Dimension L Fix</b>	3.31 in 84.1 mm
<b>Dimension N</b>	2.56 in 65 mm
<b>Dimension RVV</b>	0.72 in 18.3 mm
<b>Dimension SVV</b>	4.02 in 102.1 mm

### Radial and Thrust Factors

<b>C0 - Static Load</b>	31900 lbf 142000 N
<b>C - Dynamic Load (Basic)</b>	31400 lbf 140000 N
<b>e - Geometry Factor</b>	0.25
<b>Y1 - Geometry Factor</b>	2.74
<b>Y2 - Geometry Factor</b>	4.08

### Engineering Seal Speed

<b>Oil Lubrication - M/N Seal</b>	2200 rpm
<b>Oil Lubrication - T Seal</b>	3800 rpm
<b>Oil Lubrication - B/C/O Seal</b>	1800 rpm
<b>Grease Lubrication - M/N Seal</b>	2200 rpm
<b>Grease Lubrication - T Seal</b>	3200 rpm
<b>Grease Lubrication - B/C/O Seal</b>	1600 rpm

## Engineering Bearing Attributes

<b>Float</b>	0.050 in 1.270 mm
<b>Shaft Tolerance</b>	0.0015 in 0.038 mm

## Engineering Internal Radial Clearance

<b>Eng Internal Radial Clearance - Min</b>	0.0030
<b>Eng Internal Radial Clearance - Max</b>	0.0037
<b>Pre Install Clearance Min</b>	0.0030 in 0.075 mm
<b>Pre Install Clearance Max</b>	0.0037 in 0.094 mm

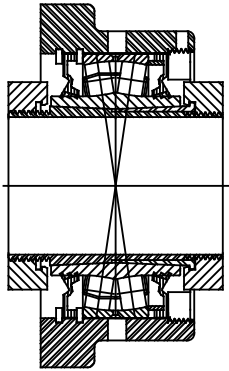
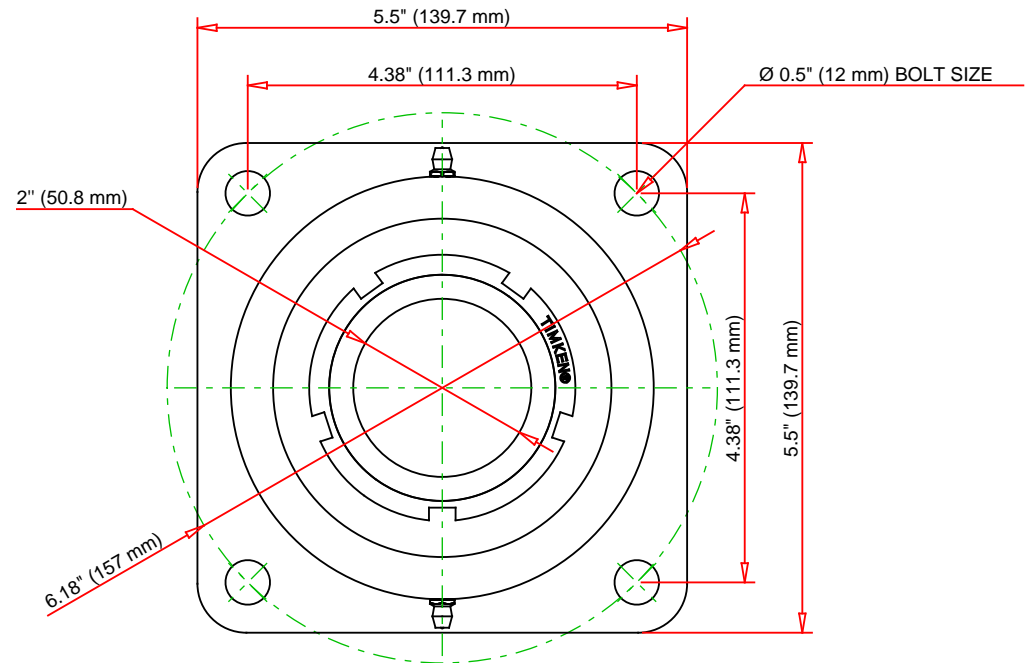
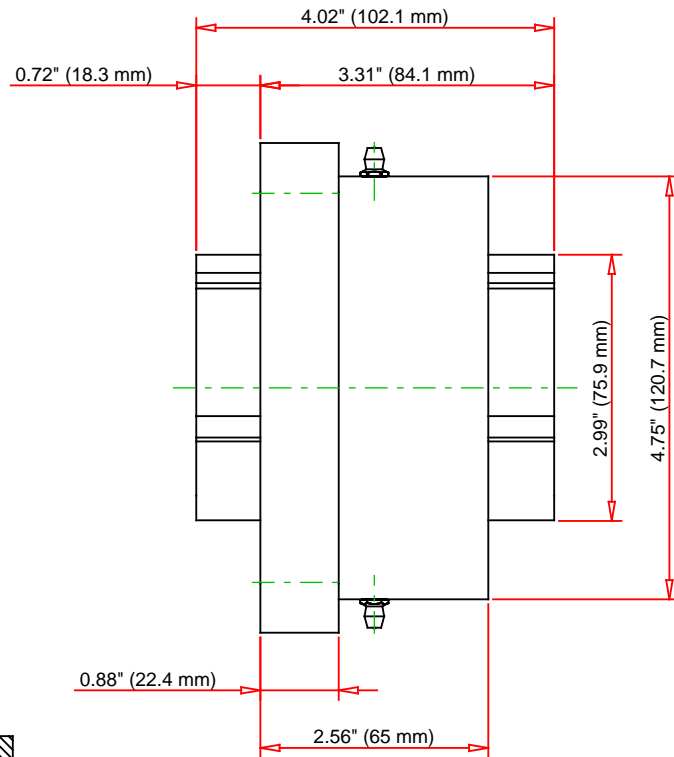

Note: Section View not to Scale

C - Dynamic Load	31400	lbf	140000	N
C0 - Static Load	31900	lbf	142000	N
Weight	11	lb	5	kg
Max. Speed T-Seals & Grease	3200	rpm		
Rad. Clearance - Max.	0.0037			

**TIMKEN**

THE TIMKEN COMPANY  
NORTH CANTON, OHIO USA

**QVVF11V200S**

Double V-Lock Four Bolt Square  
Flange Block

Every reasonable effort has been made to ensure the accuracy of the information contained in this writing, but no liability is accepted for errors, omissions or for any other reason.

**FOR DISCUSSION ONLY**