

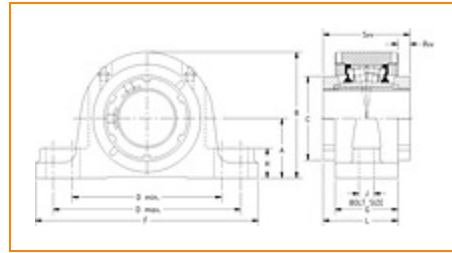

The Timken Company

4500 Mt Pleasant St. NW

N. Canton, OH 44720

Phone: (234) 262-3000

E-Mail: CustomerCAD@timken.com • **Web site:** www.timken.com
Part Number QVVP11V115S, Double V-Lock Two-Bolt Pillow Block

[Specifications](#) | [Dimensions](#) | [Radial and Thrust Factors](#) | [Engineering Seal Speed](#) | [Engineering Bearing Attributes](#) | [Engineering Internal Radial Clearance](#)

Specifications

Engineering Group Mounted Bearing

Bearing Number 22211

Shaft Size 1 15/16 in

Shaft Size Type Imperial

Full Timken Part Number

- QVVP11V115SB
- QVVP11V115SC
- QVVP11V115SEB
- QVVP11V115SEC
- QVVP11V115SEM
- QVVP11V115SEN
- QVVP11V115SEO
- QVVP11V115SET
- QVVP11V115SM
- QVVP11V115SN
- QVVP11V115SO
- QVVP11V115ST



Locking Style	Double V-Lock
Housing Construction	Two-Bolt Pillow Block
UPC Code	0883450032438 0883450032544 0883450094948 0883450095419 0883450106832 0883450106962 0883450113489 0883450113762 0883450126465 0883450126892 0883450137591 0883450137683

Dimensions

Dimension A	2.25 in 57.2 mm
Dimension B	4.81 in 122.2 mm
Dimension C	2.99 in 75.9 mm
Dimension D Min	6 in 152.4 mm
Dimension D Max	7.13 in 181.1 mm
Dimension F	8.88 in 225.6 mm
Dimension G	2.44 in 62 mm
Dimension H	1-1/4 in 31.8 mm

Dimension J (Bolt Size)	0.625 in 16 mm
Dimension L	3.23 in 82 mm
Dimension RVV	0.79 in 20.1 mm
Dimension SVV	4.02 in 102.1 mm

Radial and Thrust Factors

C0 - Static Load	31900 lbf 142000 N
C - Dynamic Load (Basic)	31400 lbf 140000 N
e - Geometry Factor	0.23
Y1 - Geometry Factor	2.95
Y2 - Geometry Factor	4.40

Engineering Seal Speed

Oil Lubrication - M/N Seal	2200 rpm
Oil Lubrication - T Seal	3800 rpm
Oil Lubrication - B/C/O Seal	1800 rpm
Grease Lubrication - M/N Seal	2200 rpm
Grease Lubrication - T Seal	3200 rpm
Grease Lubrication - B/C/O Seal	1600 rpm

Engineering Bearing Attributes

Float	0.050 in 1.270 mm
Shaft Tolerance	0.0015 in 0.038 mm

Engineering Internal Radial Clearance

Eng Internal Radial Clearance - Min	0.0030
Eng Internal Radial Clearance - Max	0.0037
Pre Install Clearance Min	0.0030 in 0.075 mm
Pre Install Clearance Max	0.0037 in 0.094 mm

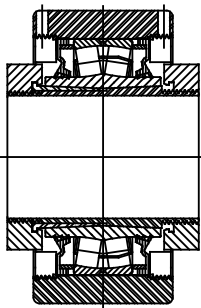
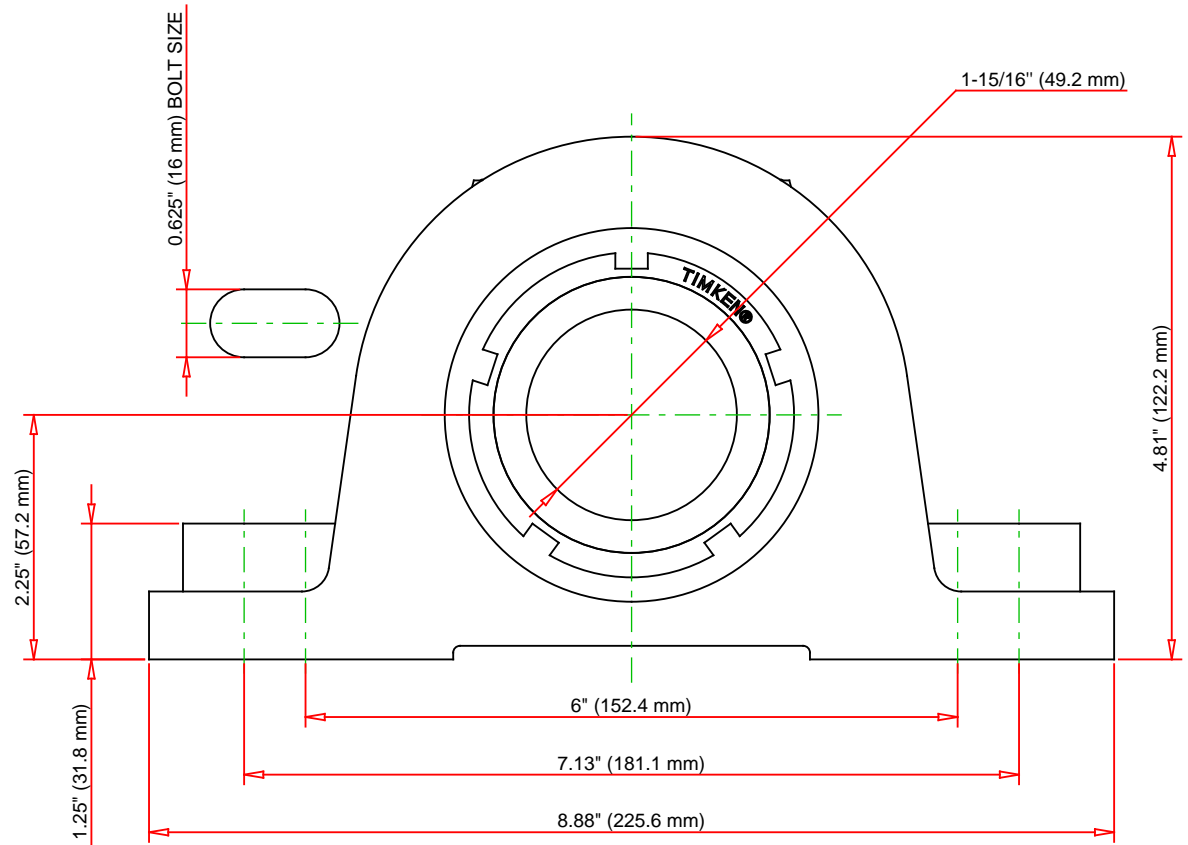
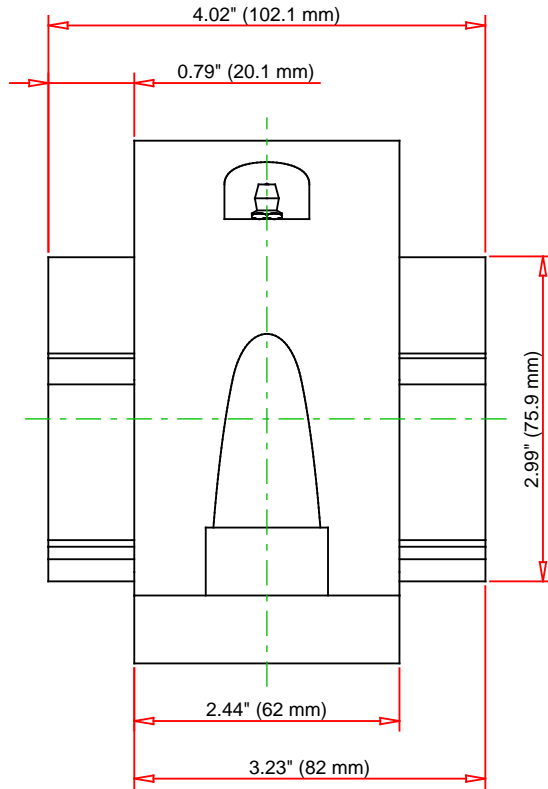

Note: Section View not to Scale

C - Dynamic Load	31400	lbf	140000	N
C0 - Static Load	31900	lbf	142000	N
Weight	14	lb	6.4	kg
Max. Speed T-Seals & Grease	3200	rpm		
Rad. Clearance - Max.	0.0037			

TIMKEN

THE TIMKEN COMPANY
NORTH CANTON, OHIO USA

QVVP11V115S
Double V-Lock Two-Bolt Pillow Block

Every reasonable effort has been made to ensure the accuracy of the information contained in this writing, but no liability is accepted for errors, omissions or for any other reason.

FOR DISCUSSION ONLY