



**The Timken Company**

4500 Mt Pleasant St. NW

N. Canton, OH 44720

**Phone:** (234) 262-3000

**E-Mail:** [CustomerCAD@timken.com](mailto:CustomerCAD@timken.com) • **Web site:** [www.timken.com](http://www.timken.com)

## Part Number QVVP12V055S, Double V-Lock Two-Bolt Pillow Block

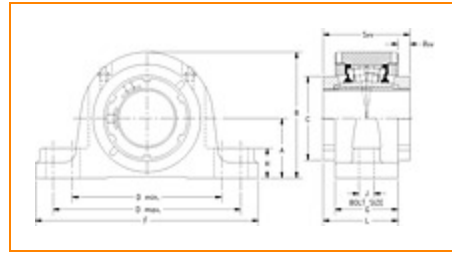

[Specifications](#) | [Dimensions](#) | [Radial and Thrust Factors](#) | [Engineering Seal Speed](#) | [Engineering Bearing Attributes](#) | [Engineering Internal Radial Clearance](#)

### Specifications

**Engineering Group** Mounted Bearing

**Bearing Number** 22212

**Shaft Size** 55 mm

**Shaft Size Type** Metric

**Full Timken Part Number**

- QVVP12V055SB
- QVVP12V055SC
- QVVP12V055SEB
- QVVP12V055SEC
- QVVP12V055SEM
- QVVP12V055SEN
- QVVP12V055SEO
- QVVP12V055SET
- QVVP12V055SM
- QVVP12V055SN
- QVVP12V055SO
- QVVP12V055ST



<b>Locking Style</b>	Double V-Lock
<b>Housing Construction</b>	Two-Bolt Pillow Block
<b>UPC Code</b>	0883450032483 0883450032605 0883450095211 0883450095648 0883450106900 0883450107044 0883450113649 0883450113908 0883450126694 0883450127165 0883450137645 0883450137737

## Dimensions

<b>Dimension A</b>	2-1/2 in 63.5 mm
<b>Dimension B</b>	5-1/4 in 133.4 mm
<b>Dimension C</b>	3.16 in 80.3 mm
<b>Dimension D Min</b>	6.5 in 165.1 mm
<b>Dimension D Max</b>	7.88 in 200.2 mm
<b>Dimension F</b>	9.63 in 244.6 mm
<b>Dimension G</b>	2.63 in 66.8 mm
<b>Dimension H</b>	1-1/4 in 31.8 mm

<b>Dimension J (Bolt Size)</b>	0.625 in 16 mm
<b>Dimension L</b>	3.33 in 84.6 mm
<b>Dimension RVV</b>	0.70 in 17.8 mm
<b>Dimension SVV</b>	4.02 in 102.1 mm

### Radial and Thrust Factors

<b>C0 - Static Load</b>	39000 lbf 174000 N
<b>C - Dynamic Load (Basic)</b>	38100 lbf 169000 N
<b>e - Geometry Factor</b>	0.24
<b>Y1 - Geometry Factor</b>	2.84
<b>Y2 - Geometry Factor</b>	4.23

### Engineering Seal Speed

<b>Oil Lubrication - M/N Seal</b>	2000 rpm
<b>Oil Lubrication - T Seal</b>	3500 rpm
<b>Oil Lubrication - B/C/O Seal</b>	1650 rpm
<b>Grease Lubrication - M/N Seal</b>	2000 rpm
<b>Grease Lubrication - T Seal</b>	3000 rpm
<b>Grease Lubrication - B/C/O Seal</b>	1550 rpm

### Engineering Bearing Attributes

<b>Float</b>	0.050 in 1.270 mm
--------------	----------------------

<b>Shaft Tolerance</b>	0.0015 in 0.038 mm
------------------------	-----------------------

## Engineering Internal Radial Clearance

<b>Eng Internal Radial Clearance - Min</b>	0.0030
--	--------

<b>Eng Internal Radial Clearance - Max</b>	0.0037
--	--------

<b>Pre Install Clearance Min</b>	0.0030 in 0.075 mm
----------------------------------	-----------------------

<b>Pre Install Clearance Max</b>	0.0037 in 0.094 mm
----------------------------------	-----------------------

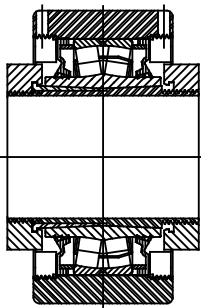
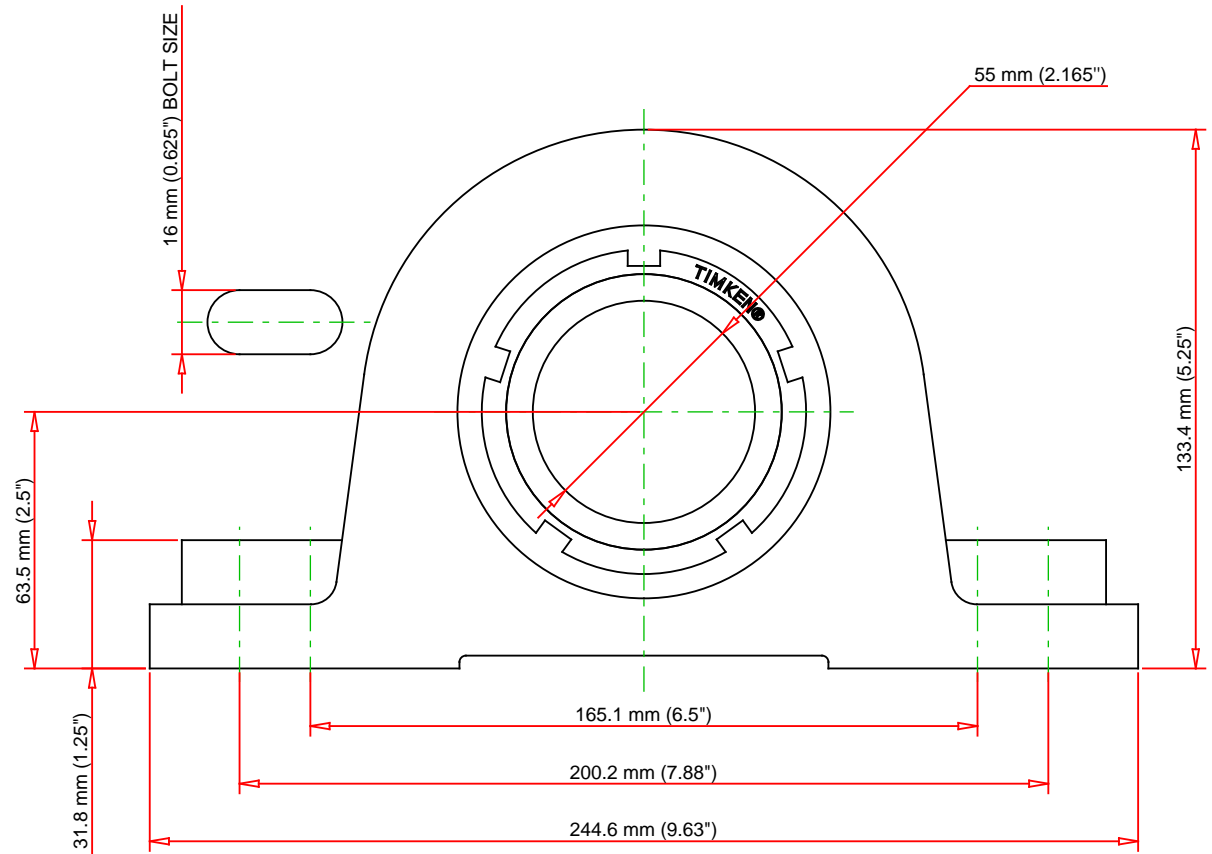
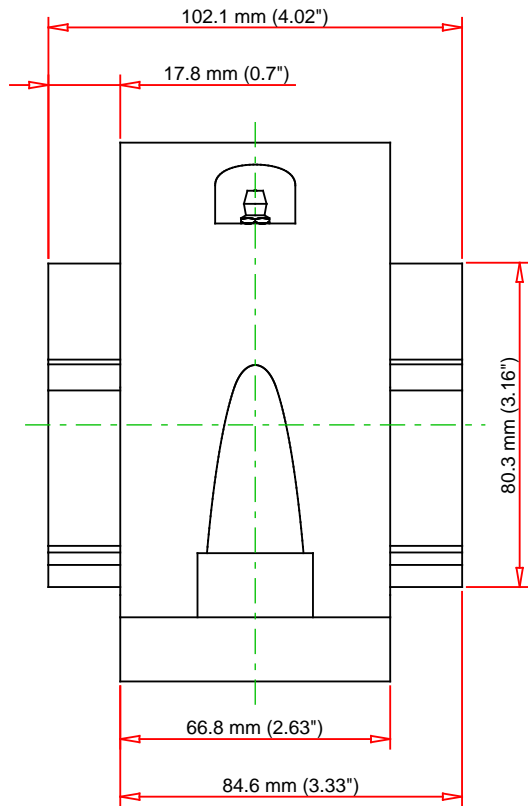

Note: Section View not to Scale

C - Dynamic Load	38100	lbf	169000	N
C0 - Static Load	39000	lbf	174000	N
Weight	17	lb	7.7	kg
Max. Speed T-Seals & Grease	3000	rpm		
Rad. Clearance - Max.	0.0037			

**TIMKEN**

THE TIMKEN COMPANY  
NORTH CANTON, OHIO USA

**QVVP12V055S**  
Double V-Lock Two-Bolt Pillow Block

Every reasonable effort has been made to ensure the accuracy of the information contained in this writing, but no liability is accepted for errors, omissions or for any other reason.

**FOR DISCUSSION ONLY**