

**The Timken Company**

4500 Mt Pleasant St. NW

N. Canton, OH 44720

**Phone:** (234) 262-3000

**E-Mail:** [CustomerCAD@timken.com](mailto:CustomerCAD@timken.com) • **Web site:** [www.timken.com](http://www.timken.com)

## Part Number QAC20A315S, Single Concentric Piloted Flange Cartridge



[Specifications](#) | [Dimensions](#) | [Radial and Thrust Factors](#) | [Engineering Seal Speed](#) | [Engineering Bearing Attributes](#) | [Engineering Internal Radial Clearance](#)

## Specifications

<b>Engineering Group</b>	Mounted Bearing
<b>Bearing Number</b>	22220
<b>Shaft Size</b>	3 15/16 in
<b>Shaft Size Type</b>	Imperial
<b>Full Timken Part Number</b>	QAC20A315SB QAC20A315SC QAC20A315SEB QAC20A315SEC QAC20A315SEM QAC20A315SEN QAC20A315SEO QAC20A315SET QAC20A315SM QAC20A315SMNP QAC20A315SMT QAC20A315SN QAC20A315SO



QAC20A315ST  
QAC20A315STHT

**Locking Style** Single Concentric

**Housing Construction** Piloted Flange Cartridge

**UPC Code**

0883450036009  
0883450036016  
0883450036030  
0883450036047  
0883450036054  
0883450036061  
0883450036078  
0883450036085  
0883450193276  
0883450193436  
0883450270465  
0883450270625  
0883450434928  
0883450456951  
0883450952798

## Dimensions

**Dimension BC** 9.38 in  
238.3 mm

**Dimension B Exp** 2.93 in  
74.4 mm

**Dimension B Fix** 2.84 in  
72.1 mm

**Dimension C** 6 in  
152.4 mm

**Dimension D** 8.13 in  
206.5 mm

**Dimension E** 6.63 in  
168.4 mm

<b>Dimension F</b>	10.88 in 276.4 mm
<b>Dimension G</b>	8.125 in 206.4 mm
<b>Dimension H</b>	1 in 25.4 mm
<b>Dimension J (Bolt Size)</b>	0.75 in 20 mm
<b>Dimension KA</b>	1.63 in 41.4 mm
<b>Dimension L Exp</b>	5.05 in 128.3 mm
<b>Dimension L Fix</b>	4.97 in 126.2 mm
<b>Dimension M</b>	2.97 in 75.4 mm
<b>Dimension N</b>	2.13 in 54.1 mm
<b>Dimension RA</b>	0.37 in 9.4 mm
<b>Dimension SA</b>	4.59 in 116.6 mm

## Radial and Thrust Factors

<b>C0 - Static Load</b>	113000 lbf 502000 N
<b>C - Dynamic Load (Basic)</b>	97700 lbf 435000 N
<b>e - Geometry Factor</b>	0.24
<b>Y1 - Geometry Factor</b>	2.85

<b>Y2 - Geometry Factor</b>	4.24
-----------------------------	------

### Engineering Seal Speed

<b>Oil Lubrication - M/N Seal</b>	1200 rpm
<b>Oil Lubrication - T Seal</b>	2000 rpm
<b>Oil Lubrication - B/C/O Seal</b>	900 rpm
<b>Grease Lubrication - M/N Seal</b>	1200 rpm
<b>Grease Lubrication - T Seal</b>	1600 rpm
<b>Grease Lubrication - B/C/O Seal</b>	900 rpm

### Engineering Bearing Attributes

<b>Float</b>	0.083 in 2.108 mm
<b>Shaft Tolerance</b>	0.0030 in 0.076 mm

### Engineering Internal Radial Clearance

<b>Eng Internal Radial Clearance - Min</b>	0.0030
<b>Eng Internal Radial Clearance - Max</b>	0.0047
<b>Pre Install Clearance Min</b>	0.0030 in 0.075 mm
<b>Pre Install Clearance Max</b>	0.0047 in 0.120 mm

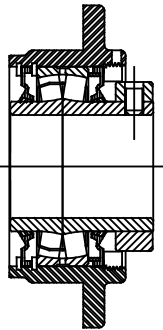
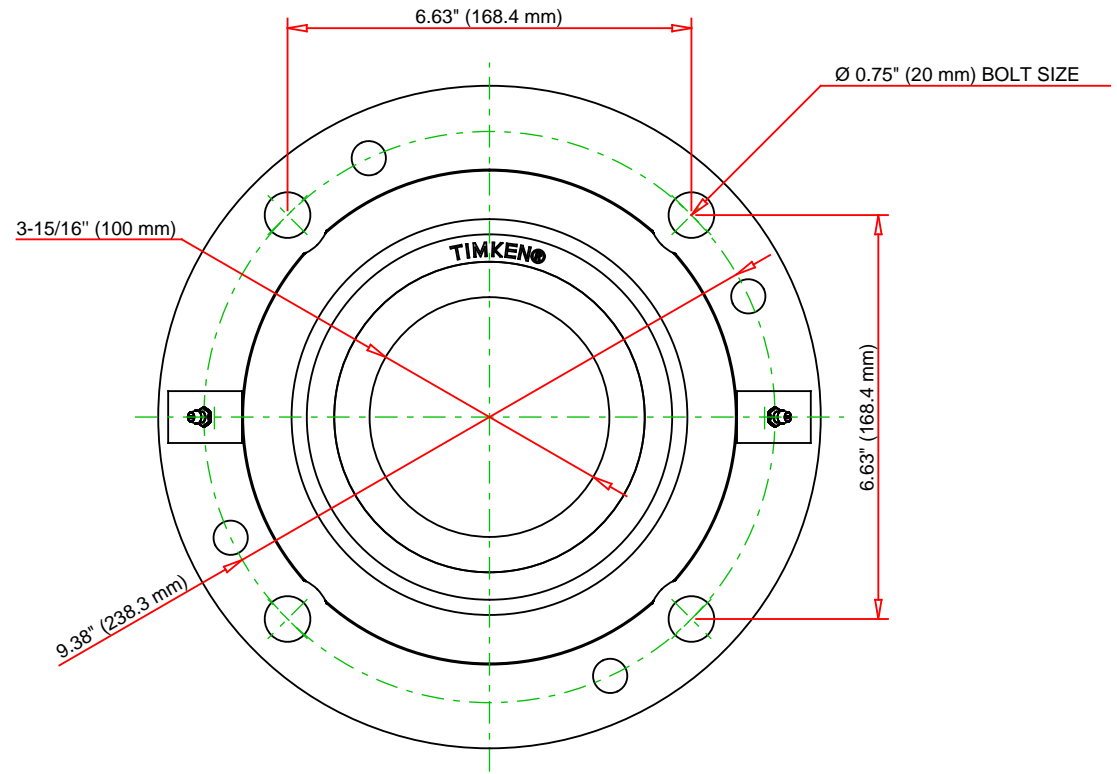
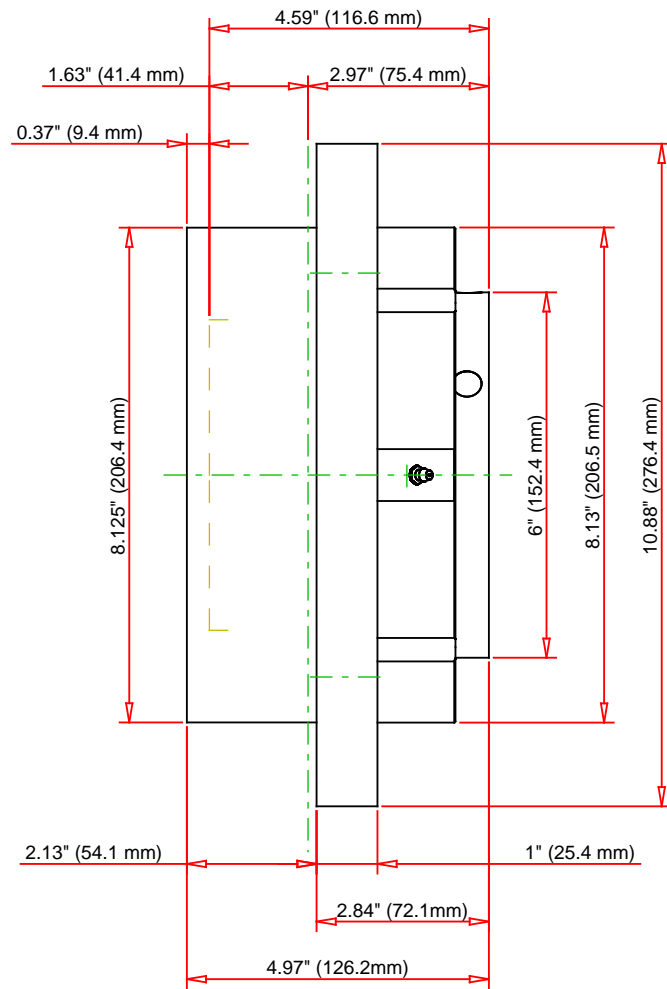

Note: Section View not to Scale

C - Dynamic Load	97700	lbf	435000	N
C0 - Static Load	113000	lbf	502000	N
Weight	43	lb	19.5	kg
Max. Speed T-Seals & Grease	1600	rpm		
Rad. Clearance - Max.	0.0047			

**TIMKEN**

THE TIMKEN COMPANY  
NORTH CANTON, OHIO USA

**QAC20A315S**

Single Concentric Piloted Flange  
Cartridge

Every reasonable effort has been made to ensure the accuracy of the information contained in this writing, but no liability is accepted for errors, omissions or for any other reason.

**FOR DISCUSSION ONLY**