

The Timken Company

4500 Mt Pleasant St. NW

N. Canton, OH 44720

Phone: (234) 262-3000

E-Mail: CustomerCAD@timken.com • **Web site:** www.timken.com

Part Number QACW18A308S, Single Concentric Piloted Flange Cartridge



[Specifications](#) | [Dimensions](#) | [Radial and Thrust Factors](#) | [Engineering Seal Speed](#) | [Engineering Bearing Attributes](#) | [Engineering Internal Radial Clearance](#)

Specifications

Engineering Group	Mounted Bearing
Bearing Number	22218
Shaft Size	3 1/2 in
Shaft Size Type	Imperial
Full Timken Part Number	QACW18A308SB QACW18A308SC QACW18A308SEB QACW18A308SEC QACW18A308SEM QACW18A308SEN QACW18A308SEO QACW18A308SET QACW18A308SM QACW18A308SN QACW18A308SO QACW18A308ST



Locking Style	Single Concentric
----------------------	-------------------

Housing Construction	Piloted Flange Cartridge
-----------------------------	--------------------------

UPC Code	0883450037501
	0883450037518
	0883450037532
	0883450037549
	0883450037556
	0883450037563
	0883450037570
	0883450037587
	0883450193931
	0883450194099
0883450271103	
0883450271264	

Dimensions

Dimension BC	8.63 in 219.2 mm
---------------------	---------------------

Dimension B Exp	2.54 in 64.5 mm
------------------------	--------------------

Dimension B Fix	2.46 in 62.5 mm
------------------------	--------------------

Dimension C	5.13 in 130.3 mm
--------------------	---------------------

Dimension D	7.13 in 181.1 mm
--------------------	---------------------

Dimension E	6.1 in 154.9 mm
--------------------	--------------------

Dimension F	10-1/4 in 260.4 mm
--------------------	-----------------------

Dimension G	7.375 in 187.3 mm
--------------------	----------------------

Dimension H	0.88 in 22.4 mm
Dimension J (Bolt Size)	0.75 in 20 mm
Dimension KA	1.44 in 36.6 mm
Dimension L Exp	4.42 in 112.3 mm
Dimension L Fix	4.34 in 110.2 mm
Dimension M	2.59 in 65.8 mm
Dimension N	1.88 in 47.8 mm
Dimension RA	0.3 in 7.6 mm
Dimension SA	4.03 in 102.4 mm

Radial and Thrust Factors

C0 - Static Load	87200 lbf 388000 N
C - Dynamic Load (Basic)	79700 lbf 355000 N
e - Geometry Factor	0.23
Y1 - Geometry Factor	2.90
Y2 - Geometry Factor	4.31

Engineering Seal Speed

Oil Lubrication - M/N Seal	1400 rpm
-----------------------------------	----------

Oil Lubrication - T Seal	2400 rpm
---------------------------------	----------

Oil Lubrication - B/C/O Seal	1000 rpm
-------------------------------------	----------

Grease Lubrication - M/N Seal	1400 rpm
--------------------------------------	----------

Grease Lubrication - T Seal	2000 rpm
------------------------------------	----------

Grease Lubrication - B/C/O Seal	1000 rpm
--	----------

Engineering Bearing Attributes

Float	0.083 in 2.108 mm
--------------	----------------------

Shaft Tolerance	0.0030 in 0.076 mm
------------------------	-----------------------

Engineering Internal Radial Clearance

Eng Internal Radial Clearance - Min	0.0024
--	--------

Eng Internal Radial Clearance - Max	0.0039
--	--------

Pre Install Clearance Min	0.0024 in 0.060 mm
----------------------------------	-----------------------

Pre Install Clearance Max	0.0039 in 0.100 mm
----------------------------------	-----------------------

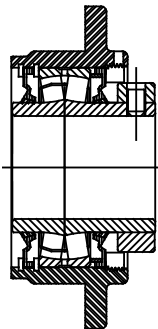
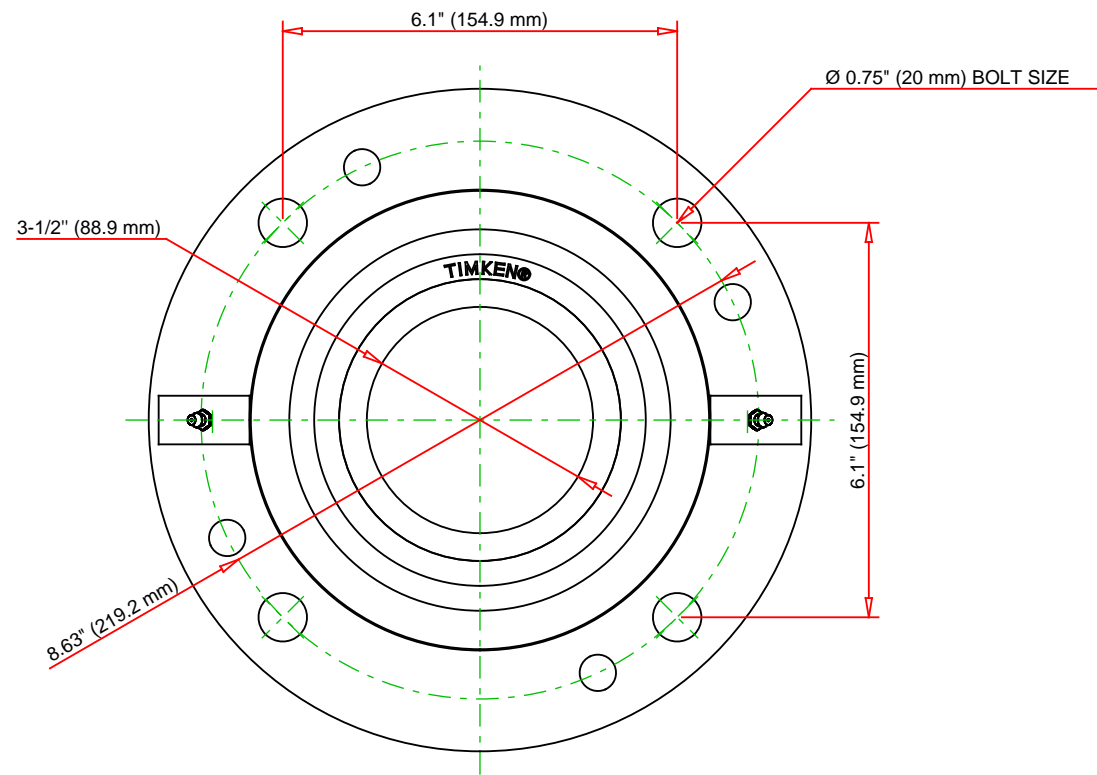
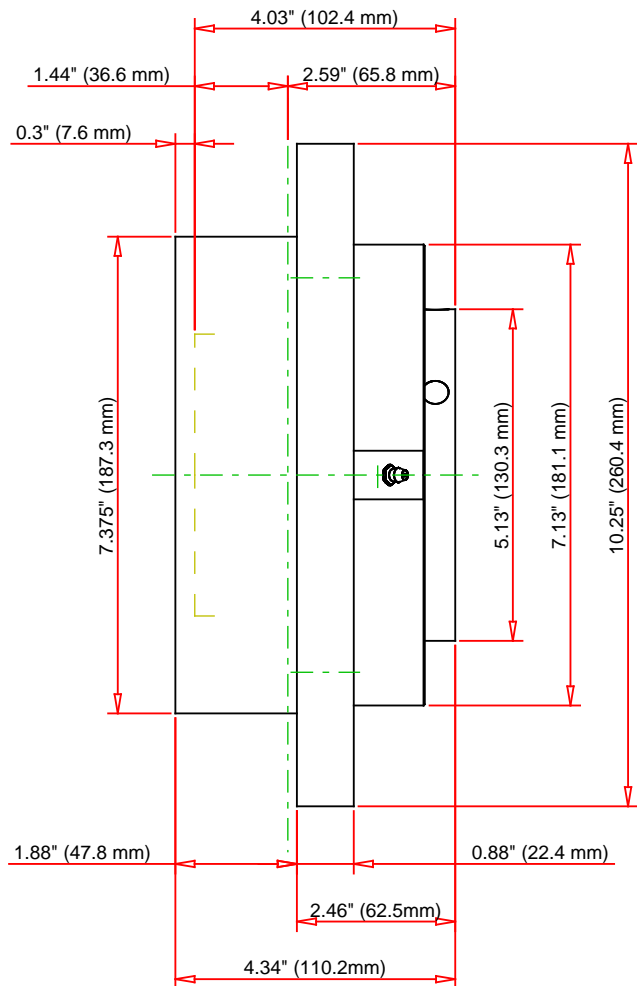

Note: Section View not to Scale

C - Dynamic Load	79700	lbf	355000	N
C0 - Static Load	87200	lbf	388000	N
Weight	32	lb	14.5	kg
Max. Speed T-Seals & Grease	2000	rpm		
Rad. Clearance - Max.	0.0039			

TIMKEN

THE TIMKEN COMPANY
NORTH CANTON, OHIO USA

QACW18A308S
Single Concentric Piloted Flange
Cartridge

Every reasonable effort has been made to ensure the accuracy of the information contained in this writing, but no liability is accepted for errors, omissions or for any other reason.

FOR DISCUSSION ONLY