



The Timken Company

4500 Mt Pleasant St. NW

N. Canton, OH 44720

Phone: (234) 262-3000

E-Mail: CustomerCAD@timken.com • **Web site:** www.timken.com

Part Number QMCW34J608S, Eccentric Piloted Flange Cartridge

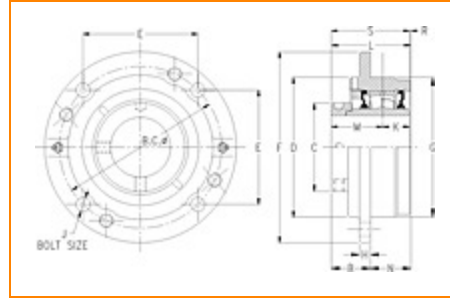

[Specifications](#) | [Dimensions](#) | [Radial and Thrust Factors](#) | [Engineering Seal Speed](#) | [Engineering Bearing Attributes](#) | [Engineering Internal Radial Clearance](#)

Specifications

Engineering Group Mounted Bearing

Bearing Number 23234

Shaft Size 6 1/2 in

Shaft Size Type Imperial

Full Timken Part Number

- QMCW34J608SB
- QMCW34J608SC
- QMCW34J608SEB
- QMCW34J608SEC
- QMCW34J608SEM
- QMCW34J608SEN
- QMCW34J608SEO
- QMCW34J608SET
- QMCW34J608SM
- QMCW34J608SN
- QMCW34J608SO
- QMCW34J608ST



Locking Style	Eccentric
Housing Construction	Piloted Flange Cartridge

UPC Code	0883450382595
	0883450382601
	0883450382618
	0883450382632
	0883450382649
	0883450382656
	0883450382663
	0883450382670
	0883450382687
	0883450382694
0883450382700	
0883450382717	

Dimensions

Dimension BC	17 in 431.8 mm
---------------------	-------------------

Dimension B Exp	3.46 in 87.9 mm
------------------------	--------------------

Dimension B Fix	3.38 in 85.9 mm
------------------------	--------------------

Dimension C	9.25 in 235 mm
--------------------	-------------------

Dimension D	14 in 355.6 mm
--------------------	-------------------

Dimension E	8.5 in 215.9 mm
--------------------	--------------------

Dimension F	19.0000 in 482.600 mm
--------------------	--------------------------

Dimension G	15 in 381 mm
--------------------	-----------------

Dimension H	1.13 in 28.7 mm
Dimension J (Bolt Size)	1 in 24 mm
Dimension K	3.35 in 85.1 mm
Dimension L Exp	8.59 in 218.2 mm
Dimension L Fix	8.51 in 216.2 mm
Dimension M	5.08 in 129 mm
Dimension N	5.13 in 130.3 mm
Dimension R	0.08 in 2 mm
Dimension S	8.43 in 214.1 mm

Radial and Thrust Factors

C0 - Static Load	494000 lbf 2200000 N
C - Dynamic Load (Basic)	373000 lbf 1660000 N
e - Geometry Factor	0.33
Y1 - Geometry Factor	2.08
Y2 - Geometry Factor	3.09

Engineering Seal Speed

Oil Lubrication - M/N Seal	600 rpm
-----------------------------------	---------

Oil Lubrication - T Seal	900 rpm
---------------------------------	---------

Oil Lubrication - B/C/O Seal	350 rpm
-------------------------------------	---------

Grease Lubrication - M/N Seal	600 rpm
--------------------------------------	---------

Grease Lubrication - T Seal	800 rpm
------------------------------------	---------

Grease Lubrication - B/C/O Seal	350 rpm
--	---------

Engineering Bearing Attributes

Float	0.083 in 2.108 mm
--------------	----------------------

Shaft Tolerance	0.0050 in 0.127 mm
------------------------	-----------------------

Engineering Internal Radial Clearance

Eng Internal Radial Clearance - Min	0.0047
--	--------

Eng Internal Radial Clearance - Max	0.0071
--	--------

Pre Install Clearance Min	0.0047 in 0.120 mm
----------------------------------	-----------------------

Pre Install Clearance Max	0.0071 in 0.180 mm
----------------------------------	-----------------------

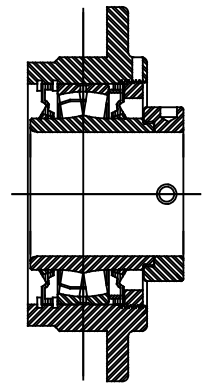
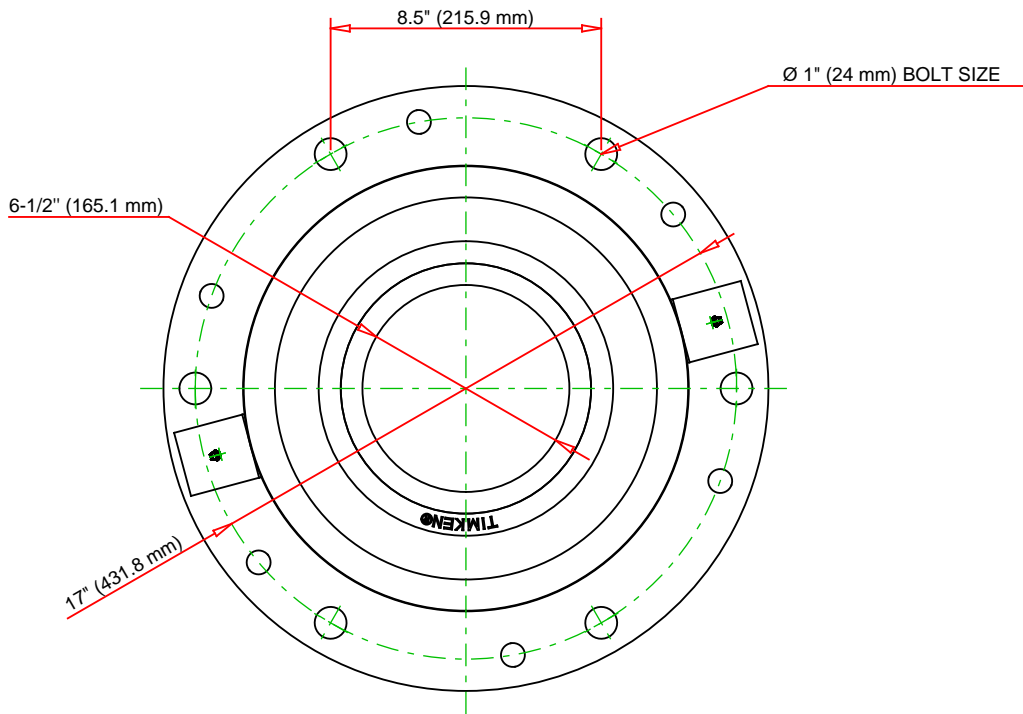
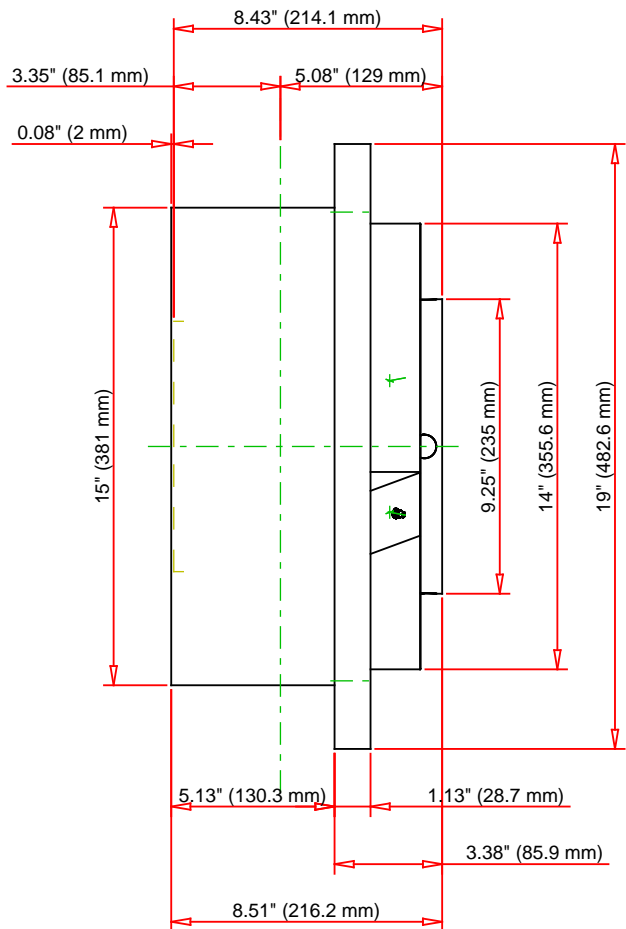

Note: Section View not to Scale

C - Dynamic Load	373000	lbf	1660000	N
C0 - Static Load	494000	lbf	2200000	N
Weight	336	lb	152.4	kg
Max. Speed T-Seals & Grease	800	rpm		
Rad. Clearance - Max.	0.0071			

TIMKEN

THE TIMKEN COMPANY
NORTH CANTON, OHIO USA

QMCW34J608S
Eccentric Piloted Flange Cartridge

Every reasonable effort has been made to ensure the accuracy of the information contained in this writing, but no liability is accepted for errors, omissions or for any other reason.

FOR DISCUSSION ONLY