

The Timken Company

4500 Mt Pleasant St. NW

N. Canton, OH 44720

Phone: (234) 262-3000

E-Mail: CustomerCAD@timken.com • **Web site:** www.timken.com

Part Number QMSN22J407S, Eccentric Two-Bolt Pillow Block



[Specifications](#) | [Dimensions](#) | [Radial and Thrust Factors](#) | [Engineering Seal Speed](#) | [Engineering Bearing Attributes](#) | [Engineering Internal Radial Clearance](#)

Specifications

Engineering Group	Mounted Bearing
Bearing Number	22222
Shaft Size	4 7/16 in
Shaft Size Type	Imperial
Full Timken Part Number	QMSN22J407SB QMSN22J407SC QMSN22J407SEB QMSN22J407SEC QMSN22J407SEM QMSN22J407SEN QMSN22J407SEO QMSN22J407SET QMSN22J407SM QMSN22J407SN QMSN22J407SO QMSN22J407ST



Locking Style	Eccentric
Housing Construction	Two-Bolt Pillow Block
UPC Code	0883450099325 0883450099332 0883450099356 0883450099363 0883450099370 0883450099394 0883450253772 0883450254168 0883450356787 0883450356794 0883450356800 0883450356817

Dimensions

Dimension A	5.91 in 150 mm
Dimension B	10.43 in 265 mm
Dimension C	6.3 in 160 mm
Dimension D Min	14.45 in 367 mm
Dimension D Max	15.75 in 400 mm
Dimension F	17.52 in 445 mm
Dimension G	4.13 in 105 mm
Dimension H	1.93 in 49 mm

Dimension J (Bolt Size)	0.875 in 24 mm
--------------------------------	-------------------

Dimension K	1.85 in 47 mm
--------------------	------------------

Dimension L	5.79 in 147 mm
--------------------	-------------------

Dimension M	3.7 in 94 mm
--------------------	-----------------

Dimension R	0.24 in 6 mm
--------------------	-----------------

Dimension S	5.55 in 141 mm
--------------------	-------------------

Radial and Thrust Factors

C0 - Static Load	147000 lbf 653000 N
-------------------------	------------------------

C - Dynamic Load (Basic)	125000 lbf 555000 N
---------------------------------	------------------------

e - Geometry Factor	0.25
----------------------------	------

Y1 - Geometry Factor	2.73
-----------------------------	------

Y2 - Geometry Factor	4.06
-----------------------------	------

Engineering Seal Speed

Oil Lubrication - M/N Seal	900 rpm
-----------------------------------	---------

Oil Lubrication - T Seal	1700 rpm
---------------------------------	----------

Oil Lubrication - B/C/O Seal	600 rpm
-------------------------------------	---------

Grease Lubrication - M/N Seal	900 rpm
--------------------------------------	---------

Grease Lubrication - T Seal	1200 rpm
------------------------------------	----------

Grease Lubrication - B/C/O Seal	600 rpm
--	---------

Engineering Bearing Attributes

Float	0.083 in 2.108 mm
--------------	----------------------

Shaft Tolerance	0.0050 in 0.127 mm
------------------------	-----------------------

Engineering Internal Radial Clearance

Eng Internal Radial Clearance - Min	0.0030
--	--------

Eng Internal Radial Clearance - Max	0.0047
--	--------

Pre Install Clearance Min	0.0030 in 0.075 mm
----------------------------------	-----------------------

Pre Install Clearance Max	0.0047 in 0.120 mm
----------------------------------	-----------------------

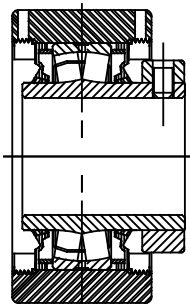
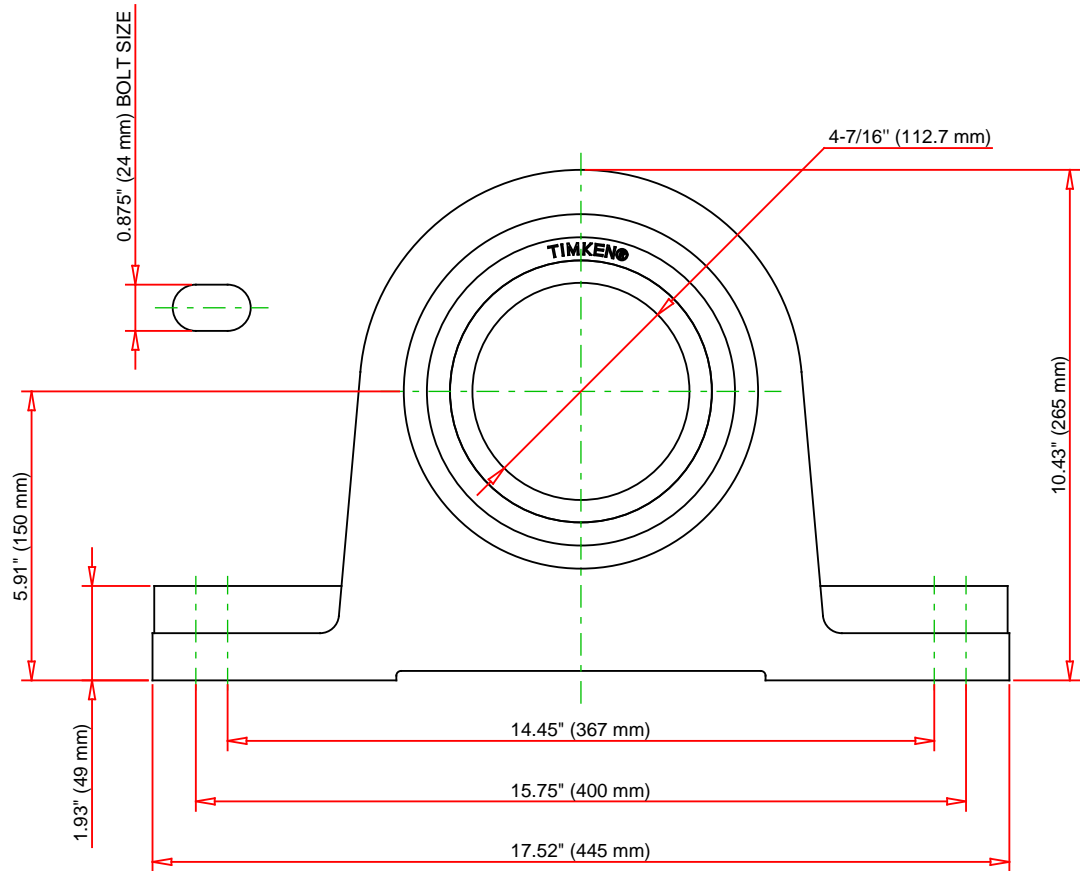
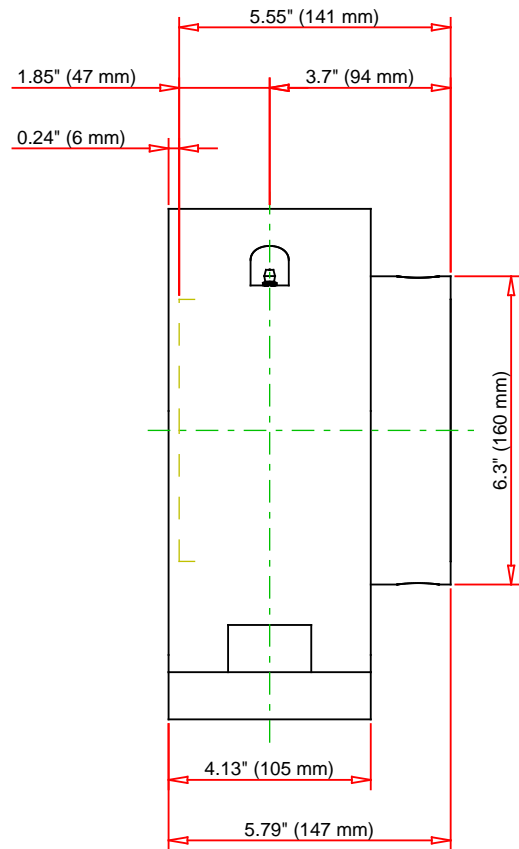

Note: Section View not to Scale

C - Dynamic Load	125000	lbf	555000	N
C0 - Static Load	147000	lbf	653000	N
Weight	78	lb	35.5	kg
Max. Speed T-Seals & Grease	1200	rpm		
Rad. Clearance - Max.	0.0047			

TIMKEN

THE TIMKEN COMPANY
NORTH CANTON, OHIO USA

QMSN22J407S
Eccentric Two-Bolt Pillow Block

Every reasonable effort has been made to ensure the accuracy of the information contained in this writing, but no liability is accepted for errors, omissions or for any other reason.

FOR DISCUSSION ONLY