

**The Timken Company**

4500 Mt Pleasant St. NW

N. Canton, OH 44720

**Phone:** (234) 262-3000

**E-Mail:** [CustomerCAD@timken.com](mailto:CustomerCAD@timken.com) • **Web site:** [www.timken.com](http://www.timken.com)

## Part Number QACW15A211S, Single Concentric Piloted Flange Cartridge



[Specifications](#) | [Dimensions](#) | [Radial and Thrust Factors](#) | [Engineering Seal Speed](#) | [Engineering Bearing Attributes](#) | [Engineering Internal Radial Clearance](#)

## Specifications

<b>Engineering Group</b>	Mounted Bearing
<b>Bearing Number</b>	22215
<b>Shaft Size</b>	2 11/16 in
<b>Shaft Size Type</b>	Imperial
<b>Full Timken Part Number</b>	QACW15A211SB QACW15A211SC QACW15A211SEB QACW15A211SEC QACW15A211SEM QACW15A211SEN QACW15A211SEO QACW15A211SET QACW15A211SM QACW15A211SN QACW15A211SO QACW15A211ST



<b>Locking Style</b>	Single Concentric
----------------------	-------------------

<b>Housing Construction</b>	Piloted Flange Cartridge
-----------------------------	--------------------------

<b>UPC Code</b>	0883450305389
	0883450305396
	0883450305402
	0883450305419
	0883450305426
	0883450305433
	0883450305440
	0883450305457
	0883450305464
	0883450305471
	0883450305488
	0883450305495

## Dimensions

<b>Dimension BC</b>	7-1/2 in 190.5 mm
---------------------	----------------------

<b>Dimension B Exp</b>	1.89 in 48 mm
------------------------	------------------

<b>Dimension B Fix</b>	1.81 in 46 mm
------------------------	------------------

<b>Dimension C</b>	4.29 in 109 mm
--------------------	-------------------

<b>Dimension D</b>	6.38 in 162.1 mm
--------------------	---------------------

<b>Dimension E</b>	5.3 in 134.6 mm
--------------------	--------------------

<b>Dimension F</b>	8-3/4 in 222.3 mm
--------------------	----------------------

<b>Dimension G</b>	6.375 in 161.9 mm
--------------------	----------------------

<b>Dimension H</b>	0.5 in 12.7 mm
<b>Dimension J (Bolt Size)</b>	0.625 in 16 mm
<b>Dimension KA</b>	1.25 in 31.8 mm
<b>Dimension L Exp</b>	3.76 in 95.5 mm
<b>Dimension L Fix</b>	3.68 in 93.5 mm
<b>Dimension M</b>	2.37 in 60.2 mm
<b>Dimension N</b>	1.88 in 47.8 mm
<b>Dimension RA</b>	0.06 in 1.5 mm
<b>Dimension SA</b>	3.62 in 91.9 mm

## Radial and Thrust Factors

<b>C0 - Static Load</b>	54100 lbf 240000 N
<b>C - Dynamic Load (Basic)</b>	49900 lbf 222000 N
<b>e - Geometry Factor</b>	0.22
<b>Y1 - Geometry Factor</b>	3.14
<b>Y2 - Geometry Factor</b>	4.67

## Engineering Seal Speed

<b>Oil Lubrication - M/N Seal</b>	1600 rpm
-----------------------------------	----------

<b>Oil Lubrication - T Seal</b>	2900 rpm
---------------------------------	----------

<b>Oil Lubrication - B/C/O Seal</b>	1300 rpm
-------------------------------------	----------

<b>Grease Lubrication - M/N Seal</b>	1600 rpm
--------------------------------------	----------

<b>Grease Lubrication - T Seal</b>	2400 rpm
------------------------------------	----------

<b>Grease Lubrication - B/C/O Seal</b>	1300 rpm
--	----------

## Engineering Bearing Attributes

<b>Float</b>	0.083 in 2.108 mm
--------------	----------------------

<b>Shaft Tolerance</b>	0.0020 in 0.051 mm
------------------------	-----------------------

## Engineering Internal Radial Clearance

<b>Eng Internal Radial Clearance - Min</b>	0.0020
--	--------

<b>Eng Internal Radial Clearance - Max</b>	0.0031
--	--------

<b>Pre Install Clearance Min</b>	0.0020 in 0.050 mm
----------------------------------	-----------------------

<b>Pre Install Clearance Max</b>	0.0031 in 0.080 mm
----------------------------------	-----------------------

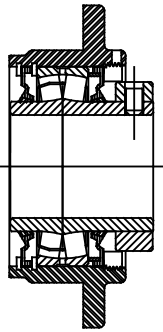
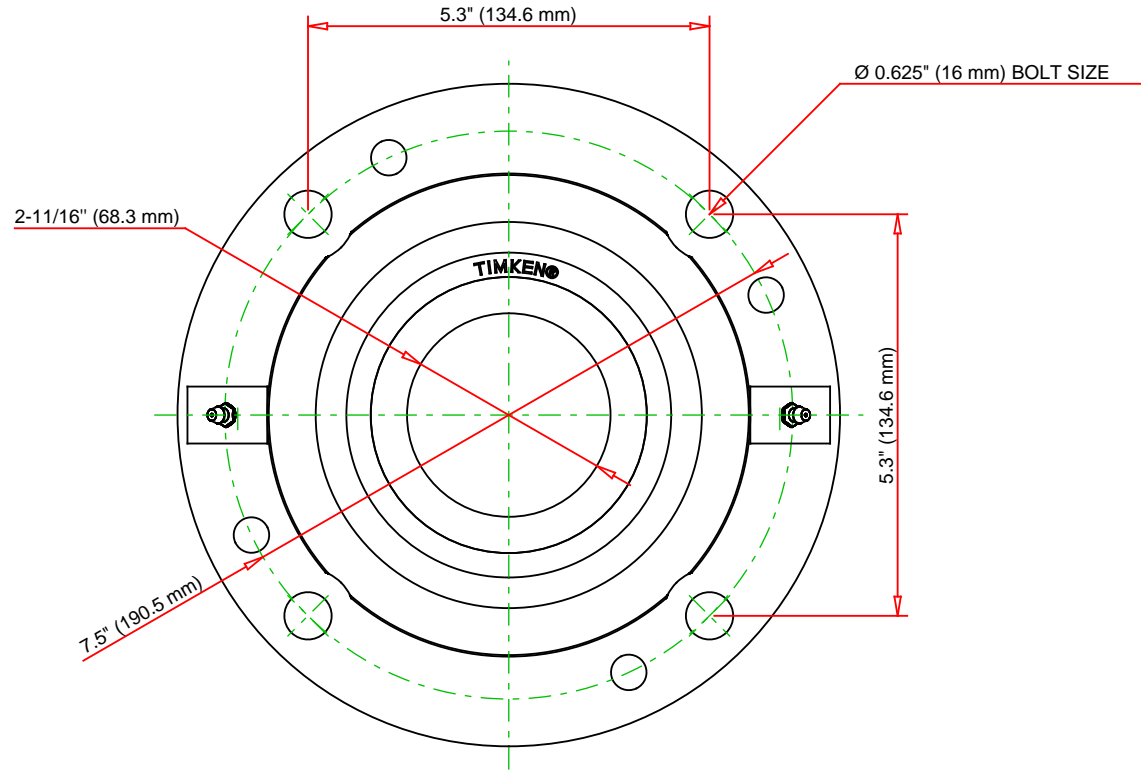
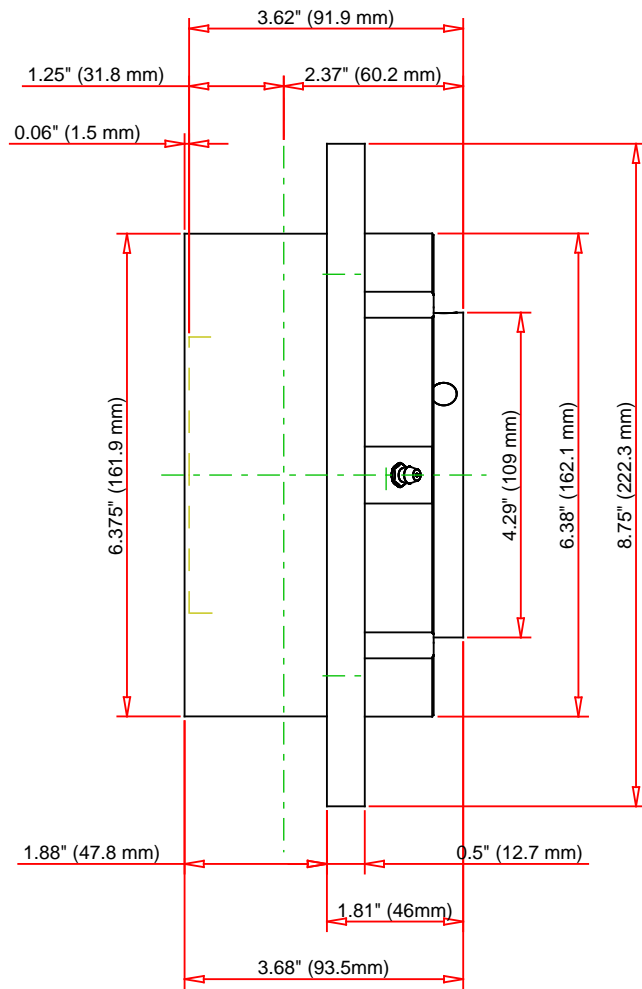

Note: Section View not to Scale

C - Dynamic Load	49900	lbf	222000	N
C0 - Static Load	54100	lbf	240000	N
Weight	22	lb	10	kg
Max. Speed T-Seals & Grease	2400	rpm		
Rad. Clearance - Max.	0.0031			

**TIMKEN**

THE TIMKEN COMPANY  
NORTH CANTON, OHIO USA

**QACW15A211S**

Single Concentric Piloted Flange  
Cartridge

Every reasonable effort has been made to ensure the accuracy of the information contained in this writing, but no liability is accepted for errors, omissions or for any other reason.

**FOR DISCUSSION ONLY**