



The Timken Company

4500 Mt Pleasant St. NW

N. Canton, OH 44720

Phone: (234) 262-3000

E-Mail: CustomerCAD@timken.com • **Web site:** www.timken.com

Part Number QMPL09J112S, Eccentric Two-Bolt Pillow Block

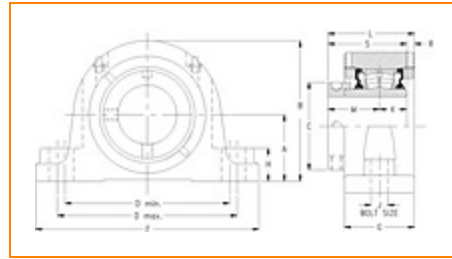

[Specifications](#) | [Dimensions](#) | [Radial and Thrust Factors](#) | [Engineering Seal Speed](#) | [Engineering Bearing Attributes](#) | [Engineering Internal Radial Clearance](#)

Specifications

Engineering Group Mounted Bearing

Bearing Number 22209

Shaft Size 1 3/4 in

Shaft Size Type Imperial

Full Timken Part Number

- QMPL09J112SB
- QMPL09J112SC
- QMPL09J112SEB
- QMPL09J112SEC
- QMPL09J112SEM
- QMPL09J112SEN
- QMPL09J112SEO
- QMPL09J112SET
- QMPL09J112SM
- QMPL09J112SMNG
- QMPL09J112SMNP
- QMPL09J112SMNPFG



QMPL09J112SN
 QMPL09J112SO
 QMPL09J112ST

Locking Style

Eccentric

Housing Construction

Two-Bolt Pillow Block

UPC Code

0883450086820
 0883450086837
 0883450086851
 0883450086868
 0883450086875
 0883450086882
 0883450086899
 0883450086905
 0883450155014
 0883450155359
 0883450249959
 0883450250290
 0883450476102
 0883450491730
 0883450502795

Dimensions**Dimension A**

2.13 in
 54.1 mm

Dimension B

4.13 in
 104.9 mm

Dimension C

2.62 in
 66.5 mm

Dimension D Min

5.25 in
 133.4 mm

Dimension D Max

5.75 in
 146.1 mm

Dimension F

7.13 in
 181.1 mm

Dimension G	2.37 in 60.2 mm
--------------------	--------------------

Dimension H	1-1/4 in 31.8 mm
--------------------	---------------------

Dimension J (Bolt Size)	0.5 in 12 mm
--------------------------------	-----------------

Dimension K	1 in 25.4 mm
--------------------	-----------------

Dimension L	3.06 in 77.7 mm
--------------------	--------------------

Dimension M	1.88 in 47.8 mm
--------------------	--------------------

Dimension R	0.19 in 4.8 mm
--------------------	-------------------

Dimension S	2.88 in 73.2 mm
--------------------	--------------------

Radial and Thrust Factors

C0 - Static Load	24200 lbf 108000 N
-------------------------	-----------------------

C - Dynamic Load (Basic)	24500 lbf 109000 N
---------------------------------	-----------------------

e - Geometry Factor	0.26
----------------------------	------

Y1 - Geometry Factor	2.64
-----------------------------	------

Y2 - Geometry Factor	3.93
-----------------------------	------

Engineering Seal Speed

Oil Lubrication - M/N Seal	2700 rpm
-----------------------------------	----------

Oil Lubrication - T Seal	4500 rpm
---------------------------------	----------

Oil Lubrication - B/C/O Seal	1950 rpm
-------------------------------------	----------

Grease Lubrication - M/N Seal	2700 rpm
--------------------------------------	----------

Grease Lubrication - T Seal	4000 rpm
------------------------------------	----------

Grease Lubrication - B/C/O Seal	1950 rpm
--	----------

Engineering Bearing Attributes

Float	0.050 in 1.270 mm
--------------	----------------------

Shaft Tolerance	0.0015 in 0.038 mm
------------------------	-----------------------

Engineering Internal Radial Clearance

Eng Internal Radial Clearance - Min	0.0014
--	--------

Eng Internal Radial Clearance - Max	0.0022
--	--------

Pre Install Clearance Min	0.0014 in 0.035 mm
----------------------------------	-----------------------

Pre Install Clearance Max	0.0022 in 0.055 mm
----------------------------------	-----------------------

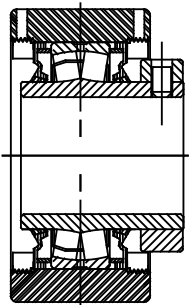
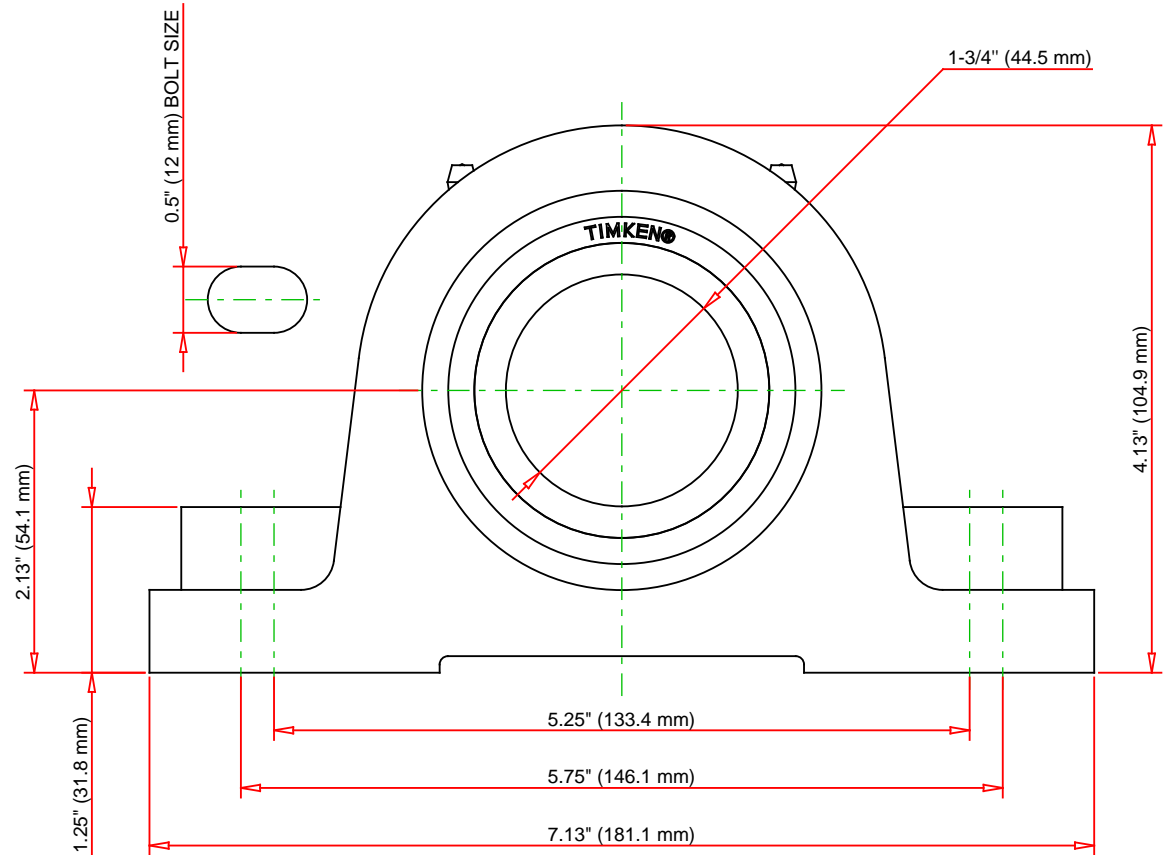
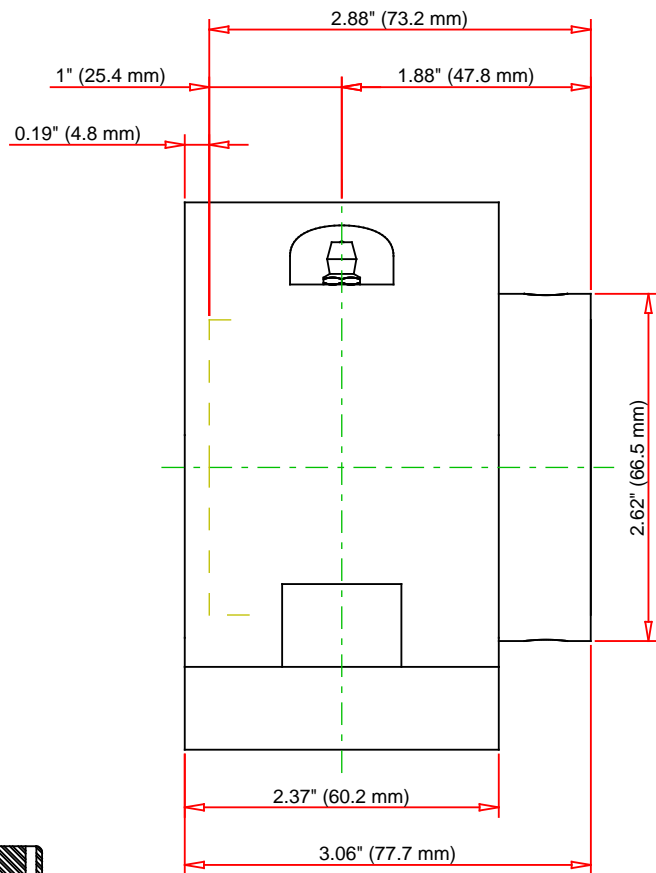

Note: Section View not to Scale

C - Dynamic Load	24500	lbf	109000	N
C0 - Static Load	24200	lbf	108000	N
Weight	10	lb	4.5	kg
Max. Speed T-Seals & Grease	4000	rpm		
Rad. Clearance - Max.	0.0022			

TIMKEN

THE TIMKEN COMPANY
NORTH CANTON, OHIO USA

QMPL09J112S
Eccentric Two-Bolt Pillow Block

Every reasonable effort has been made to ensure the accuracy of the information contained in this writing, but no liability is accepted for errors, omissions or for any other reason.

FOR DISCUSSION ONLY