



**The Timken Company**

4500 Mt Pleasant St. NW

N. Canton, OH 44720

**Phone:** (234) 262-3000

**E-Mail:** [CustomerCAD@timken.com](mailto:CustomerCAD@timken.com) • **Web site:** [www.timken.com](http://www.timken.com)

## Part Number QVCW14V207S, Single V-Lock Piloted Flange Cartridge

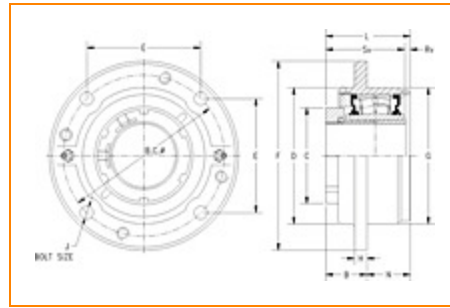
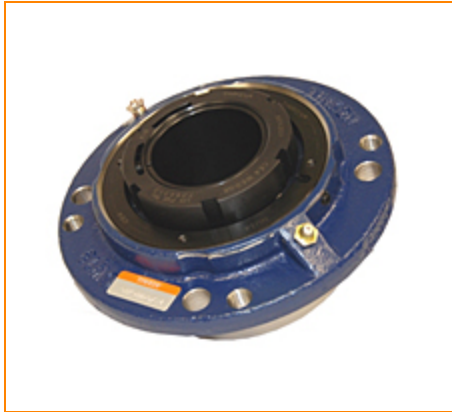

[Specifications](#) | [Dimensions](#) | [Radial and Thrust Factors](#) | [Engineering Seal Speed](#) | [Engineering Bearing Attributes](#) | [Engineering Internal Radial Clearance](#)

### Specifications

**Engineering Group** Mounted Bearing

**Bearing Number** 22214

**Shaft Size** 2 7/16 in

**Shaft Size Type** Imperial

**Full Timken Part Number**

- QVCW14V207SB
- QVCW14V207SC
- QVCW14V207SEB
- QVCW14V207SEC
- QVCW14V207SEM
- QVCW14V207SEN
- QVCW14V207SEO
- QVCW14V207SET
- QVCW14V207SM
- QVCW14V207SN
- QVCW14V207SO
- QVCW14V207ST



QVCW14V207STM

**Locking Style**

Single V-Lock

**Housing Construction**

Piloted Flange Cartridge

**UPC Code**

0883450038195  
 0883450062145  
 0883450106030  
 0883450106078  
 0883450185936  
 0883450213721  
 0883450214100  
 0883450226141  
 0883450226523  
 0883450238564  
 0883450238946  
 0883450295475  
 0883450492508

**Dimensions****Dimension BC**

6-1/2 in  
 165.1 mm

**Dimension C**

3.7 in  
 94 mm

**Dimension D**

5.5 in  
 139.7 mm

**Dimension E**

4.6 in  
 116.8 mm

**Dimension B Exp**

1.73 in  
 43.9 mm

**Dimension B Fix**

1.65 in  
 41.9 mm

**Dimension F**

7.63 in  
 193.8 mm

<b>Dimension H</b>	0.5 in 12.7 mm
<b>Dimension J (Bolt Size)</b>	0.5 in 12 mm
<b>Dimension L</b>	3.4 in 86.4 mm
<b>Dimension RV</b>	0.21 in 5.3 mm
<b>Dimension SV</b>	3.19 in 81 mm
<b>Dimension G</b>	5.5 in 139.7 mm
<b>Dimension N</b>	1.69 in 42.9 mm

### Radial and Thrust Factors

<b>C0 - Static Load</b>	52000 lbf 231000 N
<b>C - Dynamic Load (Basic)</b>	47800 lbf 213000 N
<b>e - Geometry Factor</b>	0.23
<b>Y1 - Geometry Factor</b>	2.90
<b>Y2 - Geometry Factor</b>	4.32

### Engineering Seal Speed

<b>Oil Lubrication - M/N Seal</b>	1700 rpm
<b>Oil Lubrication - T Seal</b>	3050 rpm
<b>Oil Lubrication - B/C/O Seal</b>	1400 rpm

<b>Grease Lubrication - M/N Seal</b>	1700 rpm
--------------------------------------	----------

<b>Grease Lubrication - T Seal</b>	2600 rpm
------------------------------------	----------

<b>Grease Lubrication - B/C/O Seal</b>	1400 rpm
--	----------

### Engineering Bearing Attributes

<b>Float</b>	0.083 in 2.108 mm
--------------	----------------------

<b>Shaft Tolerance</b>	0.0015 in 0.038 mm
------------------------	-----------------------

### Engineering Internal Radial Clearance

<b>Pre Install Clearance Min</b>	0.0030 in 0.075 mm
----------------------------------	-----------------------

<b>Pre Install Clearance Max</b>	0.0037 in 0.095 mm
----------------------------------	-----------------------

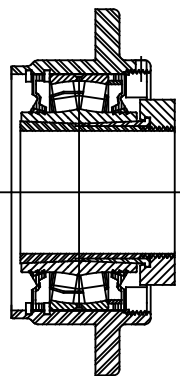
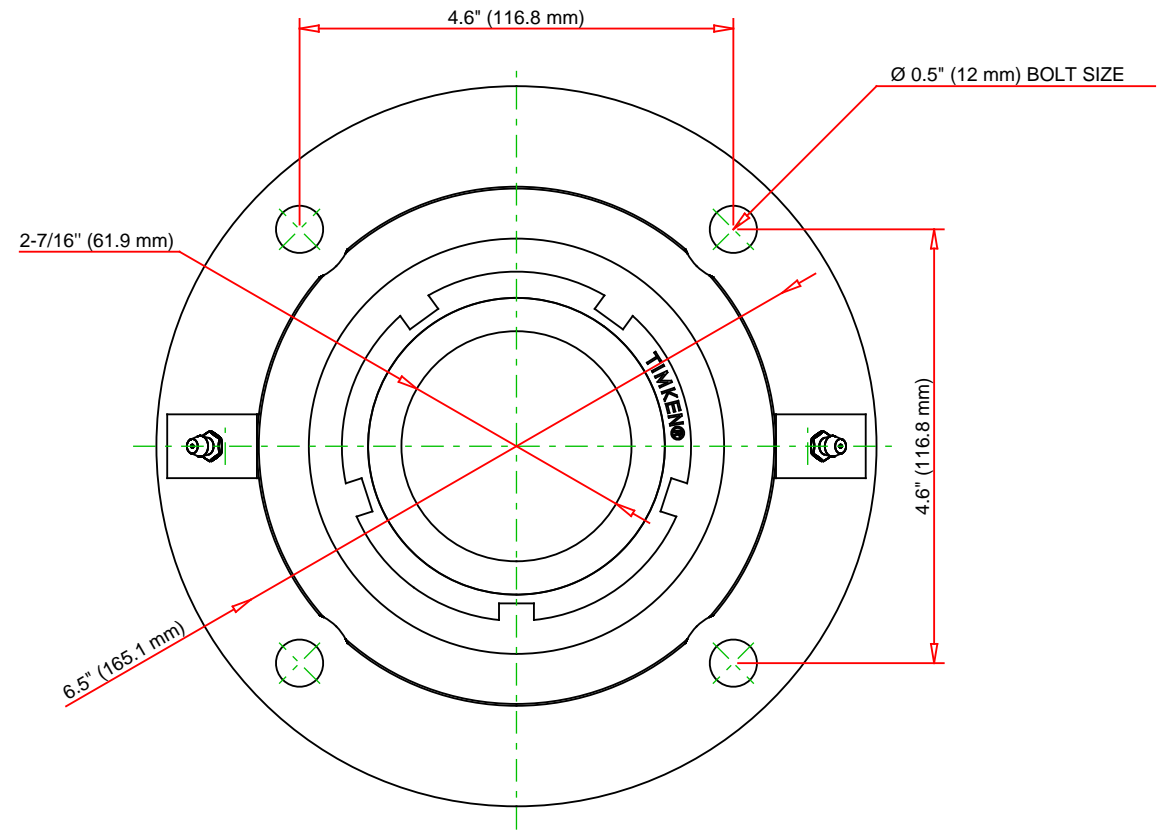
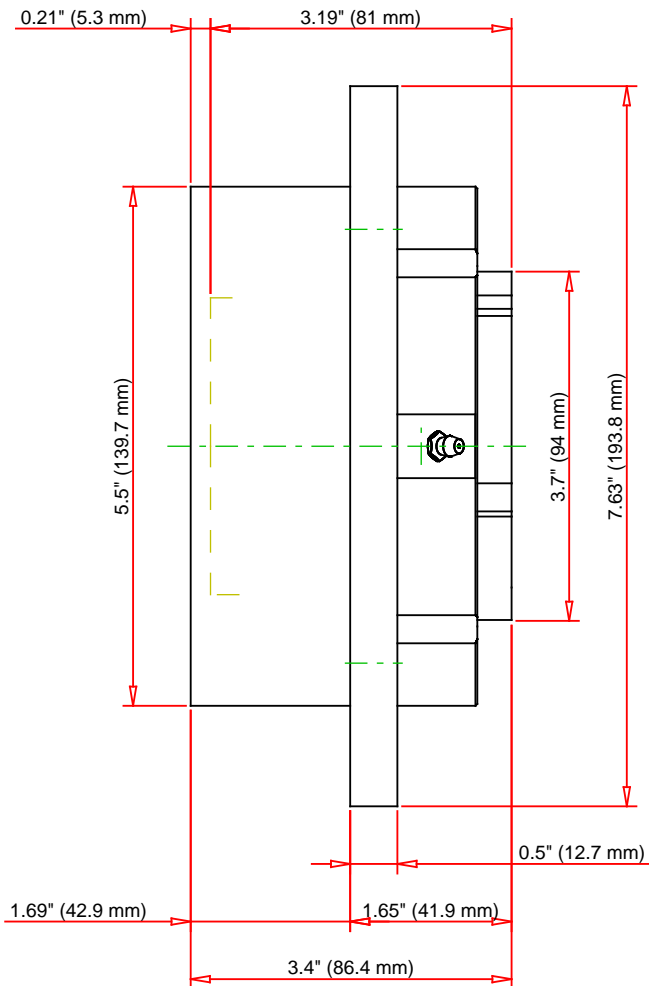

Note: Section View not to Scale

C - Dynamic Load	47800	lbf	213000	N
C0 - Static Load	52000	lbf	231000	N
Weight	16	lb	7.3	kg
Max. Speed T-Seals & Grease	2600	rpm		
Rad. Clearance - Max.	0.0037			

**TIMKEN**

THE TIMKEN COMPANY  
NORTH CANTON, OHIO USA

**QVCW14V207S**  
Single V-Lock Piloted Flange Cartridge

Every reasonable effort has been made to ensure the accuracy of the information contained in this writing, but no liability is accepted for errors, omissions or for any other reason.

**FOR DISCUSSION ONLY**