



The Timken Company

4500 Mt Pleasant St. NW

N. Canton, OH 44720

Phone: (234) 262-3000

E-Mail: CustomerCAD@timken.com • **Web site:** www.timken.com

Part Number QAFY15A215S, Single Concentric Round Flange Block

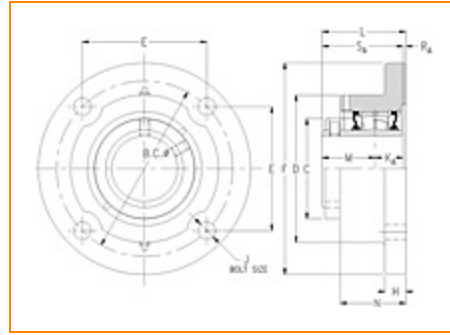

[Specifications](#) | [Dimensions](#) | [Radial and Thrust Factors](#) | [Engineering Seal Speed](#) | [Engineering Bearing Attributes](#) | [Engineering Internal Radial Clearance](#)

Specifications

Engineering Group Mounted Bearing

Bearing Number 22215

Shaft Size 2 15/16 in

Shaft Size Type Imperial

Full Timken Part Number

- QAFY15A215SB
- QAFY15A215SC
- QAFY15A215SEB
- QAFY15A215SEC
- QAFY15A215SEM
- QAFY15A215SEN
- QAFY15A215SEO
- QAFY15A215SET
- QAFY15A215SM
- QAFY15A215SN
- QAFY15A215SO
- QAFY15A215ST



Locking Style	Single Concentric
----------------------	-------------------

Housing Construction	Round Flange
-----------------------------	--------------

UPC Code	0883450041904
	0883450041911
	0883450041942
	0883450041959
	0883450041966
	0883450041973
	0883450041980
	0883450192002
	0883450192163
	0883450192323
0883450269360	
0883450269520	

Dimensions

Dimension BC	7.88 in 200.2 mm
---------------------	---------------------

Dimension C	4.5 in 114.3 mm
--------------------	--------------------

Dimension D	6.63 in 168.4 mm
--------------------	---------------------

Dimension E	5.57 in 141.5 mm
--------------------	---------------------

Dimension F	9.5000 in 241.300 mm
--------------------	-------------------------

Dimension H	0.94 in 23.9 mm
--------------------	--------------------

Dimension J (Bolt Size)	0.75 in 20 mm
--------------------------------	------------------

Dimension KA	1.25 in 31.8 mm
---------------------	--------------------

Dimension L Exp	3.95 in 100.3 mm
------------------------	---------------------

Dimension L Fix	3.87 in 98.3 mm
------------------------	--------------------

Dimension M	2.37 in 60.2 mm
--------------------	--------------------

Dimension N	2.93 in 74.4 mm
--------------------	--------------------

Dimension RA	0.25 in 6.4 mm
---------------------	-------------------

Dimension SA	3.62 in 91.9 mm
---------------------	--------------------

Radial and Thrust Factors

C0 - Static Load	54100 lbf 240000 N
-------------------------	-----------------------

C - Dynamic Load (Basic)	49900 lbf 222000 N
---------------------------------	-----------------------

e - Geometry Factor	0.22
----------------------------	------

Y1 - Geometry Factor	3.14
-----------------------------	------

Y2 - Geometry Factor	4.67
-----------------------------	------

Engineering Seal Speed

Oil Lubrication - M/N Seal	1600 rpm
-----------------------------------	----------

Oil Lubrication - T Seal	2900 rpm
---------------------------------	----------

Oil Lubrication - B/C/O Seal	1300 rpm
-------------------------------------	----------

Grease Lubrication - M/N Seal	1600 rpm
--------------------------------------	----------

Grease Lubrication - T Seal	2400 rpm
------------------------------------	----------

Grease Lubrication - B/C/O Seal	1300 rpm
--	----------

Engineering Bearing Attributes

Float	0.083 in 2.108 mm
--------------	----------------------

Shaft Tolerance	0.0020 in 0.051 mm
------------------------	-----------------------

Engineering Internal Radial Clearance

Eng Internal Radial Clearance - Min	0.0020
--	--------

Eng Internal Radial Clearance - Max	0.0031
--	--------

Pre Install Clearance Min	0.0020 in 0.050 mm
----------------------------------	-----------------------

Pre Install Clearance Max	0.0031 in 0.080 mm
----------------------------------	-----------------------

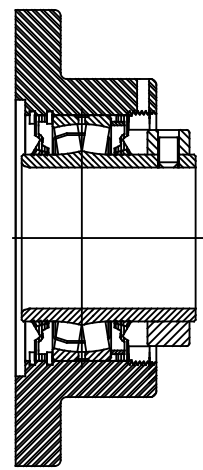
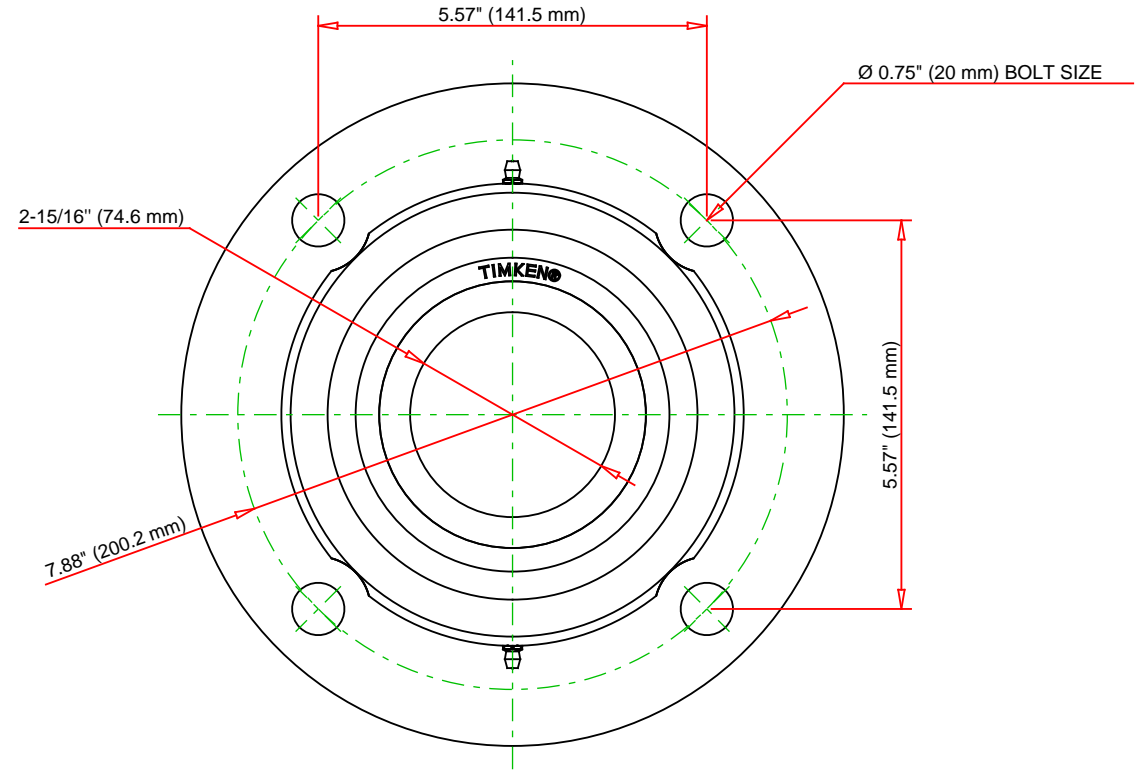
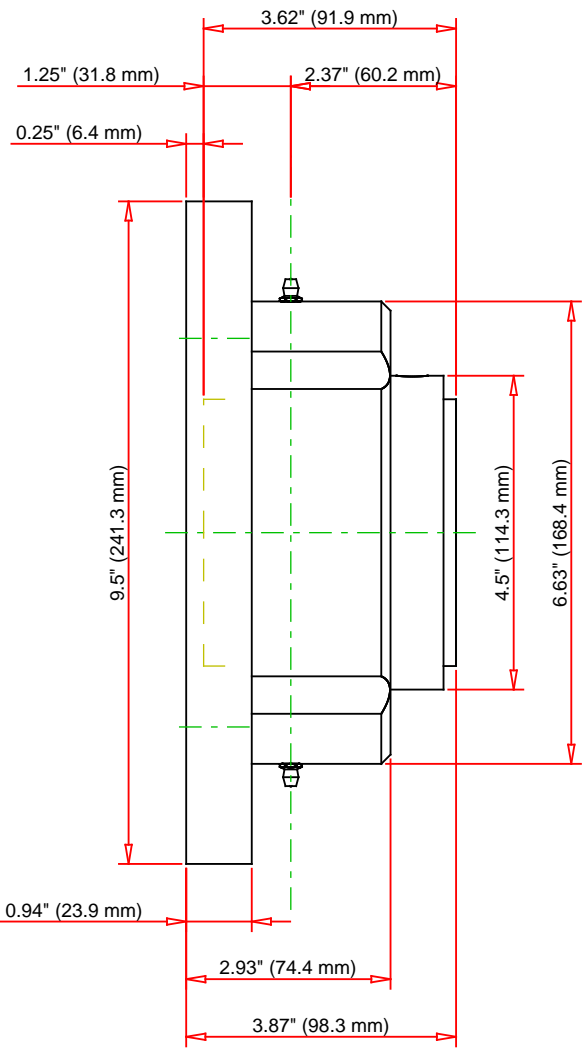

Note: Section View not to Scale

C - Dynamic Load	49900	lbf	222000	N
C0 - Static Load	54100	lbf	240000	N
Weight	28	lb	12.7	kg
Max. Speed T-Seals & Grease	2400	rpm		
Rad. Clearance - Max.	0.0031			

TIMKEN

THE TIMKEN COMPANY
NORTH CANTON, OHIO USA

QAFY15A215S
Single Concentric Round Flange Block

Every reasonable effort has been made to ensure the accuracy of the information contained in this writing, but no liability is accepted for errors, omissions or for any other reason.

FOR DISCUSSION ONLY