

The Timken Company

4500 Mt Pleasant St. NW

N. Canton, OH 44720

Phone: (234) 262-3000

E-Mail: CustomerCAD@timken.com • **Web site:** www.timken.com

Part Number QMP13J060S, Eccentric Two-Bolt Pillow Block

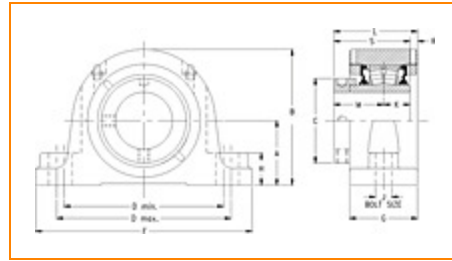

[Specifications](#) | [Dimensions](#) | [Radial and Thrust Factors](#) | [Engineering Seal Speed](#) | [Engineering Bearing Attributes](#) | [Engineering Internal Radial Clearance](#)

Specifications

Engineering Group Mounted Bearing

Bearing Number 22213

Shaft Size 60 mm

Shaft Size Type Metric

Full Timken Part Number
 QMP13J060SC
 QMP13J060SEB
 QMP13J060SEC
 QMP13J060SEM
 QMP13J060SEN
 QMP13J060SEO
 QMP13J060SET
 QMP13J060SM
 QMP13J060SMNG
 QMP13J060SN
 QMP13J060SO
 QMP13J060ST



QMP13J060STNG

Locking Style

Eccentric

Housing Construction

Two-Bolt Pillow Block

UPC Code

0883450329699
 0883450329705
 0883450329927
 0883450329934
 0883450329941
 0883450329958
 0883450329965
 0883450329972
 0883450329989
 0883450329996
 0883450330008
 0883450432177
 0883450499910

Dimensions**Dimension A**

2.75 in
 69.9 mm

Dimension B

5.8 in
 147.3 mm

Dimension C

3.62 in
 91.9 mm

Dimension D Min

6.88 in
 174.8 mm

Dimension D Max

8.63 in
 219.2 mm

Dimension F

10 1/4 in
 260.4 mm

Dimension G

2.9 in
 73.7 mm

Dimension H	1.38 in 35.1 mm
Dimension J (Bolt Size)	0.625 in 16 mm
Dimension K	1.24 in 31.5 mm
Dimension L	3.59 in 91.2 mm
Dimension M	2.13 in 54.1 mm
Dimension R	0.21 in 5.3 mm
Dimension S	3.37 in 85.6 mm

Radial and Thrust Factors

C0 - Static Load	48600 lbf 216000 N
C - Dynamic Load (Basic)	46400 lbf 206000 N
e - Geometry Factor	0.24
Y1 - Geometry Factor	2.79
Y2 - Geometry Factor	4.15

Engineering Seal Speed

Oil Lubrication - M/N Seal	1800 rpm
Oil Lubrication - T Seal	3200 rpm
Oil Lubrication - B/C/O Seal	1500 rpm

Grease Lubrication - M/N Seal	1800 rpm
--------------------------------------	----------

Grease Lubrication - T Seal	2800 rpm
------------------------------------	----------

Grease Lubrication - B/C/O Seal	1500 rpm
--	----------

Engineering Bearing Attributes

Float	0.083 in 2.108 mm
--------------	----------------------

Shaft Tolerance	0.0015 in 0.038 mm
------------------------	-----------------------

Engineering Internal Radial Clearance

Eng Internal Radial Clearance - Min	0.0016
--	--------

Eng Internal Radial Clearance - Max	0.0026
--	--------

Pre Install Clearance Min	0.0016 in 0.040 mm
----------------------------------	-----------------------

Pre Install Clearance Max	0.0026 in 0.065 mm
----------------------------------	-----------------------

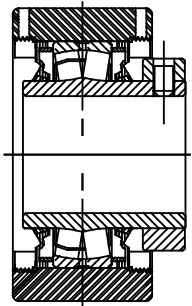
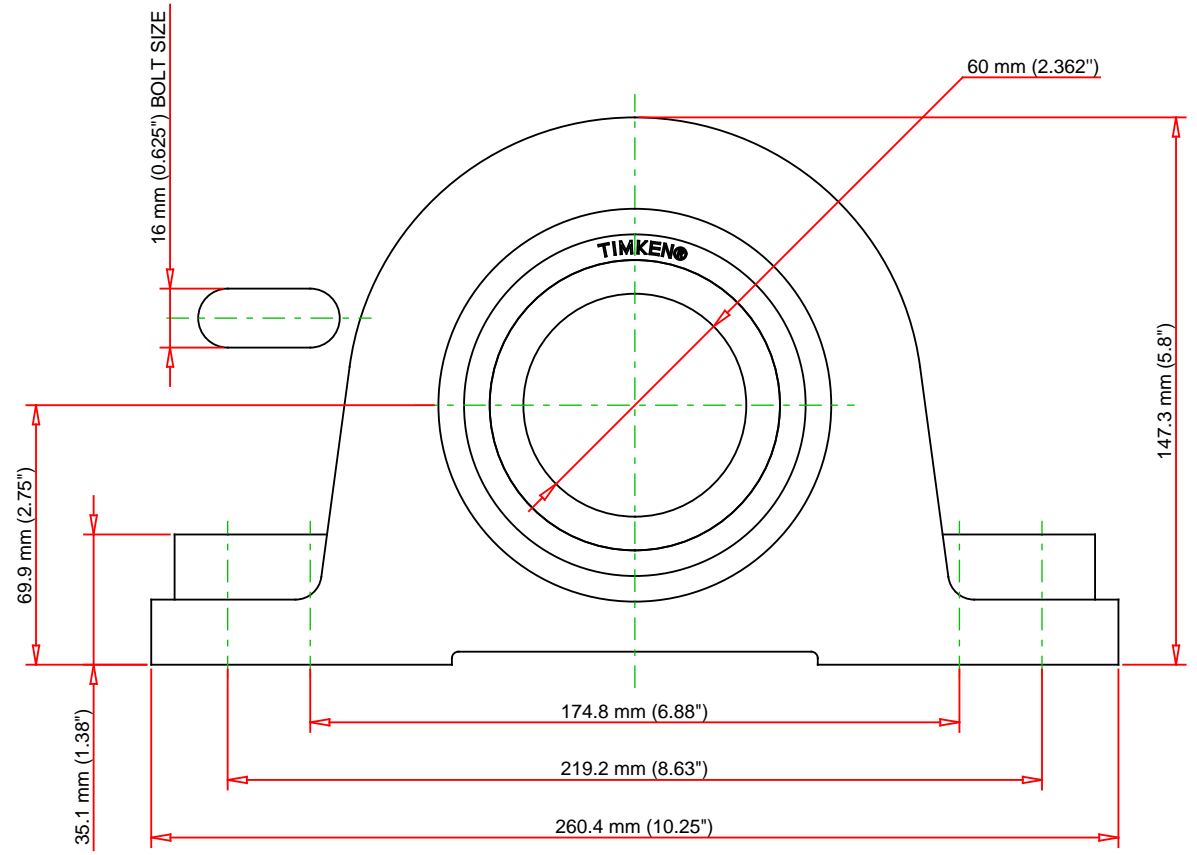
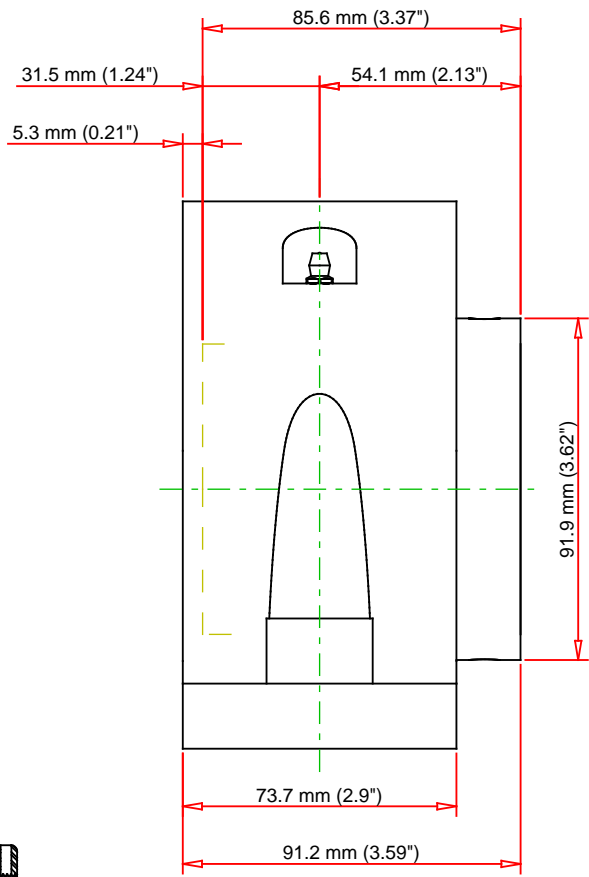

Note: Section View not to Scale

C - Dynamic Load	46400	lbf	206000	N
C0 - Static Load	48600	lbf	216000	N
Weight	22	lb	10	kg
Max. Speed T-Seals & Grease	2800	rpm		
Rad. Clearance - Max.	0.0026			

TIMKEN

THE TIMKEN COMPANY
NORTH CANTON, OHIO USA

QMP13J060S
Eccentric Two-Bolt Pillow Block

Every reasonable effort has been made to ensure the accuracy of the information contained in this writing, but no liability is accepted for errors, omissions or for any other reason.

FOR DISCUSSION ONLY