



**The Timken Company**

4500 Mt Pleasant St. NW

N. Canton, OH 44720

**Phone:** (234) 262-3000

**E-Mail:** [CustomerCAD@timken.com](mailto:CustomerCAD@timken.com) • **Web site:** [www.timken.com](http://www.timken.com)

## Part Number QVVPKT13V203S, Double V-Lock Two-Bolt Pillow Block

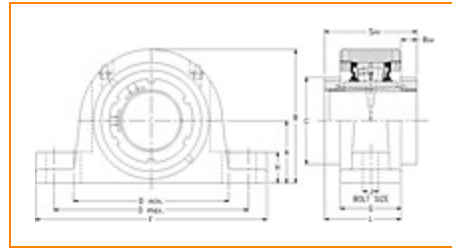

[Specifications](#) | [Dimensions](#) | [Radial and Thrust Factors](#) | [Engineering Seal Speed](#) | [Engineering Bearing Attributes](#) | [Engineering Internal Radial Clearance](#)

### Specifications

**Engineering Group** Mounted Bearing

**Bearing Number** 22213

**Shaft Size** 2 3/16 in

**Shaft Size Type** Imperial

**Full Timken Part Number**

- QVVPKT13V203SB
- QVVPKT13V203SC
- QVVPKT13V203SEB
- QVVPKT13V203SEC
- QVVPKT13V203SEM
- QVVPKT13V203SEN
- QVVPKT13V203SEO
- QVVPKT13V203SET
- QVVPKT13V203SM
- QVVPKT13V203SN
- QVVPKT13V203SO
- QVVPKT13V203ST



<b>Locking Style</b>	Double V-Lock
<b>Housing Construction</b>	Two-Bolt Pillow Block
<b>UPC Code</b>	0883450149082 0883450149136 0883450153638 0883450153669 0883450176729 0883450176750 0883450185837 0883450185868 0883450279383 0883450279413 0883450283588 0883450283618

## Dimensions

<b>Dimension A</b>	3 in 76.2 mm
<b>Dimension B</b>	6.05 in 153.7 mm
<b>Dimension C</b>	3.16 in 80.3 mm
<b>Dimension D Min</b>	7.66 in 194.6 mm
<b>Dimension D Max</b>	8.78 in 223 mm
<b>Dimension F</b>	11.25 in 285.8 mm
<b>Dimension G</b>	2.9 in 73.7 mm
<b>Dimension H</b>	1.38 in 35.1 mm

<b>Dimension J (Bolt Size)</b>	0.75 in 20 mm
<b>Dimension L</b>	3.46 in 87.9 mm
<b>Dimension RVV</b>	0.56 in 14.2 mm
<b>Dimension SVV</b>	4.02 in 102.1 mm

## Radial and Thrust Factors

<b>C0 - Static Load</b>	48600 lbf 216000 N
<b>C - Dynamic Load (Basic)</b>	46400 lbf 206000 N
<b>e - Geometry Factor</b>	0.24
<b>Y1 - Geometry Factor</b>	2.79
<b>Y2 - Geometry Factor</b>	4.15

## Engineering Seal Speed

<b>Oil Lubrication - M/N Seal</b>	1800 rpm
<b>Oil Lubrication - T Seal</b>	3200 rpm
<b>Oil Lubrication - B/C/O Seal</b>	1500 rpm
<b>Grease Lubrication - M/N Seal</b>	1800 rpm
<b>Grease Lubrication - T Seal</b>	2800 rpm
<b>Grease Lubrication - B/C/O Seal</b>	1500 rpm

## Engineering Bearing Attributes

<b>Float</b>	0.083 in 2.108 mm
--------------	----------------------

<b>Shaft Tolerance</b>	0.0015 in 0.038 mm
------------------------	-----------------------

## Engineering Internal Radial Clearance

<b>Eng Internal Radial Clearance - Min</b>	0.0030
--	--------

<b>Eng Internal Radial Clearance - Max</b>	0.0037
--	--------

<b>Pre Install Clearance Min</b>	0.0030 in 0.075 mm
----------------------------------	-----------------------

<b>Pre Install Clearance Max</b>	0.0037 in 0.094 mm
----------------------------------	-----------------------

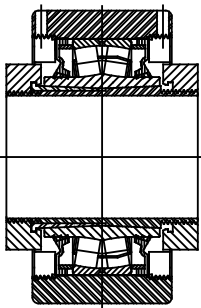
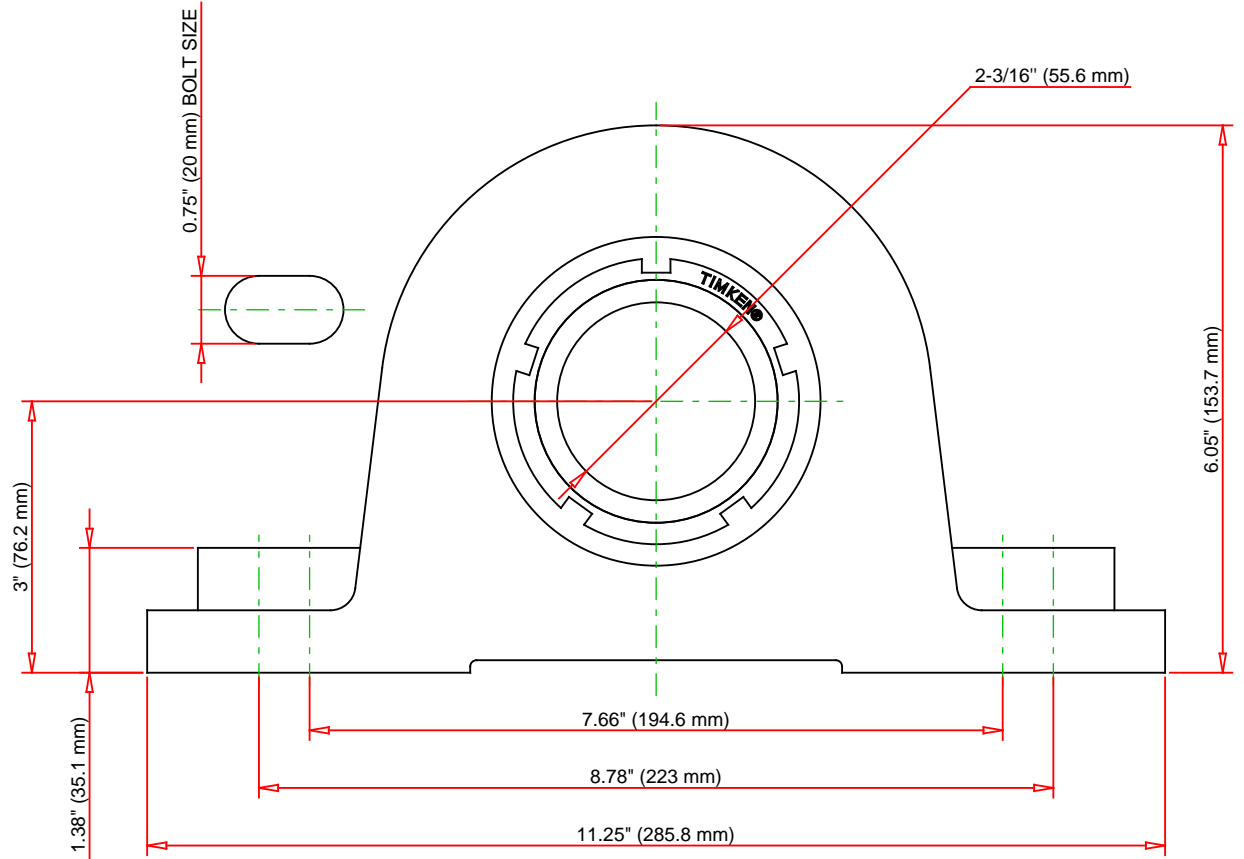
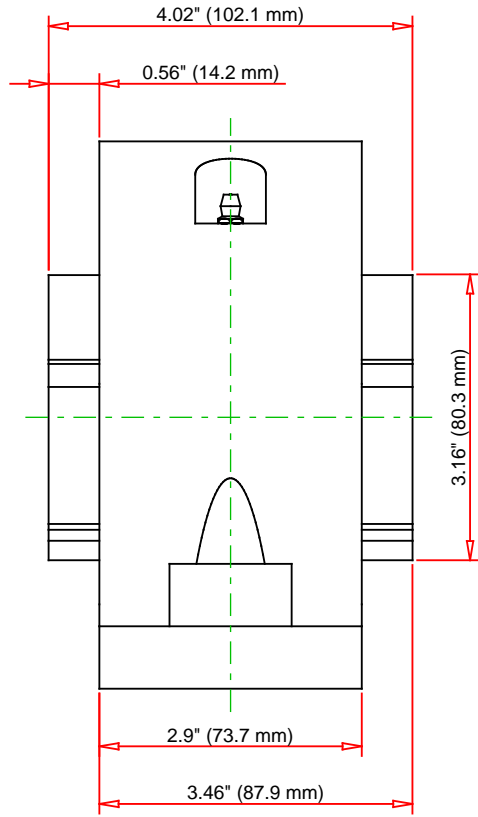

Note: Section View not to Scale

C - Dynamic Load	46400	lbf	206000	N
C0 - Static Load	48600	lbf	216000	N
Weight	22	lb	10	kg
Max. Speed T-Seals & Grease	2800	rpm		
Rad. Clearance - Max.	0.0037			

**TIMKEN**

THE TIMKEN COMPANY  
NORTH CANTON, OHIO USA

**QVVPKT13V203S**  
Double V-Lock Two-Bolt Pillow Block

Every reasonable effort has been made to ensure the accuracy of the information contained in this writing, but no liability is accepted for errors, omissions or for any other reason.

**FOR DISCUSSION ONLY**