

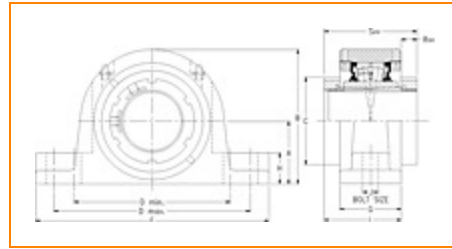

**The Timken Company**

4500 Mt Pleasant St. NW

N. Canton, OH 44720

**Phone:** (234) 262-3000

**E-Mail:** [CustomerCAD@timken.com](mailto:CustomerCAD@timken.com) • **Web site:** [www.timken.com](http://www.timken.com)
**Part Number QVVPA20V303S, Double V-Lock Two-Bolt Pillow Block**

[Specifications](#) | [Dimensions](#) | [Radial and Thrust Factors](#) | [Engineering Seal Speed](#) | [Engineering Bearing Attributes](#) | [Engineering Internal Radial Clearance](#)

**Specifications**

**Engineering Group** Mounted Bearing

**Bearing Number** 22220

**Shaft Size** 3 3/16 in

**Shaft Size Type** Imperial

**Full Timken Part Number**

- QVVPA20V303SB
- QVVPA20V303SC
- QVVPA20V303SEB
- QVVPA20V303SEC
- QVVPA20V303SEM
- QVVPA20V303SEN
- QVVPA20V303SEO
- QVVPA20V303SET
- QVVPA20V303SM
- QVVPA20V303SN
- QVVPA20V303SO
- QVVPA20V303ST



<b>Locking Style</b>	Double V-Lock
<b>Housing Construction</b>	Two-Bolt Pillow Block
<b>UPC Code</b>	0883450146753 0883450147002 0883450152174 0883450152327 0883450169837 0883450174473 0883450183383 0883450183536 0883450262453 0883450263542 0883450282130 0883450282284

## Dimensions

<b>Dimension A</b>	4-1/2 in 114.3 mm
<b>Dimension B</b>	8.63 in 219.2 mm
<b>Dimension C</b>	4.9 in 124.5 mm
<b>Dimension D Min</b>	10.88 in 276.4 mm
<b>Dimension D Max</b>	12.88 in 327.2 mm
<b>Dimension F</b>	14.5 in 368.3 mm
<b>Dimension G</b>	3.42 in 86.9 mm
<b>Dimension H</b>	1.63 in 41.4 mm

<b>Dimension J (Bolt Size)</b>	0.875 in 24 mm
<b>Dimension L</b>	4.03 in 102.4 mm
<b>Dimension RVV</b>	0.61 in 15.5 mm
<b>Dimension SVV</b>	4.63 in 117.6 mm

### Radial and Thrust Factors

<b>C0 - Static Load</b>	113000 lbf 502000 N
<b>C - Dynamic Load (Basic)</b>	97700 lbf 435000 N
<b>e - Geometry Factor</b>	0.24
<b>Y1 - Geometry Factor</b>	2.85
<b>Y2 - Geometry Factor</b>	4.24

### Engineering Seal Speed

<b>Oil Lubrication - M/N Seal</b>	1200 rpm
<b>Oil Lubrication - T Seal</b>	2000 rpm
<b>Oil Lubrication - B/C/O Seal</b>	900 rpm
<b>Grease Lubrication - M/N Seal</b>	1200 rpm
<b>Grease Lubrication - T Seal</b>	1600 rpm
<b>Grease Lubrication - B/C/O Seal</b>	900 rpm

### Engineering Bearing Attributes

<b>Float</b>	0.083 in 2.108 mm
--------------	----------------------

<b>Shaft Tolerance</b>	0.0030 in 0.076 mm
------------------------	-----------------------

## Engineering Internal Radial Clearance

<b>Eng Internal Radial Clearance - Min</b>	0.0043
--	--------

<b>Eng Internal Radial Clearance - Max</b>	0.0055
--	--------

<b>Pre Install Clearance Min</b>	0.0043 in 0.110 mm
----------------------------------	-----------------------

<b>Pre Install Clearance Max</b>	0.0055 in 0.140 mm
----------------------------------	-----------------------

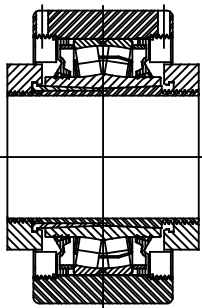
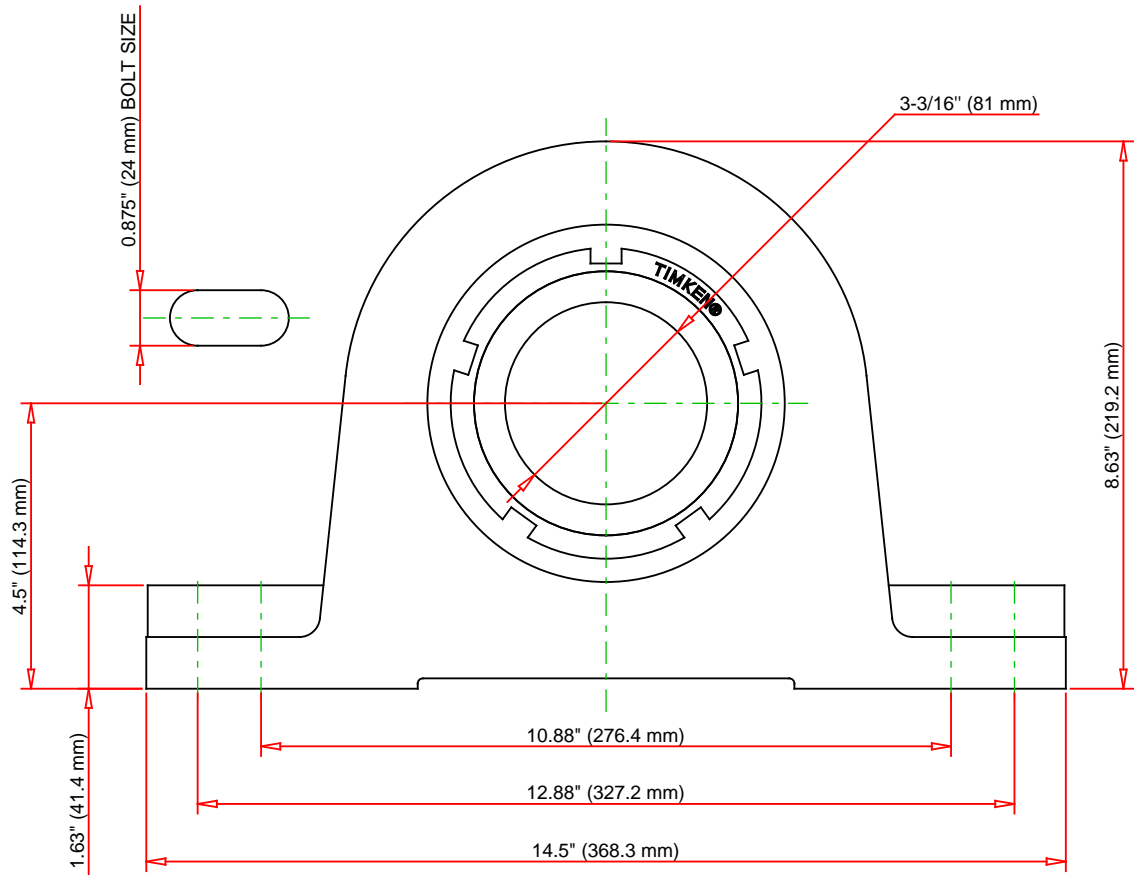
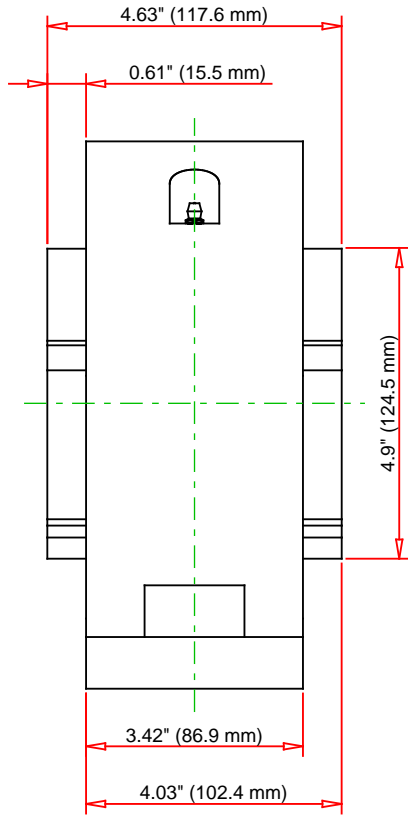

Note: Section View not to Scale

C - Dynamic Load	97700	lbf	435000	N
C0 - Static Load	113000	lbf	502000	N
Weight	65	lb	29.5	kg
Max. Speed T-Seals & Grease	1600	rpm		
Rad. Clearance - Max.	0.0055			

**TIMKEN**

THE TIMKEN COMPANY  
NORTH CANTON, OHIO USA

**QVVPA20V303S**  
Double V-Lock Two-Bolt Pillow Block

Every reasonable effort has been made to ensure the accuracy of the information contained in this writing, but no liability is accepted for errors, omissions or for any other reason.

**FOR DISCUSSION ONLY**