



The Timken Company

4500 Mt Pleasant St. NW

N. Canton, OH 44720

Phone: (234) 262-3000

E-Mail: CustomerCAD@timken.com • **Web site:** www.timken.com

Part Number QVFL22V400S, Single V-Lock Four-Bolt Square Flange Block

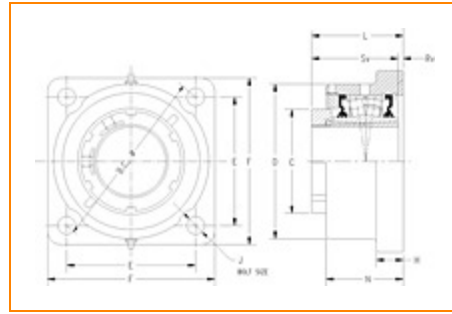

[Specifications](#) | [Dimensions](#) | [Radial and Thrust Factors](#) | [Engineering Seal Speed](#) | [Engineering Bearing Attributes](#) | [Engineering Internal Radial Clearance](#)

Specifications

Engineering Group Mounted Bearing

Bearing Number 22222

Shaft Size 4 in

Shaft Size Type Imperial

Full Timken Part Number

- QVFL22V400SB
- QVFL22V400SC
- QVFL22V400SEB
- QVFL22V400SEC
- QVFL22V400SEM
- QVFL22V400SEN
- QVFL22V400SEO
- QVFL22V400SET
- QVFL22V400SM
- QVFL22V400SN
- QVFL22V400SO



QVFL22V400ST

Locking Style

Single V-Lock

Housing Construction

Four-Bolt Square Flange

UPC Code

0883450042994
 0883450043021
 0883450109277
 0883450109314
 0883450180399
 0883450211604
 0883450211987
 0883450224024
 0883450224406
 0883450236447
 0883450236829
 0883450296359

Dimensions**Dimension BC**

10.75 in
 273.1 mm

Dimension C

5.5 in
 139.7 mm

Dimension D

9.04 in
 229.6 mm

Dimension L

4.6 in
 116.8 mm

Dimension E

7.6 in
 193 mm

Dimension F

9.5 in
 241.3 mm

Dimension H

1 1/2 in
 38.1 mm

Dimension J (Bolt Size)

1 in
 24 mm

Dimension L Exp	4.68 in 118.9 mm
------------------------	---------------------

Dimension L Fix	4.6 in 116.8 mm
------------------------	--------------------

Dimension N	4.12 in 104.6 mm
--------------------	---------------------

Dimension RV	0.47 in 11.9 mm
---------------------	--------------------

Dimension SV	4.13 in 104.9 mm
---------------------	---------------------

Radial and Thrust Factors

C0 - Static Load	147000 lbf 653000 N
-------------------------	------------------------

C - Dynamic Load (Basic)	125000 lbf 555000 N
---------------------------------	------------------------

e - Geometry Factor	0.26
----------------------------	------

Y1 - Geometry Factor	2.55
-----------------------------	------

Y2 - Geometry Factor	3.80
-----------------------------	------

Engineering Seal Speed

Oil Lubrication - M/N Seal	900 rpm
-----------------------------------	---------

Oil Lubrication - T Seal	1700 rpm
---------------------------------	----------

Oil Lubrication - B/C/O Seal	600 rpm
-------------------------------------	---------

Grease Lubrication - M/N Seal	900 rpm
--------------------------------------	---------

Grease Lubrication - T Seal	1200 rpm
------------------------------------	----------

Grease Lubrication - B/C/O Seal	600 rpm
--	---------

Engineering Bearing Attributes

Float	0.083 in 2.108 mm
Shaft Tolerance	0.0030 in 0.076 mm

Engineering Internal Radial Clearance

Eng Internal Radial Clearance - Min	0.0053
Eng Internal Radial Clearance - Max	0.0067
Pre Install Clearance Min	0.0043 in 0.109 mm
Pre Install Clearance Max	0.0055 in 0.140 mm

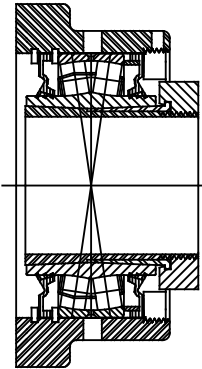
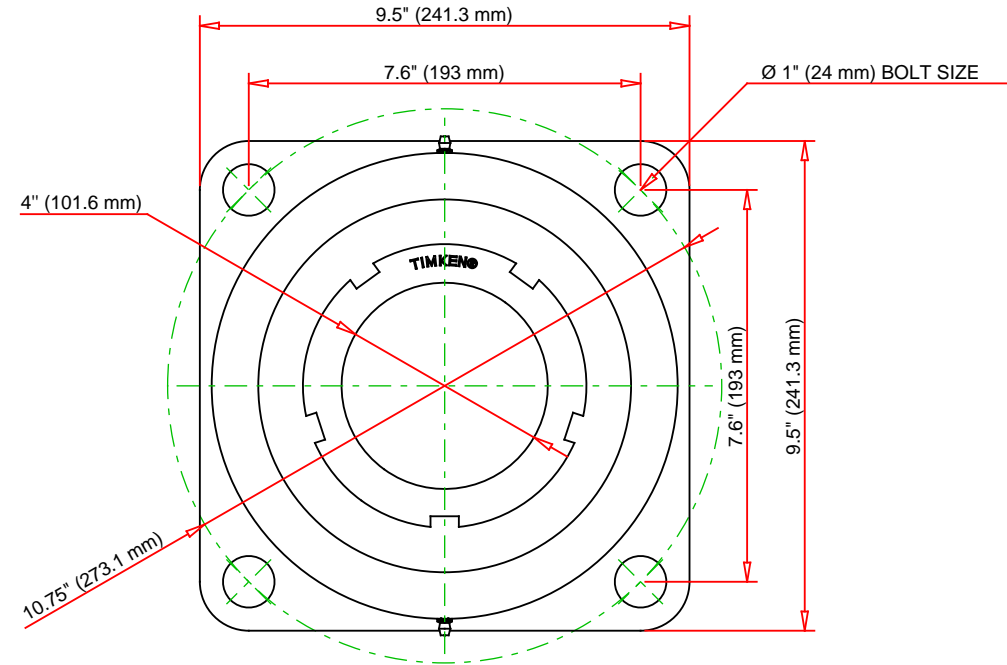
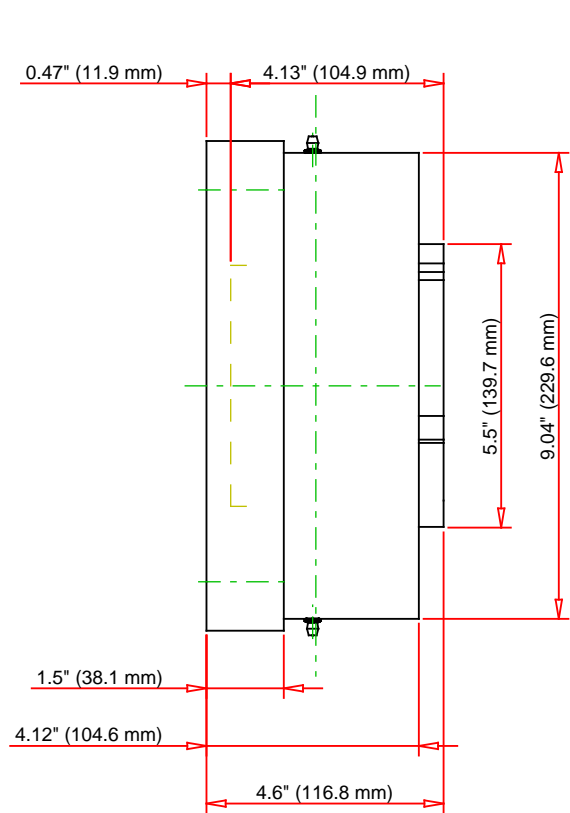

Note: Section View not to Scale

C - Dynamic Load	125000	lbf	555000	N
C0 - Static Load	147000	lbf	653000	N
Weight	55	lb	24.9	kg
Max. Speed T-Seals & Grease	1200	rpm		
Rad. Clearance - Max.	0.0067			

TIMKEN

THE TIMKEN COMPANY
NORTH CANTON, OHIO USA

QVFL22V400S
Single V-Lock Four-Bolt Square
Flange Block

Every reasonable effort has been made to ensure the accuracy of the information contained in this writing, but no liability is accepted for errors, omissions or for any other reason.

FOR DISCUSSION ONLY