



**The Timken Company**

4500 Mt Pleasant St. NW

N. Canton, OH 44720

**Phone:** (234) 262-3000

**E-Mail:** [CustomerCAD@timken.com](mailto:CustomerCAD@timken.com) • **Web site:** [www.timken.com](http://www.timken.com)

## Part Number QVVP11V050S, Double V-Lock Two-Bolt Pillow Block

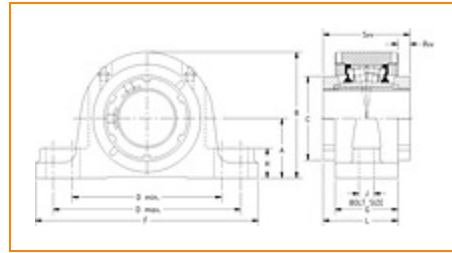

[Specifications](#) | [Dimensions](#) | [Radial and Thrust Factors](#) | [Engineering Seal Speed](#) | [Engineering Bearing Attributes](#) | [Engineering Internal Radial Clearance](#)

### Specifications

**Engineering Group** Mounted Bearing

**Bearing Number** 22211

**Shaft Size** 50 mm

**Shaft Size Type** Metric

**Full Timken Part Number**

- QVVP11V050SB
- QVVP11V050SC
- QVVP11V050SEB
- QVVP11V050SEC
- QVVP11V050SEM
- QVVP11V050SEN
- QVVP11V050SEO
- QVVP11V050SET
- QVVP11V050SM
- QVVP11V050SN



QVVP11V050SO  
 QVVP11V050ST  
 QVVP11V050STHT  
 QVVP11V050STNG

**Locking Style** Double V-Lock

**Housing Construction** Two-Bolt Pillow Block

**UPC Code**

0883450032452  
 0883450032568  
 0883450095044  
 0883450095518  
 0883450106863  
 0883450107006  
 0883450113540  
 0883450113823  
 0883450126564  
 0883450126991  
 0883450137614  
 0883450137706  
 0883450952736  
 0883450959360

## Dimensions

**Dimension A** 2.25 in  
 57.2 mm

**Dimension B** 4.81 in  
 122.2 mm

**Dimension C** 2.99 in  
 75.9 mm

**Dimension D Min** 6 in  
 152.4 mm

**Dimension D Max** 7.13 in  
 181.1 mm

**Dimension F** 8.88 in  
 225.6 mm

<b>Dimension G</b>	2.44 in 62 mm
<b>Dimension H</b>	1-1/4 in 31.8 mm
<b>Dimension J (Bolt Size)</b>	0.625 in 16 mm
<b>Dimension L</b>	3.23 in 82 mm
<b>Dimension RVV</b>	0.79 in 20.1 mm
<b>Dimension SVV</b>	4.02 in 102.1 mm

### Radial and Thrust Factors

<b>C0 - Static Load</b>	31900 lbf 142000 N
<b>C - Dynamic Load (Basic)</b>	31400 lbf 140000 N
<b>e - Geometry Factor</b>	0.23
<b>Y1 - Geometry Factor</b>	2.95
<b>Y2 - Geometry Factor</b>	4.40

### Engineering Seal Speed

<b>Oil Lubrication - M/N Seal</b>	2200 rpm
<b>Oil Lubrication - T Seal</b>	3800 rpm
<b>Oil Lubrication - B/C/O Seal</b>	1800 rpm
<b>Grease Lubrication - M/N Seal</b>	2200 rpm

<b>Grease Lubrication - T Seal</b>	3200 rpm
------------------------------------	----------

<b>Grease Lubrication - B/C/O Seal</b>	1600 rpm
--	----------

### Engineering Bearing Attributes

<b>Float</b>	0.050 in 1.270 mm
--------------	----------------------

<b>Shaft Tolerance</b>	0.0015 in 0.038 mm
------------------------	-----------------------

### Engineering Internal Radial Clearance

<b>Eng Internal Radial Clearance - Min</b>	0.0030
--	--------

<b>Eng Internal Radial Clearance - Max</b>	0.0037
--	--------

<b>Pre Install Clearance Min</b>	0.0030 in 0.075 mm
----------------------------------	-----------------------

<b>Pre Install Clearance Max</b>	0.0037 in 0.094 mm
----------------------------------	-----------------------

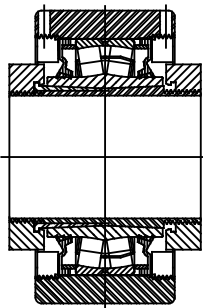
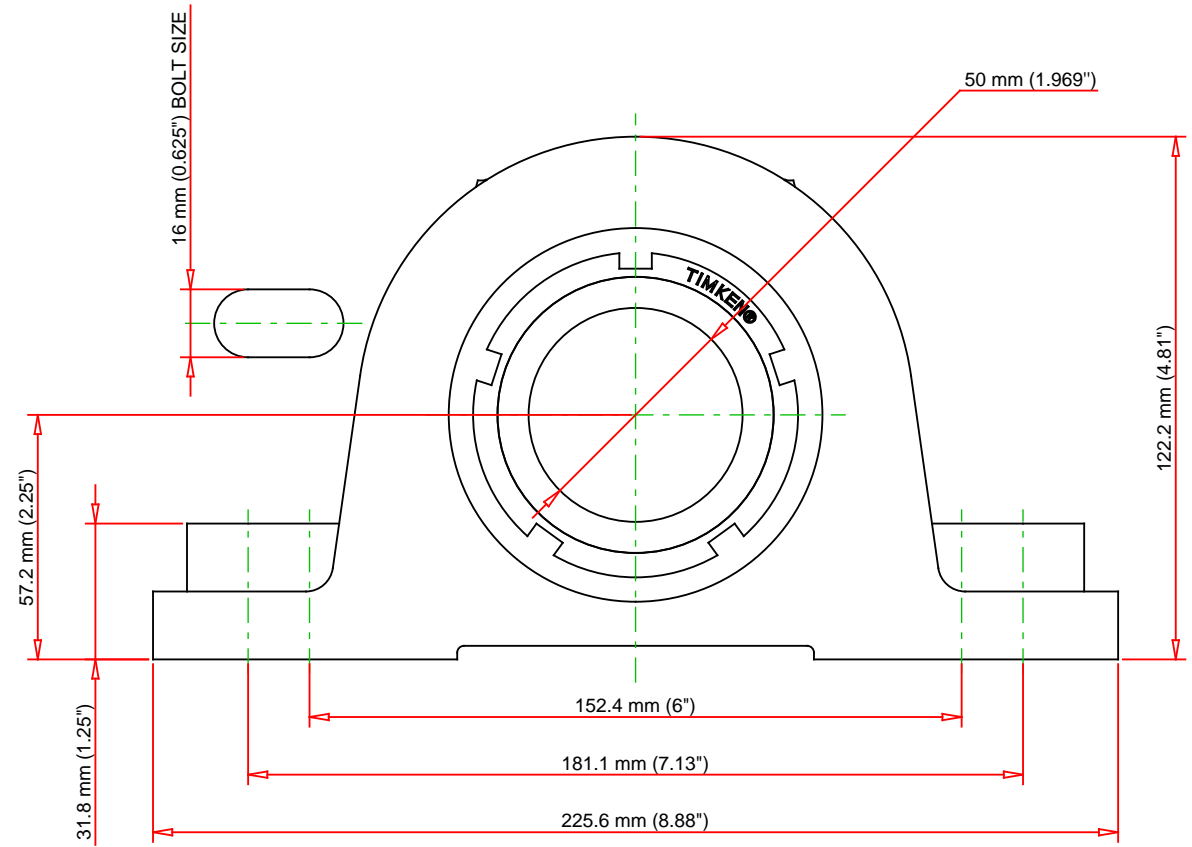
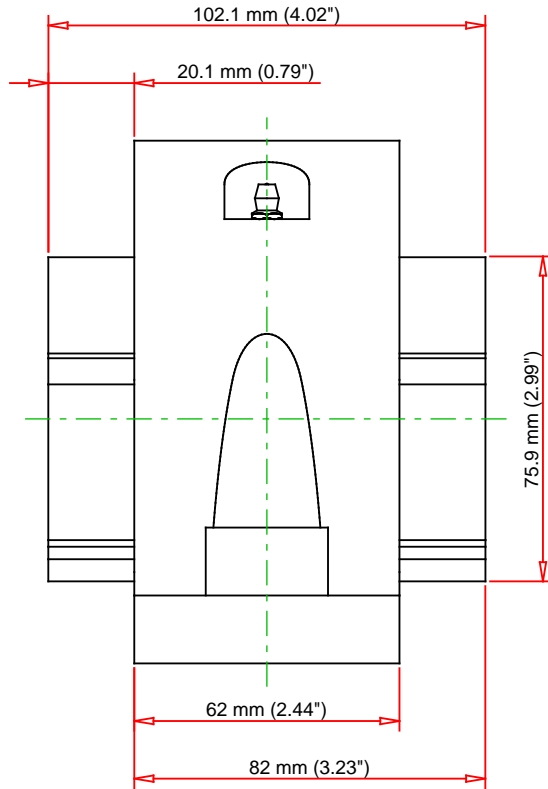

Note: Section View not to Scale

C - Dynamic Load	31400	lbf	140000	N
C0 - Static Load	31900	lbf	142000	N
Weight	14	lb	6.4	kg
Max. Speed T-Seals & Grease	3200	rpm		
Rad. Clearance - Max.	0.0037			

**TIMKEN**

THE TIMKEN COMPANY  
NORTH CANTON, OHIO USA

**QVVP11V050S**  
Double V-Lock Two-Bolt Pillow Block

Every reasonable effort has been made to ensure the accuracy of the information contained in this writing, but no liability is accepted for errors, omissions or for any other reason.

**FOR DISCUSSION ONLY**