



**The Timken Company**

4500 Mt Pleasant St. NW

N. Canton, OH 44720

**Phone:** (234) 262-3000

**E-Mail:** [CustomerCAD@timken.com](mailto:CustomerCAD@timken.com) • **Web site:** [www.timken.com](http://www.timken.com)

## Part Number QAFL11A203S, Single Concentric Four Bolt Square Flange Block

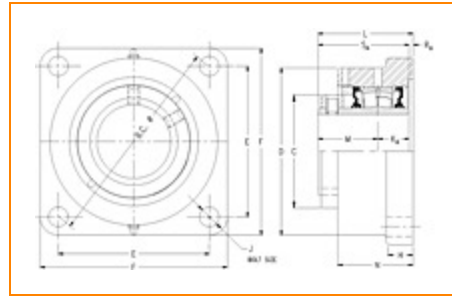

[Specifications](#) | [Dimensions](#) | [Radial and Thrust Factors](#) | [Engineering Seal Speed](#) | [Engineering Bearing Attributes](#) | [Engineering Internal Radial Clearance](#)

### Specifications

**Engineering Group** Mounted Bearing

**Bearing Number** 22211

**Shaft Size** 2 3/16 in

**Shaft Size Type** Imperial

**Full Timken Part Number**

- QAFL11A203SB
- QAFL11A203SC
- QAFL11A203SEB
- QAFL11A203SEC
- QAFL11A203SEM
- QAFL11A203SEN
- QAFL11A203SEO
- QAFL11A203SET
- QAFL11A203SM
- QAFL11A203SN
- QAFL11A203SO



QAFL11A203ST

**Locking Style** Single Concentric

**Housing Construction** Four-Bolt Square Flange

**UPC Code**

0883450039703  
0883450039710  
0883450039734  
0883450039741  
0883450039758  
0883450039765  
0883450039772  
0883450039789  
0883450191319  
0883450191470  
0883450268677  
0883450268837

## Dimensions

**Dimension BC** 6.38 in  
162.1 mm

**Dimension C** 3.25 in  
82.6 mm

**Dimension D** 5.19 in  
131.8 mm

**Dimension E** 4.5 in  
114.3 mm

**Dimension F** 5.88 in  
149.4 mm

**Dimension H** 0.75 in  
19.1 mm

**Dimension J (Bolt Size)** 0.625 in  
16 mm

**Dimension KA** 1.13 in  
28.7 mm

<b>Dimension L Exp</b>	3.36 in 85.3 mm
------------------------	--------------------

<b>Dimension L Fix</b>	3.28 in 83.3 mm
------------------------	--------------------

<b>Dimension M</b>	2 in 50.8 mm
--------------------	-----------------

<b>Dimension N</b>	2.63 in 66.8 mm
--------------------	--------------------

<b>Dimension RA</b>	0.15 in 3.8 mm
---------------------	-------------------

<b>Dimension SA</b>	3.13 in 79.5 mm
---------------------	--------------------

## Radial and Thrust Factors

<b>C0 - Static Load</b>	31900 lbf 142000 N
-------------------------	-----------------------

<b>C - Dynamic Load (Basic)</b>	31400 lbf 140000 N
---------------------------------	-----------------------

<b>e - Geometry Factor</b>	0.25
----------------------------	------

<b>Y1 - Geometry Factor</b>	2.74
-----------------------------	------

<b>Y2 - Geometry Factor</b>	4.08
-----------------------------	------

## Engineering Seal Speed

<b>Oil Lubrication - M/N Seal</b>	2200 rpm
-----------------------------------	----------

<b>Oil Lubrication - T Seal</b>	3800 rpm
---------------------------------	----------

<b>Oil Lubrication - B/C/O Seal</b>	1600 rpm
-------------------------------------	----------

<b>Grease Lubrication - M/N Seal</b>	2200 rpm
--------------------------------------	----------

<b>Grease Lubrication - T Seal</b>	3200 rpm
------------------------------------	----------

<b>Grease Lubrication - B/C/O Seal</b>	1600 rpm
--	----------

### Engineering Bearing Attributes

<b>Float</b>	0.050 in 1.270 mm
--------------	----------------------

<b>Shaft Tolerance</b>	0.0015 in 0.038 mm
------------------------	-----------------------

### Engineering Internal Radial Clearance

<b>Eng Internal Radial Clearance - Min</b>	0.0016
--	--------

<b>Eng Internal Radial Clearance - Max</b>	0.0026
--	--------

<b>Pre Install Clearance Min</b>	0.0016 in 0.040 mm
----------------------------------	-----------------------

<b>Pre Install Clearance Max</b>	0.0026 in 0.065 mm
----------------------------------	-----------------------

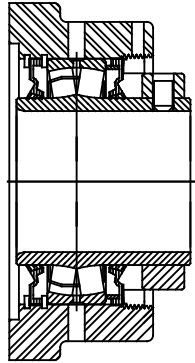
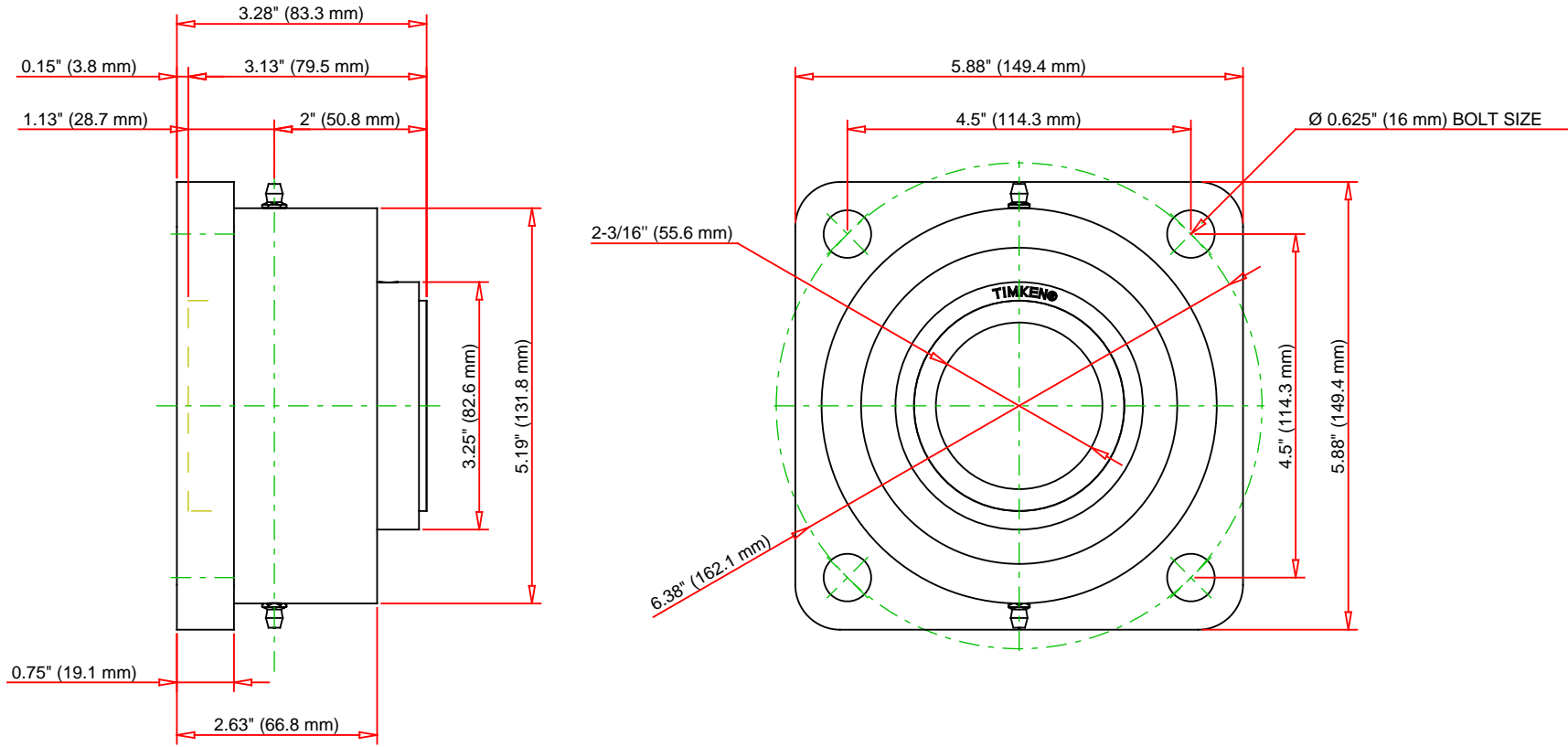

Note: Section View not to Scale

C - Dynamic Load	31400	lbf	140000	N
C0 - Static Load	31900	lbf	142000	N
Weight	14	lb	6.4	kg
Max. Speed T-Seals & Grease	3200	rpm		
Rad. Clearance - Max.	0.0026			

**TIMKEN**

THE TIMKEN COMPANY  
NORTH CANTON, OHIO USA

**QAFL11A203S**

Single Concentric Four Bolt Square  
Flange Block

Every reasonable effort has been made to ensure the accuracy of the information contained in this writing, but no liability is accepted for errors, omissions or for any other reason.

**FOR DISCUSSION ONLY**