



The Timken Company

4500 Mt Pleasant St. NW

N. Canton, OH 44720

Phone: (234) 262-3000

E-Mail: CustomerCAD@timken.com • **Web site:** www.timken.com

Part Number QAAF20A315S, Double Concentric Four Bolt Square Flange Block

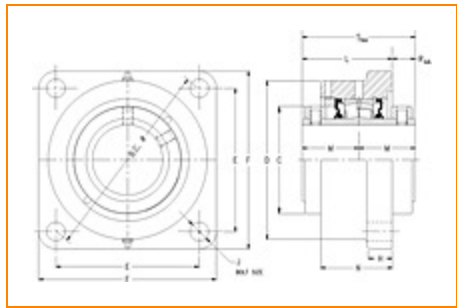

[Specifications](#) | [Dimensions](#) | [Radial and Thrust Factors](#) | [Engineering Seal Speed](#) | [Engineering Bearing Attributes](#) | [Engineering Internal Radial Clearance](#)

Specifications

Engineering Group	Mounted Bearing
Bearing Number	22220
Shaft Size	3 15/16 in
Shaft Size Type	Imperial
Full Timken Part Number	QAAF20A315SB QAAF20A315SC QAAF20A315SEB QAAF20A315SEC QAAF20A315SEM QAAF20A315SEN QAAF20A315SEO QAAF20A315SET QAAF20A315SM QAAF20A315SN QAAF20A315SO



QAAFX20A315ST

Locking Style Double Concentric

Housing Construction Four-Bolt Square Flange

UPC Code

0883450136235
0883450136242
0883450136259
0883450136266
0883450136273
0883450136280
0883450136297
0883450136303
0883450192903
0883450193092
0883450270106
0883450270281

Dimensions

Dimension BC 11-3/4 in
298.5 mm

Dimension C 6 in
152.4 mm

Dimension D 8.5 in
215.9 mm

Dimension E 8.31 in
211.1 mm

Dimension F 10.56 in
268.2 mm

Dimension H 1 1/2 in
38.1 mm

Dimension J (Bolt Size) 0.875 in
24 mm

Dimension L Exp 5.04 in
128 mm

Dimension L Fix	4.96 in 126 mm
Dimension M	2.97 in 75.4 mm
Dimension N	4.06 in 103.1 mm
Dimension RAA	0.97 in 24.6 mm
Dimension SAA	5.92 in 150.4 mm

Radial and Thrust Factors

C0 - Static Load	113000 lbf 502000 N
C - Dynamic Load (Basic)	97700 lbf 435000 N
e - Geometry Factor	0.24
Y1 - Geometry Factor	2.84
Y2 - Geometry Factor	4.23

Engineering Seal Speed

Oil Lubrication - M/N Seal	1200 rpm
Oil Lubrication - T Seal	2000 rpm
Oil Lubrication - B/C/O Seal	900 rpm
Grease Lubrication - M/N Seal	1200 rpm
Grease Lubrication - T Seal	1600 rpm
Grease Lubrication - B/C/O Seal	900 rpm

Engineering Bearing Attributes

Float	0.083 in 2.108 mm
Shaft Tolerance	0.0030 in 0.076 mm

Engineering Internal Radial Clearance

Eng Internal Radial Clearance - Min	0.0030
Eng Internal Radial Clearance - Max	0.0047
Pre Install Clearance Min	0.0030 in 0.075 mm
Pre Install Clearance Max	0.0047 in 0.120 mm

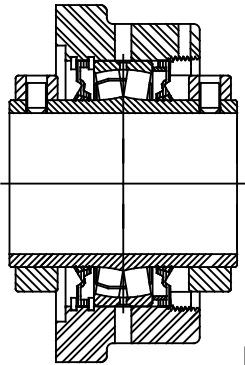
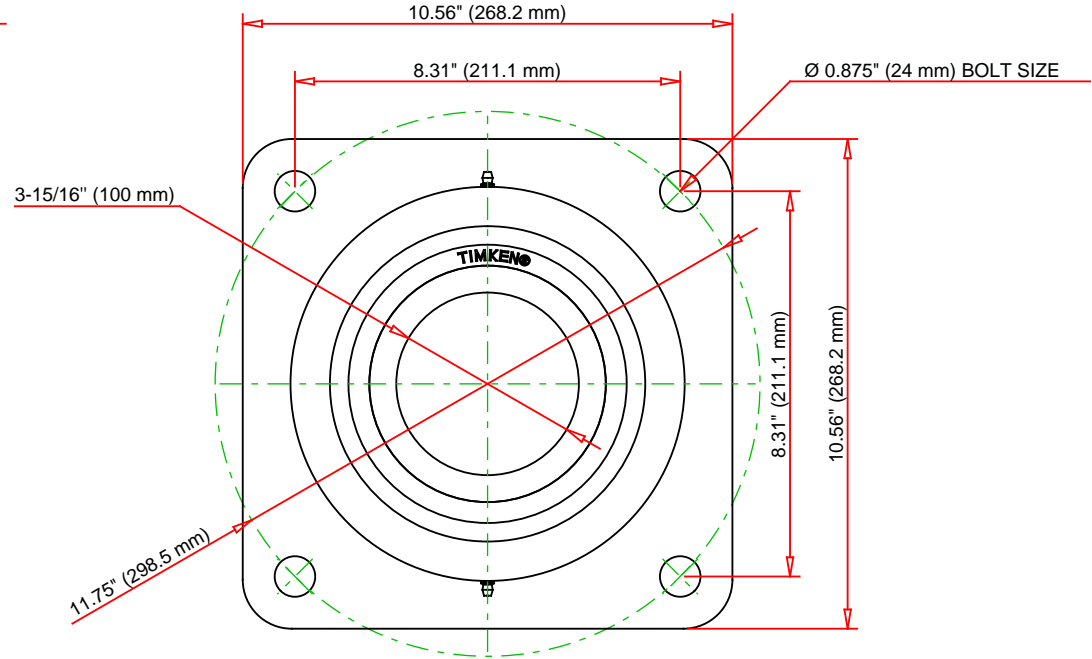
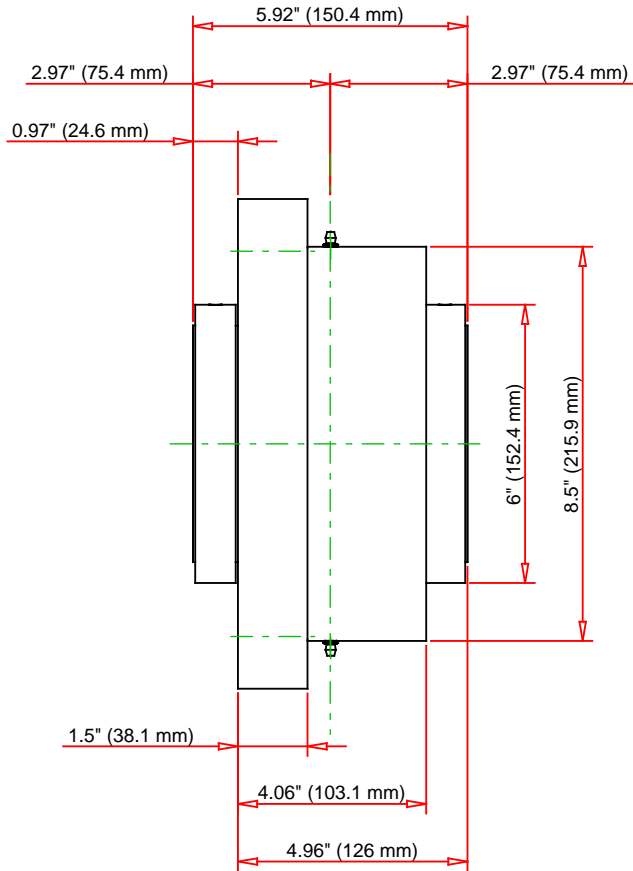

Note: Section View not to Scale

C - Dynamic Load	97700	lbf	435000	N
C0 - Static Load	113000	lbf	502000	N
Weight	66	lb	29.9	kg
Max. Speed T-Seals & Grease	1600	rpm		
Rad. Clearance - Max.	0.0047			

TIMKEN

THE TIMKEN COMPANY
NORTH CANTON, OHIO USA

QAAF20A315S

Double Concentric Four Bolt Square
Flange Block

Every reasonable effort has been made to ensure the accuracy of the information contained in this writing, but no liability is accepted for errors, omissions or for any other reason.

FOR DISCUSSION ONLY