



The Timken Company

4500 Mt Pleasant St. NW

N. Canton, OH 44720

Phone: (234) 262-3000

E-Mail: CustomerCAD@timken.com • **Web site:** www.timken.com

Part Number QVFC20V080S, Double V-Lock Four Bolt Square Flange Block

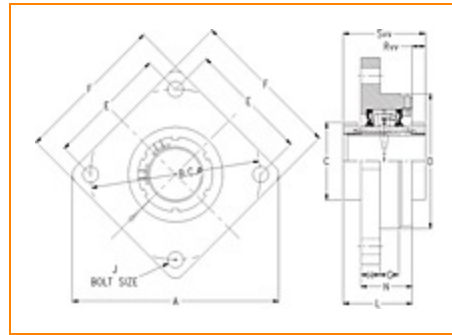

[Specifications](#) | [Dimensions](#) | [Radial and Thrust Factors](#) | [Engineering Seal Speed](#) | [Engineering Bearing Attributes](#) | [Engineering Internal Radial Clearance](#)

Specifications

Engineering Group Mounted Bearing

Bearing Number 22220

Shaft Size 80 mm

Shaft Size Type Metric

Full Timken Part Number

- QVFC20V080SB
- QVFC20V080SC
- QVFC20V080SEB
- QVFC20V080SEC
- QVFC20V080SEM
- QVFC20V080SEN
- QVFC20V080SEO
- QVFC20V080SET
- QVFC20V080SM
- QVFC20V080SN
- QVFC20V080SO



QVFC20V080ST

Locking Style

Double V-Lock

Housing Construction

Four-Bolt Square Flange

UPC Code

0883450150453
 0883450150545
 0883450158145
 0883450158275
 0883450179669
 0883450179751
 0883450189125
 0883450189217
 0883450280396
 0883450280488
 0883450284592
 0883450284684

Dimensions**Dimension A1**

13.0 in
 330.2 mm

Dimension BC

11.02 in
 279.9 mm

Dimension C

4.9 in
 124.5 mm

Dimension D

9.06 in
 230.1 mm

Dimension G

1.25 in
 31.75 mm

Dimension L

4.14 in
 105.2 mm

Dimension E

7.79 in
 197.9 mm

Dimension F

9.76 in
 247.9 mm

Dimension H	1.13 in 28.7 mm
--------------------	--------------------

Dimension J (Bolt Size)	0.75 in 20 mm
--------------------------------	------------------

Dimension N	3.71 in 94.2 mm
--------------------	--------------------

Dimension RVV	0.49 in 12.4 mm
----------------------	--------------------

Dimension SVV	4.62 in 117.3 mm
----------------------	---------------------

Radial and Thrust Factors

C0 - Static Load	113000 lbf 502000 N
-------------------------	------------------------

C - Dynamic Load (Basic)	97700 lbf 435000 N
---------------------------------	-----------------------

e - Geometry Factor	0.26
----------------------------	------

Y1 - Geometry Factor	2.84
-----------------------------	------

Y2 - Geometry Factor	4.23
-----------------------------	------

Engineering Seal Speed

Oil Lubrication - M/N Seal	1200 rpm
-----------------------------------	----------

Oil Lubrication - T Seal	2000 rpm
---------------------------------	----------

Oil Lubrication - B/C/O Seal	900 rpm
-------------------------------------	---------

Grease Lubrication - M/N Seal	1200 rpm
--------------------------------------	----------

Grease Lubrication - T Seal	1600 rpm
------------------------------------	----------

Grease Lubrication - B/C/O Seal	900 rpm
--	---------

Engineering Bearing Attributes

Float	0.083 in 2.108 mm
Shaft Tolerance	0.0030 in 0.076 mm

Engineering Internal Radial Clearance

Eng Internal Radial Clearance - Min	0.0043
Eng Internal Radial Clearance - Max	0.0055
Pre Install Clearance Min	0.0043 in 0.110 mm
Pre Install Clearance Max	0.0055 in 0.140 mm

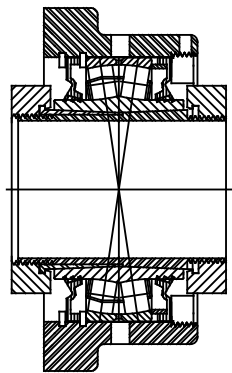
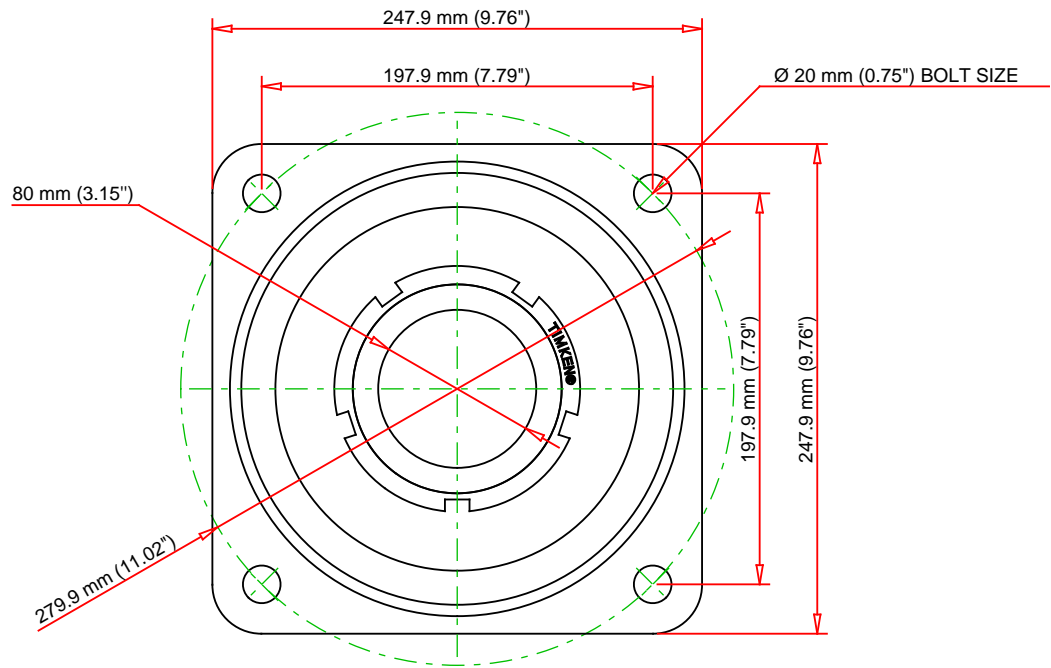
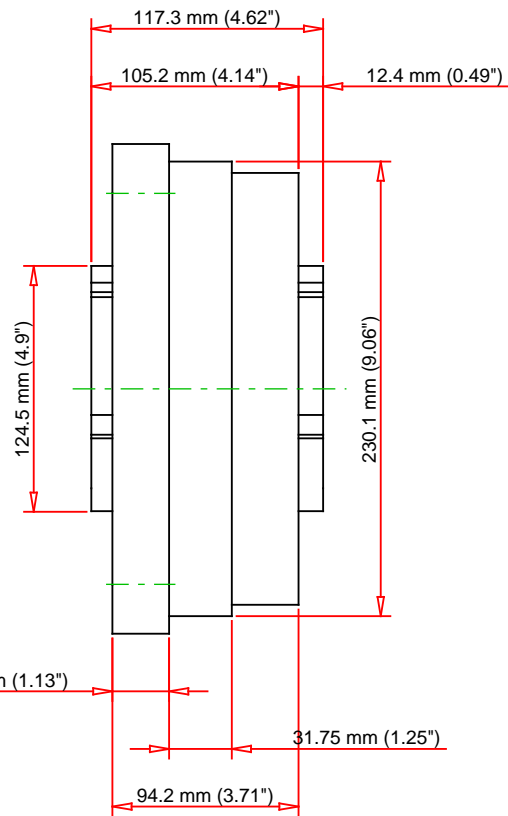

Note: Section View not to Scale

C - Dynamic Load	97700	lbf	435000	N
C0 - Static Load	113000	lbf	502000	N
Weight	40	lb	18.1	kg
Max. Speed T-Seals & Grease	1600	rpm		
Rad. Clearance - Max.	0.0055			

TIMKEN

THE TIMKEN COMPANY
NORTH CANTON, OHIO USA

QVFC20V080S

Double V-Lock Four Bolt Square
Flange Block

Every reasonable effort has been made to ensure the accuracy of the information contained in this writing, but no liability is accepted for errors, omissions or for any other reason.

FOR DISCUSSION ONLY